

External Axis Upgrade kits

Expand your production capabilities

ABB's proven and pre-engineered external axis upgrade kits - a cost efficient solution that is easier to integrate with robots and robot controllers than ever before.



Expanding possibilities

ABB introduces its standardized external axis upgrade kit for your robot. It makes possible to add customized positioners, track motion rails, grippers and indexing conveyers.

Standardized solutions

All external axis kits versions are currently being used in ABB's range of positioners and robots. The kits are tested, proven and pre-engineered to work in combination with other ABB equipment. The external axis kit conveniently contains all the required components for your robot at a lower total cost than for the individual spare parts.

Easily integrated

The external axis kits include CAD models which allow engineers to easily incorporate servo units into their system designs. These are particularly suited for ABB's own easy-to-use RobotStudio® software, which supports every aspect of a robot system (e.g., motion control, application design, execution, and communication), as well as RobotWare. By using the RobotWare tool TuneMaster, an integrator building a customized positioner can tune both motor and gear unit parameters to achieve an improved motion performance in less time. For example, TuneMaster facilitates robot and track interaction tuning for improved overall performance.

Complete package

The kits include all required parts to provide robots with the selected external axis components. The accompanying flexible cables simplify integration of motor units into designs where the motor frequently shifts position. End customers will benefit because these cables are proven to last much longer. The units are also available with serial measurement boards and push buttons for brake release.

Global support

With more than 40 years of experience in robotics, ABB has sales and service organizations in 53 countries.

External Axis Upgrade kits

Expand your production capabilities

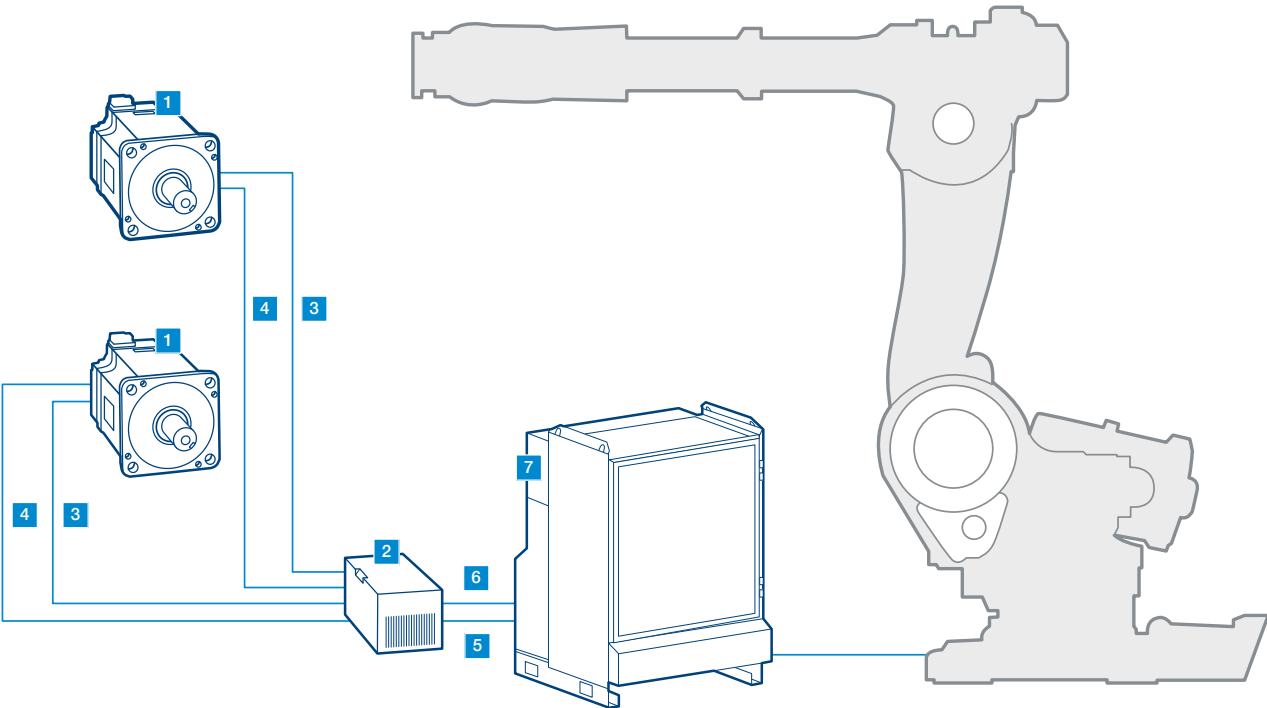

© Copyright 2015 ABB Robotics. All rights reserved. ROB028EN March 2015

Item	Parts
1	Motor unit
2	Serial measurement box *
3	Resolver cable **
4	Motor cable **
5	Power cable ***
6	Serial measurement cable ***
7	Robot cabinet

* Large robots with one motor do not have serial measurement box. A kit with brake release box is available.
** Cable lengths available: 1.5 m, 7 m, 15 m
*** Cable lengths available: 7 m, 15 m

Motor unit specification				
Version	Weight (kg)	Rated speed (rpm)	Max. dynamic torque (Nm)	Protection
MU 10	4.4	3300	4.3	IP 67
MU 20	13.5	3300	19.0	IP 67
MU 30	23.5	3300	30.0	IP 67

For more information please contact:

ABB AB Robotics
Hydrovägen 10
SE-721 36 Västerås, Sweden
Phone: +46 21325000

www.abb.com/products/robotics/service

Note
We reserve the right to make technical changes or modify the contents of this document without prior notice. With regard to purchase orders, the agreed particulars shall prevail. ABB does not accept any responsibility whatsoever for potential errors or possible lack of information in this document.

We reserve all rights in this document and in the subject matter and illustrations contained therein. Any reproduction, disclosure to third parties or utilization of its contents - in whole or in parts - is forbidden without prior written consent of ABB.

Copyright© 2015 ABB All rights reserved

		IRB 140, 1400, 1600, 2400, 340	IRB 4400	IRB 4600	IRB 6600, 7600, 660
IRC5 Design 2004	One motor	Available	Available	Available	Available
	Two motors	Available	Available	Available	Available
	Three motors	Available	NA	NA	NA
S4C+	One motor	On request	On request	NA	On request
	Two motors	On request	On request	NA	On request
	Three motors	On request	NA	NA	NA