

Emax - Tmax

DOC. N.° 1SDH000529R0907 - L4216

Blocco diverso calibro parte fissa T7-T7M-X1

Different gauge lock fixed part T7-T7M-X1

Spermechanismus anderer Bemessungsstrom Unterteil T7-T7M-X1

Verrouillage calibre différent partie fixe T7-T7M-X1

Bloqueo distinto calibre parte fija T7-T7M-X1

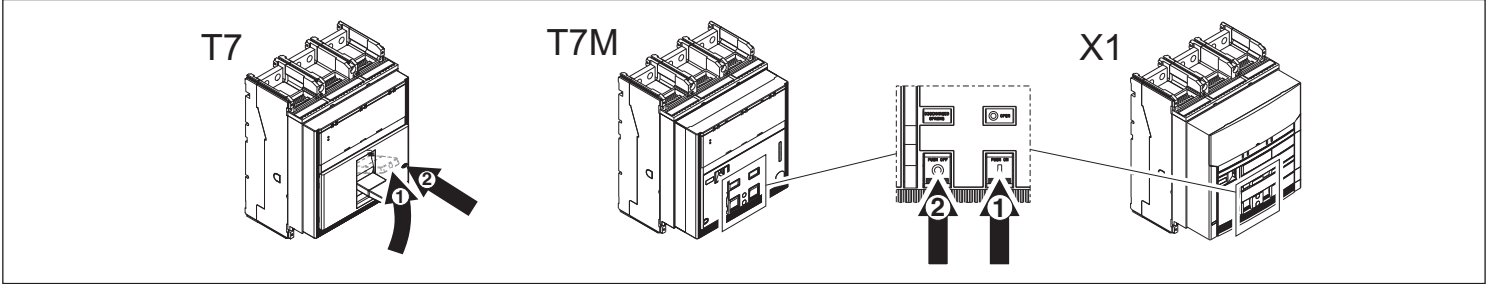

T7-T7M-X1

A

B

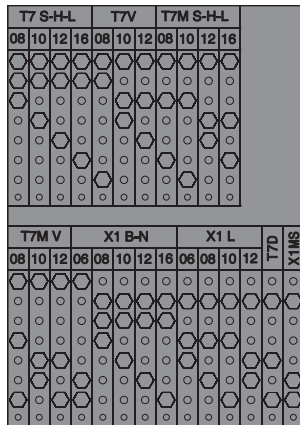
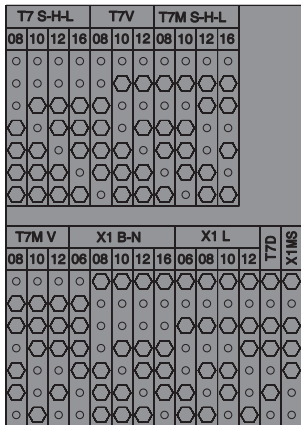

M4x8

M4x6

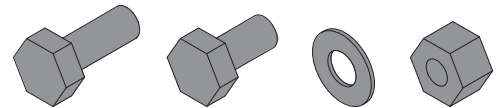

A

1

-

4

-

4

4

B

-

1

-

3

3

3

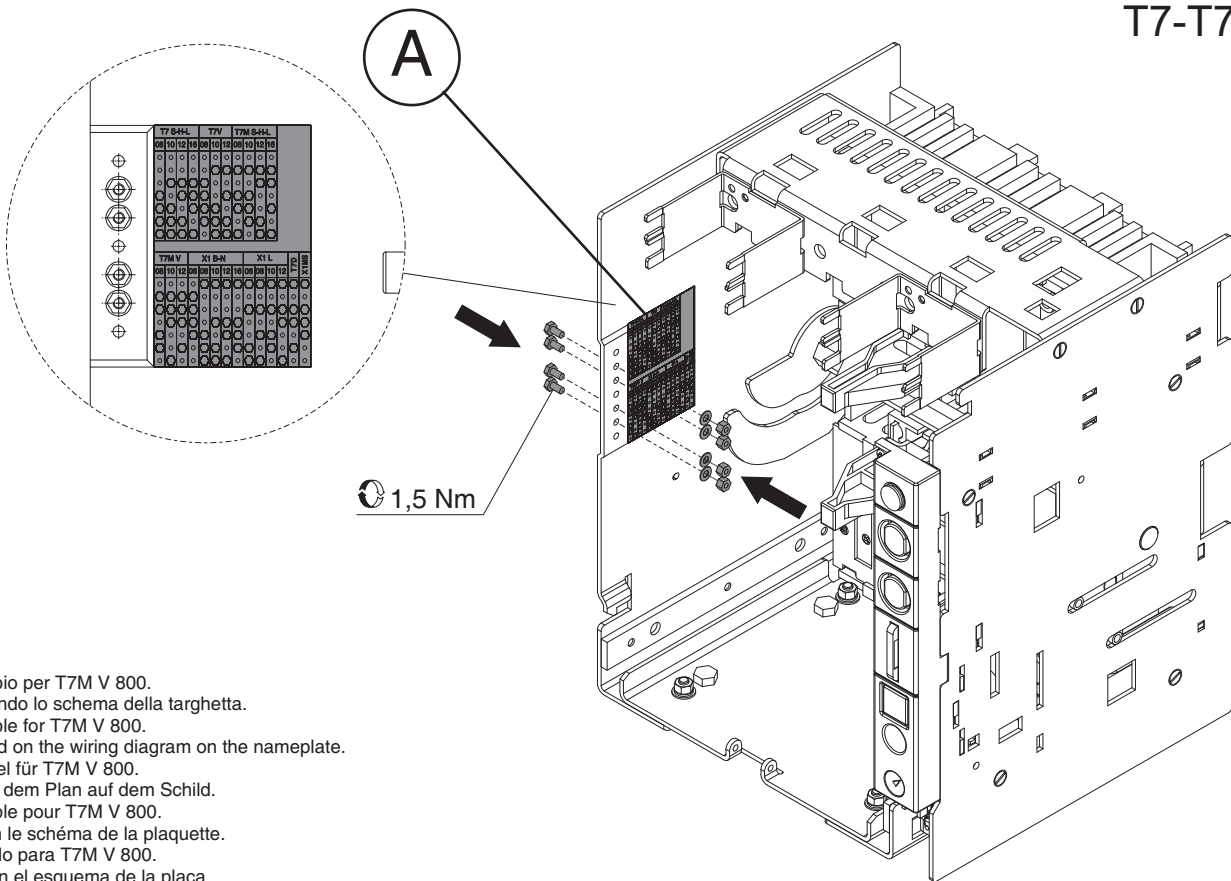
A**T7-T7M-X1 W**

- Esempio per T7M V 800.
Secondo lo schema della targhetta.
- Example for T7M V 800.
Based on the wiring diagram on the nameplate.
- Beispiel für T7M V 800.
Nach dem Plan auf dem Schild.
- Exemple pour T7M V 800.
Selon le schéma de la plaquette.
- Ejemplo para T7M V 800.
Según el esquema de la placa.

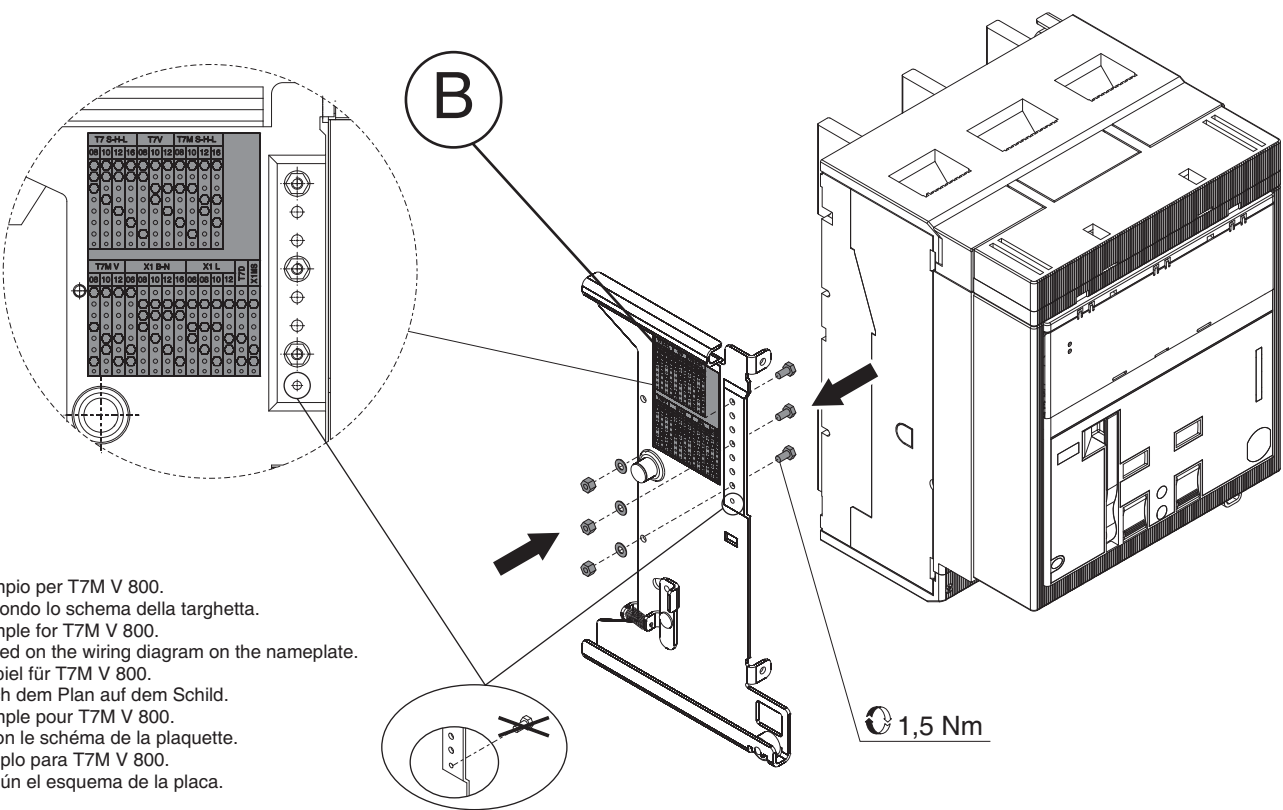
B**T7-T7M-X1 W**

- Esempio per T7M V 800.
Secondo lo schema della targhetta.
- Example for T7M V 800.
Based on the wiring diagram on the nameplate.
- Beispiel für T7M V 800.
Nach dem Plan auf dem Schild.
- Exemple pour T7M V 800.
Selon le schéma de la plaquette.
- Ejemplo para T7M V 800.
Según el esquema de la placa.

ABB**ABB SACE S.p.A.**Via Baioni, 35
24123 Bergamo Italy

Tel.: +39 035 395.111 - Telefax: +39 035 395.306-433

<http://www.abb.com>