

NOTES:

1. **WARNING:** This drawing does not illustrate completely the installation methods required for hazardous locations. Prior to any installation in a Classified Hazardous Location, verify installation methods by the Control Drawing referenced on the product's name tag and national and local codes.

2. 75 PSI Carrier Pressure is for the Non-Manifold version of the BTU. When using the Manifold version (check the type listed on the product label), use a Carrier Gas pressure of 90 PSI.

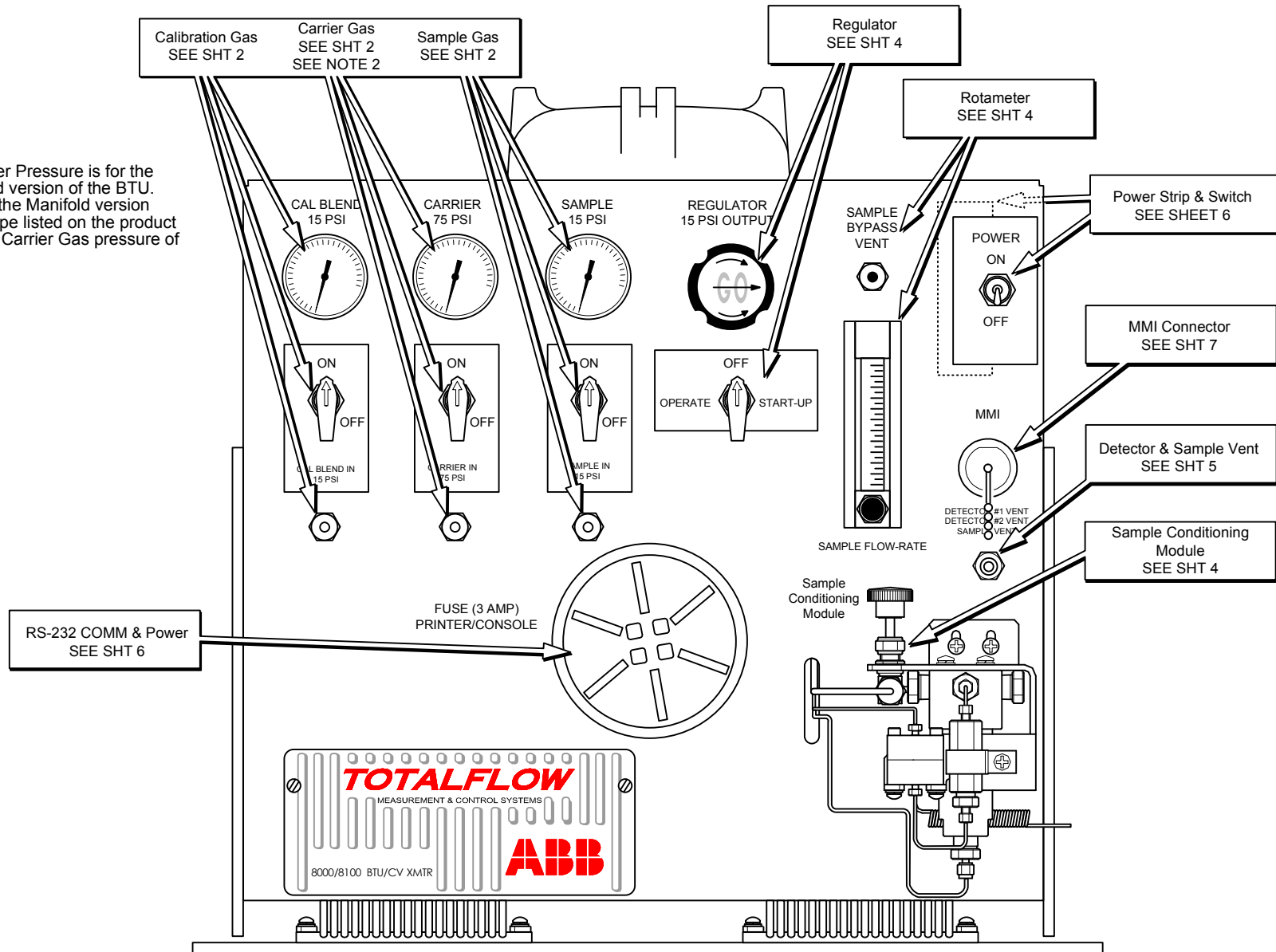

Front View of Mobile Mount

REF:N/A

ABB	TOTALFLOW Products	ACTION	DOC TYPE	TITLE	DWG NO.	REV	SHEET
		L19638	UD	MOBIL MOUNT FOR BTU TRANSMITTER TUBING AND POWER DIAGRAMS	2103079	AA	1 OF 7

NOTES:

1. **WARNING:** This drawing does not illustrate completely the installation methods required for hazardous locations. Prior to any installation in a Classified Hazardous Location, verify installation methods by the Control Drawing referenced on the product's name tag and national and local codes.
2. 75 PSI Carrier Pressure is for the Non-Manifold version of the BTU. When using the Manifold version (check the type listed on the product label), use a Carrier Gas pressure of 90 PSI.

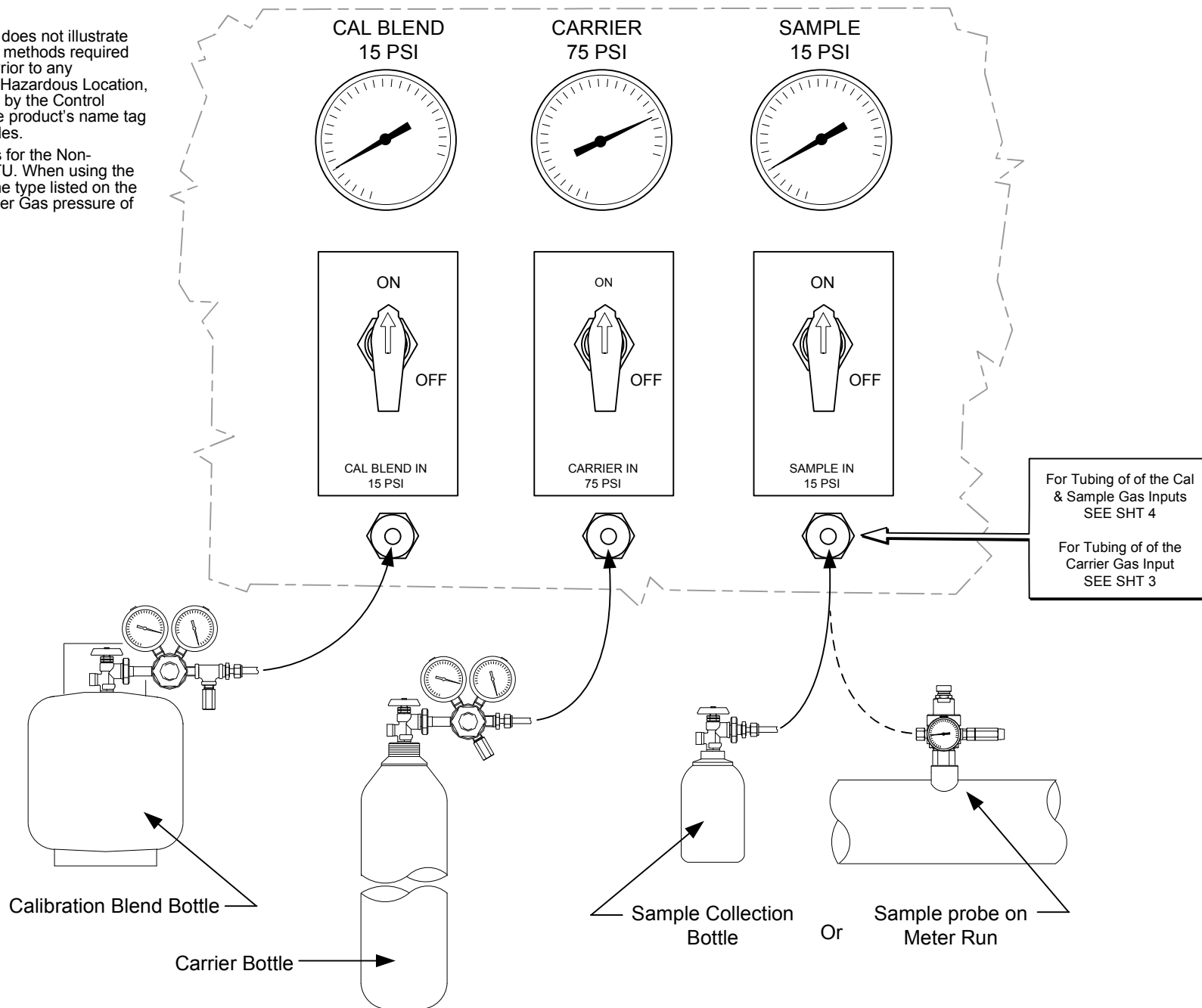

Front Panel Gas Connections to 1/8T SST Fitting

REF:N/A

ABB	TOTALFLOW Products	ACTION	DOC TYPE	TITLE	DWG NO.	REV	SHEET
		L19638	UD	MOBIL MOUNT FOR BTU TRANSMITTER TUBING AND POWER DIAGRAMS	2103079	AA	2 OF 7

NOTES:

1. WARNING: This drawing does not illustrate completely the installation methods required for hazardous locations. Prior to any installation in a Classified Hazardous Location, verify installation methods by the Control Drawing referenced on the product's name tag and national and local codes.

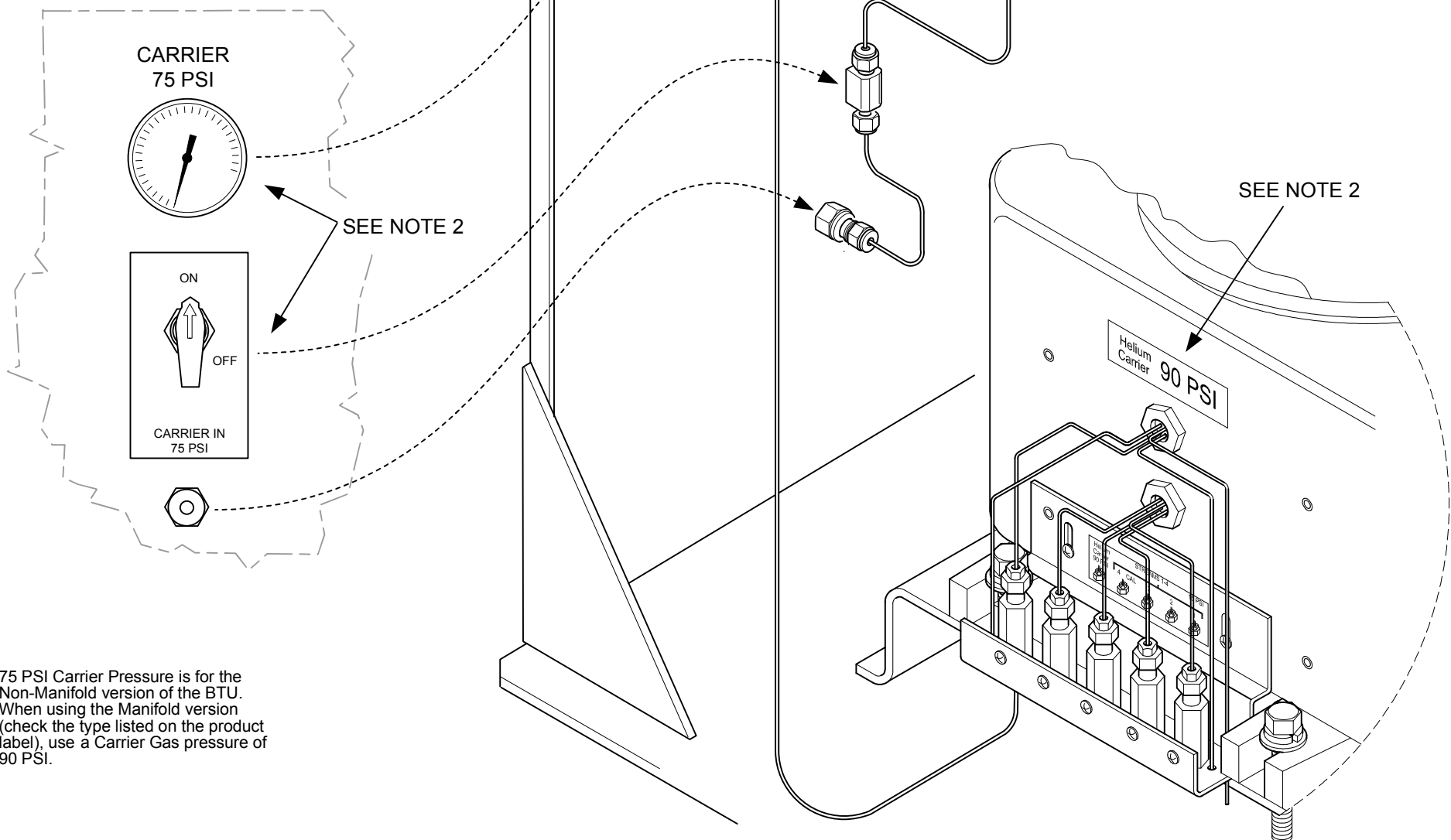

2. 75 PSI Carrier Pressure is for the Non-Manifold version of the BTU. When using the Manifold version (check the type listed on the product label), use a Carrier Gas pressure of 90 PSI.

Carrier Gas & Vent Details

REF:N/A

ABB	TOTALFLOW	ACTION	DOC TYPE	TITLE	DWG NO.	REV	SHEET
	Products	L19638	UD	MOBIL MOUNT FOR BTU TRANSMITTER TUBING AND POWER DIAGRAMS	2103079	AA	3 OF 7

NOTES:

1. WARNING: This drawing does not illustrate completely the installation methods required for hazardous locations. Prior to any installation in a Classified Hazardous Location, verify installation methods by the Control Drawing referenced on the product's name tag and national and local codes.

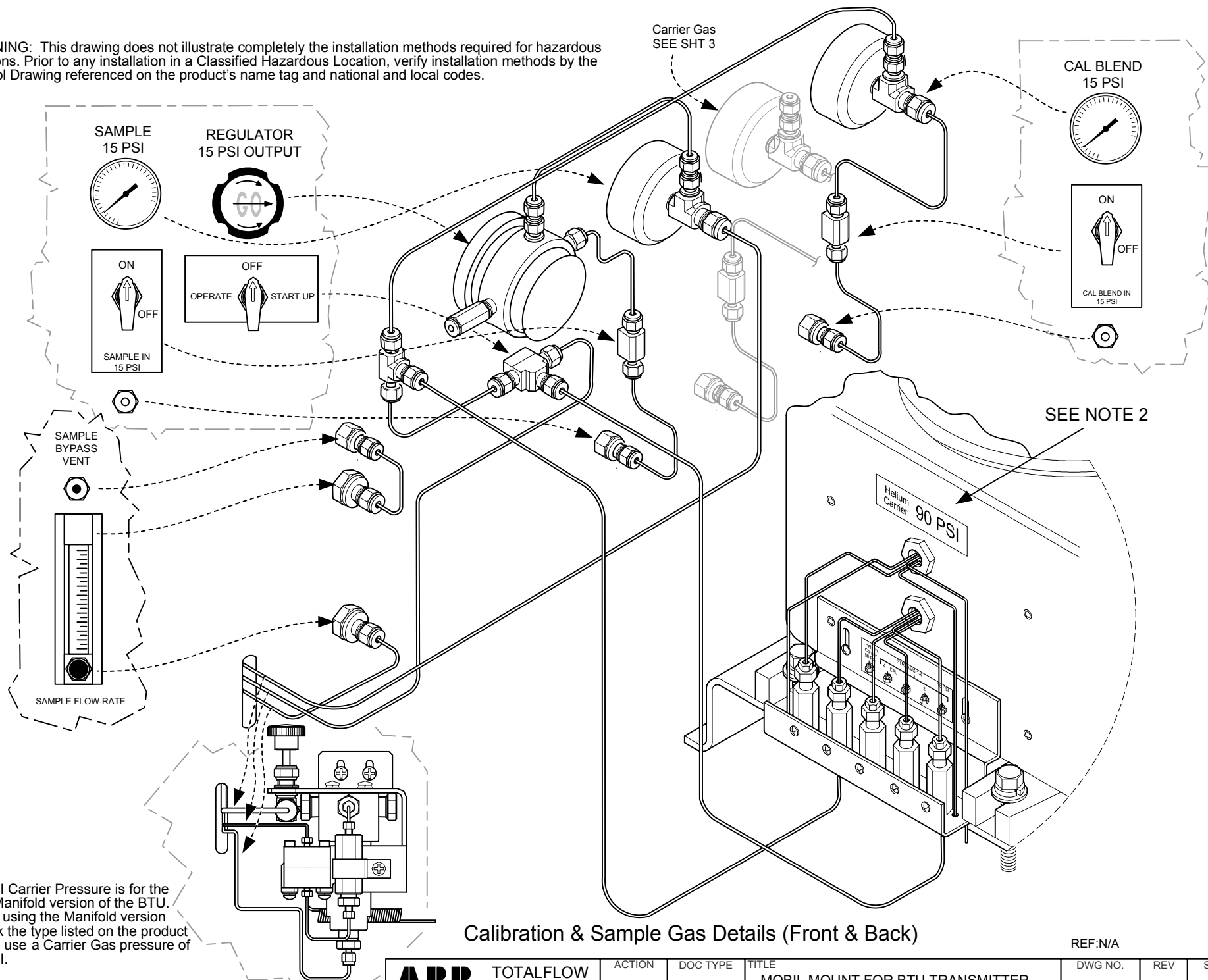

2. 75 PSI Carrier Pressure is for the Non-Manifold version of the BTU. When using the Manifold version (check the type listed on the product label), use a Carrier Gas pressure of 90 PSI.

Calibration & Sample Gas Details (Front & Back)

REF: N/A



TOTALFLOW
Products

ACTION
L19638

DOC TYPE
UD

TITLE
MOBIL MOUNT FOR BTU TRANSMITTER
TUBING AND POWER DIAGRAMS

DWG NO.
2103079

REV
AA

SHEET
4 OF 7

NOTES:

1. WARNING: This drawing does not illustrate completely the installation methods required for hazardous locations. Prior to any installation in a Classified Hazardous Location, verify installation methods by the Control Drawing referenced on the product's name tag and national and local codes.

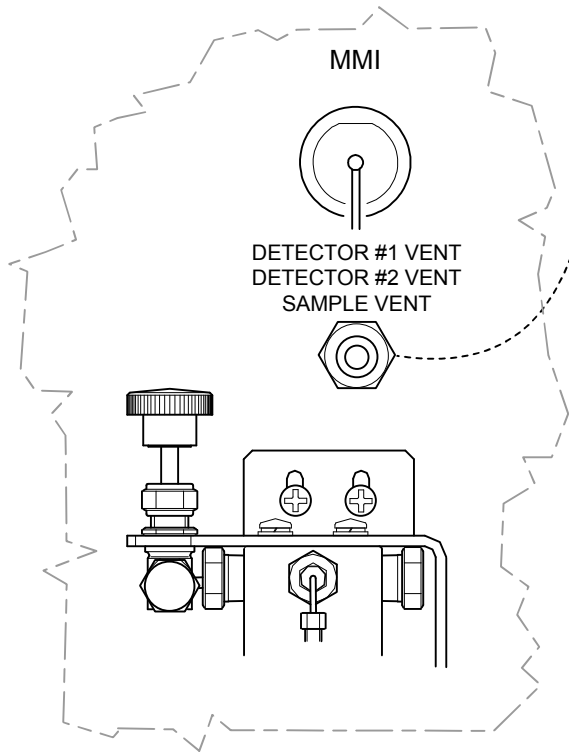

2. 75 PSI Carrier Pressure is for the Non-Manifold version of the BTU. When using the Manifold version (check the type listed on the product label), use a Carrier Gas pressure of 90 PSI.

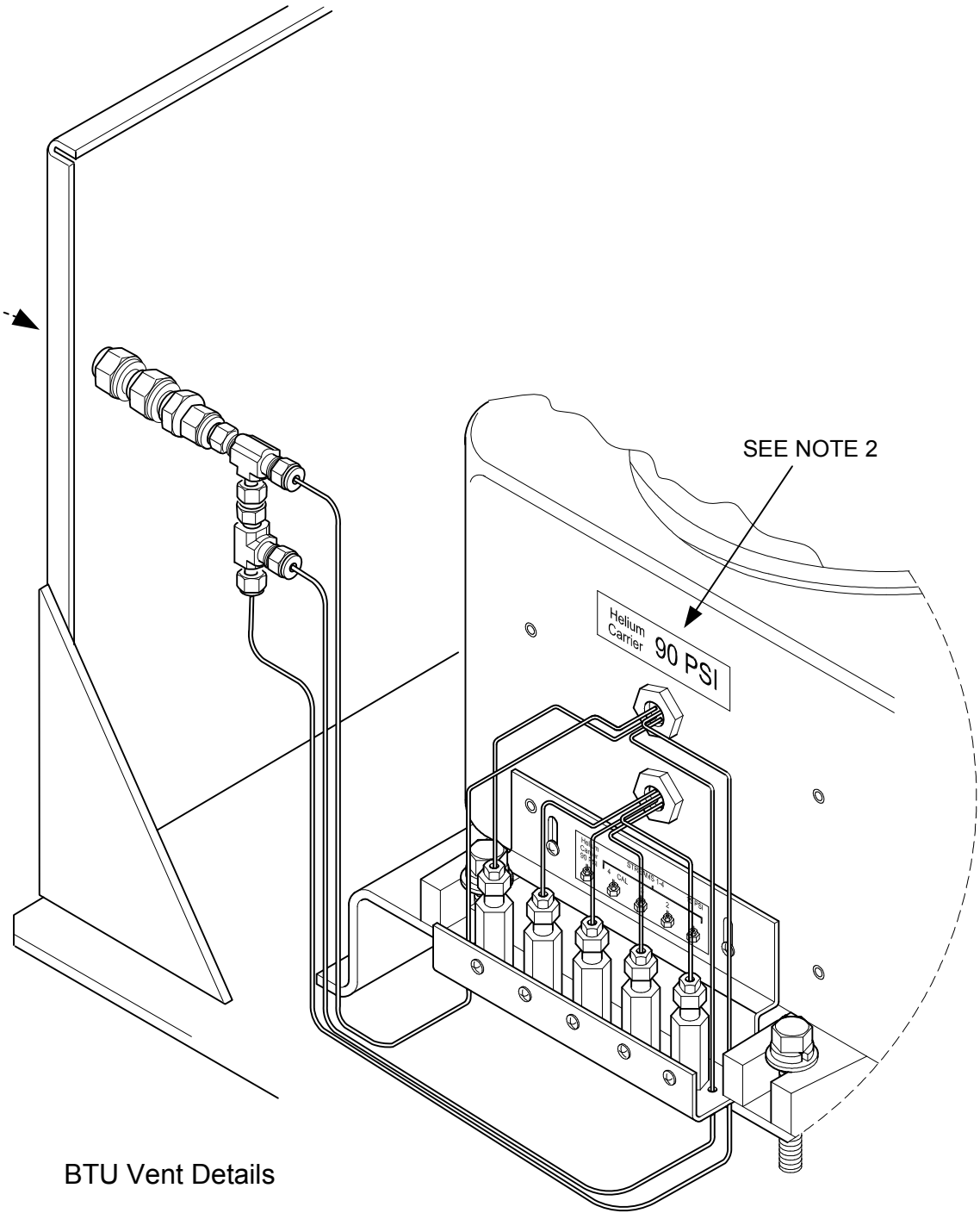

BTU Vent Details

REF: N/A

ABB	TOTALFLOW	ACTION	DOC TYPE	TITLE	DWG NO.	REV	SHEET
	Products	L19638	UD	MOBIL MOUNT FOR BTU TRANSMITTER TUBING AND POWER DIAGRAMS	2103079	AA	5 OF 7

NOTES:

1. WARNING: This drawing does not illustrate completely the installation methods required for hazardous locations. Prior to any installation in a Classified Hazardous Location, verify installation methods by the Control Drawing referenced on the product's name tag and national and local codes.

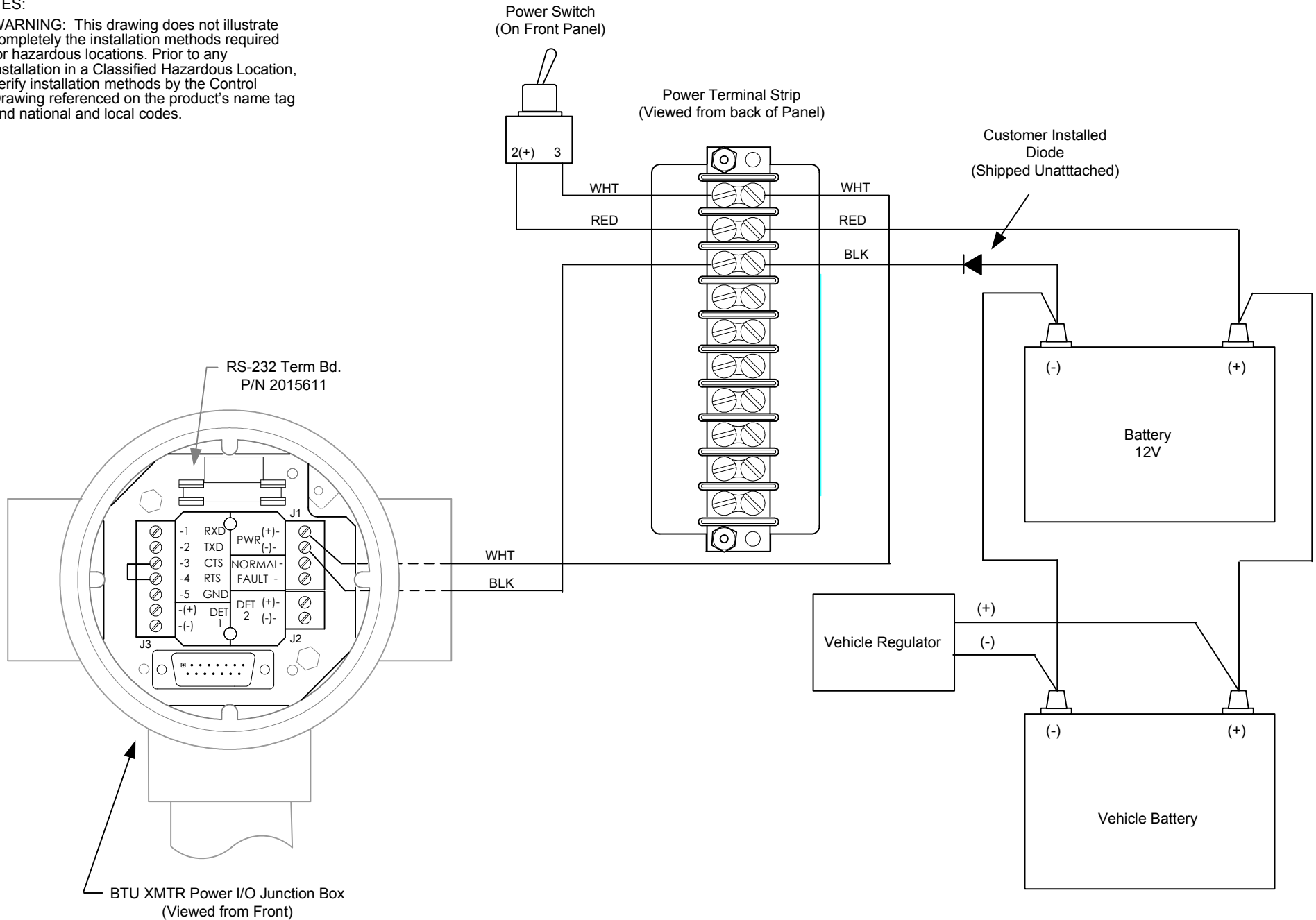

BTU Power Wiring

REF:N/A

ABB	TOTALFLOW Products	ACTION	DOC TYPE	TITLE	DWG NO.	REV	SHEET
		L19638	UD	MOBIL MOUNT FOR BTU TRANSMITTER TUBING AND POWER DIAGRAMS	2103079	AA	6 OF 7

NOTES:

1. WARNING: This drawing does not illustrate completely the installation methods required for hazardous locations. Prior to any installation in a Classified Hazardous Location, verify installation methods by the Control Drawing referenced on the product's name tag and national and local codes.

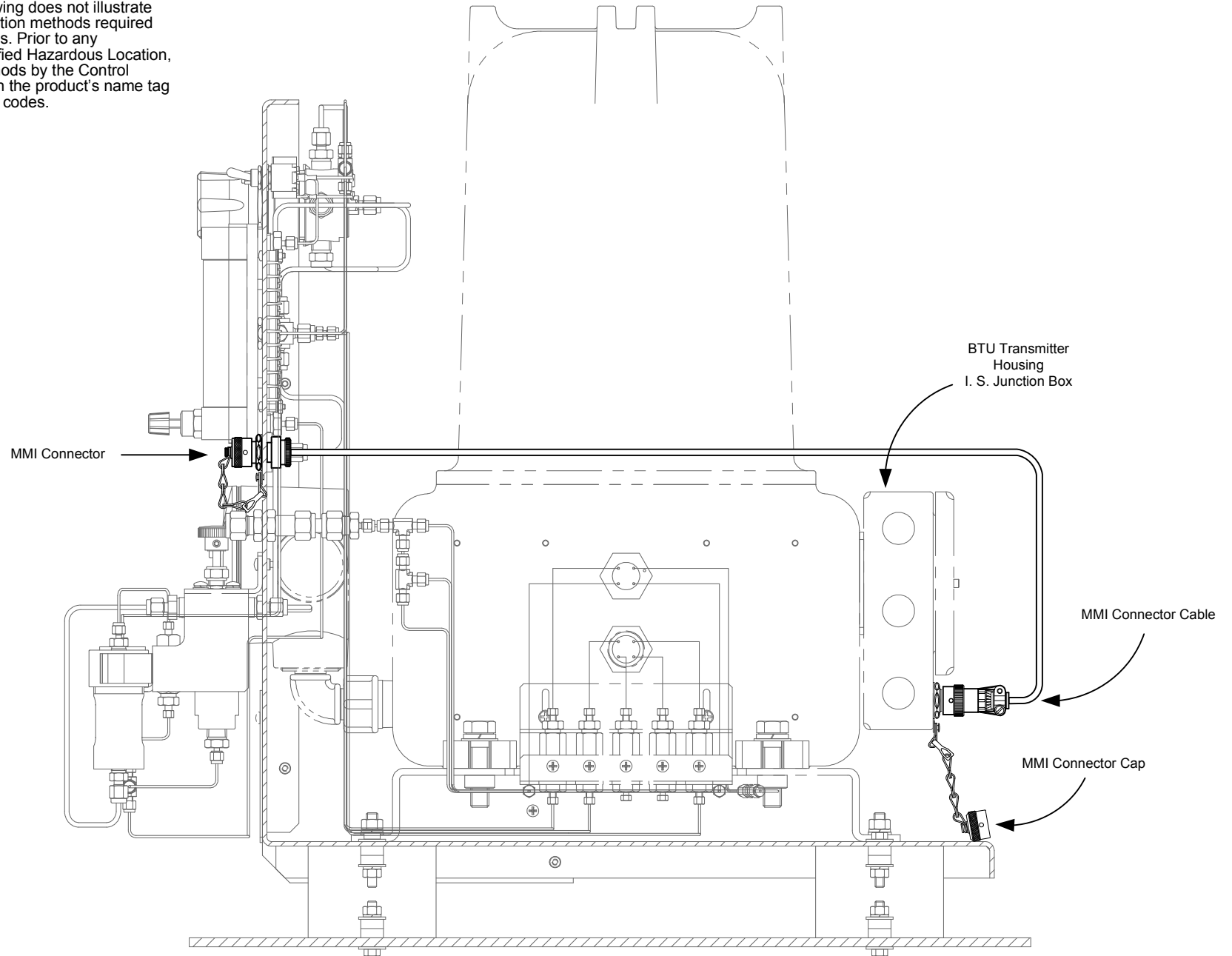

MMI Connector Cable to the BTU

REF:N/A

	TOTALFLOW	ACTION	DOC TYPE	TITLE	DWG NO.	REV	SHEET
	Products	L19638	UD	MOBIL MOUNT FOR BTU TRANSMITTER TUBING AND POWER DIAGRAMS	2103079	AA	7 OF 7