

---

 TECHNICAL DATA SHEET

# PMA Automation - BTK - Ball joint sleeve

## PMA

**Applications:**

- This ball joint sleeve is used in BSH tube clamps for gliding and guiding PMA conduits

**Features & Benefits:**

- Increased degree of freedom for cable packs
- The ball joint offers additional flexibility and reduces mechanical stress on the conduit
- Can be used with strain relief insert TR to fix the conduit in axial direction
- Easy to install and exchange

**Materials:**

- High-grade, specially formulated polyamide 6

**Compatible with:**

- PMA Automation BSH Tube clamp
- PMAFLEX Pro Conduits
- PMAFLEX Multilayer Conduits
- PMAFLEX Conduits

**Weathering resistance:**

- Very good UV resistance and weathering characteristics

**Colour:**

- Black

**Chemical properties:**

- Please refer to [www.pma.ch](http://www.pma.ch) (Technical Information / Chemical Resistance)

**Environmental properties:**

- Free from halogens and cadmium
- RoHS and REACH compliant

**Product selection:**

Part no.	Conduit size	Dimensions in mm (nom.)			Weight	Packing unit
function: glide      function: strain relief	NW	B	D	PT screws	kg/100 pcs	pcs/PU
-                      BTK-R70 + BTR-R70G + BGN-R56G/70G	56	138.5	121.0	KA 50x20	25.5	1
BTK-R70              BTK-R70 + BTR-R70G	70	138.5	121.0	KA 50x20	22.1	1

Our customer service dept. or local distribution partner will be pleased to help you concerning product availability and lead time

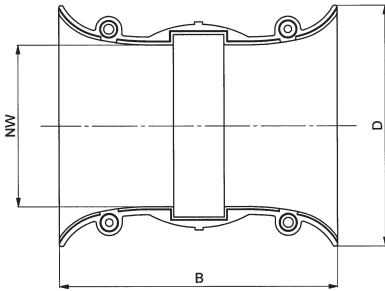
**Product selection:**

Part no.	Conduit size	Dimensions in mm (nom.)		Weight	Packing unit
function: glide	NW	B	D	kg/100 pcs	pcs/PU
BTR-R70G	70	24.5	91.0	4.2	10

Our customer service dept. or local distribution partner will be pleased to help you concerning product availability and lead time

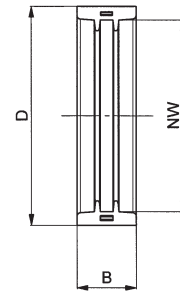

Mechanical Properties:	Value:	Test parameters:	Test method:
Tensile modulus	1'200 ... 3'700 N/mm <sup>2</sup>		ISO 527
Tensile strength	45 ... 65 N/mm <sup>2</sup>		ISO 527
Notched bar impact test	4 ... 20 kJ/m <sup>2</sup>		ISO 180/1C
Vibration and shock standard	Cat. 2		IEC 61373, IEC 60068-2-27 / -64

Thermal properties:	Value:	Test parameters:	Test method:
Continuous application temperature	-50 ... +105°C		PMA DO 9.21-4510
Upper application temperature	+120°C	(20'000 h)	PMA DO 9.21-4360
Short-term	+160°C	(168 h)	PMA DO 9.21-4360

**Content of delivery:**

- Depending on the combination

ABB Switzerland Ltd,  
PMA Cable Protection  
Aathalstrasse 90  
8610 Uster, Switzerland  
Phone: +41 58 585 00 11  
pma-info@ch.abb.com  
www.pma.ch

Let's write the future.  
Together. **abb.com**

We reserve the right to make technical changes or modify the contents of this document without prior notice. With regard to purchase orders, the agreed particulars shall prevail. ABB Installation Products Inc. does not accept any responsibility whatsoever for potential errors or possible lack of information in this document.

We reserve all rights in this document and in the subject matter and illustrations contained therein. Any reproduction, disclosure to third parties or utilization of its contents – in whole or in parts – is forbidden without prior written consent of ABB Inc. Copyright© 2019 ABB Installation Products Inc. All rights reserved



---

ABB Switzerland Ltd,  
PMA Cable Protection  
Aathalstrasse 90  
8610 Uster, Switzerland  
Phone: +41 58 585 00 11  
pma-info@ch.abb.com  
www.pma.ch

Let's write the future.  
Together. **abb.com**

---

We reserve the right to make technical changes or modify the contents of this document without prior notice. With regard to purchase orders, the agreed particulars shall prevail. ABB Installation Products Inc. does not accept any responsibility whatsoever for potential errors or possible lack of information in this document.

We reserve all rights in this document and in the subject matter and illustrations contained therein. Any reproduction, disclosure to third parties or utilization of its contents – in whole or in parts – is forbidden without prior written consent of ABB Inc. Copyright© 2019 ABB Installation Products Inc. All rights reserved

