

Installation and Instruction Manual For DODGE® TORQUE-ARM II™ Metric Cooling Fan Assemblies

TA4207CF-M

TA5215CF-M

TA6307CF-M

TA7315CF-M

TA8407CF-M

TA9415CF-M

TA10507CF-M

TA12608CF-M

These instructions must be read thoroughly before installing or operating this product.

WARNING: To ensure that drive is not unexpectedly started, turn off and lock out or tag power source before proceeding. Remove all external loads from drive before removing or servicing drive or accessories. Failure to observe these precautions could result in bodily injury.

COOLING FAN INSTALLATION

Unpack all components and inspect for shipping damage. Do not use any component that has been damaged or modified. Make sure all components are clean and free of any foreign material prior to assembly. Cooling fan assembly is designed to fit onto the input shaft before placement of sheaves or belt guard assembly.

Installation for TA4207CFM and TA5215CFM:

1. Referring to Figure 2, install tapered bushing (9) into bore of fan blade assembly (2) and loosely install the two set screws provided with fan. Snug set screws but do not tighten at this time.
2. Slide fan assembly onto input shaft and install input shaft key.

NOTE: Key is supplied with the TAIL reducer.

3. Locate fan blade edge distance "A" (Figure 1) from end of shaft per Table 1. Make sure fan assembly rotates without interference when input shaft is rotated.
4. Alternately tighten the set screws until fan assembly is securely installed on the input shaft.
5. Recheck fan assembly for proper location and clearance. Loosen set screws and repeat steps 2 and 3 above if not properly located.
6. Tighten set screws to the recommended torque value given in Table 1.

WARNING: Because of the possible danger to person(s) or property from accidents which may result from the improper use of products, it is important that correct procedures be followed. Products must be used in accordance with the engineering information specified in the catalog. Proper installation, maintenance and operation procedures must be observed. The instructions in the instruction manuals must be followed. Inspections should be made as necessary to assure safe operation under prevailing conditions. Proper guards and other suitable safety devices or procedures, as may be desirable, or as may be specified in safety codes should be provided, and are neither provided by Baldor Electric Company, nor are the responsibility of Baldor Electric Company. This unit and its associated equipment must be installed, adjusted and maintained by qualified personnel who are familiar with the construction and operation of all equipment in the system and the potential hazards involved. When risks to persons or property may be involved, a holding device must be an integral part of the driven equipment beyond the speed reducer output shaft.

Installation for TA6307CFM through TA12608CFM:

1. Referring to Figure 2, install fan guard back plate assembly (1) using the four bolts (4) provided. Tighten to recommended torque in Table 1.

CAUTION: Fan guard screen has sharp edges. Use caution when installing to avoid lacerations.

2. Slide fan blade assembly (2) onto input shaft and install key and set screws (5).

NOTE: Key is supplied with the TAIL reducer.

3. Position fan blade edge distance "A" (Figure 1) from end of shaft per Table 1. Make sure fan assembly rotates without interference when input shaft is rotated. Tighten the two fan blade set screws (5) to the recommended torque value given in Table 1.
4. Install fan guard cover (3) with four bolts (6), lockwashers (7), and hex nuts (8). Tighten bolts to the recommended torque value given in Table 1.
5. Verify fan blade rotates freely and does not interfere with fan guard back plate (1) or fan guard cover (3). Adjust fan blade if necessary.

Table 1 - Dimensions and Bolt Torque

Reducer Size	Dim."A" mm	Torque (Nm)
TA4207HM	95.25	19 - 22
TA5215HM	117.5	19 - 22
TA6307HM	108	40 - 45
TA7315HM	111	40 - 45
TA8407HM	128.5	40 - 45
TA9415HM	158	40 - 45
TA10507HM	158.75	40 - 45
TA12608HM	163.5	40 - 45

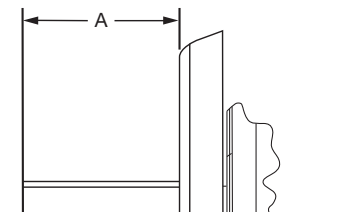

TYPICAL FOR REDUCER SIZES 4 AND 5

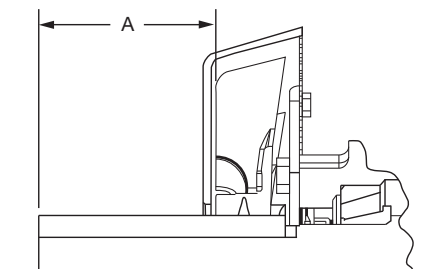

TYPICAL FOR REDUCER SIZES 6 THRU 12

BALDOR • DODGE®

Figure 1 - Fan Blade Replacement

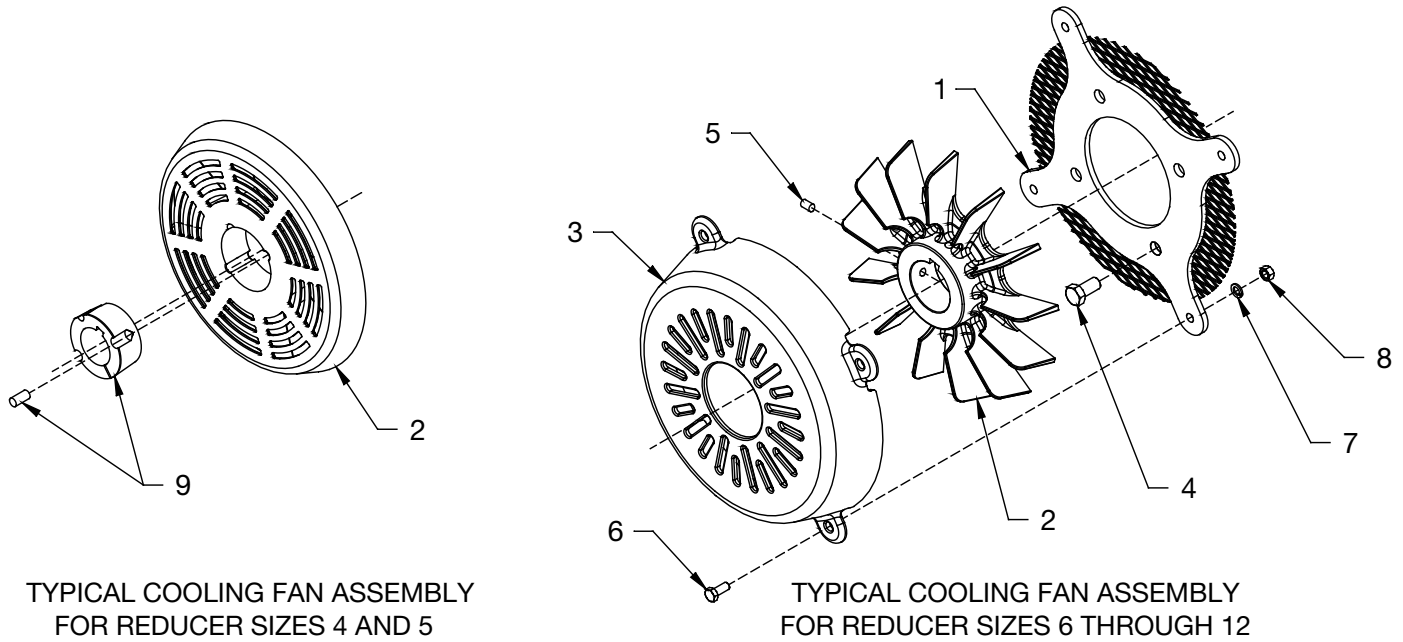

Figure 2 - Parts Identification

Table 2 - Cooling Fan Part Numbers

Description	Ref. Number	Quantity	TA4207HM	TA5215HM	TA6307HM	TA7315HM	TA8407HM	TA9415HM	TA10507HM	TA12608HM
Cooling Fan Assembly ①	-----	1	904107	905107	906107	907107	907107	909107	910107	912107
Fan Guard Plate Assembly ②	1	1	-----	-----	906519	906519	906519	909519	909519	912519
Fan Blade ②	2	1	904517	905517	906528	907528	907528	909528	910528	910528
Fan Guard Cover ②	3	1	-----	-----	906521	906521	906521	909521	909521	909521
Mounting Bolt ②	4	4	-----	-----	411294	411294	411294	411294	411294	411294
Fan Set Screw ②	5	2	-----	-----	299812	299812	299812	299812	299812	299812
Cover Bolt ②	6	4	-----	-----	304519	304519	304519	304519	304519	304519
Lockwasher ②	7	4	-----	-----	304602	304602	304602	304602	304602	304602
Hex Nut ②	8	4	-----	-----	901247	901247	901247	901247	901247	901247
Taper Bushing Assembly ② ③	9	1	119604	119615	-----	-----	-----	-----	-----	-----

① Assembly includes parts listed below

② Included in Cooling Fan Assembly

③ Set screws are included with taper bushing assembly

BALDOR
A MEMBER OF THE ABB GROUP

P.O. Box 2400, Fort Smith, AR 72902-2400 U.S.A., Ph: (1) 479.646.4711, Fax (1) 479.648.5792, International Fax (1) 479.648.5895

Dodge Product Support

6040 Ponders Court, Greenville, SC 29615-4617 U.S.A., Ph: (1) 864.297.4800, Fax: (1) 864.281.2433

www.baldor.com

