

FurseWELD

Bar to earth rod BR7

Bar to earth rod BR7 - FurseWELD

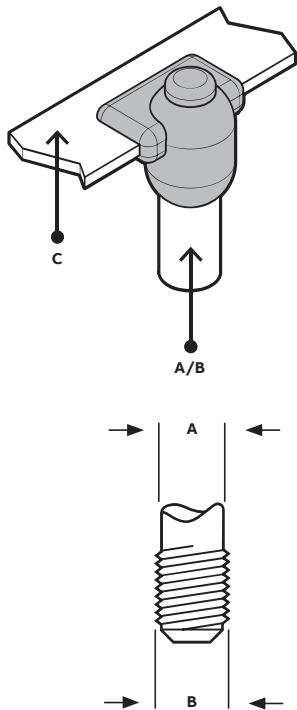

Earth rod A ø (mm)	Earth rod B ø (")	Flat tape conductor size C (mm)	Mould part no.	Order code	Powder cartridge part no.	Handle clamp part no.
14.2	5/8	25 x 3	BR7-4-142253	7TCA083910R0472	90P10	HCPK4
14.2	5/8	25 x 4	BR7-4-142254	7TCA083910R0473	115P10	HCPK4
14.2	5/8	25 x 6	BR7-4-142256	7TCA083910R2427	115P10	HCPK4
14.2	5/8	30 x 2	BR7-4-142302	7TCA083910R2934	115P10	HCPK4
14.2	5/8	30 x 3	BR7-4-142303	7TCA083910R2935	115P10	HCPK4
14.2	5/8	30 x 4	BR7-4-142304	7TCA083910R0474	150P10	HCPK4
14.2	5/8	30 x 5	BR7-4-142305	7TCA083910R2575	150P10	HCPK4
14.2	5/8	38 x 5	BR7-4-142385	7TCA083910R2937	150P10	HCPK4
14.2	5/8	38 x 6	BR7-4-142386	7TCA083910R2938	200P10	HCPK4
14.2	5/8	40 x 3	BR7-4-142403	7TCA083910R2939	115P10	HCPK4
14.2	5/8	40 x 4	BR7-4-142404	7TCA083910R2260	150P10	HCPK4
14.2	5/8	40 x 5	BR7-4-142405	7TCA083910R2940	150P10	HCPK4
14.2	5/8	40 x 6	BR7-4-142406	7TCA083910R2911	200P10	HCPK4
14.2	5/8	50 x 3	BR7-4-142503	7TCA083910R0475	150P10	HCPK4
14.2	5/8	50 x 4	BR7-4-142504	7TCA083910R0476	200P10	HCPK4
14.2	5/8	50 x 5	BR7-4-142505	7TCA083910R2941	200P10	HCPK4
14.2	5/8	50 x 6	BR7-4-142506	7TCA083910R2358	200P10	HCPK4

Suitable for connections to copperbond rods - for connections to solid copper and stainless steel rods please contact our sales office

Threaded portion of copperbond rods must be removed prior to welding

Special moulds for all FurseWELD products can be manufactured to meet specific customer applications on request

For order codes of powder cartridges and handle clamps, see pages 49-50

FurseWELD moulds should only be used with FurseWELD powders, handle clamps and accessories. If moulds, powders, handle clamps and accessories from other manufacturers are utilized, we cannot guarantee the safe use or the integrity of the completed joint

Conductors must be installed in the orientation shown to achieve the correct connection

FurseWELD

Bar to earth rod BR7

Bar to earth rod BR7 (continued) - FurseWELD

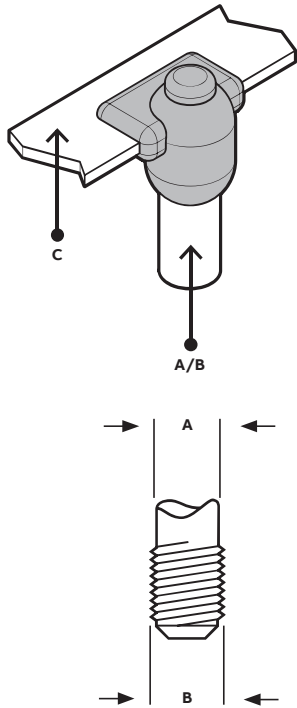

Earth rod A ø (mm)	Earth rod B ø (")	Flat tape conductor size C (mm)	Mould part no.	Order code	Powder cartridge part no.	Handle clamp part no.
17.2	3/4	25 x 3	BR7-4-172253	7TCA083910R2719	150P10	HCPK4
17.2	3/4	25 x 4	BR7-4-172254	7TCA083910R2341	150P10	HCPK4
17.2	3/4	25 x 6	BR7-4-172256	7TCA083910R2943	200P10	HCPK4
17.2	3/4	30 x 2	BR7-4-172302	7TCA083910R0480	150P10	HCPK4
17.2	3/4	30 x 3	BR7-4-172303	7TCA083910R2944	150P10	HCPK4
17.2	3/4	30 x 4	BR7-4-172304	7TCA083910R2945	250P10	HCPK4
17.2	3/4	30 x 5	BR7-4-172305	7TCA083910R2576	200P10	HCPK4
17.2	3/4	38 x 5	BR7-4-172385	7TCA083910R2946	200P10	HCPK4
17.2	3/4	38 x 6	BR7-5-172386	7TCA083910R2947	250P10	HCPK5
17.2	3/4	40 x 3	BR7-4-172403	7TCA083910R2543	200P10	HCPK4
17.2	3/4	40 x 4	BR7-4-172404	7TCA083910R2525	200P10	HCPK4
17.2	3/4	40 x 5	BR7-4-172405	7TCA083910R2948	200P10	HCPK4
17.2	3/4	40 x 6	BR7-5-172406	7TCA083910R2949	250P10	HCPK5
17.2	3/4	50 x 4	BR7-5-172504	7TCA083910R3026	250P10	HCPK5
17.2	3/4	50 x 5	BR7-5-172505	7TCA083910R3027	2 x 150P10	HCPK5
17.2	3/4	50 x 6	BR7-5-172506	7TCA083910R2298	2 x 200P10	HCPK5

Suitable for connections to copperbond rods - for connections to solid copper and stainless steel rods please contact our sales office

Threaded portion of copperbond rods must be removed prior to welding

Special moulds for all FurseWELD products can be manufactured to meet specific customer applications on request

For order codes of powder cartridges and handle clamps, see pages 49-50

FurseWELD moulds should only be used with FurseWELD powders, handle clamps and accessories. If moulds, powders, handle clamps and accessories from other manufacturers are utilized, we cannot guarantee the safe use or the integrity of the completed joint

Conductors must be installed in the orientation shown to achieve the correct connection