

**ABB**

2CSS200999R0001

**S2C-EST**

Base per estraibilità

Plug-in base

Embase pour disjoncteur embrochable

Base adaptadora

Stecksocket

IT: A429407  
FR: 429407

8 012542 940708

MADE IN ITALY

2CSS490003D0001

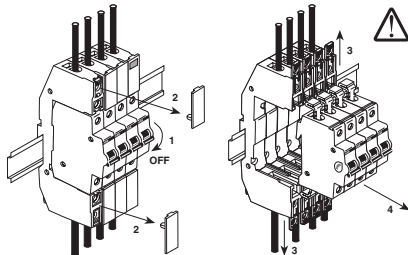
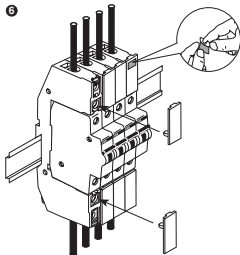
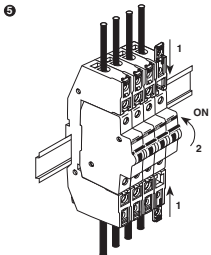
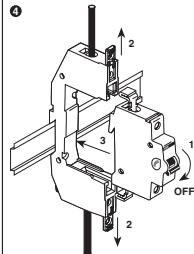
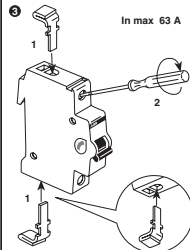
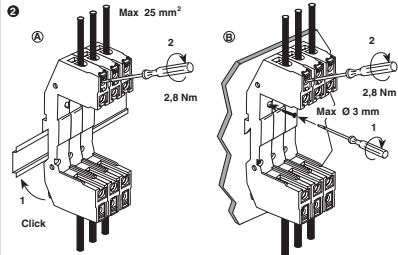
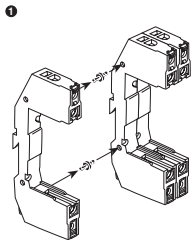

- 1** Non sezionare sotto carico.
- 2** Do not isolate under load.
- 3** Nicht unter last trennen.
- 4** Ne pas sectionner en charge.
- 5** No sectionar en carga.

