

Circuit Monitoring Systems (CMS) Installation manual CMS-600 System

1. Scope of delivery

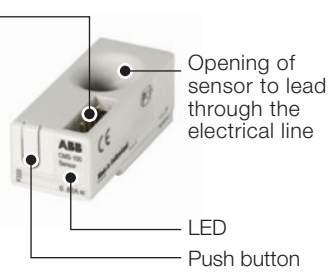

Current sensors
CMS-1xxPS,
CMS-1xxS8, CMS-1xxDR, CMS-1xxCA,
CMS-2xxS8, CMS-2xxDR, CMS-2xxCA

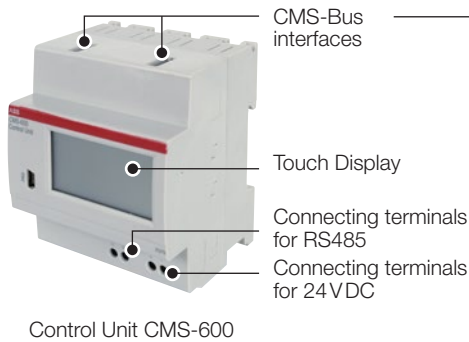

Connector set CMS-820



Flat cable
CMS-80x

2. Mounting the Control Unit

- i**
- Remove rapid fixation (RAFIX) before mounting on SMISSLINE TP



DIN-rail mounting

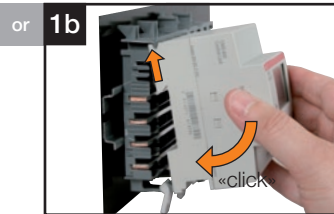

SMISSLINE TP mounting

3. Mounting the sensors

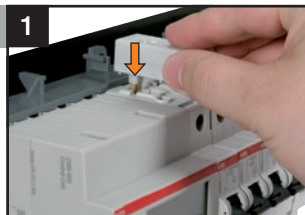

1
CMS-1xxPS:
Insert the metal pin of the sensor into the rear terminal connection



2
CMS-1xxS8, CMS-2xxS8:
Slip sensor on S800



3
CMS-1xxDR, CMS-2xxDR:
Put cable through opening of sensor into installation device. Fix the cable with a cable tie if needed.



4
CMS-1xxCA, CMS-2xxCA:
Put cable through opening of sensor into installation device. Fix the cable with a cable tie.

4. Cabling the Control Unit

- i**
- Connecting terminals for 24VDC and RS485
- max. cable cross-section 2.5 mm²
 - stripping length 13 mm
 - current consumption of Control Unit max. 1.5 A

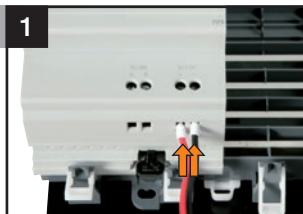

1
Insert cables into the connecting terminals



2
Tighten the screws

5. Cabling the sensors

i

- Use the connectors only once
- Connect a max. number of 32 sensors to each Control Unit CMS-Bus interface
- Consider the maximum flat cable length, see User Manual CMS-700 (2CCC481011M0201)
- The flat cable should not exert force to the sensor, otherwise measuring errors are possible
- Keep a distance of min. 5.5 mm from the flat cable to uninsulated live parts

1

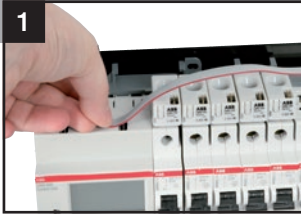

Put the flat cable onto the CMS-Bus interfaces

2



Mark the desired placement of the connectors with a pen

3

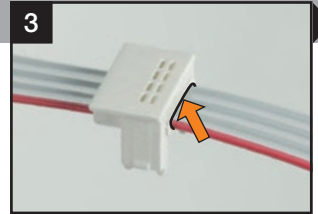

Press the flat cable into the cable duct of the connector housing

4

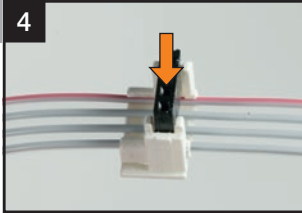

Put the connector at the position of the marking into the connector housing

5

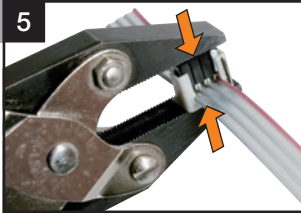

Press together the connector and the connector housing with a parallel pliers tool. Repeat that process at the other markings

6

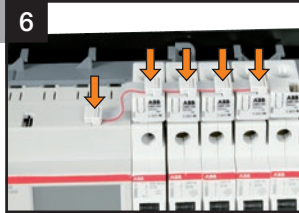

Plug the connectors to the Control Unit and the sensors

7 ✓



Plug the connectors to the sensors with the longer side to the left

6. Add sensors

i

- Connect the power supply to the Control Unit
- The LEDs of not registered sensors start to blink. If LEDs do not blink, check the cabling.

1

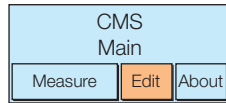

Press «Edit»

2

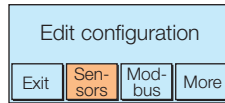

Press «Sensors»

3

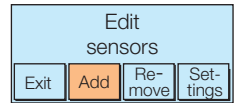

Press «Add»

4

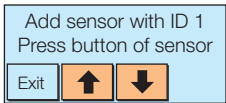

Press ↓ or ↑ until the desired sensor ID appears

5

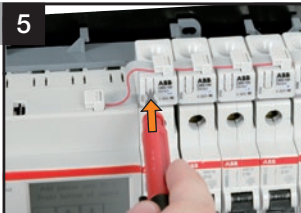

Press push button of the sensor

6



Initialized sensors light up continuously

WARNING



Failure to follow these instructions could result in death, personal injury or property damage. The device should be installed by a qualified person only. If the components or devices do not appear to be in a proper condition, they must be replaced.



Mind the instructions in the user manual

Stromkreis-Überwachungssystem (CMS) Installationsanleitung CMS-600 System

1. Lieferumfang

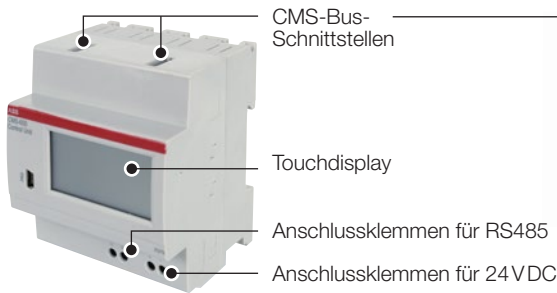

Control Unit CMS-600



Sensoren zur Strommessung
CMS-1xxPS,
CMS-1xxS8, CMS-1xxDR, CMS-1xxCA,
CMS-2xxS8, CMS-2xxDR, CMS-2xxCA

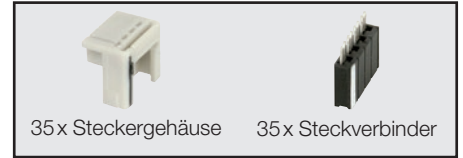

Steckerkit CMS-820



Flachbandkabel
CMS-80x

2. Montage der Control Unit

i

- Vor SMISLINE TP Montage Schnellbefestiger entfernen

1a



DIN-Schiennenmontage

oder

1b

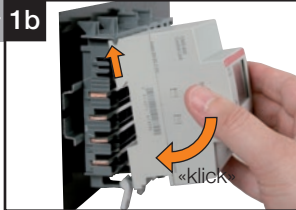

SMISLINE TP Montage

3. Montage der Sensoren

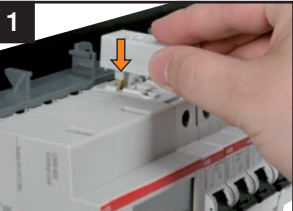

1
CMS-1xxPS:
Metallstift des Sensors in die
hintere Klemme einführen



2
CMS-1xxS8, CMS-2xxS8:
Sensor auf S800 schieben



3
CMS-1xxDR, CMS-2xxDR:
Kabel durch die Öffnung in das
Gerät einführen.
Bei Bedarf die Leitung mit
Kabelbinder fixieren.



4
CMS-1xxCA, CMS-2xxCA:
Kabel durch die Öffnung des
Sensors einführen. Sensor mit
Kabelbinder an Kabel befestigen.

4. Verkabelung der Control Unit

i

- Anschlussklemmen 24VDC
und RS485
- Kabelquerschnitt max.
2,5 mm²
 - Abisolierlänge 13 mm
 - Stromaufnahme Control Unit
max. 1,5A

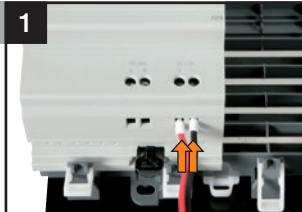

1
Abisoliertes Anschlusskabel in die
Klemmen einführen



2
Anschlussklemmen festziehen

5. Verkabelung der Sensoren

i

- Steckverbinder dürfen nur einmal verwendet werden
- Maximal 32 Sensoren je Control Unit CMS-Bus-Schnittstelle anschliessen
- Maximale Länge des Flachbandkabels beachten, siehe Bedienungsanleitung CMS-700 (2CCC481011M0101)
- Das Flachbandkabel darf keine Zugkräfte auf Sensoren ausüben, sonst Messabweichungen möglich

1

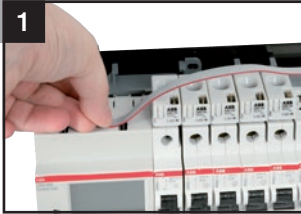

Flachbandkabel auf CMS-Bus-Schnittstelle halten

- Luftdistanz von min. 5,5 mm vom Flachbandkabel zu blanken spannungsführenden Teilen einhalten

2



Platzierung der Steckverbinder mit Stift markieren

3

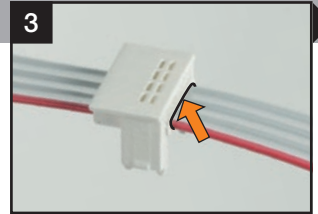

Flachbandkabel in Steckergehäuse einlegen und ganz in Kabelführung drücken

4

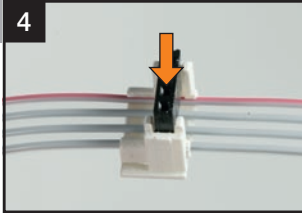

Steckverbinder an Markierung in Steckergehäuse einlegen

5

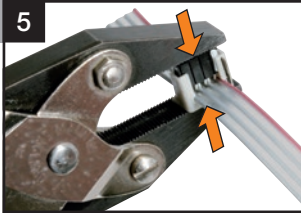

Steckverbinder und Steckergehäuse mit Parallellzange anpressen bis die Teile bündig sind. Vorgang bei allen Markierungen wiederholen

6

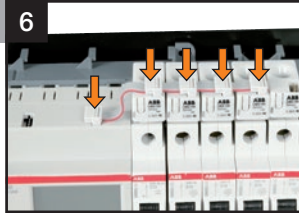

Steckverbinder an Control Unit und Sensoren anschliessen

7 ✓



Steckverbinder an den Sensoren mit längerer Seite nach links montieren

6. Sensoren anmelden

i

- Spannungsversorgung für Control Unit herstellen
- LEDs der nicht angemeldeten Sensoren beginnen zu blinken. Wenn LEDs nicht blinken, die Verkabelung prüfen.

1

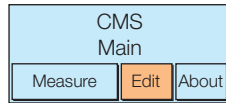

«Edit» drücken

2

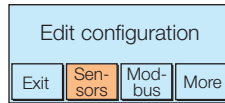

«Sensors» drücken

3

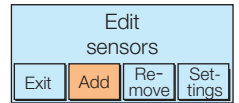

«Add» drücken

4

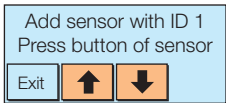

↓ oder ↑ drücken, bis gewünschte ID-Nummer erscheint

5

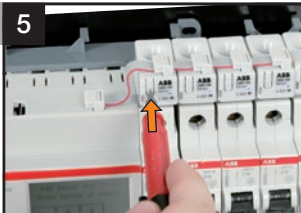

Drucktaster am Sensor betätigen

6



Angemeldete Sensoren leuchten permanent

WARNUNG



Nichtbefolgung dieser Hinweise kann zu tödlichen Verletzungen oder zu Sachschäden führen. Das Gerät darf nur von einer qualifizierten Person installiert werden. Wenn augenscheinlich an Komponenten bzw. Geräten ein nicht ordnungsgemässer Zustand vorliegt, sind diese auszutauschen.



Bitte Hinweise in der Bedienungsanleitung beachten