

CONNECTIONS FOR E1.2 WITHDRAWABLE 1000A/1250A/1600A

SPEP P = 900mm
 BUSBARS HOLDER PBHB3121 (100mm)
 MAIN BUSBAR IP40 / IP41 / IP65 : 4000A (3x120x10)

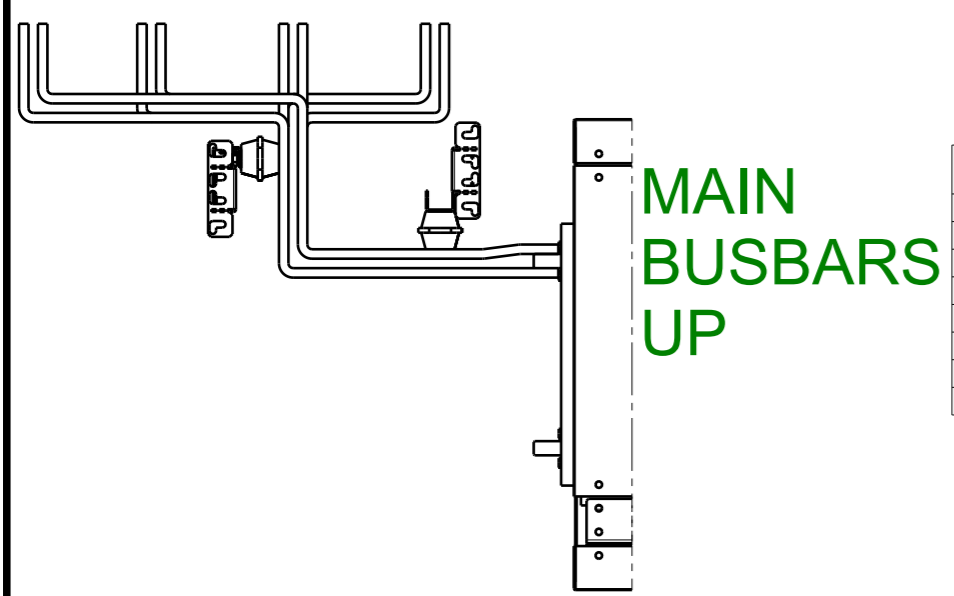

**MAIN
BUSBARS
UP**

	B	E
L3.1	268.5	125
L3.2	248.5	105
L2.1	268.5	125
L2.2	248.5	105
L1.1	268.5	125
L1.2	248.5	105
N.1	268.5	125
N.2	248.5	105

PHASE	POS	A	C	D	
L3	1	L3.1	295.5	84.25	160
	2	L3.2	275.5	104.25	160
L2	1	L2.1	295.5	-	-
	2	L2.2	275.5	-	-
L1	1	L1.1	295.5	104.25	160
	2	L1.2	275.5	84.25	160
N	1	N.1	295.5	104.25	285
	2	N.2	275.5	84.25	285

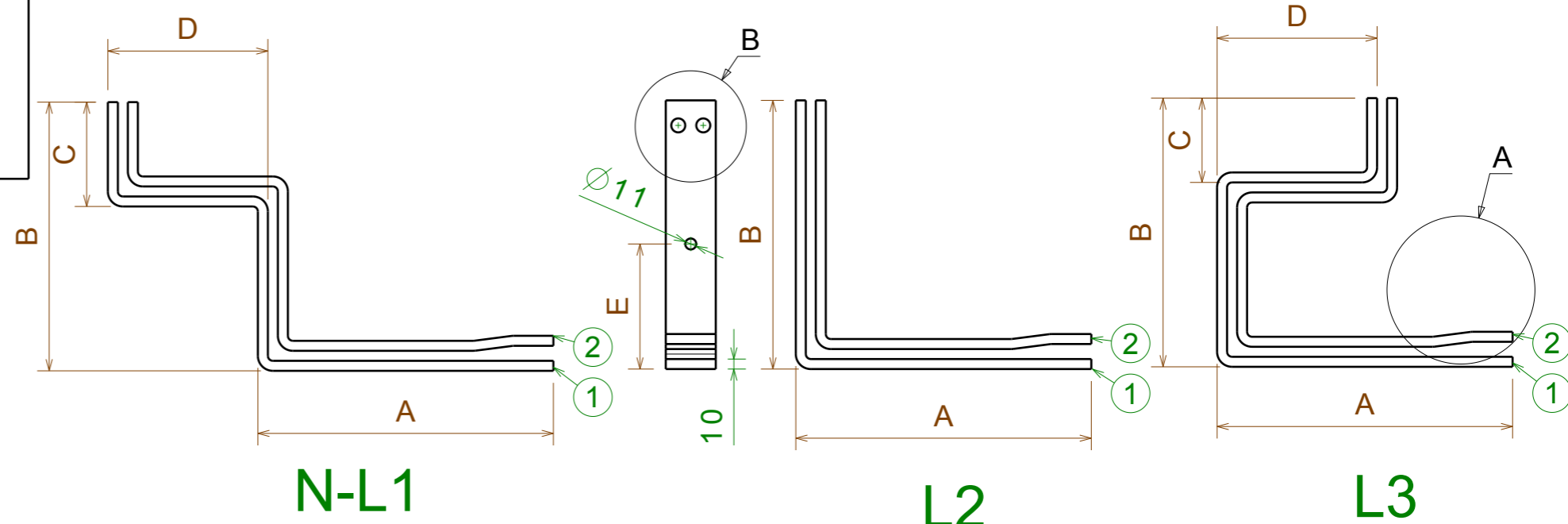

N-L1

L2

L3

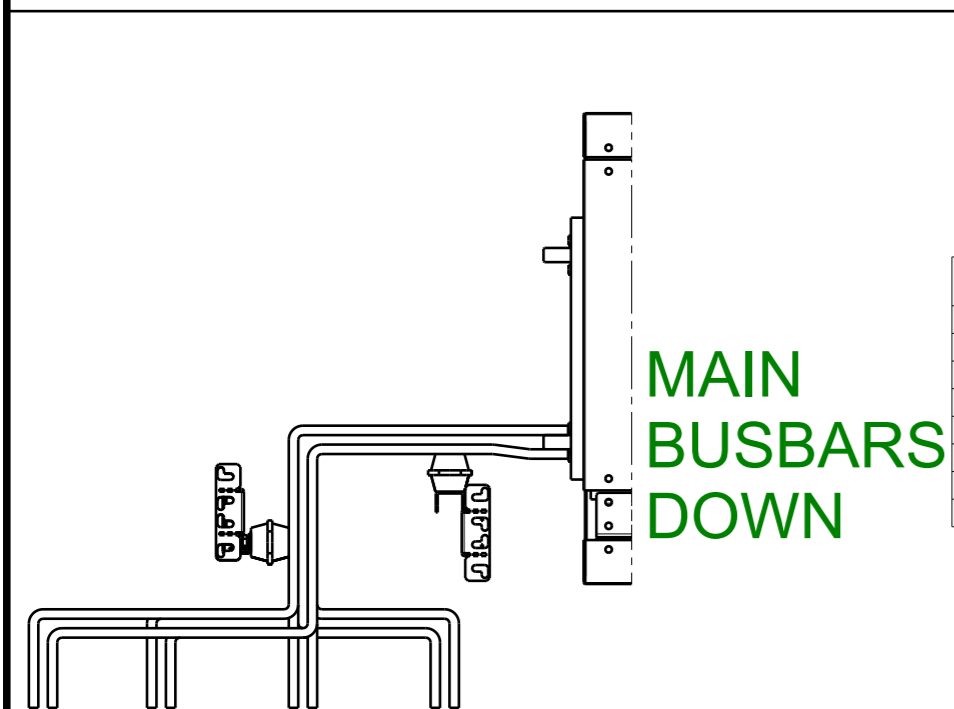

**MAIN
BUSBARS
DOWN**

	B	E
L3.1	298.5	125
L3.2	278.5	105
L2.1	298.5	125
L2.2	278.5	105
L1.1	298.5	125
L1.2	278.5	105
N.1	298.5	125
N.2	278.5	105

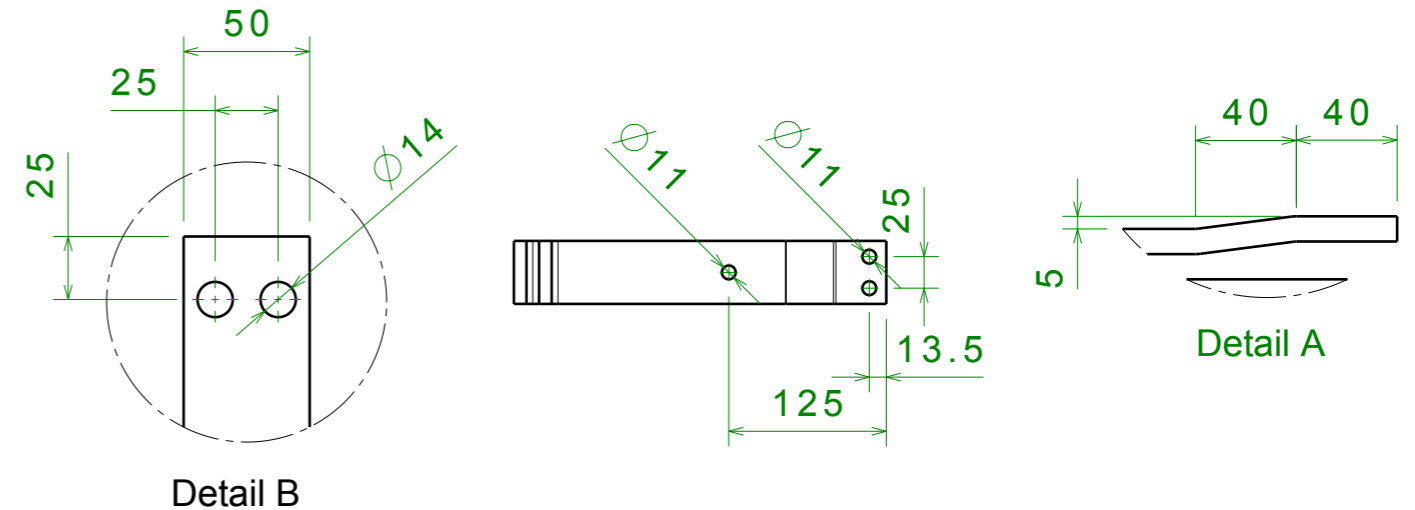

Detail B

Detail A

AGG. DI SEGNO	SCALA SCALE :	N° PROGETTO : PROJECT	XXX.XX
DESIGNER	DISEGNATORE DESIGNER :	ABB SACE ADB	
APPROVAZIONE	APPROVAZIONE APPROVAL :	DENOMINAZIONE/NAME: E1.2 1000A/1250A/1600A W CONNECTION BUSBARS 2x50x10xP	
DATE	DATA DATE : xx-xx-xx	DISEGNO N° /DRAWING N° 8 6 3 7 1 8	
FORMATO	FORMATO FORMED : A3	Questo disegno e' di esclusiva proprieta' di ABB SACE ADB. Ne e' vietata la riproduzione a termini di legge	

HOLDER FOR 36<I_{cw}<=50KA

Vista isometrica
Scala: 1:8

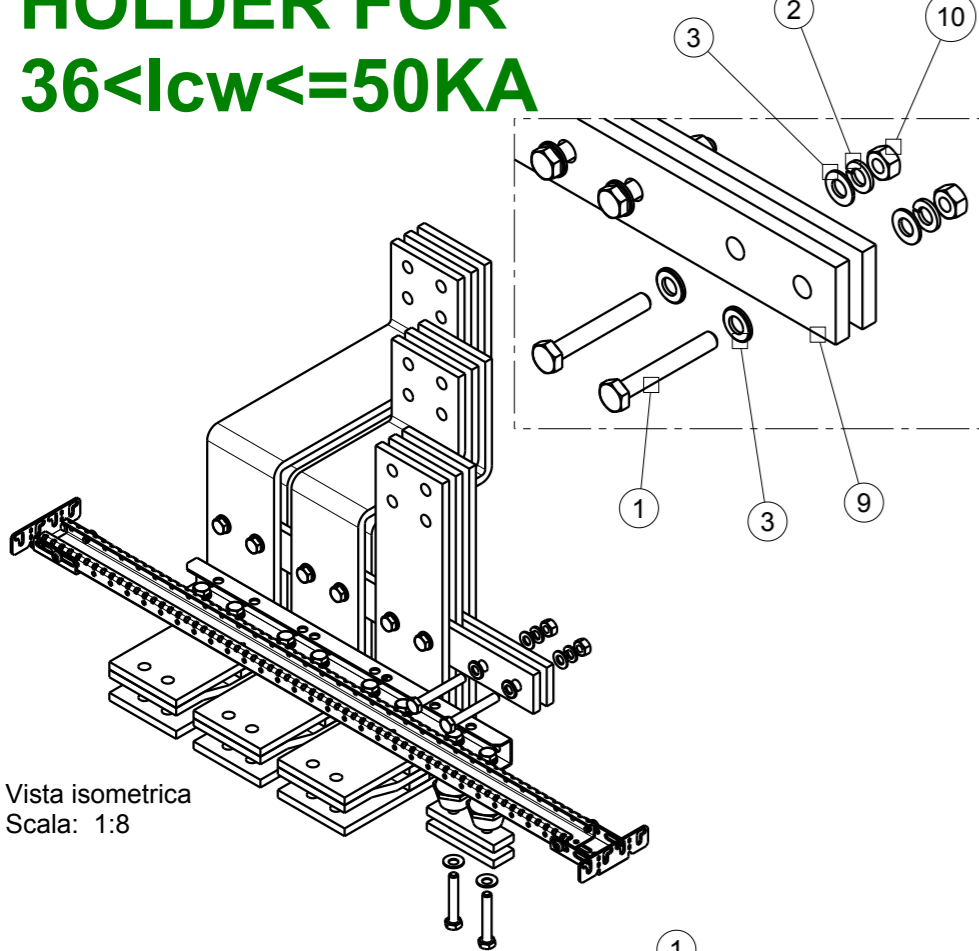

BOM 36<I_{cw}<=50KA

POS	DESCRIPTION
1	HEX CAP SCREWS M10x16 - 8.8 (VITE TESTA ESAGONALE M10x16 - 8.8)
2	FLAT WASHER M10 (RONDELLA PIANA M10)
3	SPRING LOCK WASHER M10 (ROSETTA ELASTICA GROWER M10)
4	BRACKET FOR INSULATOR (STAFFA ISOLATORI)
5	INSULATOR H40 M10 (ISOLATORI H40 M10)
6	CUPPER SPACER H10mm (SPESSORE IN RAME H10mm)
7	CONICAL SPRING WASHER M10 (ROSETTE ELASTICHE CONICHE M10)
8	HEX CAP SCREWS M10x__ - 8.8 (VITE TESTA ESAGONALE M10x__ - 8.8)
9	GPO3 PROFILE
10	NUT M10 - DADO M10

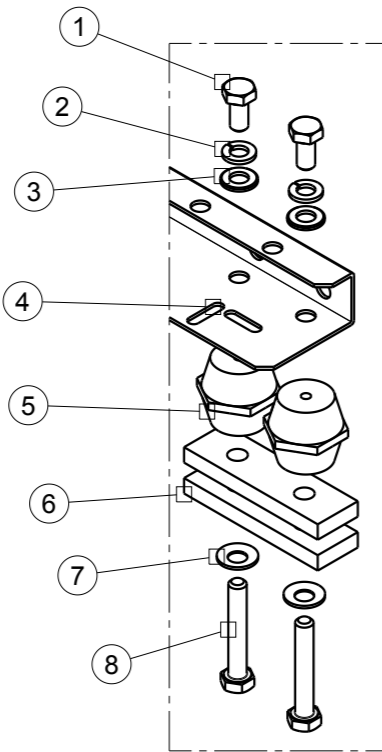

HOLDER FOR 50<I_{cw}<=75KA

Vista isometrica
Scala: 1:8

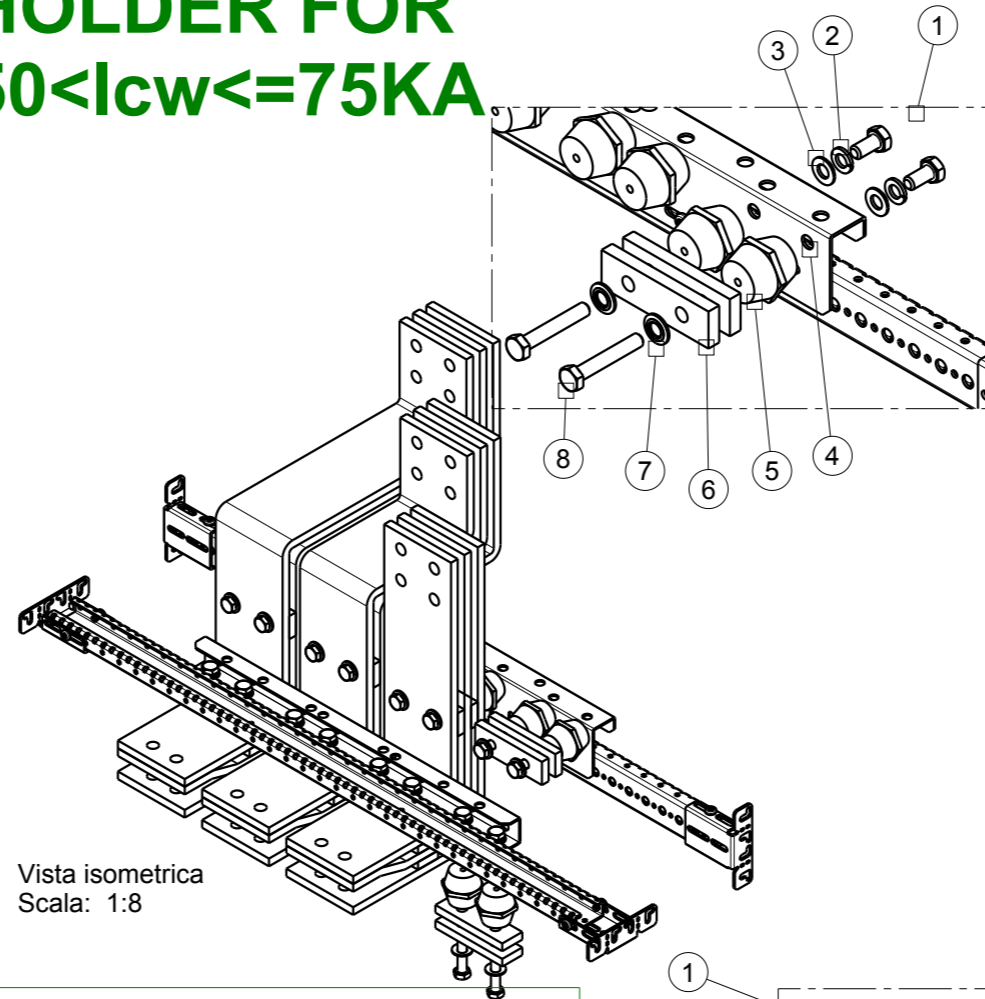

BOM 50<I_{cw}<=75KA

POS	DESCRIPTION
1	HEX CAP SCREWS M10x16 - 8.8 (VITE TESTA ESAGONALE M10x16 - 8.8)
2	FLAT WASHER M10 (RONDELLA PIANA M10)
3	SPRING LOCK WASHER M10 (ROSETTA ELASTICA GROWER M10)
4	BRACKET FOR INSULATOR (STAFFA ISOLATORI)
5	INSULATOR H40 M10 (ISOLATORI H40 M10)
6	CUPPER SPACER H10mm (SPESSORE IN RAME H10mm)
7	CONICAL SPRING WASHER M10 (ROSETTE ELASTICHE CONICHE M10)
8	HEX CAP SCREWS M10x__ - 8.8 (VITE TESTA ESAGONALE M10x__ - 8.8)
9	GPO3 PROFILE

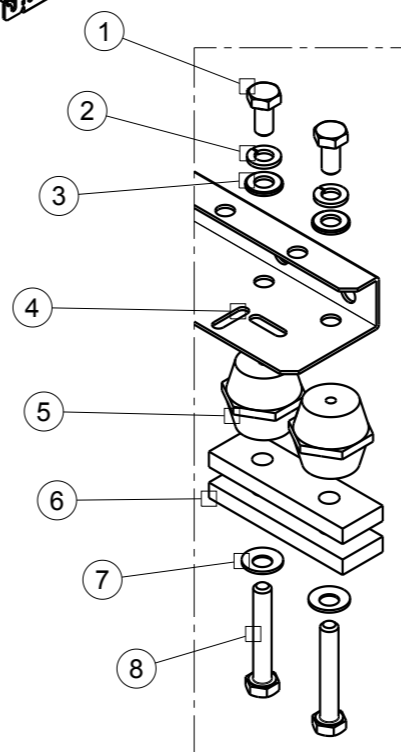

HOLDER FOR I_{cw} >75KA

Vista isometrica
Scala: 1:8

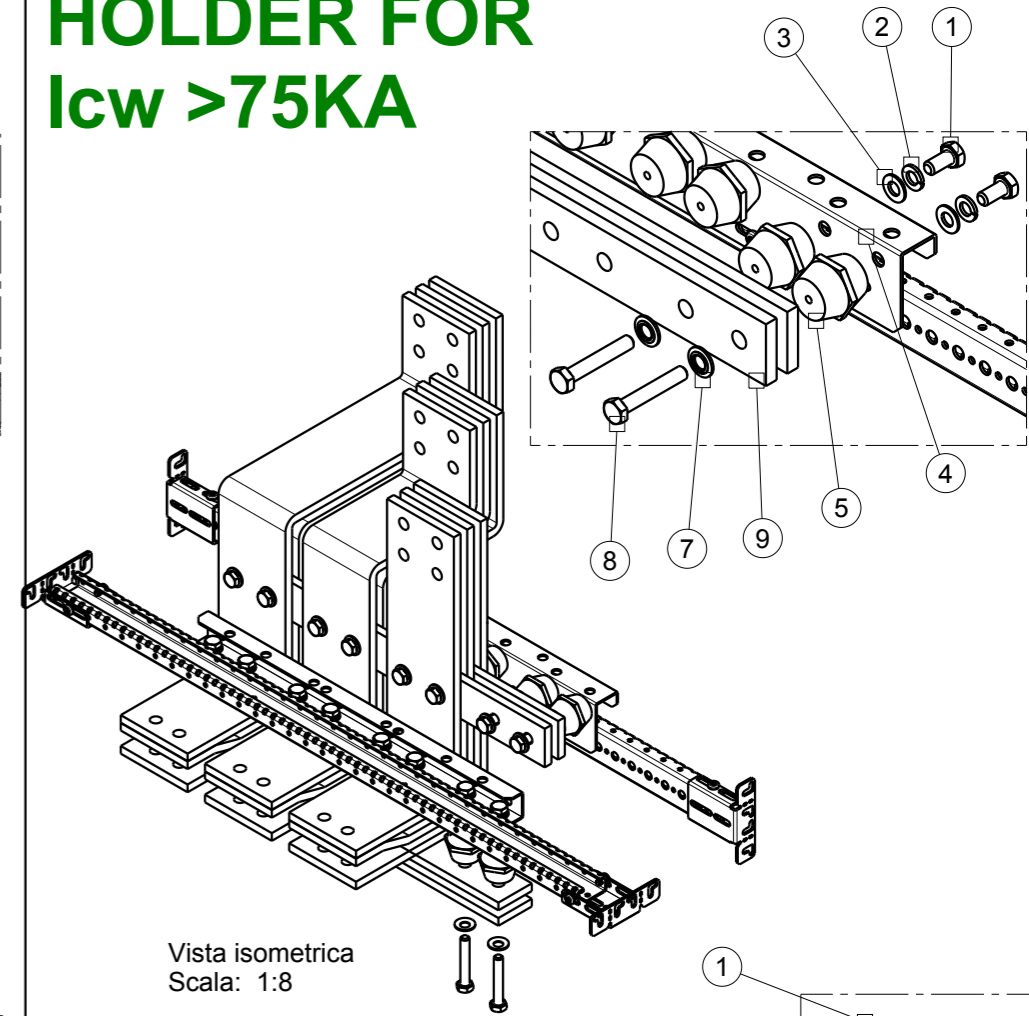

BOM I_{cw}>75KA

POS	DESCRIPTION
1	HEX CAP SCREWS M10x16 - 8.8 (VITE TESTA ESAGONALE M10x16 - 8.8)
2	FLAT WASHER M10 (RONDELLA PIANA M10)
3	SPRING LOCK WASHER M10 (ROSETTA ELASTICA GROWER M10)
4	BRACKET FOR INSULATOR (STAFFA ISOLATORI)
5	INSULATOR H40 M10 (ISOLATORI H40 M10)
6	CUPPER SPACER H10mm (SPESSORE IN RAME H10mm)
7	CONICAL SPRING WASHER M10 (ROSETTE ELASTICHE CONICHE M10)
8	HEX CAP SCREWS M10x__ - 8.8 (VITE TESTA ESAGONALE M10x__ - 8.8)
9	GPO3 PROFILE

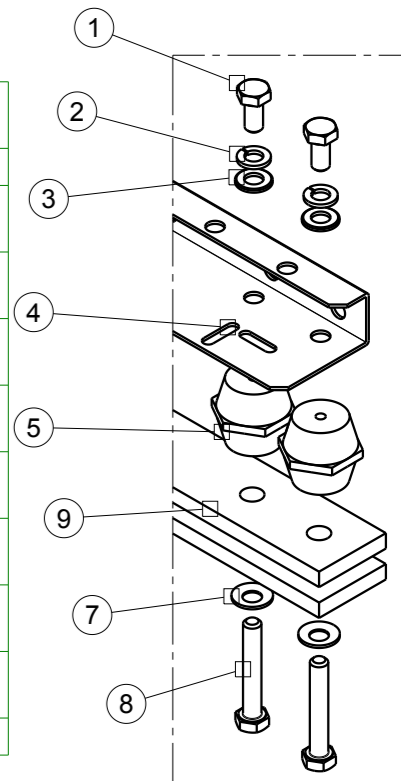

GPO3 PROFILE

E1.2 4P

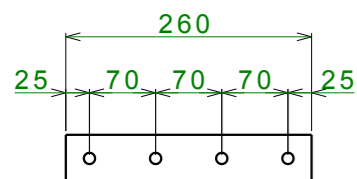

E2.2 4P

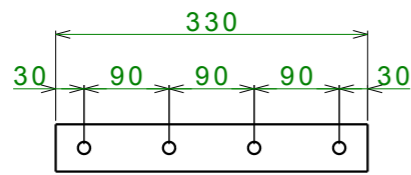

E4.2 4P

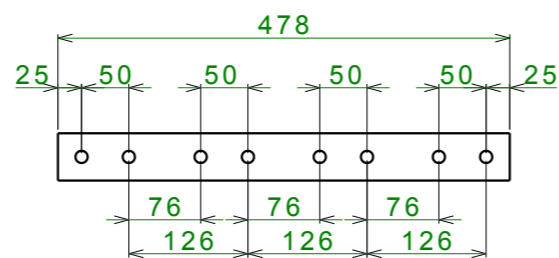

801

FIG.

DIMENSIONI / DIMENSION

PESO / WEIGHT

mm

UNITA' DI MISURA
UNITS OF MEASUREMENT

AGG. DI SEGNO DISTR. MOD.	SCALA SCALE	MAT. / MAT. :
VERSIONE VERSION	DISEGNATO DA DRAW BY	TRATT. / TREAT :
DATA DATE	APPROVAZIONE APPROVAL	PROGETTO N° : PROJECT N° : 142.00
	ABB	ABB SACE ADB
	Formato Format A3	DESCRIZIONE / DESCRIPTION: DIVERSI TIPI DI ANCORAGGIO DIFFERENT TYPES OF SUPPORT

DISEGNO N° / DRAWING N°

863877