

**S2C-A2L**  
**Arbeitsstromauslöser**  
**Shunt trip**  
 2CDS200907R0002  
 IT A649728

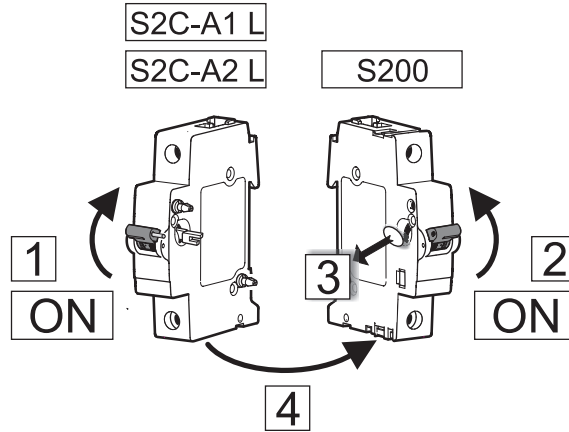

CE  
 Made in Germany



2CDC092028F0005

|         |                                  |
|---------|----------------------------------|
| S2C-A1L | 12...60 V AC/DC                  |
| S2C-A2L | 110...415 V AC<br>110...250 V DC |

|                      |                     |
|----------------------|---------------------|
| 24.8 lb-in<br>2.8 Nm | 0.49 in.<br>12.5 mm |
|----------------------|---------------------|

**ABB STOTZ-KONTAKT GmbH**  
 Eppelheimer Str. 82  
 69123 Heidelberg  
 Germany  
[www.abb.com/lowvoltage](http://www.abb.com/lowvoltage)



en Warning! Installation by person with electrotechnical expertise only.  
 de Warnung! Installation nur durch elektrotechnische Fachkraft.  
 it Avvertenza! Fare installare solo da un elettricista qualificato.  
 fr Avertissement! Installation uniquement par des personnes qualifiées en électrotechnique.  
 es ¡Advertencia! La instalación deberá ser realizada únicamente por electricistas especializados.

GHS2007016P0002

02.2016