

A41/A42/A43/A44 INSTALLATION MANUAL

ABB SpA
Via Dell'Industria, 18
20009 – Vittuone – Milano
Italy
Tel. +39 02 2415 0000
<https://new.abb.com/low-voltage>

2CMC484004M0201 February 2021 Rev C

© Copyright 2021 ABB SpA. All rights reserved.
Specification subject to change without notice.

Warning! Installation by person with electrotechnical expertise only.

Warnung! Installation nur durch elektrotechnische Fachkraft.

Avertenci! Fare installare solo da un elettricista qualificato.



Avertissement! Installation uniquement par des personnes qualifiées en électrotechnique.

Advertencia! La instalación deberá ser realizada únicamente por electricistas especializados.



Utilization category as of IEC 62052-31
A41 and A43: UC2
A42 and A44: UC1

Working with high voltage is potentially lethal. Persons subjected to high voltage may suffer cardiac arrest, burn injuries, or other severe injuries. To avoid such injuries, make sure to disconnect the power supply before you start the installation.

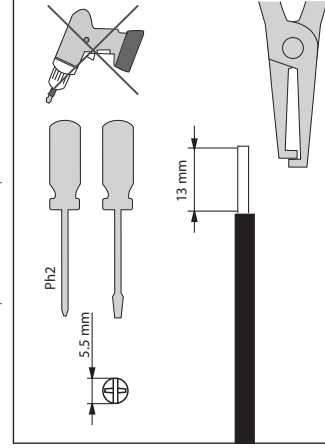

4 wire, TPE-N

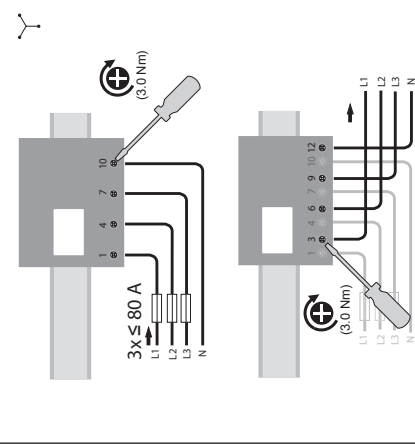

3 wire, TPE

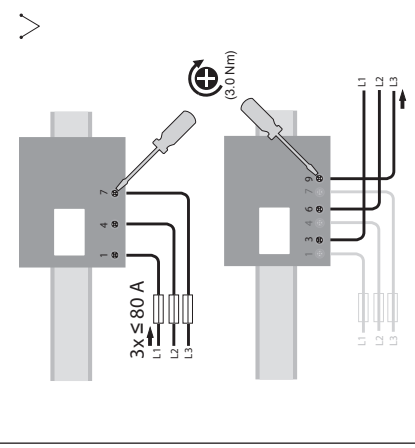

Transformers 4 wires, TPE+N

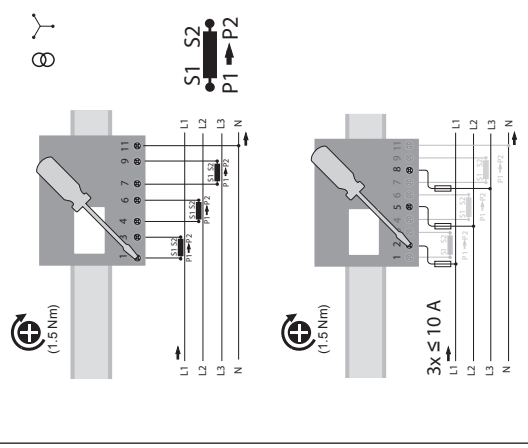

Transformer 3 wire, TPE

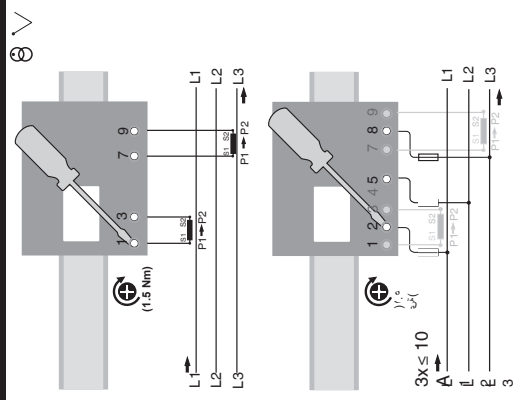

A41

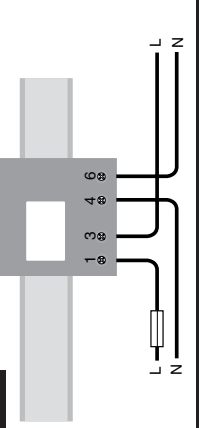

Transformer 2 wire

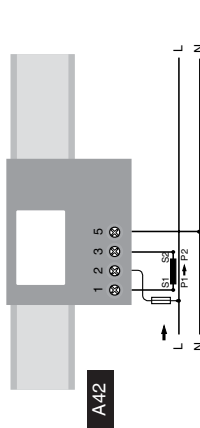

A42

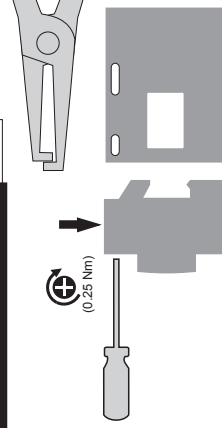
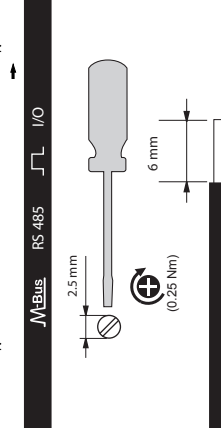

M-Bus	36	37
RS-485	36	37
C (Common)	B (Rx/Tx+)	A (Rx/Tx-)
1 output (5-40 V DC, max 100 mA)		
C	15	out
Fixed 2 inputs/2 outputs		
Inputs (24-240 V DC/57-240 V AC)		
Outputs (5-240 V AC/DC, max 100 mA)		
13	15	16
C	01	02
4 Programmable in/out		
Inputs (24-240 V DC/57-240 V AC)		
Outputs (5-240 V AC/DC, max 100 mA)		
C	I/O1	I/O2
	I/O3	I/O4

Wires

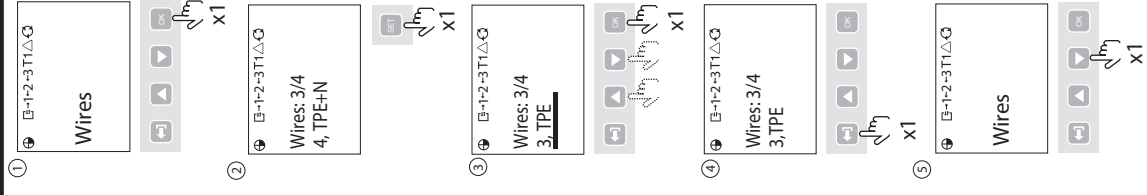

Pulse output

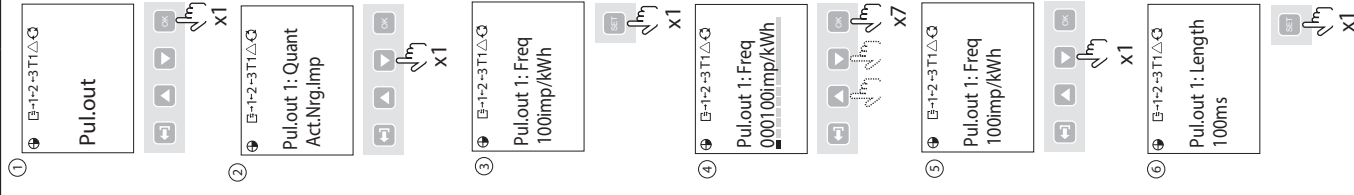

Start

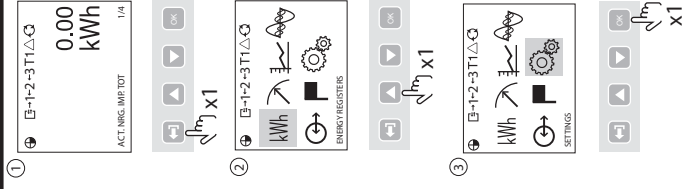

Transformer ratios

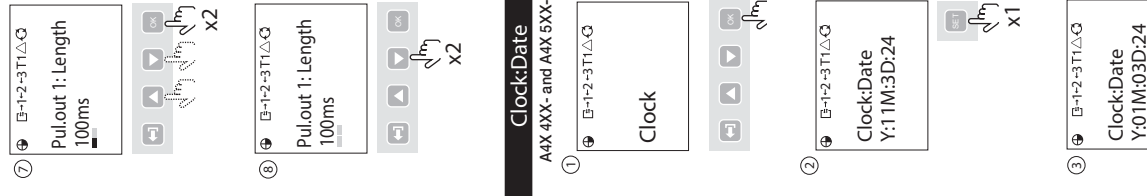
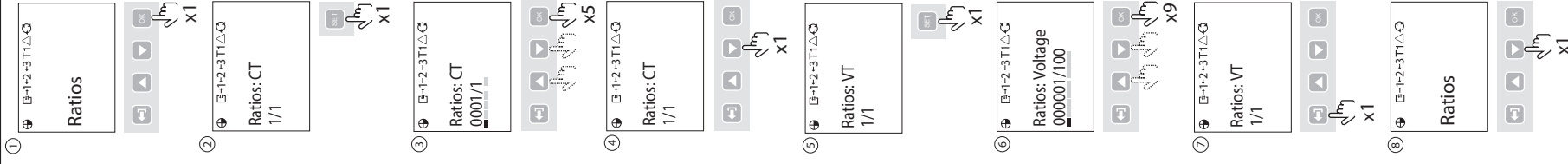

Clock/Date

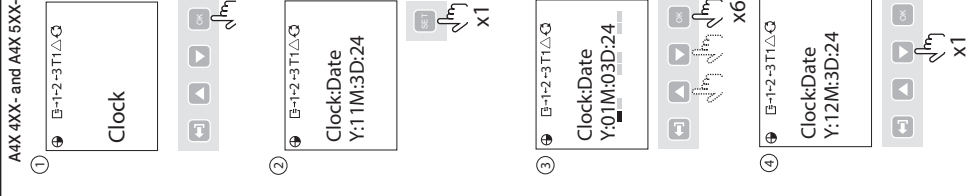

Clock/Time

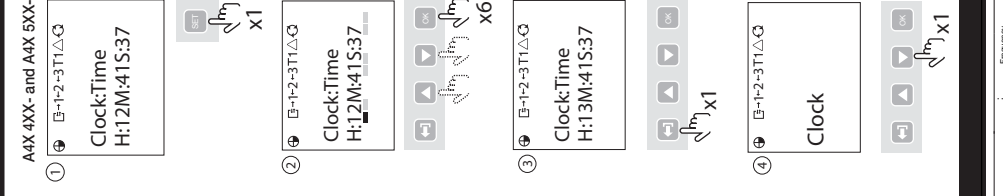

Primary	Length
A41/A42 100mm (AW)	40mm
A42/A44 200mm (AW)	40mm

