

TECHNICAL DATA SHEET

## PMAFIX IP68 - BVNR-RE - Fitting

Straight, PG/inch, connection to solid metal tube

**PMA**



IP68, polyamide fitting for connection to solid metal tube



### Applications:

- In railway vehicle construction and other applications where metric metal tubes are to be connected with the flexible PMA conduits

### Features & Benefits:

- Very high impact resistance
- Quick connection of solid metal tubes with flexible PMA conduits
- Vibration-proof connection to PMA conduits
- Available with or without jubilee clip
- Easy installation
- High conduit pull-out strength
- Very good chemical properties
- Fits both conduit profiles - fine (T) and coarse (G)

### Ingress protection:

- On conduit side:  
IP66, IP68 & IP69 (EN/IEC 60529)  
IP69, 100 bar with Water impact protection (WPS-ring)

On tube side:  
IP68 with sealant (please see assembly instructions)

### Materials:

- High-grade, specially formulated polyamide 6
- Jubilee clip made of galvanised bright steel

### Compatible with:

- PMAFLEX Pro Conduits
- PMAFLEX Multilayer Conduits
- PMAFLEX Conduits
- PMA Smart Line Conduits

### Conforms to:

- EN 45545-2 HL3 (R22 & R23)
- NFPA 130
- UL 94 (V0)

### Weathering resistance:

- Very good UV resistance and weathering characteristics

### Colour:

- Black

### Chemical properties:

- Please refer to [www.pma.ch](http://www.pma.ch)  
(Technical Information / Chemical Resistance)

### Environmental properties:

- Free from halogens and cadmium
- RoHS and REACH compliant

**Product selection:**

Part no.		Metal tube	Conduit size	Dimensions in mm (nom.)				Weight	Packing unit
black without jubilee clip	black with jubilee clip	PG/inch	NW	L	d1	d2	A	kg/100 pcs	pcs/PU
BVNR-RE12	BVNR-RE12-24	PG11	12	54.0	18.5	26.0	25.0	1.2 (3.1)	50
BVNR-RE1317	BVNR-RE1317-28	PG13	17	65.0	20.4	30.0	28.0	1.3 (3.9)	50
BVNR-RE17	BVNR-RE17-28	PG16	17	65.0	22.5	30.0	28.0	2.1 (3.9)	50
BVNR-RE23	BVNR-RE23-32	PG21	23	71.0	28.3	37.0	30.0	2.5 (4.9)	30
BVNR-RE29	BVNR-RE29-44	PG29	29	70.5	37.0	45.0	30.0	3.4 (6.5)	20
BVNR-RE36	BVNR-RE36-50	PG36	36	84.5	47.0	56.0	30.0	5.3 (8.8)	20
BVNR-RE48	BVNR-RE48-65	PG48	48	90.0	59.3	67.5	35.0	7.9 (12.0)	10
BVNR-RE1917	-	3/4"	17	65.0	19.0	29.5	28.0	1.8 (-)	50
BVNR-RE2523	-	1"	23	71.0	25.5	37.0	30.0	2.5 (-)	30
BVNR-RE3129	-	1 1/4"	29	71.0	32.0	44.0	30.0	3.4 (-)	10
BVNR-RE3836	-	1 1/2"	36	130.0	38.0	53.5	76.0	5.3 (-)	10

Our customer service dept. or local distribution partner will be pleased to help you concerning product availability and lead time

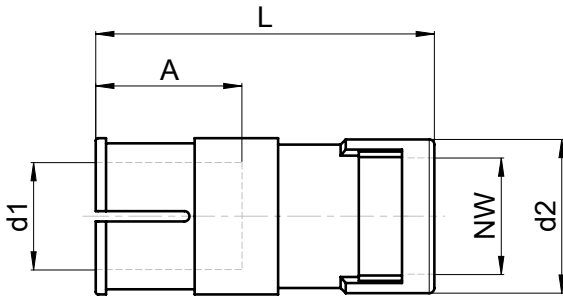

<b>Mechanical Properties:</b>	<b>Value:</b>	<b>Test parameters:</b>	<b>Test method:</b>
Tensile modulus	1'200 ... 3'700 N/mm <sup>2</sup>		ISO 527
Tensile strength	45 ... 65 N/mm <sup>2</sup>		ISO 527
Notched bar impact test	4 ... 20 kJ/m <sup>2</sup>		ISO 180/1C
Vibration and shock standard	Cat. 2		IEC 61373, IEC 60068-2-27 / -64

<b>Thermal properties:</b>	<b>Value:</b>	<b>Test parameters:</b>	<b>Test method:</b>
Continuous application temperature	-50 ... +105°C		PMA DO 9.21-4510
Upper application temperature	+120°C	(20'000 h)	PMA DO 9.21-4360
Short-term	+160°C	(168 h)	PMA DO 9.21-4360

<b>Fire safety properties:</b>	<b>Value:</b>	<b>Test parameters:</b>	<b>Test method:</b>
Fire performance	non flame-propagating		IEC EN 61386-1
Flame class	V0		UL 94
Fire hazard level	HL3		EN 45545-2 (R22)
Oxygen index	> 32 %		EN ISO 4589-2
Smoke density	< 150 Ds max.		EN ISO 5659-2 (25 kW/m <sup>2</sup> )
Toxicity	< 0.75 CIT <sub>NLP</sub>		NF X 70-100-1/-2: (600°C)
Fire hazard level	HL3		EN 45545-2 (R23)
Oxygen index	> 32 %		EN ISO 4589-2
Smoke density	< 300 Ds max.		EN ISO 5659-2 (25 kW/m <sup>2</sup> )
Toxicity	< 1.5 CIT <sub>NLP</sub>		NF X 70-100-1/-2: (600°C)
Fire performance NFPA 130:			NFPA 130
- Flammability	compliant		ASTM E 162
- Smoke density	compliant		ASTM E 662
Heat and visible smoke	26.00 MJ/kg		ASTM E 1354
Smoke emission toxicity	compliant		Bombardier SMP 800-C
Smoke emission toxicity	compliant		Boeing BSS 7241

#### Content of delivery:

- Fitting with or without jubilee clip
- Locking clip (OVN2),
- Conduit gasket (NVN3)

#### Assembly instructions:

- Sealing paste, sealing band, glue etc. should be used at the junction to the metal tubing if increased sealing is required
- Please consider the appropriate assembly instructions on [www.pma.ch](http://www.pma.ch)

ABB Switzerland Ltd,  
PMA Cable Protection  
Aathalstrasse 90  
8610 Uster, Switzerland  
Phone: +41 58 585 00 11  
pma-info@ch.abb.com  
[www.pma.ch](http://www.pma.ch)

Let's write the future.  
Together. **abb.com**

We reserve the right to make technical changes or modify the contents of this document without prior notice. With regard to purchase orders, the agreed particulars shall prevail. ABB Installation Products Inc. does not accept any responsibility whatsoever for potential errors or possible lack of information in this document.

We reserve all rights in this document and in the subject matter and illustrations contained therein. Any reproduction, disclosure to third parties or utilization of its contents – in whole or in parts – is forbidden without prior written consent of ABB Inc. Copyright© 2019 ABB Installation Products Inc. All rights reserved

