

ASSEMBLY DRAWING
E2.2 2500A W (COUPLER COLUMN)
I_{cw} > 36KA

ASSEMBLY DRAWING
E2.2 2500A W (COUPLER COLUMN)
I_{cw} ≤ 36KA

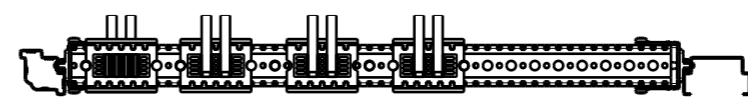
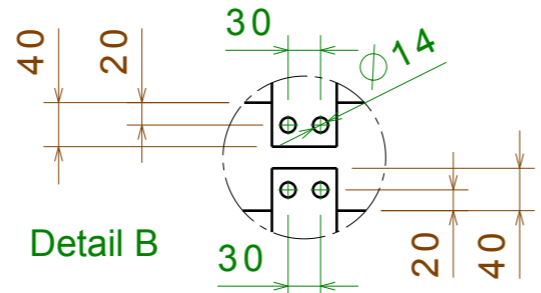
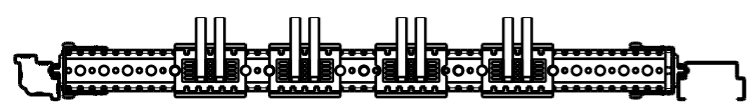
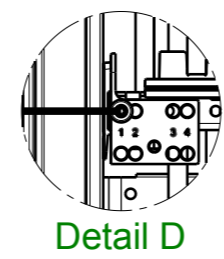
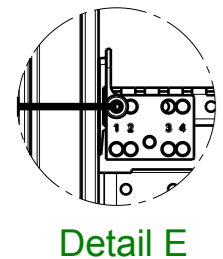
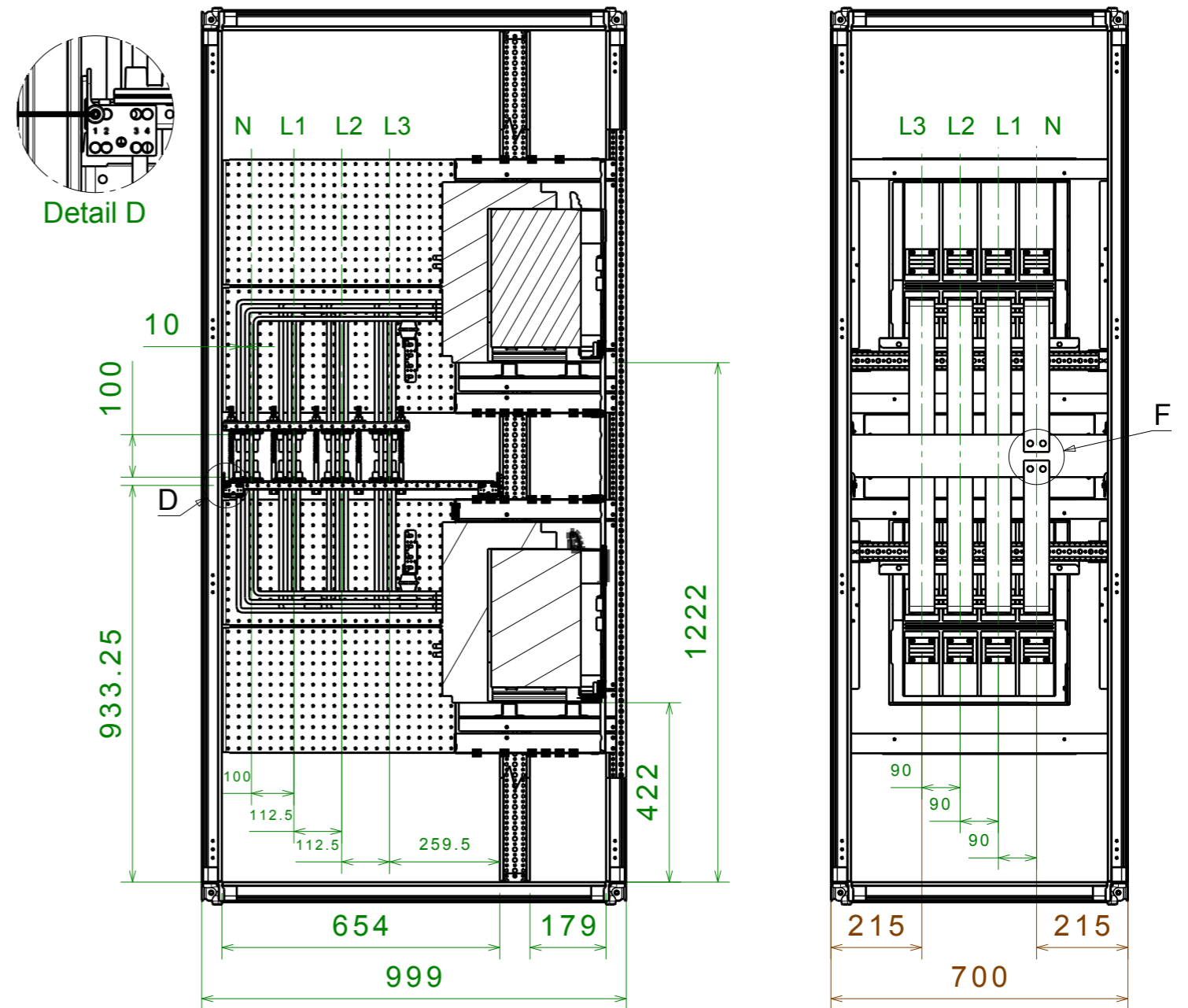
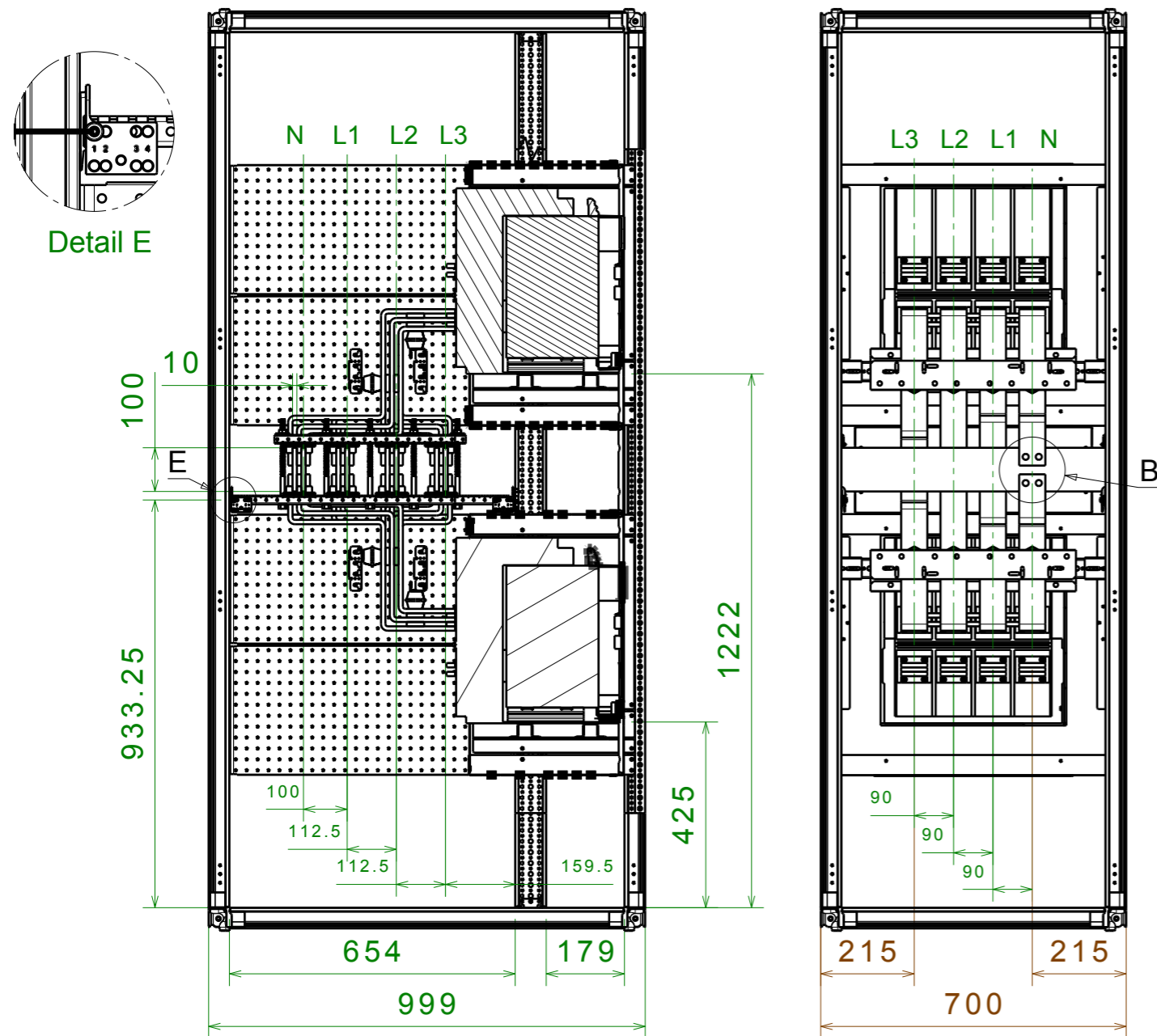
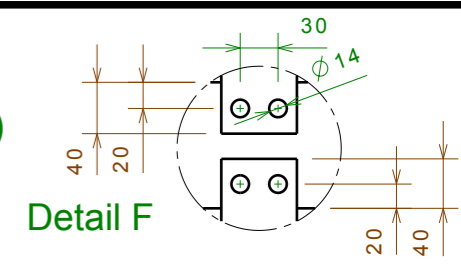

CONNECTION BUSBARS 3x60x10xP

AGG. DI SEGNO	SCALA SCALE	: 1:14	N° PROGETTO / PROJECT	XXX.XX
DISEGNATORE DESIGNER	APPROVAZIONE APPROVAL		ABB	ABB SACE ADB
MODIFICA	DATA DATE	: xx-xx-xx	DENOMINAZIONE/NAME: E2.2 2500A W (COUPLER COLUMN) CONNECTION BUSBARS 3x60x10xP	
DATA		Formato A3 Formed	DISEGNO N° /DRAWING N° 8 6 3 8 3 6	

Questo disegno e' di esclusiva proprieta' di ABB SACE ADB. Ne e' vietata la riproduzione a termini di legge.

CONNECTIONS FOR E2.2 2500A WITHDRAWABLE (COUPLER COLUMN) $I_{cw} \leq 36KA$

SPEP P = 900mm
 BUSBARS HOLDER PBHB2145 (75mm)
 MAIN BUSBARS IP30 / IP31 : 2500A (2x80x10);
 MAIN BUSBARS IP40 / IP41 / IP65 : 2500A (2x100x10)

MAIN
BUSBARS FOR
BREAKER UP

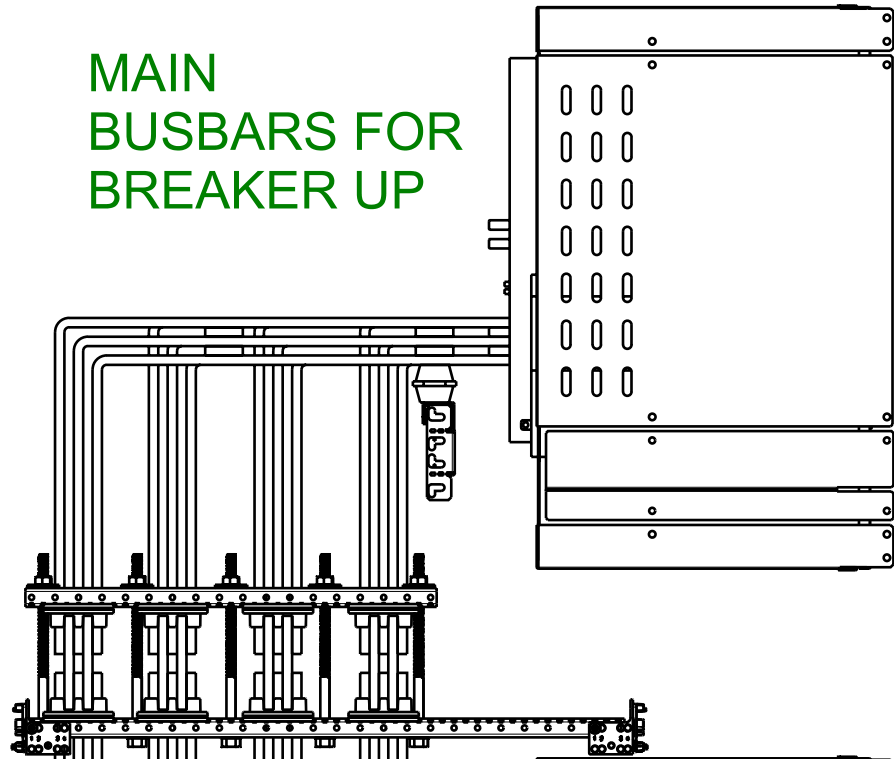

	B	
	H MAIN BUSBARS	
	80	100
L3.1	378	358
L3.2	358	338
L3.3	338	318
L2.1	378	358
L2.2	358	338
L2.3	338	318
L1.1	378	358
L1.2	358	338
L1.3	338	318
N.1	378	358
N.2	358	338
N.3	338	318

MAIN
BUSBARS FOR
BREAKER DOWN

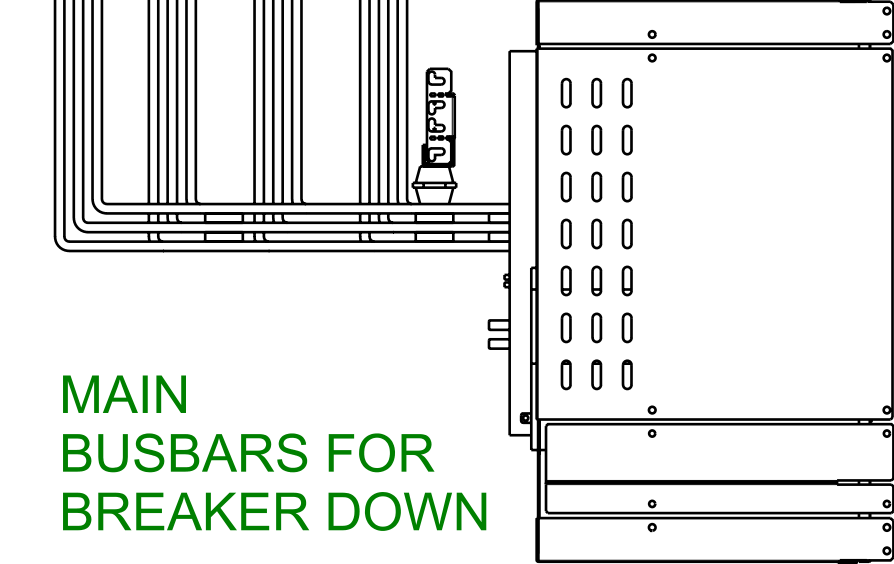

	B	
	H MAIN BUSBARS	
	80	100
L3.1	358	358
L3.2	338	338
L3.3	318	318
L2.1	358	358
L2.2	338	338
L2.3	318	318
L1.1	358	358
L1.2	338	338
L1.3	318	318
N.1	358	358
N.2	338	338
N.3	318	318

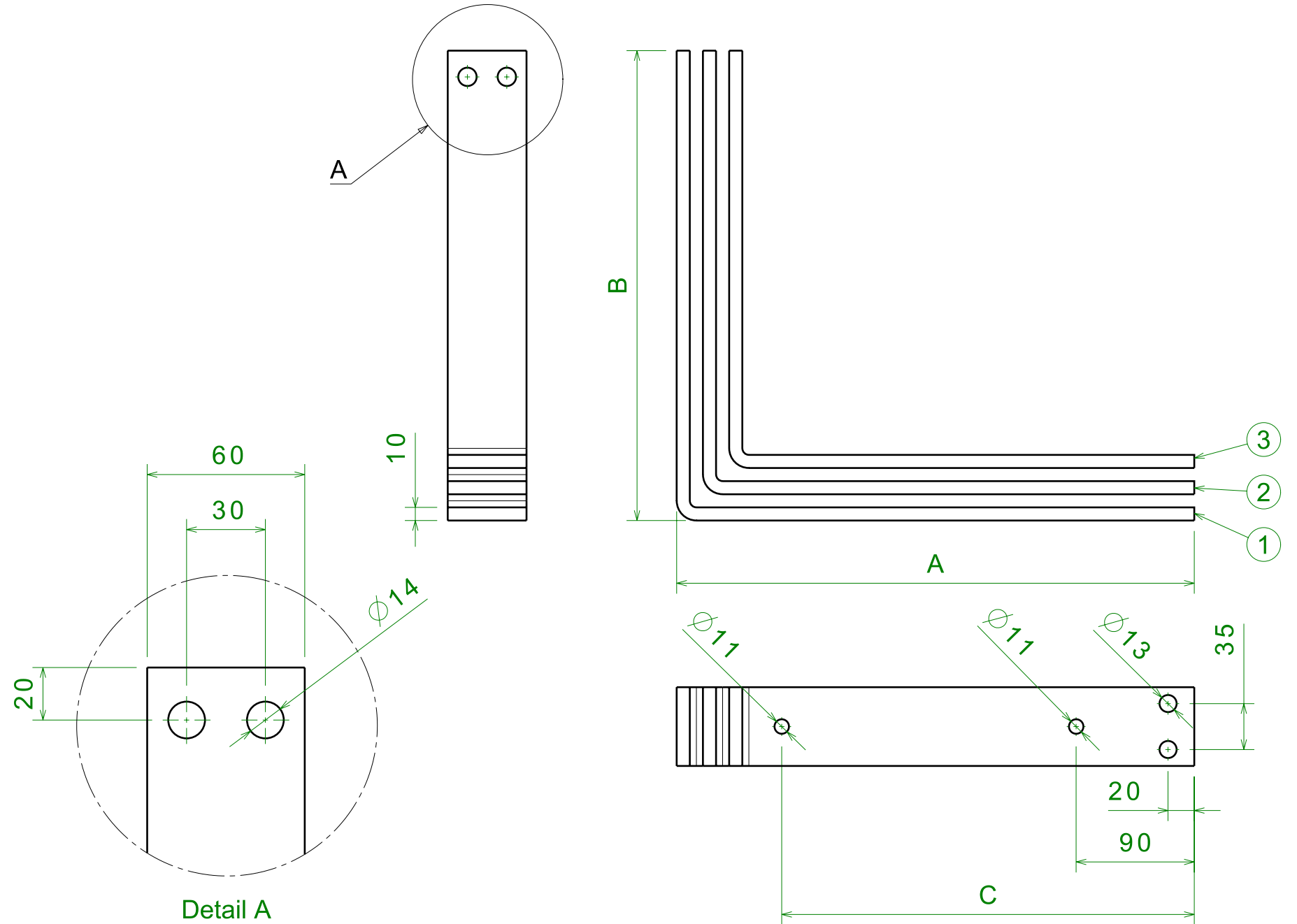

Detail A

PHASE	POS		A	C
L3	1	L3.1	169.25	-
	2	L3.2	149.25	-
	3	L3.3	129.25	-
L2	1	L2.1	281.75	-
	2	L2.2	261.75	-
	3	L2.3	241.75	-
L1	1	L1.1	394.25	314.25
	2	L1.2	374.25	314.25
	3	L1.3	354.25	314.25
N	1	N.1	494.25	314.25
	2	N.2	474.25	314.25
	3	N.3	454.25	314.25

SCALA SCALE	: 1:4	N° PROGETTO : PROJECT	XXX.XX
DISSEGNAZIONE DESIGNER	:	ABB SACE ADB	
APPROVAZIONE APPROVAL	:	DENOMINAZIONE/NAME: E2.2 2500A WITHDRAWABLE (COUPLER COLUMN) CONNECTION BUSBARS 3x60x10xP_L	
DATA DATE	: XX-XX-XX	DISEGNO N° /DRAWING N° 8 6 3 8 3 8	
FORMATO FORMED	Formato A3 Formed	Questo disegno e' di esclusiva proprieta' di ABB SACE ADB. Ne e' vietata la riproduzione a termini di legge	

CONNECTIONS FOR E2.2 2500A WITHDRAWABLE (COUPLER COLUMN) $I_{cw} > 36KA$

SPEP P = 900mm
 BUSBARS HOLDER PBHB2145 (75mm)
 MAIN BUSBARS IP30 / IP31 : 2500A (2x80x10);
 MAIN BUSBARS IP40 / IP41 / IP65 : 2500A (2x100x10)

MAIN
BUSBARS FOR
BREAKER UP

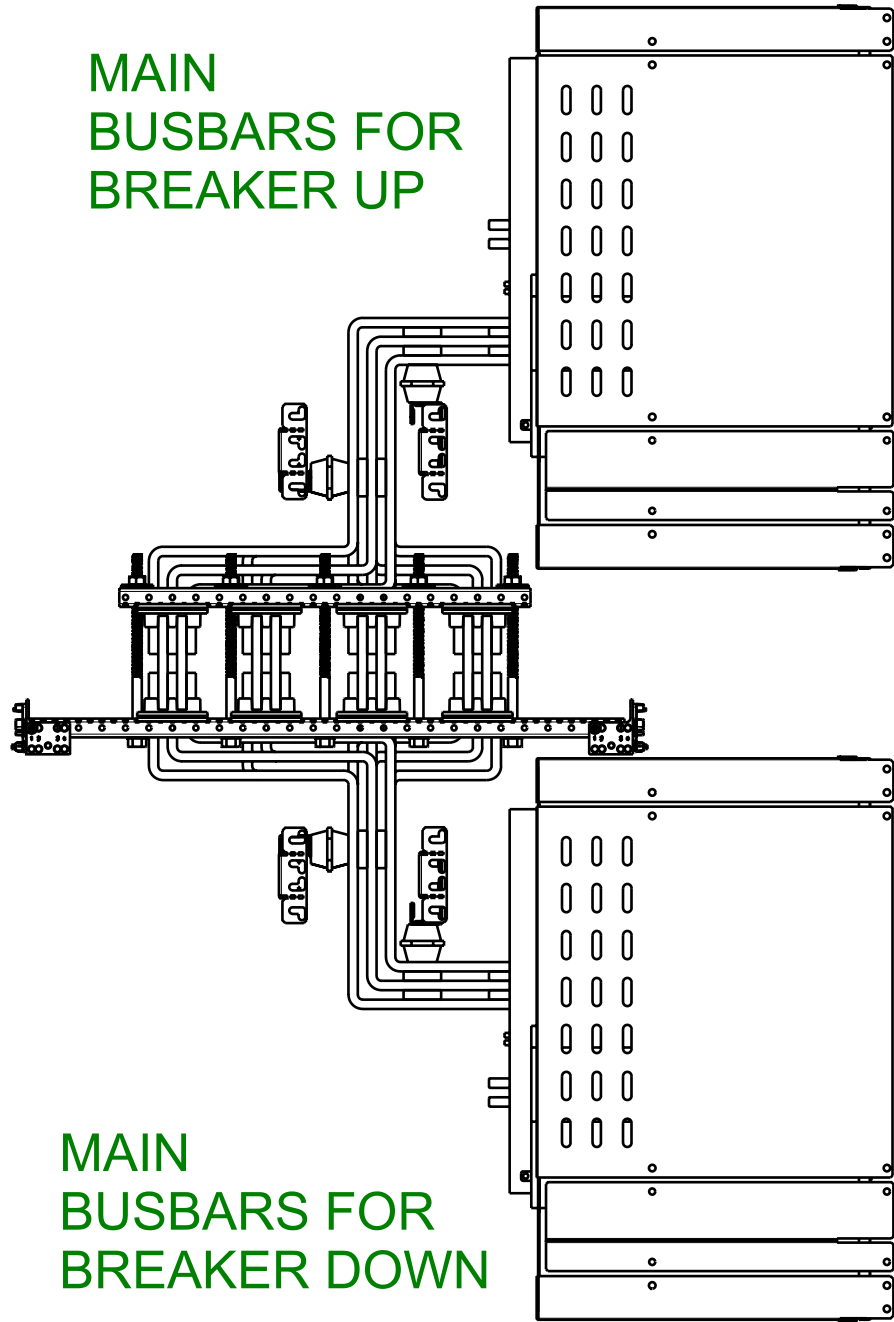

	B	
	H MAIN BUSBARS	
	80	100
L3.1	378	358
L3.2	358	338
L3.3	338	318
L2.1	378	358
L2.2	358	338
L2.3	338	318
L1.1	378	358
L1.2	358	338
L1.3	338	318
N.1	378	358
N.2	358	338
N.3	338	318

	B	
	H MAIN BUSBARS	
	80	100
L3.1	358	358
L3.2	338	338
L3.3	318	318
L2.1	358	358
L2.2	338	338
L2.3	318	318
L1.1	358	358
L1.2	338	338
L1.3	318	318
N.1	358	358
N.2	338	338
N.3	318	318

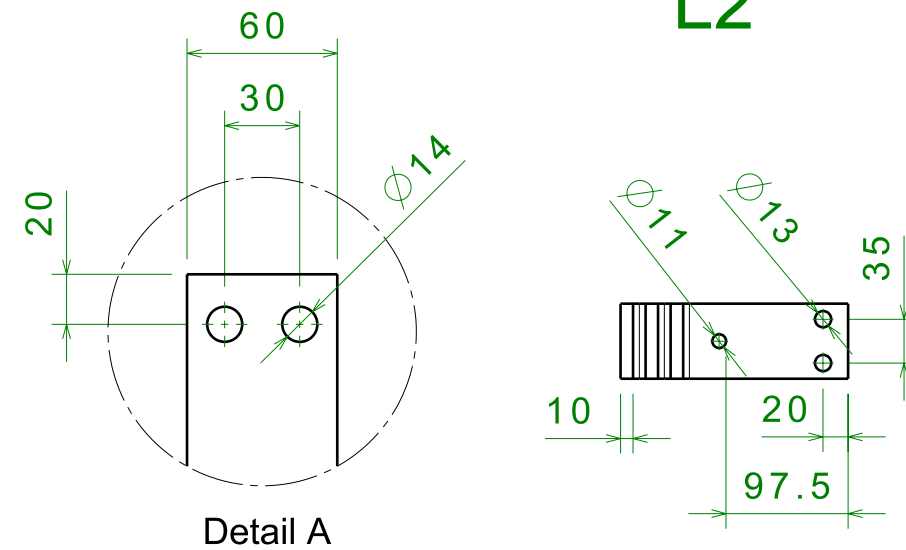
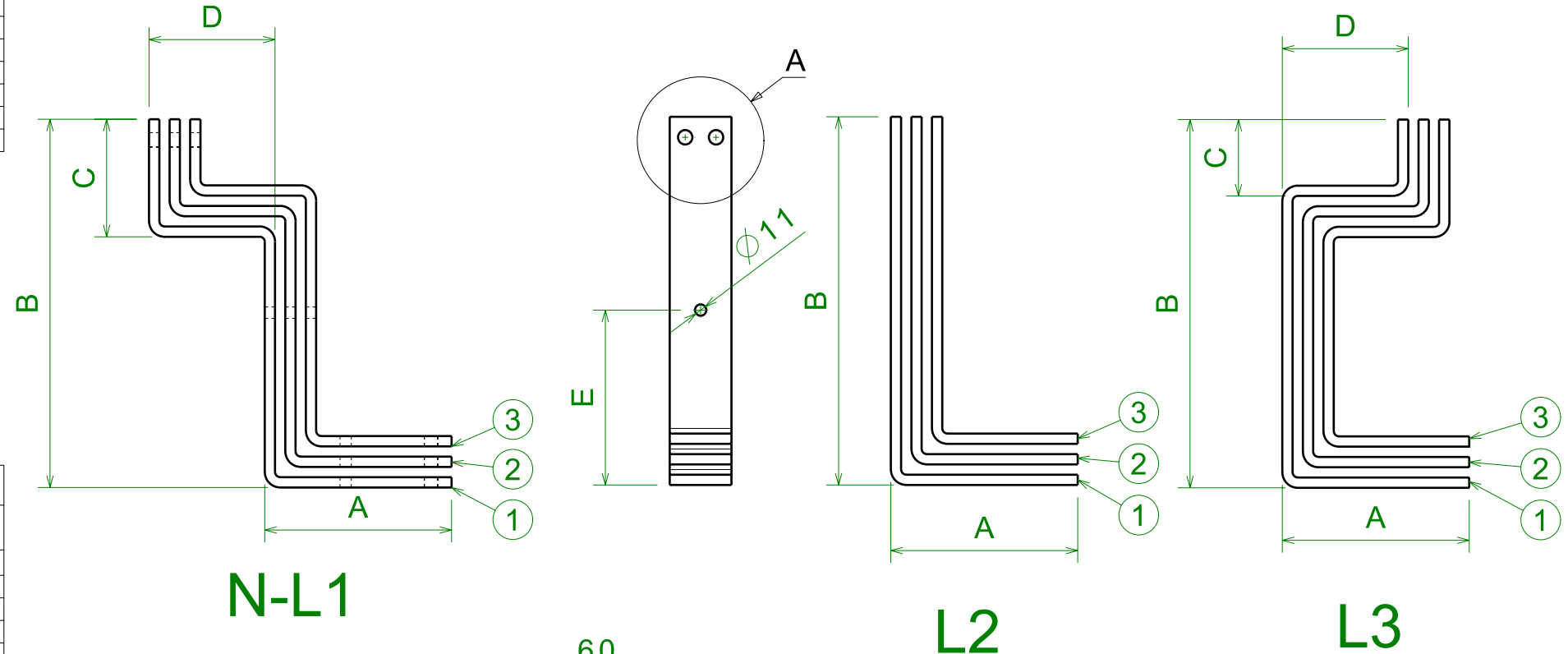

MAIN
BUSBARS FOR
BREAKER DOWN

PHASE	POS		A	C	D	E
L3	1	L3.1	181.75	74.25	122.5	170
	2	L3.2	161.75	94.25	122.5	150
	3	L3.3	141.75	114.25	122.5	130
L2	1	L2.1	181.75	-	-	170
	2	L2.2	161.75	-	-	150
	3	L2.3	141.75	-	-	130
L1	1	L1.1	181.75	114.25	122.5	170
	2	L1.2	161.75	94.25	122.5	150
	3	L1.3	141.75	74.25	122.5	130
N	1	N.1	181.75	114.25	222.5	170
	2	N.2	161.75	94.25	222.5	150
	3	N.3	141.75	74.25	222.5	130

DATA	MODIFICA	AGG. DISEGNO	SCALA	SCALE	N° PROGETTO	PROJECT	DENOMINAZIONE/NAME	DISEGNO N° /DRAWING N°
			SCALA	SCALE	XXX.XX	XXX.XX	E2.2 2500A	8 6 3 8 3 7
			DISEGNATORE	DESIGNER			WITHDRAWABLE (COUPLER COLUMN)	
			APPROVAZIONE	APPROVAL			CONNECTION BUSBARS 3x60x10xP_S	
			DATA	DATE				
			Formato A3	Formed				

HOLDER FOR Icw 15KA

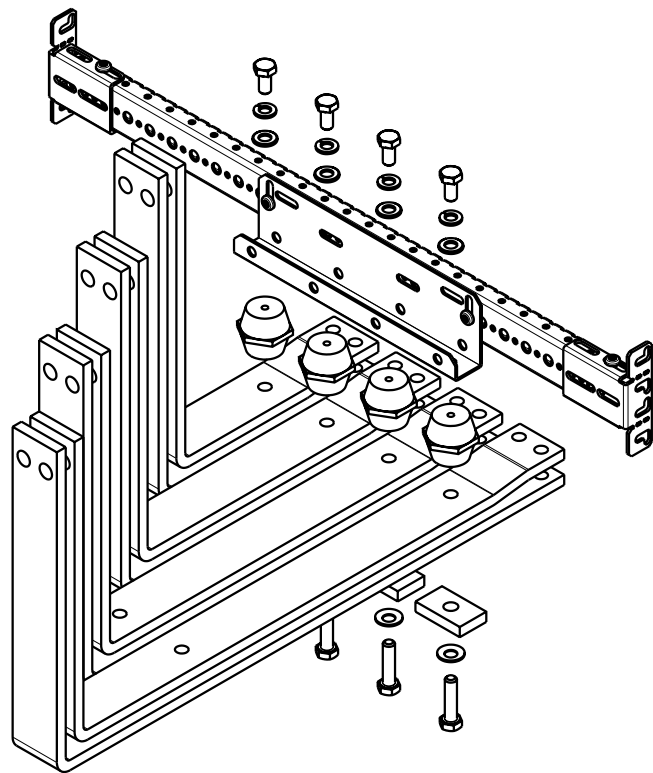

Vista isometrica
Scala: 1:6

BOM

POS	DESCRIPTION
1	HEX CAP SCREWS M10x16 - 8.8 (VITE TESTA ESAGONALE M10x16 - 8.8)
2	FLAT WASHER M10 (RONDELLA PIANA M10)
3	SPRING LOCK WASHER M10 (ROSETTA ELASTICA GROWER M10)
4	BRACKET FOR INSULATOR (STAFFA ISOLATORI)
5	INSULATOR H40 M10 (ISOLATORI H40 M10)
6	CUPPER SPACER H10mm (SPESSORE IN RAME H10mm)
7	CONICAL SPRING WASHER M10 (ROSETTE ELASTICHE CONICHE M10)
8	HEX CAP SCREWS M10x__ - 8.8 (VITE TESTA ESAGONALE M10x__ - 8.8)

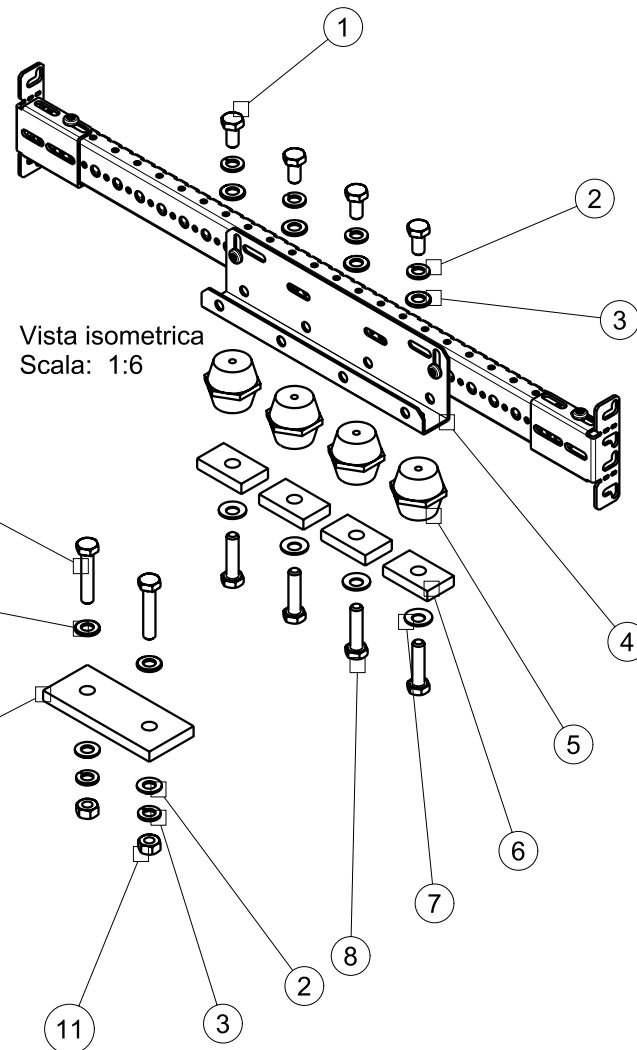

Vista isometrica
Scala: 1:6

HOLDER FOR Icw 25-36KA

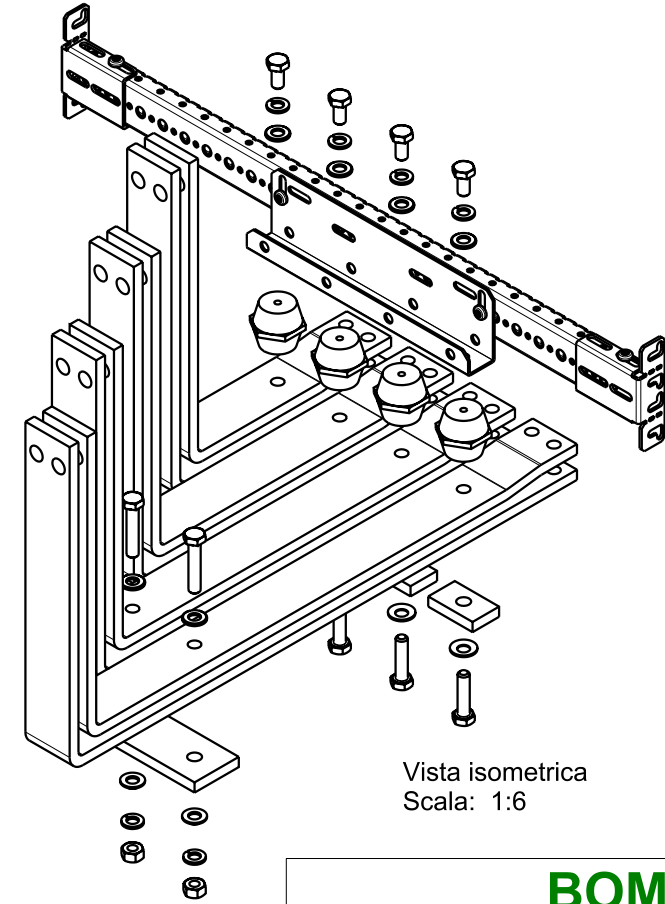

Vista isometrica
Scala: 1:6

BOM

N° PART	DESCRIPTION
1	HEX CAP SCREWS M10x16 - 8.8 (VITE TESTA ESAGONALE M10x16 - 8.8)
2	FLAT WASHER M10 (RONDELLA PIANA M10)
3	SPRING LOCK WASHER M10 (ROSETTA ELASTICA GROWER M10)
4	BRACKET FOR INSULATOR (STAFFA ISOLATORI)
5	INSULATOR H40 M10 (ISOLATORI H40 M10)
6	CUPPER SPACER H10mm (SPESSORE IN RAME H10mm)
7	CONICAL SPRING WASHER M10 (ROSETTE ELASTICHE CONICHE M10)
8	HEX CAP SCREWS M10x__ - 8.8 (VITE TESTA ESAGONALE M10x__ - 8.8)
9	GPO3 PROFILE
10	HEX CAP SCREWS M10x__ - 8.8 (VITE TESTA ESAGONALE M10x__ - 8.8)
11	NUT M10 - (DADO M12)

GPO3 PROFILE

E1.2 2 PHASE

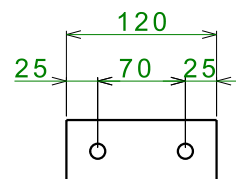

E2.2 2 PHASE

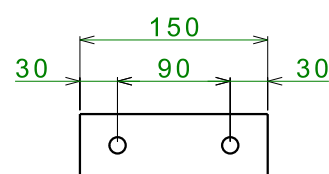

E4.2 2 PHASE

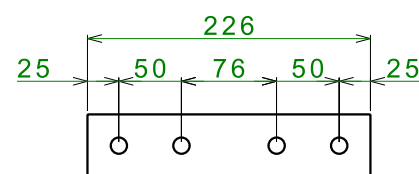

801

FIG.

DIMENSIONI / DIMENSION

PESO / WEIGHT

mm

UNITA' DI MISURA / UNITS OF MEASUREMENT

SCALA / SCALE	:	MAT. / MAT. :
DISegnato DA / DRAW BY	:	TRATT. / TREAT :
APPROVAZIONE / APPROVAL	:	PROGETTO N° / PROJECT N° : 142.00
DATA / DATE	: 14.04.2016	ABB ABB SACE ADB
Formato / Format	A3	DESCRIZIONE / DESCRIPTION : ANCORAGGIO BARRE A "L" "L" TYPE CONNECTIONS SUPPORT

DISEGNO N° / DRAWING N°	863876
-------------------------	---------------

HOLDER FOR 36<I_{cw}<=50KA

Vista isometrica
Scala: 1:8

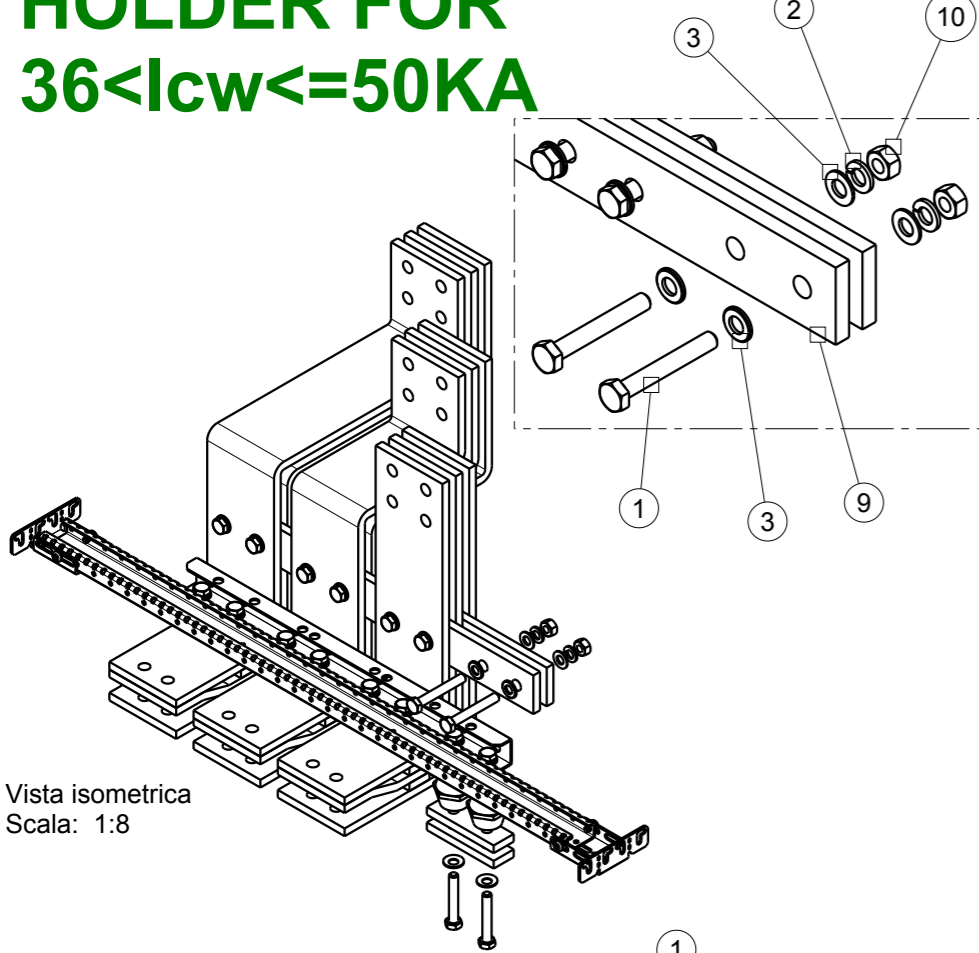

BOM 36<I_{cw}<=50KA

POS	DESCRIPTION
1	HEX CAP SCREWS M10x16 - 8.8 (VITE TESTA ESAGONALE M10x16 - 8.8)
2	FLAT WASHER M10 (RONDELLA PIANA M10)
3	SPRING LOCK WASHER M10 (ROSETTA ELASTICA GROWER M10)
4	BRACKET FOR INSULATOR (STAFFA ISOLATORI)
5	INSULATOR H40 M10 (ISOLATORI H40 M10)
6	CUPPER SPACER H10mm (SPESSORE IN RAME H10mm)
7	CONICAL SPRING WASHER M10 (ROSETTE ELASTICHE CONICHE M10)
8	HEX CAP SCREWS M10x__ - 8.8 (VITE TESTA ESAGONALE M10x__ - 8.8)
9	GPO3 PROFILE
10	NUT M10 - DADO M10

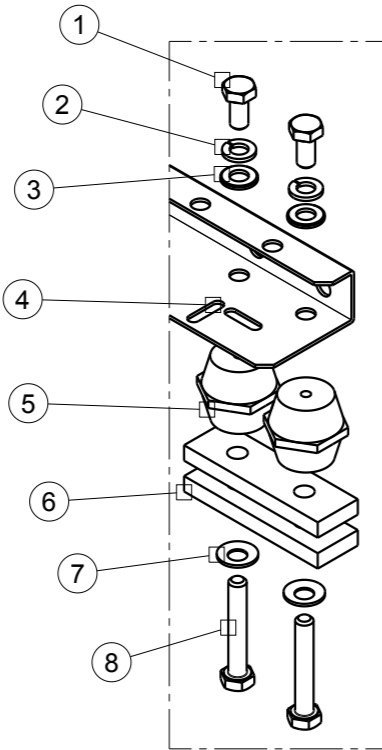

HOLDER FOR 50<I_{cw}<=75KA

Vista isometrica
Scala: 1:8

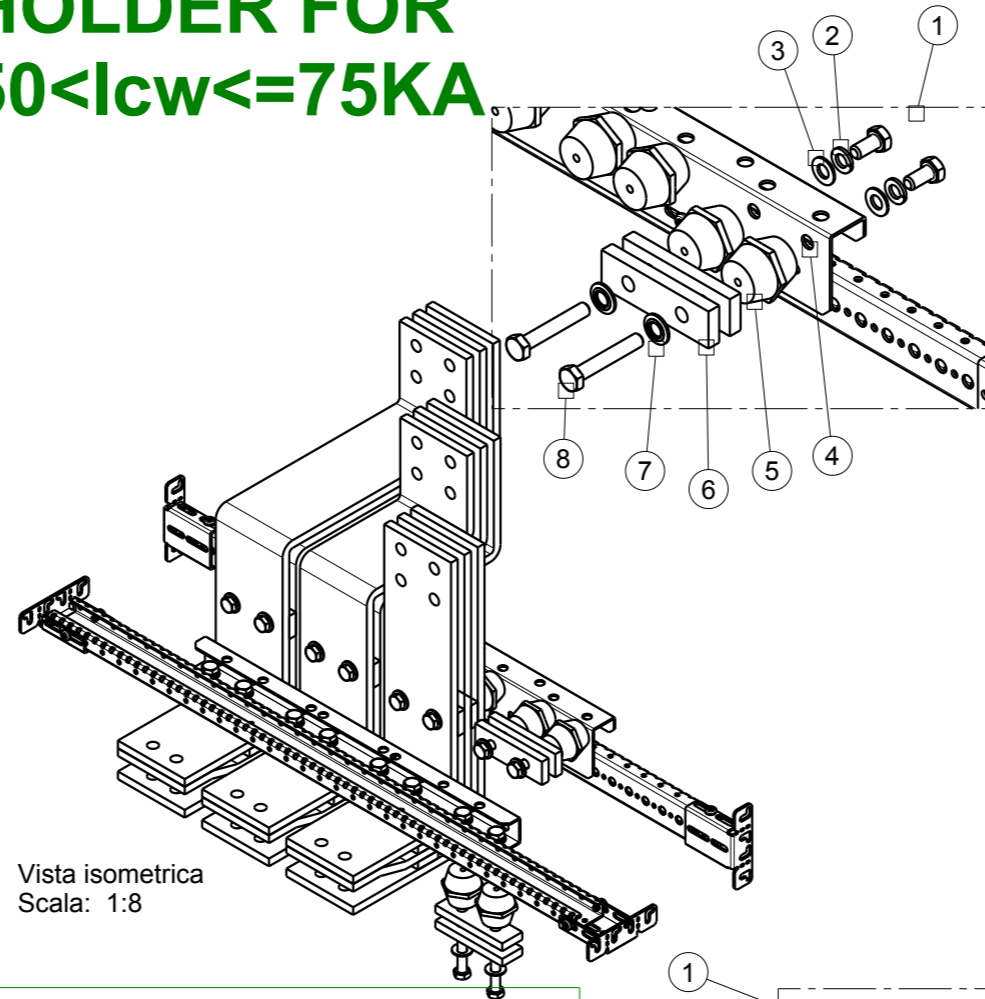

BOM 50<I_{cw}<=75KA

POS	DESCRIPTION
1	HEX CAP SCREWS M10x16 - 8.8 (VITE TESTA ESAGONALE M10x16 - 8.8)
2	FLAT WASHER M10 (RONDELLA PIANA M10)
3	SPRING LOCK WASHER M10 (ROSETTA ELASTICA GROWER M10)
4	BRACKET FOR INSULATOR (STAFFA ISOLATORI)
5	INSULATOR H40 M10 (ISOLATORI H40 M10)
6	CUPPER SPACER H10mm (SPESSORE IN RAME H10mm)
7	CONICAL SPRING WASHER M10 (ROSETTE ELASTICHE CONICHE M10)
8	HEX CAP SCREWS M10x__ - 8.8 (VITE TESTA ESAGONALE M10x__ - 8.8)
9	GPO3 PROFILE

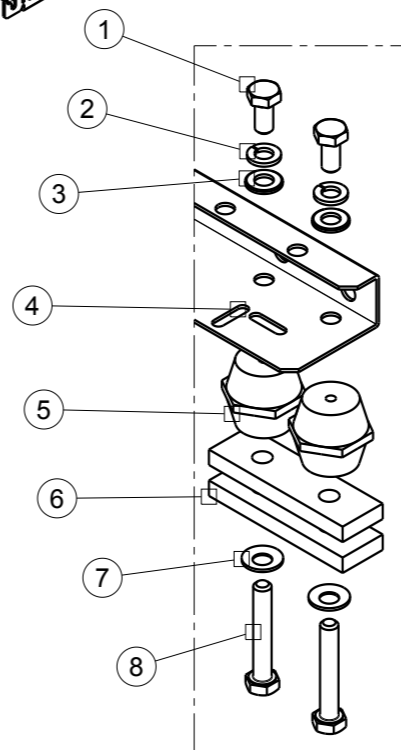

HOLDER FOR I_{cw} >75KA

Vista isometrica
Scala: 1:8

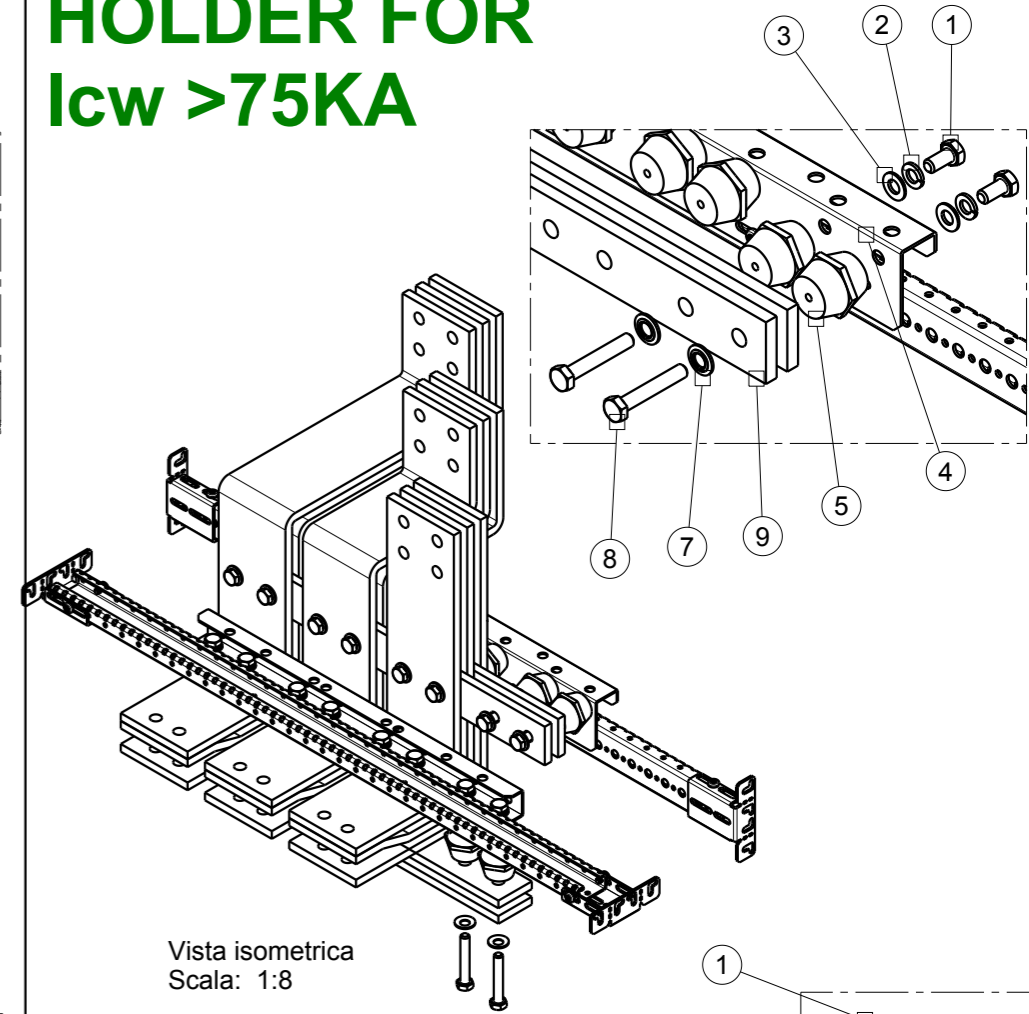

BOM I_{cw}>75KA

POS	DESCRIPTION
1	HEX CAP SCREWS M10x16 - 8.8 (VITE TESTA ESAGONALE M10x16 - 8.8)
2	FLAT WASHER M10 (RONDELLA PIANA M10)
3	SPRING LOCK WASHER M10 (ROSETTA ELASTICA GROWER M10)
4	BRACKET FOR INSULATOR (STAFFA ISOLATORI)
5	INSULATOR H40 M10 (ISOLATORI H40 M10)
6	CUPPER SPACER H10mm (SPESSORE IN RAME H10mm)
7	CONICAL SPRING WASHER M10 (ROSETTE ELASTICHE CONICHE M10)
8	HEX CAP SCREWS M10x__ - 8.8 (VITE TESTA ESAGONALE M10x__ - 8.8)
9	GPO3 PROFILE

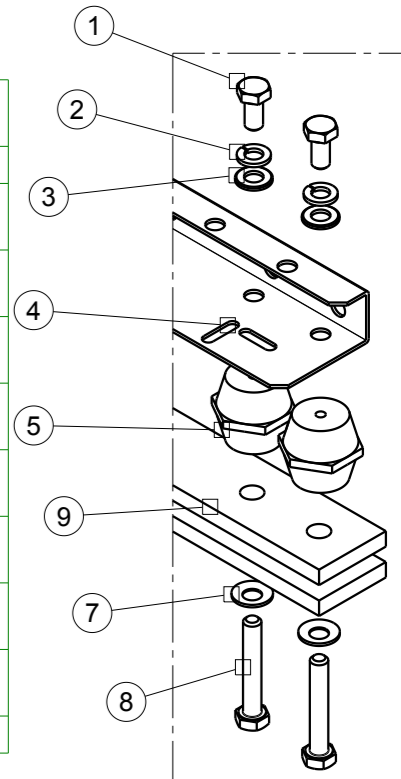

GPO3 PROFILE

E1.2 4P

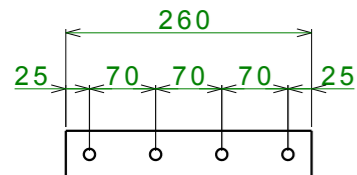

E2.2 4P

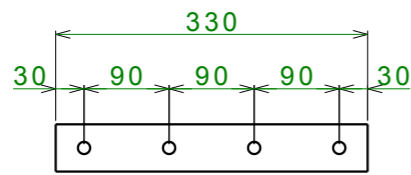

E4.2 4P

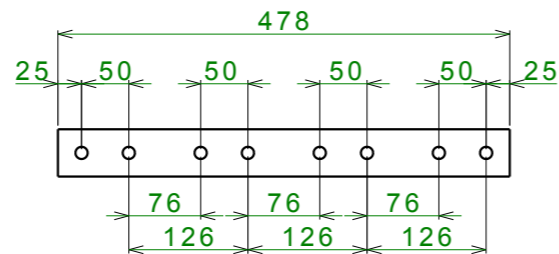

801

FIG.

DIMENSIONI / DIMENSION

PESO / WEIGHT

mm

UNITA' DI MISURA
UNITS OF MEASUREMENT

AGG. DI SEGNO DISTR. MOD.	SCALA SCALE	MAT. / MAT. :
VERSIONE VERSION	DISEGNATO DA DRAW BY	TRATT. / TREAT :
DATA DATE	APPROVAZIONE APPROVAL	PROGETTO N° : PROJECT N° : 142.00
	ABB	ABB SACE ADB
	Formato Format A3	DESCRIZIONE / DESCRIPTION: DIVERSI TIPI DI ANCORAGGIO DIFFERENT TYPES OF SUPPORT

DISEGNO N° / DRAWING N°

863877