

RRD - Remote Racking Device

For SACE Emax 2 E2.2, E4.2 and E6.2



ABB SACE offers a dedicated device to remotely perform circuit breaker rack-in/rack-out operations for SACE Emax 2, increasing the safety for personnel. ABB is constantly committed to the safety of the personnel during every phase of use of its products, including installation and maintenance. During the rack-in operations of the circuit-breaker, the RRD prevents risk of injuries due to possible electric arc.

Arc flash

An electric arc can occur because of several reasons, such as human error and poor connections. Accidents are quite unusual but when they happen their consequences may be severe. The main risk of arc flash occurs when the cabinet door is open, and the arc-proof characteristics of the switchgear are significantly decreased.

ABB Solution

In order to maximize safety during the racking-in of the circuit breaker moving part, ABB has developed the new Remote Racking Device (RRD) for Emax 2 to operate the circuit breakers without being in front of the gear. The device only works with the circuit breaker in the open position and with the springs discharged.

The RRD is powered by a standard outlet (110V and 220V versions available). The remote control is connected to the main device with 10 meters (33 ft) cable which allows the Racking-in/out command from a remote location. The cable length guarantees enough distance from the arc flash boundary for traditional LV switchgear.

Advantages

- Improves employee safety against electrical arcs thanks to the long distance between the circuit breaker and the operator
- One single device for all the Emax 2 circuit breakers
- Easy installation thanks to the ergonomic handle to mount and to remove the device from the circuit breaker
- All operating positions can be reached: Connected/Test position/Disconnected
- Immediate visual verification of the circuit breaker position, thanks to the 3 LEDs available both on the device and on the remote control
- Possibility to interrupt the operation in any moment thanks to the emergency pushbutton on the remote control
- Easy of storage thanks to the dedicated carrying case.

Certification

The remote racking devices for switchgear and control gear have been investigated by UL in accordance with the Standard(s) UL 2876 and CSA-C22.2 No. 14.

Electrical and Technical Data

Rated service voltage:	100..127VAC/DC
	200...240VAC/DC
Frequency	50-60 Hz
Rated power:	150 W, 120 VA,
Working and storage temperature range:	-5 °C ... +70 °C / 23 °F... 158 °F
Minimum time interval between two operation:	3 minute
Maximum operating distance:	10m / 33 ft
Weight:	11 Kg / 24.3 lb

Ordering codes

Codes	Descriptions
1SDA085528R1	RRD Emax2 E2.2...E6.2 110 Vac/dc
1SDA085529R1	RRD Emax2 E2.2...E6.2 220 Vac/dc
1SDA085530R1	Kit for fixing RRD on E2.2...E6.2

Included in package:

1) RRD packaging:

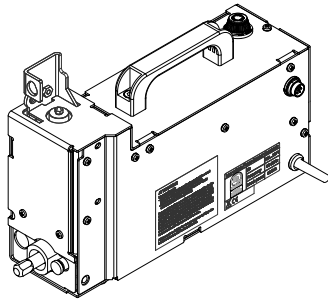

- Main Device
- Remote control with cable

2) Kit for fixing RRD on E2.2...E6.2:

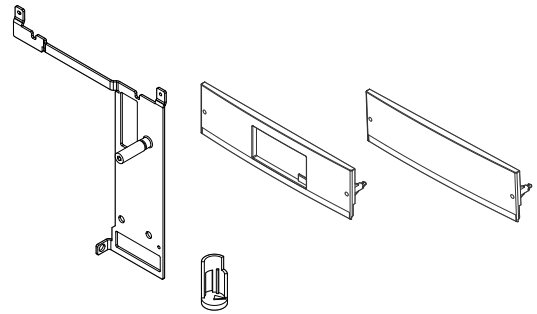

- Fixed plate E2.2...E6.2 (1 pieces)
- Indicator (5 pieces)
- Transparent cover for Ekip Dip Trip Unit
- Transparent cover for Ekip Touch or greater

Dimensions

