

H-BOX

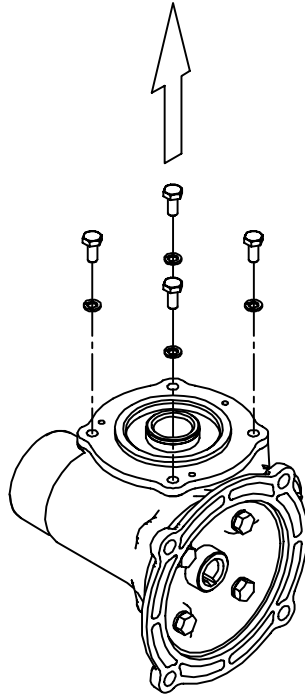
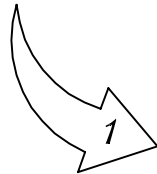
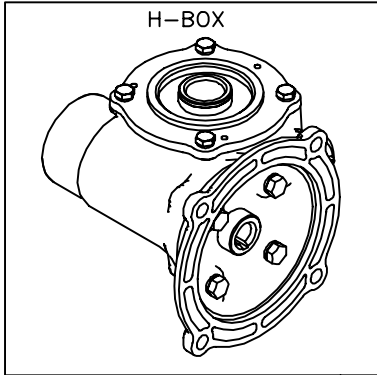

1.) LAY UNIT WITH INSTALLATION SIDE FACING UP.

CAUTION

FAILURE TO DO SO WILL RESULT IN LUBRICANT LOSS.

2.) REMOVE FOUR EXISTING BOLTS AND LOCK WASHERS AND DISCARD.

3.) DO NOT REMOVE BEARING SUPPORT.

CAUTION

REMOVAL OF BEARING SUPPORT MAY RESULT IN LUBRICANT LOSS.

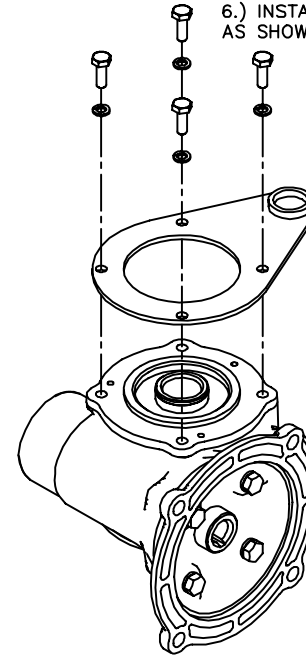
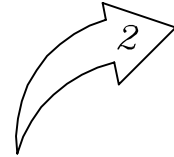

4.) POSITION TORQUE ARM AS REQUIRED.

5.) MOUNT TORQUE ARM WITH THE FOUR BOLTS AND WASHERS PROVIDED IN THE KIT.

CAUTION

FAILURE TO USE PROVIDED FASTENERS MAY RESULT IN STRIPPED THREADS.

6.) INSTALL BOLTS AND WASHERS AS SHOWN BELOW.

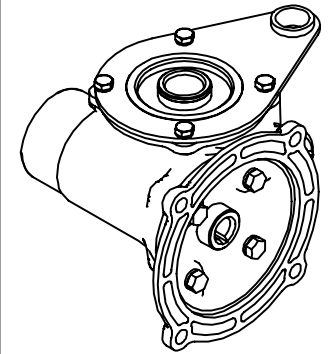
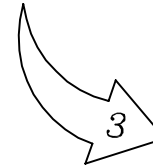

7.) UNIFORMLY TIGHTEN FOUR TORQUE ARM BOLTS AS LISTED BELOW.

LUBRICATED: 41inlb MAXIMUM.
UNLUBRICATED: 72inlb MAXIMUM.

CAUTION

OVERTIGHTENING OF THE BOLTS MAY RESULT IN STRIPPED THREADS.

REV. DESC: NEW

REV. LTR: -

VERSION: 00

TDR: 000000396810

51A990017

FILE: \CKA\00029\947

REVISED: 12: 43: 52 11/14/2006

MTL: -

BY: CKBRISO

BALDOR ELECTRIC Co.

H-BOX TORQUE ARM, ASSEMBLY INSTRUCTIONS