

CATALOG

Stainless steel solutions

Corrosion-resistant protection
for electrical systems

T&B Fittings | ***T&B Liquidtight Systems*** | ***Kindorf*** | ***Superstrut*** | ***T&B Cable Tray*** | ***Ty-Met***



—
**Stainless steel solutions —
built to stand up to your harshest
environments.**

**Water, salt spray, sunlight, petroleum,
chemicals and extreme temperatures
— all destructive enemies that can
have corrosive, degrading effects on
your electrical distribution system.**

**ABB Installation Products offers you
a wide selection of stainless steel
electrical system components —
including many innovative, industry-
exclusive products that save you time
and money, reduce inventory and
solve installation challenges.**

Table of contents

01. T&B® Fittings rigid conduit and fittings	06
02. T&B® Fittings cord and cable connectors	30
03. T&B Liquidtight Systems® flexible conduit and fittings	34
04. Kindorf® modular framing system	44
05. Superstrut® channels and accessories	52
06. T&B® Cable Tray cable support systems	60
07. Ty-Met™ cable ties	70
08. Catalog number index	80





01

T&B[®] Fittings rigid conduit and fittings



T&B® Fittings rigid conduit and fittings

Stainless steel rigid conduit and fittings

Conduit	8
Conduit couplings	9
Conduit nipples	10
Conduit elbows	12
Clamps, straps and hangers	14
Thread reducers and locknuts	18
Three-piece couplings	19
Hubs	20
Dome drains	23
Conduit bodies	24
Device boxes and covers	26
Explosion-proof flexible couplings	27

Stainless steel conduit, fittings and accessories

Stainless steel conduit



Withstand corrosive environments and meet stringent sanitary requirements.

For corrosion-resistant electrical conduit systems, stainless steel offers value and performance that's hard to match, combining high corrosion, chemical and temperature resistance with strength, durability, ease of installation and low maintenance. Compared to standard galvanized steel conduit in corrosive environments, type 304 stainless steel offers up to five times the lifespan, while type 316 offers up to eight times the lifespan. Because it is very easy to clean and its surface has no pores or cracks to harbor bacteria and other impurities, stainless steel also provides one of the most hygienic surfaces.

- Available in both type 304 and marine-grade type 316 stainless steel
- Features standard NPT threads for easy installation

- Each 10-ft. length of conduit ships with one stainless steel coupling included
- Couplings also sold separately
- Exceeds requirements for washdown applications
- Food- and potable water-safe
- Satisfies plant-cleanliness mandates from HACCP, FDA and various state agencies
- Meets ASTM A-321/SA-312 Standards
- UL/cUL listed

Typical applications

- Petrochemical refining/processing
- Water and wastewater treatment
- Food and beverage processing
- Marine and coastal facilities
- Pharmaceutical manufacturing
- Pulp and paper processing
- Other applications in corrosive environments or with strict hygiene requirements

Stainless steel rigid conduit

Cat. no.	Trade size (in.)	Weight (lbs./ft.)	Std. pkg. qty. ft.
Type 304 stainless steel conduit with coupling			
COND1/2SS	1/2	0.82	1,500
COND3/4SS	3/4	1.09	1,000
COND1SS	1	1.61	700
COND11/4SS	1 1/4	2.18	350
COND11/2SS	1 1/2	2.63	300
COND2SS	2	3.50	200
COND21/2SS	2 1/2	5.59	120
COND3SS	3	7.27	90
COND4SS	4	10.08	40
COND5SS	5	13.25	40
COND6SS	6	17.65	40



Cat. no.	Trade size (in.)	Weight (lbs./ft.)	Std. pkg. qty. ft.
Type 316 stainless steel conduit with coupling			
COND1/2SST	1/2	0.82	1,500
COND3/4SST	3/4	1.09	1,000
COND1SST	1	1.61	700
COND11/4SST	1 1/4	2.18	350
COND11/2SST	1 1/2	2.63	300
COND2SST	2	3.50	200
COND21/2SST	2 1/2	5.59	120
COND3SST	3	7.27	90
COND4SST	4	10.08	40
COND5SST	5	13.25	40
COND6SST	6	17.65	40

Note: Conduit sold in 10-ft. lengths. Each 10-ft. length ships with one coupling.

Conduit couplings

Type 304 and Type 316 stainless steel

Withstand corrosive environments and meet stringent sanitary requirements.



Stainless steel couplings — Type 304

Cat. no.	Trade size (in.)	Weight (lbs./ea.)	Std. pkg. qty.
CPL1/2SS	½	0.22	100
CPL3/4SS	¾	0.28	50
CPL1SS	1	0.39	30
CPL11/4SS	1¼	0.55	25
CPL11/2SS	1½	0.77	25
CPL2SS	2	1.10	20
CPL21/2SS	2½	2.09	12
CPL3SS	3	3.15	16
CPL4SS	4	4.29	10
CPL5SS	5	7.70	4
CPL6SS	6	10.15	4



Stainless steel couplings — Type 316

Cat. no.	Trade size (in.)	Weight (lbs./ea.)	Std. pkg. qty.
CPL1/2SST	½	0.17	100
CPL3/4SST	¾	0.29	50
CPL1SST	1	0.34	30
CPL11/4SST	1¼	0.37	25
CPL11/2SST	1½	0.61	25
CPL2SST	2	0.90	20
CPL21/2SST	2½	1.87	12
CPL3SST	3	1.93	16
CPL4SST	4	3.97	10
CPL5SST	5	7.70	4
CPL6SST	6	10.15	4

Conduit nipples

Type 304 and Type 316 stainless steel

Withstand corrosive environments and meet stringent sanitary requirements.



Conduit nipples

Type 304 stainless steel	Close	1½"	2"	2½"	3"	3½"
½	CLNPL1/2SS	NPL1/2X11/2SS	NPL1/2X2SS	NPL1/2X21/2SS	NPL1/2X3SS	NPL1/2X31/2SS
¾	CLNPL3/4SS	NPL3/4X11/2SS	NPL3/4X2SS	NPL3/4X21/2SS	NPL3/4X3SS	NPL3/4X31/2SS
1	CLNPL1SS	—	NPL1X2SS	NPL1X21/2SS	NPL1X3SS	NPL1X31/2SS
1¼	CLNPL11/4SS	—	NPL11/4X2SS	NPL11/4X21/2SS	NPL11/4X3SS	NPL11/4X31/2SS
1½	CLNPL11/2SS	—	NPL11/2X2SS	NPL11/2X21/2SS	NPL11/2X3SS	NPL11/2X31/2SS
2	CLNPL2SS	—	—	—	—	NPL2X31/2SS
2½	CLNPL21/2SS	—	—	—	—	—
3	CLNPL3SS	—	—	—	—	—

Type 316 stainless steel	Close	1½"	2"	2½"	3"	3½"
½	CLNPL1/2SST	NPL1/2X11/2SST	NPL1/2X2SST	NPL1/2X21/2SST	NPL1/2X3SST	NPL1/2X31/2SST
¾	CLNPL3/4SST	NPL3/4X11/2SST	NPL3/4X2SST	NPL3/4X21/2SST	NPL3/4X3SST	NPL3/4X31/2SST
1	CLNPL1SST	—	NPL1X2SST	NPL1X21/2SST	NPL1X3SST	NPL1X31/2SST
1¼	CLNPL11/4SST	—	NPL11/4X2SST	NPL11/4X21/2SST	NPL11/4X3SST	NPL11/4X31/2SST
1½	CLNPL11/2SST	—	NPL11/2X2SST	NPL11/2X21/2SST	NPL11/2X3SST	NPL11/2X31/2SST
2	CLNPL2SST	—	—	—	—	NPL2X31/2SST



4"	5"	6"	8"	10"	12"
NPL1/2X4SS	NPL1/2X5SS	NPL1/2X6SS	NPL1/2X8SS	NPL1/2X10SS	NPL1/2X12SS
NPL3/4X4SS	NPL3/4X5SS	NPL3/4X6SS	NPL3/4X8SS	NPL3/4X10SS	NPL3/4X12SS
NPL1X4SS	NPL1X5SS	NPL1X6SS	NPL1X8SS	NPL1X10SS	NPL1X12SS
NPL11/4X4SS	NPL11/4X5SS	NPL11/4X6SS	NPL11/4X8SS	NPL11/4X10SS	NPL11/4X12SS
NPL11/2X4SS	NPL11/2X5SS	NPL11/2X6SS	NPL11/2X8SS	NPL11/2X10SS	NPL11/2X12SS
NPL2X4SS	NPL2X5SS	NPL2X6SS	NPL2X8SS	NPL2X10SS	NPL2X12SS
—	NPL21/2X5SS	NPL21/2X6SS	NPL21/2X8SS	NPL21/2X10SS	NPL21/2X12SS
—	—	—	—	—	NPL3X12SS

4"	5"	6"	8"	10"	12"
NPL1/2X4SST	NPL1/2X5SST	NPL1/2X6SST	NPL1/2X8SST	NPL1/2X10SST	NPL1/2X12SST
NPL3/4X4SST	NPL3/4X5SST	NPL3/4X6SST	NPL3/4X8SST	NPL3/4X10SST	NPL3/4X12SST
NPL1X4SST	NPL1X5SST	NPL1X6SST	NPL1X8SST	NPL1X10SST	NPL1X12SST
NPL11/4X4SST	NPL11/4X5SST	NPL11/4X6SST	NPL11/4X8SST	NPL11/4X10SST	NPL11/4X12SST
NPL11/2X4SST	NPL11/2X5SST	NPL11/2X6SST	NPL11/2X8SST	NPL11/2X10SST	NPL11/2X12SST
NPL2X4SST	NPL2X5SST	NPL2X6SST	NPL2X8SST	NPL2X10SST	NPL2X12SST

Conduit elbows — standard radius 90°

Type 304 and Type 316 stainless steel



Withstand corrosive environments and meet stringent sanitary requirements.

Standard radius elbows 90°

Cat. no.	Trade size (in.)	Radius "R"	Offset "C"*	Straight end "D"*	Weight (lbs./ea.)	Std. pkg. qty.
Type 304 stainless steel elbows						
ELL1/2SS	½	4	5.50	1.50	0.64	25
ELL3/4SS	¾	4.5	6.00	1.50	0.92	25
ELL1SS	1	5.75	7.63	1.88	1.69	20
ELL11/4SS	1¼	7.25	9.25	2.00	2.66	8
ELL11/2SS	1½	8.25	10.25	2.00	3.67	8
ELL2SS	2	9.5	11.50	2.00	5.31	6
Type 316 stainless steel elbows						
ELL1/2SST	½	4	5.50	1.50	0.64	25
ELL3/4SST	¾	4.5	6.00	1.50	0.92	25
ELL1SST	1	5.75	7.63	1.88	1.69	20
ELL11/4SST	1¼	7.25	9.25	2.00	2.66	8
ELL11/2SST	1½	8.25	10.25	2.00	3.67	8
ELL2SST	2	9.5	11.50	2.00	5.31	6

Diagram

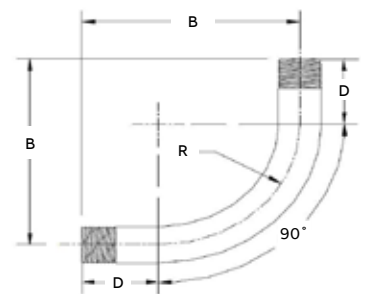

* Minimum

Conduit elbows — standard radius 45°

Type 304 and Type 316 stainless steel



Withstand corrosive environments and meet stringent sanitary requirements.

Standard radius elbows 45°

Cat. no.	Trade size (in.)	Radius "R"	Straight end "D"*	Weight (lbs./ea.)	Std. pkg. qty.
Type 304 stainless steel elbows					
ELL1/245SS	½	4	1.50	0.42	25
ELL3/445SS	¾	4.5	1.50	0.61	25
ELL145SS	1	5.75	1.88	1.11	20
ELL11/445SS	1¼	7.25	2.00	1.70	16
ELL11/245SS	1½	8.25	2.00	2.30	16
ELL245SS	2	9.5	2.00	3.10	9
Type 316 stainless steel elbows					
ELL1/245SST	½	4	1.50	0.42	25
ELL3/445SST	¾	4.5	1.50	0.61	25
ELL145SST	1	5.75	1.88	1.11	20
ELL11/445SST	1¼	7.25	2.00	1.70	16
ELL11/245SST	1½	8.25	2.00	2.30	16
ELL245SST	2	9.5	2.00	3.10	9

Diagram

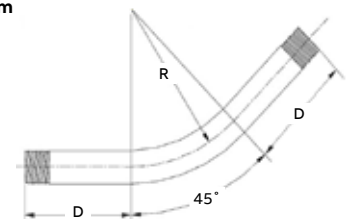

* Minimum

Pipe straps

Type 304 stainless steel



Support and securely fasten rigid, IMC and EMT conduit.

- Type 304 stainless steel
- Higher degree of corrosion resistance than traditional zinc-plated or hot-dipped galvanized straps
- One- and two-hole straps for EMT sizes ½" through 2"
- One- and two-hole straps for rigid and IMC sizes ½" through 4"

Type 304 stainless steel pipe straps

Cat. no.	Trade size (in.)	Wt. per 100	Hole dia. (in.)	Std. pkg.
One-hole EMT straps				
TS101-SS	½	2.21	¼	25
TS102-SS	¾	2.49	¼	25
TS103-SS	1	3.31	¼	25
TS104-SS	1¼	3.64	11/16	10
TS105-SS	1½	3.87	11/16	5
TS106-SS	2	4.03	11/16	5
One-hole rigid/IMC straps				
HS100-SS	¾	2.00	9/32	20
HS101-SS	½	2.21	9/32	20
HS102-SS	¾	2.49	9/32	20
HS103-SS	1	3.48	9/32	20
HS104-SS	1¼	3.76	11/32	10
HS105-SS	1½	18.22	13/32	10
HS106-SS	2	19.69	13/32	5
HS107-SS	2½	67.21	15/32	5
HS108-SS	3	76.45	17/32	5
HS110-SS	4	80.18	17/32	5

Cat. no.	Trade size (in.)	Wt. per 100	Hole dia. (in.)	Std. pkg.
Two-hole EMT straps				
TS901-SS	½	2.21	¼	25
TS902-SS	¾	3.31	¼	25
TS903-SS	1	3.87	¼	25
TS904-SS	1¼	7.54	11/16	10
TS905-SS	1½	12.21	11/16	5
TS906-SS	2	18.23	11/16	5
Two-hole rigid/IMC straps				
HS901-SS	½	2.49	9/32	20
HS902-SS	¾	3.64	9/32	20
HS903-SS	1	4.15	9/32	20
HS904-SS	1¼	8.17	11/32	10
HS905-SS	1½	17.50	13/32	10
HS906-SS	2	21.37	13/32	5
HS907-SS	2½	21.54	15/32	5
HS908-SS	3	25.72	17/32	5
HS909-SS	3½	27.27	17/32	5
HS910-SS	4	31.70	17/32	5

Pipe straps

Type 316 stainless steel



Support and securely fasten rigid conduit.

- Type 316 stainless steel
- Higher degree of corrosion resistance than traditional zinc-plated or hot-dipped galvanized straps
- One- and two-hole straps for rigid and IMC sizes ½" through 4"

Type 316 stainless steel pipe straps

Cat. no.	Trade size (in.)	Hole dia. (in.)	Wt. per 100 (lbs.)
One-hole rigid/IMC stainless steel 316 straps			
HS101SST	½	0.25	4
HS102SST	¾	0.25	5
HS103SST	1	0.31	8
HS104SST	1¼	0.38	12
HS105SST	1½	0.44	15
HS106SST	2	0.56	24
HS107SST	2½	0.56	43
HS108SST	3	0.56	47
HS110SST	4	0.56	72

Cat. no.	Trade size (in.)	Hole dia. (in.)	Wt. per 100 (lbs.)
Two-hole rigid/IMC stainless steel 316 straps			
HS901SST	½	0.19	2
HS902SST	¾	0.19	3
HS903SST	1	0.25	4
HS904SST	1¼	0.25	6
HS905SST	1½	0.25	9
HS906SST	2	0.38	11
HS907SST	2½	0.38	16
HS908SST	3	0.38	20
HS910SST	4	0.44	29

Beam clamps

Type 316 stainless steel

- For mounting pipe or conduit at right angles to the beam
- Type 316 stainless steel



Type 316 stainless steel right-angle clamps



Cat. no.	Dimensions (in.) nom. conduit or pipe size	O.D. of conduit or pipe (in.)	Std. ctn.
RC1/2SST	½	0.840	50
RC3/4SST	¾	1.050	25
RC1SST	1	1.315	25
RC11/4SST	1¼	1.660	25
RC11/2SST	1½	1.900	10
RC2SST	2	2.375	10



Type 316 stainless steel beam clamps



Cat. no.	Base size (in.)		Jaw opening (in.)	Tapping of base and back holes	Set screw load rating [†]	Torque in inch-lbs.	Std. ctn.
	A	B					
500SS316	1	1¼	1½/₁₆	¼-20	250	60	50
502SS316	2	2	1	¾-16	750	120	50
503SS316	2⅝	2½	1	½-13	1,250	250	20

Diagrams

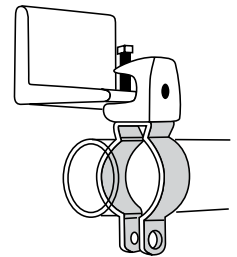
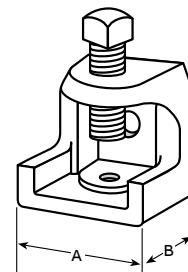

[†]Safety factor of 3.

Load ratings based on bottom hole of beam clamp.
CSA File No. LR-52208.

6H series conduit and pipe hangers

Type 302 stainless steel



6H hanger bolts include a combination slot-Phillips head.

For hanging conduit (rigid or EMT) and pipe.
The 6H series hangers are fast, easy and economical to use. May be fastened directly

to a #500 beam clamp through a hole in the base of the hanger by means of a ¼–20 stove bolt or suspended on ¼" hanger rod.

6H series conduit and pipe hangers — without bolt



Cat. no.	Rigid conduit or pipe size (in.)	EMT size (in.)	Dimensions (in.)				Load rating	Std. ctn.
			A	B	C	D (dia.)		
6H0SS	3/8–1/2	1/2	3/4	0.045	1 ²¹ / ₃₂	9/32	500	100
6H1SS	3/4	3/4	7/8	0.045	1 ³¹ / ₃₂	9/32	500	100
6H2SS	1	1	7/8	0.045	2 ³ / ₈	9/32	500	100
6H5SS	2	2	1 ¹ / ₄	0.071	3 ²⁹ / ₃₂	1 ¹ / ₃₂	500	50

Diagrams

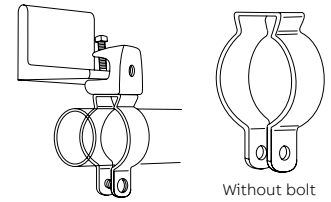

UL File No. E-160899.
Load rating is 500 lbs. with a safety factor of 3.
Available with or without closure bolt.

6H series conduit and pipe hangers — with bolt



Cat. no.	Rigid conduit or pipe size (in.)	EMT size (in.)	Dimensions (in.)				Load rating	Std. ctn.
			A	B	C	D (dia.)		
6H0 BSS	3/8–1/2	1/2	3/4	0.045	1 ²¹ / ₃₂	9/32	500	100
6H1-BSS	3/4	3/4	7/8	0.045	1 ³¹ / ₃₂	9/32	500	100
6H2-BSS	1	1	7/8	0.045	2 ³ / ₈	9/32	500	100
6H3-BSS	1 ¹ / ₄	1 ¹ / ₂	7/8	0.045	2 ⁷ / ₈	9/32	500	100
6H4-BSS	1 ¹ / ₂	–	1	0.071	3 ³ / ₈	1 ¹ / ₃₂	500	100
6H5-BSS	2	2	1 ¹ / ₄	0.071	3 ²⁹ / ₃₂	1 ¹ / ₃₂	500	50
6H6-BSS	2 ¹ / ₂	–	1 ¹ / ₄	0.071	4 ⁹ / ₃₂	1 ¹ / ₃₂	500	50
6H7-BSS	3	–	1 ¹ / ₄	0.071	5 ³ / ₁₆	1 ¹ / ₃₂	500	25
6H8-BSS	3 ¹ / ₂	–	1 ¹ / ₄	0.071	5 ⁷ / ₁₆	1 ¹ / ₃₂	500	25
6H9-BSS	4	4	1 ¹ / ₄	0.071	5 ⁷ / ₈	1 ¹ / ₃₂	500	10

Diagrams

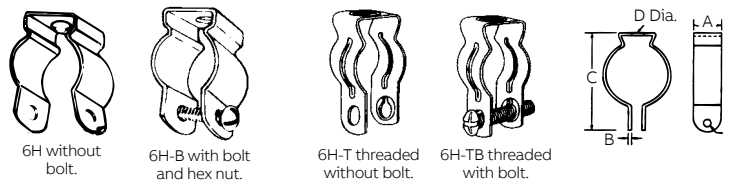

UL File No. E-160899.
Load rating is 500 lbs. with a safety factor of 3.
Available with or without closure bolt.

01

Threaded reducers and locknuts

Type 316 stainless steel

- Reduces threaded opening in conduit bodies or any female threaded fitting
- Smooth, built-in bushing completely covers rough ends of conduit
- Type 316 stainless steel



Type 316 stainless steel threaded reducers



Cat. no.	Trade size	B(Ø)±0.01	Dimensions (in.)	
			E	C
RB21SST	¾ x ½	0.870	0.150	0.559
RB31SST	1 x ½	1.110	0.150	0.630
RB32SST	1 x ¾	1.110	0.150	0.630
RB42SST	1½ x ¾	1.429	0.150	0.701
RB43SST	1½ x 1	1.429	0.201	0.701
RB65SST	2 x 1½	2.098	0.201	0.858
RB76SST	2½ x 2	2.504	0.201	1.016

Diagram

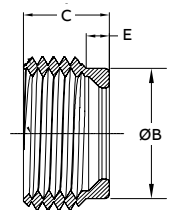

Type 316 stainless steel locknuts



Cat. no.	Trade size	E	Dimensions (in.)	
			O.D.	Thickness (T)
RLN12SST	½-14	0.24	1.13	0.13
RLN34SST	¾-14	0.25	1.38	0.15
RLN1SST	1-11.5	0.26	1.72	0.17
RLN114SST	1¼-11.5	0.44	2.07	0.17
RLN112SST	1½-11.5	0.31	2.38	0.17
RLN2SST	2-11.5	0.44	2.89	0.19
RLN212SST	2½-8	0.47	3.70	0.39
RLN3SST	3-8	0.47	4.29	0.39
RLN312SST	3½-8	0.47	4.80	0.39
RLN4SST	4-8	0.47	5.31	0.39

Diagrams

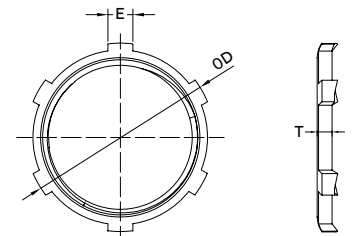

Threaded three-piece couplings

Type 316 stainless steel

01 675SST series — With a three-piece coupling, a conduit run may be completed when neither conduit can be turned. A conduit run may also be broken without taking down the entire run. Conduit joined with three-piece couplings is rigid and in line, and vibration will not loosen the connections.

For threaded rigid stainless steel conduit.

Application

- To couple and effectively bond threaded ends of rigid stainless steel conduit where neither length of conduit can be rotated

Features

- 316 stainless steel construction
- Free-fitting threads ensure easy assembly
- Permits conduit coupling without rotating either conduit
- Provides rigid in-line coupling with high-quality grounding; will not loosen under vibration
- Suitable for concrete-tight application

Standard material

- Type 316 stainless steel

Range

- ½" through 2" conduit
- All straight pipe threads (NPS)

Listings/compliances

- UL 514B
- CSA C22.2 No. 18
- cUL
- NEMA FB1



01

Type 316 stainless steel threaded three-piece coupling



Cat. no.	Conduit trade size	Dimensions (in.)	
		A	B
675SST	½	1.10	1.26
676SST	¾	1.10	1.56
677SST	1	1.38	1.73
678SST	1¼	1.91	2.28
679SST	1½	1.92	2.52
680SST-TB	2	2.47	3.11

Diagram

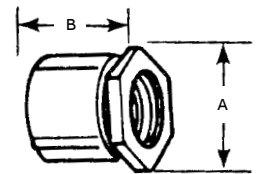

T&B® grounding hub

Type 316 stainless steel

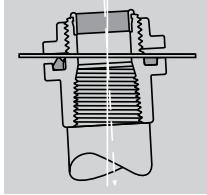

Designed for unequalled performance. Never before has a single hub fit like this one. The innovative engineering of the T&B® grounding hub will raise your performance expectations for threaded hubs. Look for the distinctive blue color to ensure the quality of a T&B® Fittings product.

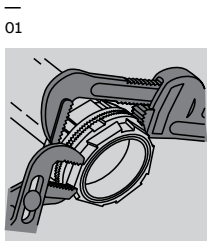

1 Sealing ring and groove with innovative profile outperforms standard O-ring design. Sealing ring is captivated in place before installation and resists buckling or slipping during installation. The seal groove is designed for optimum compression of the sealing ring. The sealing ring is designed to provide a complete 360° seal, even when the conduit is not perpendicular with the enclosure. (See figure 1.)

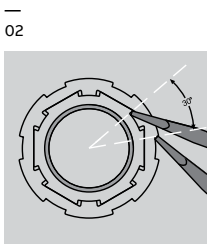

2 Locknut design with peripheral slots and a hexagonal/angled spline every 30° enables easy application of torque with wrench or hammer and screwdriver. (See figures 2 and 3.)



3 Sharper and deeper teeth on locknut and body designed for a more penetrating bite for improved bonding to the enclosure.

4 Hexagonal/splined body design for fast, easy installation with wrench or hammer and screwdriver.

5 Precision machined tapered threads designed to create watertight union.

6 Insulated throat molded from 105 °C rated thermoplastic with a flammability rating of UL 94V-O.

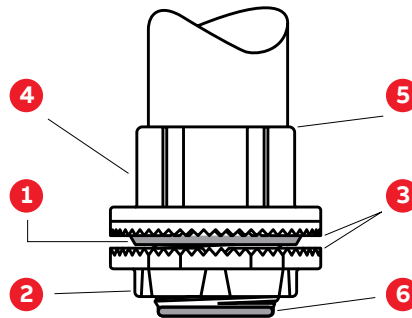

T&B® grounding hub



Cat. no.	Trade size	A	B	C	D	E
				Max. panel Dia.	Max. panel thickness	Throat dia.
H050GRSST	½"	1 1/16"	1 1/16"	7/8"	3/16"	1 1/32"
H075GRSST	¾"	1 1/16"	1 19/32"	2 9/32"	3/16"	2 5/32"
H100GRSST	1"	2"	1 13/16"	1 1/16"	¼"	1"
H125GRSST	1 ¼"	2 3/8"	1 7/8"	1 1/16"	¼"	1 5/16"
H150GRSST	1 ½"	2 ¾"	1 7/8"	1 1/16"	¼"	1 17/32"
H200GRSST	2"	3 ¼"	1 15/16"	1 5/32"	¼"	1 31/32"

Diagram

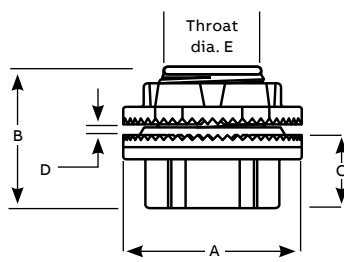

T&B® grounding hub centerline spacing chart

Conduit trade size	½"	¾"	1"	1 ¼"	1 ½"	2"
½"	1 9/16"	—	—	—	—	—
¾"	1 43/64"	1 25/32"	—	—	—	—
1"	1 27/32"	1 61/64"	2 1/8"	—	—	—
1 ¼"	2 1/32"	2 9/64"	2 5/16"	2 1/2"	—	—
1 ½"	2 7/32"	2 21/64"	2 1/2"	2 11/16"	2 7/8"	—
2"	2 15/32"	2 37/64"	2 3/4"	2 15/16"	3 1/8"	3 3/8"
Nearest obstruction to center of hub	2 7/32"	6 1/64"	1 1/8"	1 5/16"	1 1/2"	1 3/4"

Hub and locknut: Type 316 stainless steel
 Insulating throat: Thermoplastic
 Temp. rating of 105° C
 Flammability rating of UL 94-V0
 Sealing ring: Nitrile (BUNA "N")
 Meets NEMA sealing requirements for NEMA 3R, 4 and 13 enclosures
 UL listed and CSA certified; CSA certified for hazardous locations
 Class II Groups E, F, G, Class III (NEC 501.10B)
 UL File No. E-23018, CSA File No. 4484

T&B® grounding and bonding locknut

Type 316 stainless steel

T&B® grounding and bonding locknut



	Cat. no.	Trade size	Dia.	Height	Ground screw	Max. conductor size
	L050GR-SST	1/2"	1 1/2	1 3/32	#10-32 x 1/4"	#10
	L075GR-SST	3/4"	1 11/16	1 3/32	#10-32 x 1/4"	#10
	L100GR-SST	1"	2	1 3/32	#10-32 x 1/4"	#10
	L125GR-SST	1 1/4"	2 3/8	1 5/32	1/4-20 x 1/4"	#10
	L150GR-SST	1 1/2"	2 3/4	1 5/32	1/4-20 x 5/16"	#8
	L200GR-SST	2"	3 1/4	1 5/32	1/4-20 x 5/16"	#8

Diagram

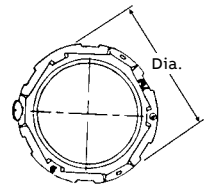

Material – Type 316 stainless steel

UL File No. E-3060

CSA File No. 4484

Cylinder conduit hub

Type 316 stainless steel

01 Type 316 stainless steel conduit hub

02 When installed on conduit, the hub's TPE seal covers the exposed conduit threads

Stainless steel conduit hub provides a Type 4X connection means between conduit and enclosure.

Features

- Compact body design and gasket helps make the conduit hub suitable for installation in tight spaces
- Conduit seal is extended to cover threads on conduit
- Conduit hub offers UL Type 4X, IP66 and IP67 ratings and is suitable for wash-down areas

Applications

- For use with stainless steel electrical enclosures and conduit
- Food and beverage facilities

Conforms to

- UL listed, Type 4X, IP66 and IP67 rated

Material/finishes

- Type 316 stainless steel (corrosion resistance)
- TPE seal material (FDA compliant)



01

02

Type 316 stainless steel conduit hub



Dimensions (in.)

Cat. no.	Trade size	A (NPT)	B (NPT)	C	D	E	F	G
H050FGSST	½	½	½	1.181	0.945	0.709	1.571	0.583
H075FGSST	¾	¾	¾	1.417	1.378	0.984	1.701	0.598
H100FGSST	1	1	1	1.811	1.811	1.181	1.984	0.697
H125FGSST	1¼	1¼	1¼	2.126	2.165	1.535	2.165	0.724
H150FGSST	1½	1½	1½	2.480	2.362	1.772	2.256	0.724
H200FGSST	2	2	2	3.032	2.913	2.205	2.496	0.724

Diagrams

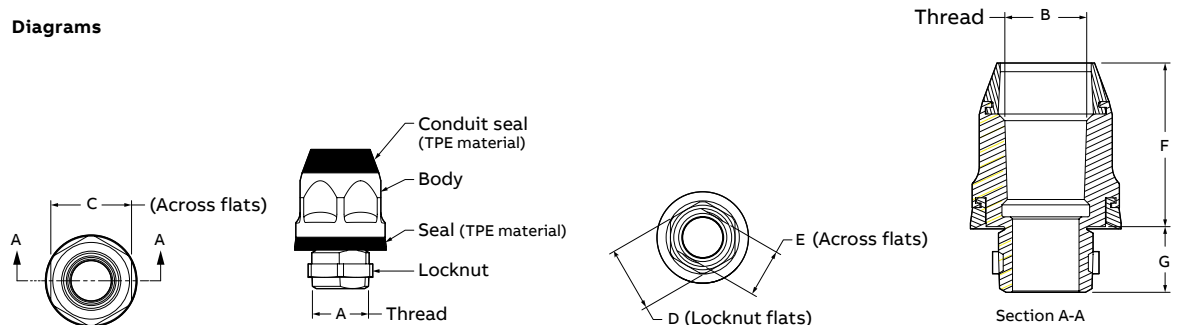

Note: Product must be installed in accordance with applicable national and local electrical codes.

Dome drain

Type 316 stainless steel

- 01 Dome drain
- 02 Dome drain with filter (-FLTR)
- 03 FBDRFLTR

Conduit dome drain continuously drains accumulated moisture or small debris from electrical enclosures.

Features

- Compact body design and gasket makes the drain suitable for installation in tight spaces
- One-piece stainless steel construction helps ensure no metallic parts can be dislodged by cleaning practices
- No moving parts for long-lasting performance
- UL Type 4X rating, and is designed to meet IP56 requirements for wash-down areas
- Slots on thread body and locknut help provide a steady drain path
- Optional internal wire mesh screen filter (FBDR12SST-FLTR and FBDR34SST-FLTR)

Applications

- For use on electrical enclosures
- Food and beverage facilities

Material/finishes

- Type 316 stainless steel (corrosion resistant)
- TPE seal material (FDA compliant)

Conforms to

- UL listed, Type 4X
- NSF certified per NSF/ANSI standard 169 for food and beverage application
- Tested to meet IP56 requirements



01

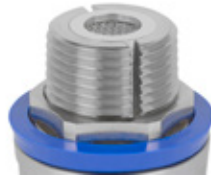

02



03

Type 316 stainless steel dome drain



Cat. no.	Dimensions (in.)					
	A (NPT)	B	C	D	E	F
FBDR12SST	½	0.781	1.224	0.984	0.937	1.063
FBDR12SST-FLTR	½	0.781	1.224	0.984	0.937	1.063
FBDR34SST	¾	0.793	1.614	1.181	1.098	1.417
FBDR34SST-FLTR	¾	0.793	1.614	1.181	1.098	1.417
FBDRFLTR	—	0.669	0.622	0.049	0.669	—

Diagrams

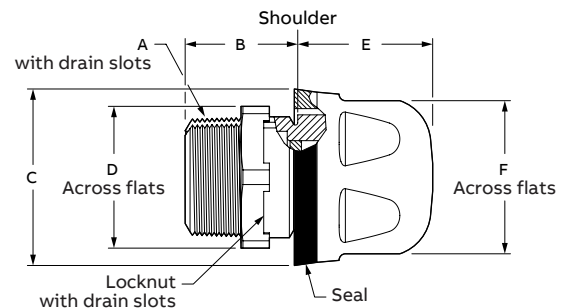
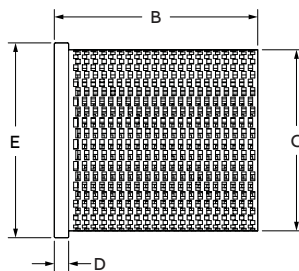

Note: Product must be installed in accordance with applicable national and local electrical codes.

Form 8 conduit bodies

Type 316 stainless steel — Now with smooth hygienic markings

Each conduit outlet body ships complete with gasket, cover and screws.



LU Form 8 conduit bodies with covers



Cat. no.	Hub size (in.)	Dimensions (in.)							Cu. in.
		A	B	C	D	E	F		
LU18SST-TB	1/2	6.210	1.450	3.825	1.125	4.320	3.700	5.5	
LU28SST-TB	3/4	6.981	1.645	4.245	1.500	4.921	4.300	8.5	
LU38SST-TB	1	8.261	1.850	5.050	1.700	5.625	5.000	14.5	
LU48SST-TB	1 1/4	9.923	2.200	5.975	2.200	6.730	5.810	26.5	
LU58SST-TB	1 1/2	11.549	2.813	7.000	2.450	7.938	7.125	45.0	
LU68SST-TB	2	13.989	3.820	8.500	2.900	9.797	9.125	116.5	

Diagrams

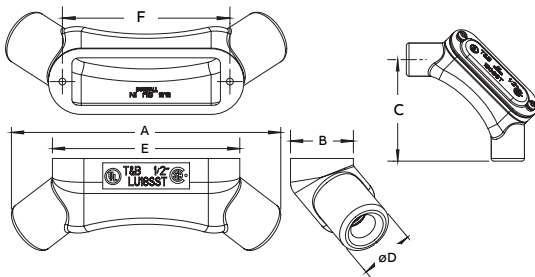

T Form 8 conduit bodies with covers



Cat. no.	Hub size (in.)	Dimensions (in.)							Cu. in.
		A	B	C	D	E	F		
T18SST-TB	1/2	5.820	1.450	2.200	1.150	4.320	3.700	5.5	
T28SST-TB	3/4	6.420	1.645	2.395	1.400	4.921	4.300	9.0	
T38SST-TB	1	7.500	1.850	2.850	1.750	5.625	5.000	13.5	
T48SST-TB	1 1/4	8.738	2.200	2.950	2.200	6.730	5.810	24.0	
T58SST-TB	1 1/2	10.046	2.813	3.867	2.450	7.938	7.125	45.0	
T68SST-TB	2	12.204	3.820	5.070	2.900	9.797	9.125	88.0	
T78SST-TB	2.5	15.659	4.575	6.561	4.250	10.875	-	220	

Diagrams

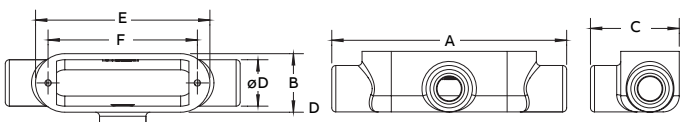

LB Form 8 conduit bodies with covers



Cat. no.	Hub size (in.)	Dimensions (in.)							Cu. in.
		A	B	C	D	E	F		
LB18SST-TB	1/2	5.070	1.450	2.250	1.150	4.320	3.700	5.8	
LB28SST-TB	3/4	5.671	1.645	2.530	1.400	4.921	4.300	8.0	
LB38SST-TB	1	6.563	1.850	2.913	1.750	5.625	5.000	13.0	
LB48SST-TB	1 1/4	7.734	2.200	3.315	2.200	6.730	5.810	23.0	
LB58SST-TB	1 1/2	8.992	2.813	3.800	2.450	7.938	7.125	44.0	
LB68SST-TB	2	11.000	3.820	4.810	2.900	9.797	9.125	88.0	

Diagrams

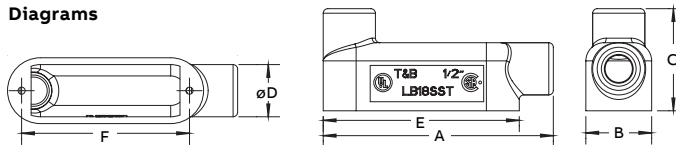

TB Form 8 conduit bodies with covers



Cat. no.	Hub size (in.)	Dimensions (in.)							Cu. in.
		A	B	C	D	E	F		
TB18SST-TB	1/2	5.820	1.450	2.250	1.150	4.320	3.700	5.5	
TB28SST-TB	3/4	6.420	1.645	2.530	1.400	4.921	4.300	9.0	
TB38SST-TB	1	7.500	1.850	2.975	1.750	5.625	5.000	13.5	
TB48SST-TB	1 1/4	8.484	2.200	3.319	2.200	6.730	5.810	24.0	
TB58SST-TB	1 1/2	10.046	2.813	3.854	2.450	7.938	7.125	45.0	
TB68SST-TB	2	12.129	3.820	4.810	2.900	9.797	9.125	88.0	

Diagrams

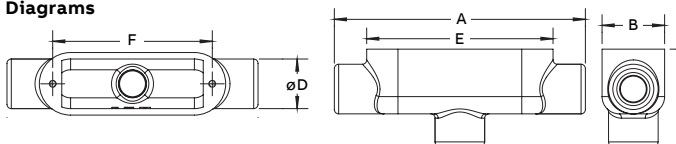

Listings/compliances

- UL Standard: 514A, 514B
- Fed. Spec: W-C-586D
- CSA Standard: C22.2 No. 18
- NEMA 4X

01

Form 8 conduit bodies

Type 316 stainless steel — Now with smooth hygienic markings



C Form 8 stainless steel conduit bodies with covers



Cat. no.	Hub size (in.)	Dimensions (in.)					
		A	B	C	D	E	Cu. in.
C18SST-TB	½	5.936	1.5	1.452	1.152	3.28	5.8
C28SST-TB	¾	6.601	1.780	1.645	1.345	3.925	8.0
C38SST-TB	1	7.643	1.975	1.850	1.550	4.550	13.0

Diagrams

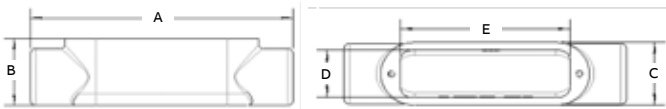

LR Form 8 stainless steel conduit bodies with covers



Cat. no.	Hub size (in.)	Dimensions (in.)					
		A	B	C	D	E	Cu. in.
LR28SST-TB	¾	5.761	1.780	2.4855	1.345	3.925	8.0
LR38SST-TB	1	6.634	1.975	2.859	1.550	4.550	13.0

Diagrams

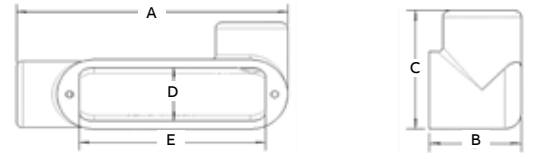

LL Form 8 stainless steel conduit bodies with covers



Cat. no.	Hub size (in.)	Dimensions (in.)					
		A	B	C	D	E	Cu. in.
LL18SST-TB	½	5.087	1.500	2.273	1.152	3.280	5.8
LL28SST-TB	¾	5.704	1.780	2.4855	1.345	3.925	8.0
LL38SST-TB	1	6.634	1.975	2.859	1.550	4.550	13.0

Diagrams

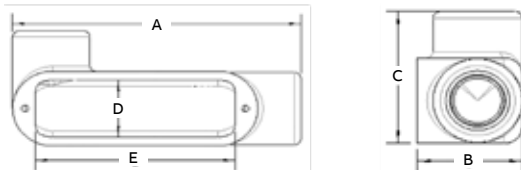

X Form 8 stainless steel conduit bodies with covers



Cat. no.	Hub size (in.)	Dimensions (in.)					
		A	B	C	D	E	Cu. in.
X28SST-TB	¾	6.775	2.000	3.455	1.345	3.925	9.0
X38SST-TB	1	7.643	2.275	3.868	1.500	4.550	13.5

Diagrams

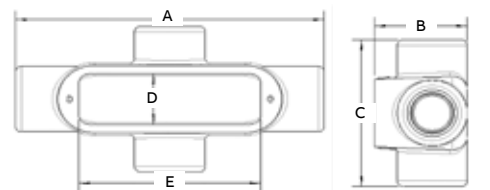

Device boxes and covers

Type 316 stainless steel



Features

- All hubs have NPT threads with a minimum of five full threads and integral bushing
- Internal grounding screw standard on boxes
- Suitable for wet locations when used with gasketed covers
- All cover holes are #6–32

Application

- Accommodate wiring devices
- Act as pull boxes for conductors in a threaded rigid conduit system, including an internal ground screw
- Provide openings to make splices and taps in conductors
- Provide access to conductors for maintenance and future system changes
- Connect conduit sections

Materials

- Bodies/covers: 316 stainless steel
- Gaskets: Neoprene
- Finish: Polished 316 stainless steel

Listings/compliances

- UL 514A (wet locations when used with gasketed covers)
- CSA C22.2 No. 18

Type 316 stainless steel deep single-gang cast device boxes



Cat. no.	Fig.	Hub size (in)	Outside depth	Dimensions (in.)		
				B	C	D
FD2SST	A	3/4	2.90	3.09	4.54	0.78
FDA2SST	B	3/4	2.90	3.09	4.54	0.78
FDC2SST	C	3/4	2.90	3.09	4.54	0.78
FDS2SST	D	3/4	2.90	3.09	4.54	0.78
FDX2SST	E	3/4	2.90	3.09	4.54	0.78

Diagrams

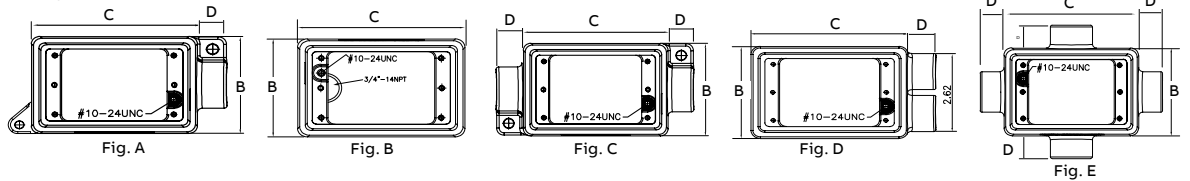

Type 316 stainless steel single-gang covers

Cat. no.	Description
FBCS2SST	Blank, sheet stainless steel
FBCM2SST	Blank, cast stainless steel
RCS2SST	Duplex receptacle, stainless steel
SWCS2SST	Single switch, stainless steel

Diagrams

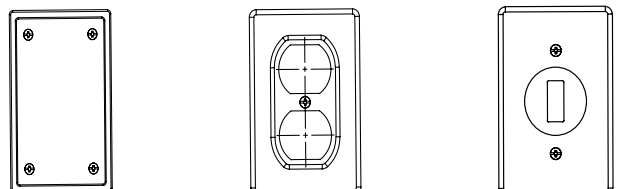

XP Flex™ explosion-proof flexible couplings

Type 316 stainless steel



Used to make flexible connections in hazardous locations.

Applications

- Used to achieve tight bends in conduit systems in confined spaces
- Can be used to connect stationary equipment to equipment that vibrates

Features

- Corrosion-resistant design — ideal for washdown areas
- Flexible construction with arc-resistant inner sleeve
- Terminated with two threaded male end fittings
- NPT threads

Standard materials

- Body: Flexible stainless steel 316
- Fitting: Stainless steel 316

Listings/compliances

- cULus listed – UL 1203
- Class I Div 1 Groups A, B, C, D: ½"–¾"
- Class I Div 1 Groups C, D: 1"–2"
- Class II Div 1 Groups E, F, G: ½"–2"
- IP69 rated for wet locations

Explosion-proof flexible couplings – stainless steel



Diagrams

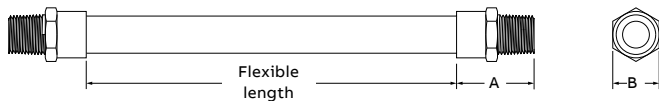

Cat. no.	Hub size (in.)	Flexible length (in.)	Dimensions (in.)	
			A	B
XPLFL16S	½	6	1.73	1.34
XPLFL18S	½	8	1.73	1.34
XPLFL110S	½	10	1.73	1.34
XPLFL112S	½	12	1.73	1.34
XPLFL115S	½	15	1.73	1.34
XPLFL118S	½	18	1.73	1.34
XPLFL121S	½	21	1.73	1.34
XPLFL124S	½	24	1.73	1.34
XPLFL127S	½	27	1.73	1.34
XPLFL130S	½	30	1.73	1.34
XPLFL133S	½	33	1.73	1.34
XPLFL136S	½	36	1.73	1.34
XPLFL24S	¾	4	1.73	1.77
XPLFL26S	¾	6	1.73	1.77
XPLFL28S	¾	8	1.73	1.77
XPLFL210S	¾	10	1.73	1.77
XPLFL212S	¾	12	1.73	1.77
XPLFL215S	¾	15	1.73	1.77
XPLFL218S	¾	18	1.73	1.77
XPLFL221S	¾	21	1.73	1.77
XPLFL224S	¾	24	1.73	1.77
XPLFL227S	¾	27	1.73	1.77
XPLFL230S	¾	30	1.73	1.77
XPLFL233S	¾	33	1.73	1.77
XPLFL236S	¾	36	1.73	1.77

Note: Product must be installed in accordance with applicable national and local electrical codes.

XP Flex™ explosion-proof flexible couplings

Type 316 stainless steel

Explosion-proof flexible couplings – stainless steel



Diagrams	Cat. no.	Hub size (in.)	Flexible length (in.)	Dimensions (in.)	
				A	B
	XPLFL36S	1	6	2.13	2.05
	XPLFL38S	1	8	2.13	2.05
	XPLFL310S	1	10	2.13	2.05
	XPLFL312S	1	12	2.13	2.05
	XPLFL315S	1	15	2.13	2.05
	XPLFL318S	1	18	2.13	2.05
	XPLFL321S	1	21	2.13	2.05
	XPLFL327S	1	27	2.13	2.05
	XPLFL330S	1	30	2.13	2.05
	XPLFL333S	1	33	2.13	2.05
	XPLFL336S	1	36	2.13	2.05
	XPLFL412S	1¼	12	2.13	2.56
	XPLFL415S	1¼	15	2.13	2.56
	XPLFL418S	1¼	18	2.13	2.56
	XPLFL421S	1¼	21	2.13	2.56
	XPLFL424S	1¼	24	2.13	2.56
	XPLFL427S	1¼	27	2.13	2.56
	XPLFL430S	1¼	30	2.13	2.56
	XPLFL433S	1¼	33	2.13	2.56
	XPLFL436S	1¼	36	2.13	2.56
	XPLFL512S	1½	12	2.56	3.19
	XPLFL515S	1½	15	2.56	3.19
	XPLFL518S	1½	18	2.56	3.19
	XPLFL521S	1½	21	2.56	3.19
	XPLFL524S	1½	24	2.56	3.19
	XPLFL527S	1½	27	2.56	3.19
	XPLFL530S	1½	30	2.56	3.19
	XPLFL533S	1½	33	2.56	3.19
	XPLFL536S	1½	36	2.56	3.19
	XPLFL612S	2	12	2.6	3.19
	XPLFL615S	2	15	2.6	3.19
	XPLFL618S	2	18	2.6	3.19
	XPLFL621S	2	21	2.6	3.19
	XPLFL624S	2	24	2.6	3.19
	XPLFL627S	2	27	2.6	3.19
	XPLFL630S	2	30	2.6	3.19
XPLFL633S	2	33	2.6	3.19	
XPLFL636S	2	36	2.6	3.19	

Note: Product must be installed in accordance with applicable national and local electrical codes.



02

T&B® Fittings cord and cable connectors



T&B® Fittings cord and cable connectors

T&B® Fittings cord and cable connectors

Series FSCG and FSEM one-piece cable glands

32

Ranger® liquid-tight cord connectors

33

Series FSCG and FSEM one-piece cable glands

Type 316 stainless steel



FSCG

Series FSCG cable glands

- UL listed
- NSF “splash zone” rated
- IP66, IP68 and IP69 ingress ratings
- Stainless steel, corrosion-resistant construction

Series FSEM cable glands

- NSF “splash zone” rated
- IEMC protection
- IP66, IP67, IP68 and IP69 ingress ratings
- Stainless steel, corrosion-resistant construction



FSEM

Series FSCG and FSEM cable glands — stainless steel

One-piece cable glands			
Corrosive environment — stainless steel			
Note: Locknuts ordered separately.			
Ingress ratings		NEMA Type 4, 4X, 6 and IEC IP69	
Orientation	Straight	Straight	Cable range (min.–max. in.)
Trade size	Part no.	Part no.	
3/8"	FSCG-0381	–	0.118–0.256
	FSCG-0382	FSEM-0381	0.197–0.394
1/2"	FSCG-0501	FSEM-0502	0.236–0.472
3/4"	FSCG-0751	FSEM-0751	0.472–0.669

Ranger® liquid-tight cord connectors

Type 304 stainless steel



Type 304 stainless construction for your harshest environments. Until now, there's been no ideal solution for liquid-tight connections of portable cord to a box or enclosure in corrosive environments. Steel connectors rust, and non-metallic connectors can't withstand high temperatures or ultraviolet exposure.

ABB Installation Products has developed the latest addition to its high-performance line of Ranger cord connectors. Made of Type 304 stainless steel, Ranger stainless steel liquid-tight cord connectors stand up to highly corrosive environments — such as washdown areas in food and beverage or pharmaceutical processing — as well as high temperatures and UV exposure.

Application

- Provide means for passing a cord cable into an enclosure, through a bulkhead or into rigid conduit
- Form a mechanical grip and water and/or oil-resistant seal for cord
- Form a non-slip connection or termination for flexible cord

Cord and cable type

- SJ, SJE, SJEO, SJEOO, SJO, SJOW, SJOO, SJOOW, SJT, SJTW, SJTO, SJTOW, SJTOO, SJTOOW, SO, SOW, SOO, SOOW, SV, ST, STD, SVD

Features

- Extended range with superior strain relief
- Reduced overall size, fits into tighter spaces
- Gland nut designed to restrict cable bending

Materials

Body, gland nut, grip	Type 304 stainless steel
Bushing	Thermoplastic rubber
Grip ring	Nylon
O-ring (supplied)	Buna N

Environment classification

Ordinary locations (wet or dry)	
Temperature rating	-20° C to 105° C (-4° F to 221° F)

Range

Cord range	0.125" to 0.950"
Hub size range	½" to 1"

Listings/compliances

¼" and ⅜" sizes	UL recognized
½" through 1" sizes	UL listed and CSA certified for use with portable cord; UL 514B liquid-tight cord connectors; UL Type 6 and 4X

Stainless steel cable glands — ¼"-⅜" hub sizes



Cat. no.	Hub size (in.)	Cord dia. range (in.)	Dimensions (in.)			Std. pkg. qty.
			A	B	C	
2918SST	¼	0.118–0.256	1.000	0.250	0.625	25
2919SST	⅜	0.157–0.315	1.313	0.438	0.750	25

Diagrams

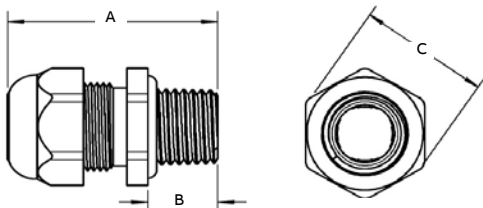

Stainless steel liquid-tight strain-relief cord connectors — ½"-1" hub sizes



Cat. no.	Hub size (in.)	Cord dia. range (in.)	Dimensions (in.)			Std. pkg. qty.
			A	B	C	
2920SST	½	0.125–0.375	1.935	0.610	1.125	25
2921SST	½	0.310–0.560	1.935	0.610	1.125	25
2922SST	½	0.500–0.750	2.003	0.610	1.125	25
2930SST	¾	0.125–0.375	2.063	0.630	1.125	10
2931SST	¾	0.310–0.560	2.063	0.630	1.125	10
2932SST	¾	0.500–0.750	2.063	0.630	1.125	10
2940SST	1	0.310–0.560	2.178	0.785	1.500	10
2941SST	1	0.500–0.750	2.218	0.785	1.500	10
2942SST	1	0.700–0.950	2.218	0.785	1.500	10

03

T&B Liquidtight Systems® flexible conduit and fittings



T&B Liquidtight Systems® flexible conduit and fittings

Stainless steel liquid-tight flexible conduit, fittings and accessories

Metallic liquid-tight conduit fittings	36
Liquid-tight flexible metallic conduits	40
Liquid-tight fittings for Type A liquid-tight flexible non-metallic conduit	41
Accessories	42

Metallic liquid-tight conduit fittings

Series 5300SST6-FB — Food and beverage, Type 316 stainless steel



Description

- Liquid-tight fittings with field assembled food and bev seal kits that effectively seal exposed threads, crevices and gaps unacceptable in food and beverage applications

Applications

- NSF certified for “splash zone” applications
- Wet or damp processing areas
- Equipment surfaces that are subject to splash or spillage

Features

- Meets UL 514B and CSA C22.2 No. 18.3
- Coordinated performance with T&B Liquidtight Systems® food and beverage antimicrobial LFMC

Technical data sheet

- TDS000778

Approvals

- UL 514B, fittings for cable and conduit
- CSA C22.2 No. 18.3
- IEC/EN 61386-1, -23

Ingress ratings

- UL: Type 3, 3R, 4, 4X, 6, 12, 13
- CSA: Type 3, 3R, 4, 4X, 12, 13
- NEMA: Type 3, 3R, 4, 4X, 6, 12, 13

Temperature ratings

- UL: -20 to +105 °C (-4 to +221 °F)
- CSA: -20 to +105 °C (-4 to +221 °F)
- IEC/CE: -45 to +150 °C (-49 to +302 °F)

Product selection



Trade size			Threads		Insulated			Sealing gasket	Wire mesh grips
UL	CSA	ISO/ BS EN	Type	Size	Straight	45°	90°		
Inch	Metric	Metric			Part no.	Part no.	Part no.	Part no.	Part no.
3/8	12	16	NPT	3/8	–	–	–	5261	WMG-LT1
1/2	16	20	NPT	1/2	5332SST6-FB	5342SST6-FB	5352SST6-FB	5262	WMG-LT2
3/4	21	25	NPT	3/4	5333SST6-FB	5343SST6-FB	5353SST6-FB	5263	WMG-LT3
1	27	32	NPT	1	5334SST6-FB	5344SST6-FB	5354SST6-FB	5264	WMG-LT4
1 1/4	35	40	NPT	1 1/4	5335SST6-FB	5345SST6-FB	5355SST6-FB	5265	WMG-LT5
1 1/2	41	50	NPT	1 1/2	5336SST6-FB	5346SST6-FB	5356SST6-FB	5266	WMG-LT6
2	53	63	NPT	2	5337SST6-FB	5347SST6-FB	5357SST6-FB	5267	WMG-LT7

Metallic liquid-tight conduit fittings

Series 5300SST6 — Type 316 stainless steel



Description

- Stainless steel 316 liquid-tight fittings that meet the demands of corrosive environments

Applications

- Food and beverage plants
- Water/wastewater
- Chemical processing

Features

- Meets UL 514B and CSA C22.2 No. 18.3
- Trade sizes from 3/8" to 2" (12 mm to 63 mm)
- Excellent corrosion protection

Technical data sheet

- TDS000126

Approvals

- UL 514B, fittings for cable and conduit
- CSA C22.2 No. 18.3
- IEC/EN 61386-1, -23

Ingress ratings

- UL: Type 3, 3R, 4, 4X, 6, 12, 13
- CSA: Type 3, 3R, 4, 4X, 12, 13
- NEMA: Type 3, 3R, 4, 4X, 6, 12, 13

Temperature ratings

- UL: -20 to +105 °C (-4 to +221 °F)
- CSA: -20 to +105 °C (-4 to +221 °F)
- IEC/CE: -45 to +150 °C (-49 to +302 °F)

Product selection					Series 5300SST6 liquid-tight fittings										
Trade size					Threads		Insulated with steel ground cone			Insulated with SST 316 ground cone			Sealing gasket	Wire mesh grips	
UL	CSA	ISO/BS EN	Type	Size	Straight	45°	90°	Straight	45°	90°	Part no.	Part no.	Part no.	Part no.	Part no.
3/8	12	16	NPT	3/8	5331SST6	5341SST6	5351SST6	5331SST6-6	5341SST6-6	5351SST6-6	5261	WMG-LT1			
1/2	16	20	NPT	1/2	5332SST6	5342SST6	5352SST6	5332SST6-6	5342SST6-6	5352SST6-6	5262	WMG-LT2			
3/4	21	25	NPT	3/4	5333SST6	5343SST6	5353SST6	5333SST6-6	5343SST6-6	5353SST6-6	5263	WMG-LT3			
1	27	32	NPT	1	5334SST6	5344SST6	5354SST6	5334SST6-6	5344SST6-6	5354SST6-6	5264	WMG-LT4			
1 1/4	35	40	NPT	1 1/4	5335SST6	5345SST6	5355SST6	5335SST6-6	5345SST6-6	5355SST6-6	5265	WMG-LT5			
1 1/2	41	50	NPT	1 1/2	5336SST6	5346SST6	5356SST6	5336SST6-6	5346SST6-6	5356SST6-6	5266	WMG-LT6			
2	53	63	NPT	2	5337SST6	5347SST6	5357SST6	5337SST6-6	5347SST6-6	5357SST6-6	5267	WMG-LT7			

Metallic liquid-tight conduit fittings

Series 5300SST6HT — Wide and extreme temperature, Type 316 stainless steel



Description

- Stainless steel 316 liquid-tight fittings suitable for the most demanding corrosive environments where extreme temperatures are encountered

Applications

- Industrial ovens
- Foundries
- Roller mills

Features

- Meets UL 514B and CSA C22.2 No. 18.3
- Trade sizes from 3/8" to 2" (12 mm to 63 mm)
- HT high temperature insulators and seal rings

Technical data sheet

- TDS000124

Approvals

- UL 514B, fittings for cable and conduit
- CSA C22.2 No. 18.3
- IEC/EN 61386-1, -23

Ingress ratings

- UL: Type 3, 3R, 4, 4X, 6, 12, 13
- CSA: Type 3, 3R, 4, 4X, 12, 13
- NEMA: Type 3, 3R, 4, 4X, 6, 12, 13

Temperature ratings

- UL: -20 to +105 °C (-4 to +221 °F)
- CSA: -20 to +105 °C (-4 to +221 °F)
- IEC/CE: -45 to +150 °C (-49 to +302 °F)
- General: Dry: -60 to +150 °C (-76 to +302 °F)

Product selection

Series 5300SST6HT liquid-tight fittings



Trade size			Threads		Insulated with steel ground cone			Insulated with SST 316 ground cone			Sealing gasket	Wire mesh grips
UL	CSA	ISO/BS EN	Type	Size	Straight	45°	90°	Straight	45°	90°		
Inch	Metric	Metric			Part no.	Part no.	Part no.	Part no.	Part no.	Part no.	Part no.	Part no.
3/8	12	16	NPT	3/8	5331SST6HT	5341SST6HT	5351SST6HT	5331SST6-6HT	5341SST6-6HT	5351SST6-6HT	5261-HT	WMG-LT1
1/2	16	20	NPT	1/2	5332SST6HT	5342SST6HT	5352SST6HT	5332SST6-6HT	5342SST6-6HT	5352SST6-6HT	5262-HT	WMG-LT2
3/4	21	25	NPT	3/4	5333SST6HT	5343SST6HT	5353SST6HT	5333SST6-6HT	5343SST6-6HT	5353SST6-6HT	5263-HT	WMG-LT3
1	27	32	NPT	1	5334SST6HT	5344SST6HT	5354SST6HT	5334SST6-6HT	5344SST6-6HT	5354SST6-6HT	5264-HT	WMG-LT4
1 1/4	35	40	NPT	1 1/4	5335SST6HT	5345SST6HT	5355SST6HT	5335SST6-6HT	5345SST6-6HT	5355SST6-6HT	5265-HT	WMG-LT5
1 1/2	41	50	NPT	1 1/2	5336SST6HT	5346SST6HT	5356SST6HT	5336SST6-6HT	5346SST6-6HT	5356SST6-6HT	5266-HT	WMG-LT6
2	53	63	NPT	2	5337SST6HT	5347SST6HT	5357SST6HT	5337SST6-6HT	5347SST6-6HT	5357SST6-6HT	5267-HT	WMG-LT7

Metallic liquid-tight conduit fittings

Type SAM one-piece — Food and beverage, Type 316 stainless steel

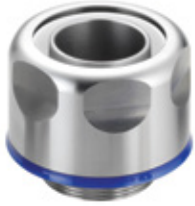

Description

- Single-piece stainless steel 316 liquid-tight fittings suitable for food zone non-contact areas

Applications

- Food and beverage plants
- Water/wastewater
- Chemical processing

Features

- Meets UL 514B and CSA C22.2 No. 18.3
- Trade sizes from 3/8" to 2" (12 mm to 63 mm)
- Excellent corrosion protection

Technical data sheet

- Type SAM

Approvals

- UL 514B, fittings for cable and conduit
- IEC/EN 61386-1, -23

Ingress ratings

- NEMA: Type 4, 4X, 12

Temperature ratings

- UL: -20 to +105 °C (-4 to +221 °F)
- IEC/CE: -45 to +150 °C (-49 to +302 °F)
- General: -50 to +130 °C (-58 to +266 °F)

Product selection



Trade size			Threads		Insulated with SST 316 ground cone	Conduit support (1-hole) Part no.	Conduit support (2-hole) Part no.
UL	CSA	ISO/BS EN	Type	Size	Straight Part no.		
Inch	Metric	Metric					
3/8	12	16	NPT	3/8	SPL16/038/SAM	–	–
1/2	16	20	NPT	1/2	SPL20/050/SAM	HS 101-SS	HS 901-SS
3/4	21	25	NPT	3/4	SPL25/075/SAM	HS 102-SS	HS 902-SS
1	27	32	NPT	1	SPL32/100/SAM	HS 103-SS	HS 903-SS
1 1/4	35	40	NPT	1 1/4	SPL40/125/SAM	HS 104-SS	HS 904-SS
1 1/2	41	50	NPT	1 1/2	SPL50/150/SAM	HS 105-SS	HS 905-SS
2	53	63	NPT	2	SPL63/200/SAM	HS 106-SS	HS 906-SS

Liquid-tight flexible metallic conduits

Type LT6FE — Food and beverage, Type 316L stainless steel

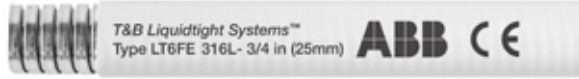

Type LT6FE SST 316L — General purpose

Stainless steel 316L food and beverage, CE and NSF certified T&B Liquidtight Systems® flexible metallic conduits provide superior strength, corrosion protection and liquid-tight performance

Materials: Stainless steel 316L core, smooth PVC jacket, FDA approved compound

Color: White (standard)

Approvals



Trade size			Coil length									Specifications				
UL	CSA	ISO/ BS EN	Standard carton			Small reel			Bulk reel			UL bond wire	ID range (nominal)		Min. inside bend radius	
Inch	mm	mm	Part no.	Ft	m	Part no.	Ft	m	Part no.	Ft	m		Inch	mm	Inch	mm
3/8	12	16	LT6FES01W-C	100	30	LT6FES01W-K	500	150	LT6FES01W-L	1,000	300	No	0.484 to 0.505 (0.493)	12.3 to 12.8 (12.5)	1.5	38
1/2	16	20	LT6FES02W-C	100	30	LT6FES02W-K	500	150	LT6FES02W-L	1,000	300	No	0.622 to 0.642 (0.632)	15.8 to 16.3 (16.0)	2.0	51
3/4	21	25	LT6FES03W-C	100	30	LT6FES03W-K	500	150	LT6FES03W-L	1,000	300	No	0.820 to 0.840 (0.830)	20.8 to 21.3 (21.1)	2.5	64
1	27	32	LT6FES04W-C	100	30	LT6FES04W-J	400	120	-	-	-	No	1.041 to 1.066 (1.053)	25.4 to 27.1 (26.8)	3.0	76
1-1/4	35	40	LT6FES05W-B	50	15	LT6FES05W-E	200	60	-	-	-	No	1.380 to 1.410 (1.395)	35.1 to 35.8 (35.5)	3.5	89
1-1/2	41	50	LT6FES06W-B	50	15	LT6FES06W-D	150	45	-	-	-	No	1.575 to 1.600 (1.587)	40.0 to 40.6 (40.3)	4.5	114
2	53	63	LT6FES07W-B	50	15	LT6FES07W-C	100	30	-	-	-	No	2.020 to 2.045 (2.032)	51.3 to 51.9 (51.6)	5.5	140
2-1/2	63	70	LT6FES08W-A	25	8	-	-	-	-	-	-	No	2.480 to 2.505 (2.492)	63.0 to 63.6 (63.3)	8.0	203
3	78	80	LT6FES09W-A	25	8	-	-	-	-	-	-	No	3.070 to 3.100 (3.085)	78.0 to 78.7 (78.4)	10.0	254
4	103	100	LT6FES11W-A	25	8	-	-	-	-	-	-	No	4.000 to 4.040 (4.020)	101.6 to 102.6 (102.1)	12.0	305

System ingress ratings

UL 50E "tested"	
Indoor	Type 4, 12, 13
Outdoor	Type 3, 3R, 4
CSA C22.2, No. 94	Type 3, 3R, 4, 12, 13
NEMA 250	Type 3, 3R, 4, 12, 14
IEC 60529	IP66, IP67

System temperature ratings

General	Dry: -55 to +105 °C (-67 to +221 °F)
	Oil: -30 to +70 °C (-22 to +158 °F)
	Wet: -30 to +60 °C (-22 to +140 °F)
IEC/CE	Gen: -45 to +105 °C (+49 to +221 °F)

For more information, see technical data sheet TDS000086 for download on our website. Please see also [page 72](#) for more information.

Liquid-tight fittings for Type A flexible non-metallic conduit

Series 6300SST — Type 304 stainless steel



Description

- Liquid-tight Type A stainless steel fittings for use in corrosive and caustic washdown applications

Applications

- Food and beverage
- Corrosive environments

Features

- Straight, 45° and 90° elbows
- Seal gasket and locknut included

Technical data sheet

- TDS000741

Approvals

- UL 514B, fittings for cable and conduit

Ingress ratings

- UL: Type 4, 4X, 12
- NEMA: Type 4, 4X, 12
- IEC/CE: IP66, IP69

Product selection

Series 6300SST liquid-tight fittings



Trade size			Threads		LT fittings			Conduit support (1-hole)	Conduit support (2-hole)
UL	CSA	ISO/BS EN	Type	Size	Straight	45°	90°	Part no.	Part no.
Inch	Metric	Metric			Part no.	Part no.	Part no.	Part no.	Part no.
½	16	20	NPT	½	6302SST	6312SST	6322SST	HS101-SS	HS901-SS
¾	21	25	NPT	¾	6303SST	6313SST	6323SST	HS102-SS	HS902-SS
1	27	32	NPT	1	6304SST	6314SST	6324SST	HS103-SS	HS903-SS
1¼	35	40	NPT	1¼	6305SST	–	6325SST	HS104-SS	HS904-SS
1½	41	50	NPT	1½	6306SST	–	6326SST	HS105-SS	HS905-SS
2	53	63	NPT	2	6307SST	–	6327SST	HS106-SS	HS906-SS

Accessories

Locknuts — Type 304 and Type 316 stainless steel



Locknuts

Series 14xSST stainless steel locknuts

Part no.	Trade size	Description	Key features	Image	Technical data sheet
141SST	½	Stainless steel locknut, ½	NPT threads Stainless steel 304 Case hardened Tiger tooth antivibration		TDS000584
142SST	¾	Stainless steel locknut, ¾			
143-SST	1	Stainless steel locknut, 1			
144-SST	1¼	Stainless steel locknut, 1¼			
145-SST	1½	Stainless steel locknut, 1½			
146-SST	2	Stainless steel locknut, 2			

Seal gaskets

Series 526x seal gaskets — standard temperature

Part no.	Trade size	Description	Key features	Image	Technical data sheet
5261	¾	Seal gasket, standard, ¾	UL 514B listed CSA 22.2 No. 18.3 certified Stainless steel 316 ring, thermoplastic rubber core UL 50E type ratings: 3, 3R, 4, 4X, 6, 12, 13 IEC 60529 ingress ratings IP66..IP69 Temperature rating: -20 to +105 °C		TDS000232
5262	½	Seal gasket, standard, ½			
5263	¾	Seal gasket, standard, ¾			
5264	1	Seal gasket, standard, 1			
5265	1¼	Seal gasket, standard, 1¼			
5266	1½	Seal gasket, standard, 1½			
5267	2	Seal gasket, standard, 2			
5268	2½	Seal gasket, standard, 2½			
5270	3	Seal gasket, standard, 3			
5269	4	Seal gasket, standard, 4			

Series 526x-HT seal gaskets — high temperature

Part no.	Trade size	Description	Key features	Image	Technical data sheet
5261-HT	¾	Seal gasket, standard, ¾	UL 514B listed CSA 22.2 No. 18.3 certified Stainless steel 316 ring, thermoplastic rubber core UL 50E type ratings: 3, 3R, 4, 4X, 6, 12, 13 IEC 60529 ingress ratings IP66..IP69 Temperature rating: -60 to +150 °C		TDS000232
5262-HT	½	Seal gasket, standard, ½			
5263-HT	¾	Seal gasket, standard, ¾			
5264-HT	1	Seal gasket, standard, 1			
5265-HT	1¼	Seal gasket, standard, 1¼			
5266-HT	1½	Seal gasket, standard, 1½			
5267-HT	2	Seal gasket, standard, 2			
5268-HT	2½	Seal gasket, standard, 2½			
5270-HT	3	Seal gasket, standard, 3			
5269-HT	4	Seal gasket, standard, 4			

Series 526x-FB seal kits

Part no.	Trade size	Description	Key features	Image	Technical data sheet
5262-FB	½	F&B seal kit, ½	For use with series 5300SST6 LT fittings (straight, 45° and 90° elbows) ½ to 2 trade sizes UR, NSF, FDA UL Type 4, 4X and 12 ingress ratings IEC 60529 ingress ratings IP66..IP69		TDS000700
5263-FB	¾	F&B seal kit, ¾			
5264-FB	1	F&B seal kit, 1			
5265-FB	1¼	F&B seal kit, 1¼			
5266-FB	1½	F&B seal kit, 1½			
5267-FB	2	F&B seal kit, 2			

Protect your industrial electrical system with corrosion-resistant stainless steel



04

Kindorf® modular framing system



Kindorf® modular framing system

Stainless steel modular framing system

Overview	46
Channels, straps and clamps	47
Trapnut® strut fastener	48
Channel fittings and hardware	49

Kindorf® modular framing system

Saving you time and money.

—
01 1½" wide x 1½" deep
⅞" continuous open slot
10 ft. and 20 ft. lengths

Kindorf channels

The Kindorf channel system is designed so that the maximum number of support and framing applications can be constructed with a minimum amount of labor and pieces.

Uniqueness in design

The 1½" dimension in the channel, hole spacing and fittings means all parts fit together, no matter where they're used, or at what angle. This modular dimension provides maximum flexibility in field applications, saving inventory and labor dollars.

Strength

Even though the Kindorf channel is slightly smaller in dimensions, it supports the same weight as 1½" channel.

Compatibility with 1½" strut

The Kindorf system is designed so that most accessories are compatible with 1½" strut. Conduit and pipe straps will work equally well with 1½" and 1½" strut. In addition, 98% of 1½" accessories are interchangeable with Kindorf channel. Angle fittings can adapt easily to the open side of any 1½" strut and the unique parallelogram nuts provide secure attachment to both types of strut.

Full line of support products

The Kindorf channel system's many advantages are extended into a broad product offering, including beam clamps, concrete inserts, lighting supports, cable cleats and a variety of threaded components. This, combined with a nationwide network of distributors and service centers, makes the Kindorf system a single source for your supported metal-framing needs.

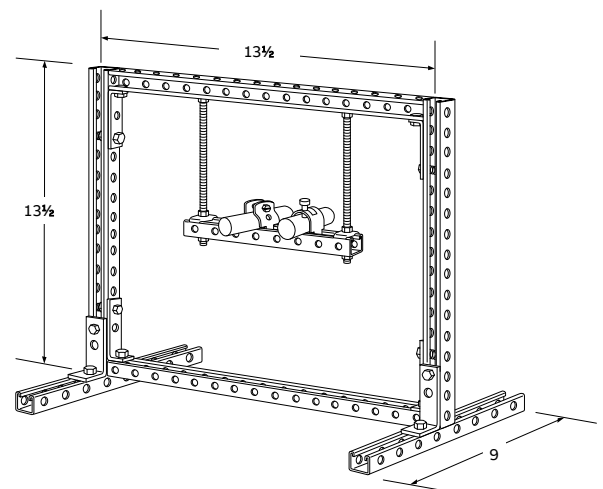

—
01

Kindorf® channels, straps and clamps

Type 304 and Type 316 stainless steel



B-900 Channel — 1½" x 1½"

Cat. no.	Description	Length (ft.)
B-900-10SS	Type 304	10
B-900-10316-SS	Type 316	10

Diagrams

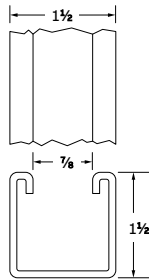

Use H-113-B bolts and B-910-1/2 or B-911-1/2 stainless steel nuts for mounting fittings. Available 20 ft. lengths.

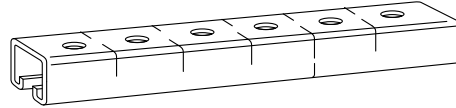

B-907 Channel — 1½" x ¾"

Cat. no.	Description	Length (ft.)
B-907-10SS	Type 304	10
B-907-10316SS	Type 316	10

Diagrams

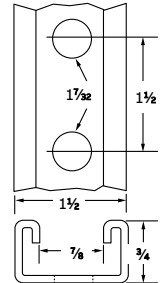

- Connection by means of continuous slot or 3/16" holes on 1½" centers

Available 20 ft. lengths.



B-905 Channel — 1½" x 1½"

Cat. no.	Description	Length (ft.)
B-905-10SS	Type 304	10
B-905-10-316SS	Type 316	10

Diagrams

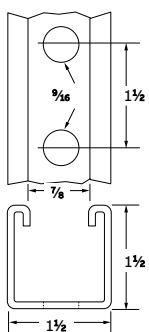

Use H-113-B bolts and B-910-1/2 or B-911-1/2 stainless steel nuts for mounting fittings. Scribe marks designate mid-point between holes for accurate field cutting. Available 20 ft. lengths.



C-105

Straps for rigid conduit and pipe — Type 304 stainless steel

Cat. no.	Rigid conduit or pipe size (in.)
C-105-1/2SS	½
C-105-3/4SS	¾
C-105-1SS	1
C-105-1-1/4SS	1¼
C-105-1-1/2SS	1½
C-105-2SS	2
C-105-2-1/2SS	2½
C-105-3SS	3
C-105-3-1/2SS	3½
C-105-4SS	4

For Type 316 stainless steel, add 316 suffix.

Kindorf® Trapnut® strut fastener

Type 316 stainless steel



01 Hold in the open position

- No need to thread the Trapnut fastener from either end of the rod – saves valuable time
- Perfect for retrofit applications where rod ends are not accessible

02 Insert the bottom plate on the rod and close the top plate

- Precision threads trap the threaded rod for a sturdy hold that can be adjusted up or down for fine-tune positioning
- Functions as a hex nut, square washer and flat washer combined

03 Press the pin with pliers

- Locking pin holds Trapnut fastener in the desired position
- Can be removed and reused

04 Tighten to the desired position with pliers

- Can be adjusted up or down for fine-tune positioning
- Sturdy, load-bearing stainless steel construction
- Sized to provide custom fit for either 1 5/8" or 1 1/2" strut systems

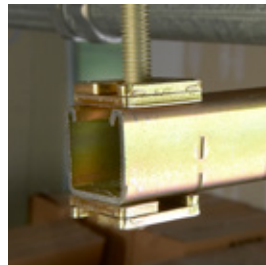
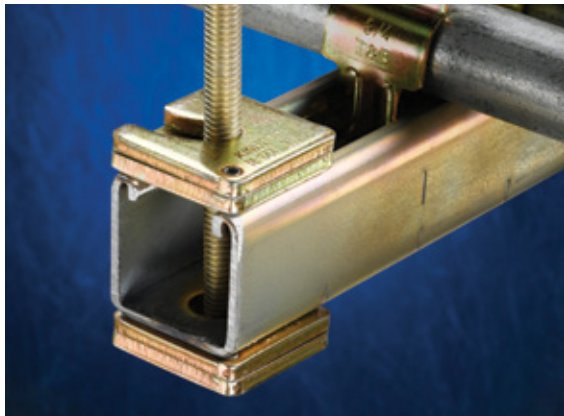

Fewer parts, less installation time and huge labor savings. The unique scissor action of the Trapnut strut fastener closes at any desired position on the threaded rod. Once closed, precision threads trap the rod for a sturdy hold that can be adjusted up or down for fine-tune positioning. While the versatile Trapnut strut fastener has a locking pin that holds it in the desired position, it can also be removed and reused.

Unlike a hex nut, there's no need to thread the Trapnut fastener from either end of the rod, saving valuable time on the job. While the Trapnut fastener is a time-saver for new work, it's also invaluable for retrofit applications. Rather than disassembling an existing trapeze to run additional conduit above it, simply clamp the Trapnut fastener between the trapeze and beam clamp for a speedy retrofit solution. Ideal for applications where the rod ends aren't accessible.

The Trapnut fastener offers sturdy, load-bearing stainless steel construction for a solid installation. In addition, the Trapnut fastener functions as a hex nut, square washer and flat washer all in one, so there are fewer parts to keep track of on the job.

- Takes 30% less time than the traditional method on new work*
- Takes 43% less time than the traditional method on retrofit applications*

* Based on time study conducted by ABB comparing the time to install 15 feet of 2" conduit with typical trapeze assemblies using washers and nuts versus Trapnut fasteners.

Trapnut fastener — Type 316 stainless steel

Product code	Material	Size		Design load	
		(in.)	(mm)	(lb)	(kg)
H122-1/4-SS6	Type 316 stainless steel	1/4	6.35	150	68.04
H122-3/8-SS6	Type 316 stainless steel	3/8	9.53	590	267.62
H122-1/2-SS6	Type 316 stainless steel	1/2	12.70	1080	489.88

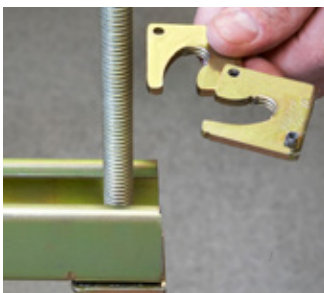

01

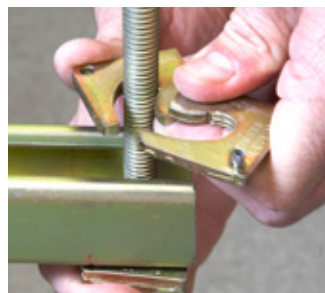

02

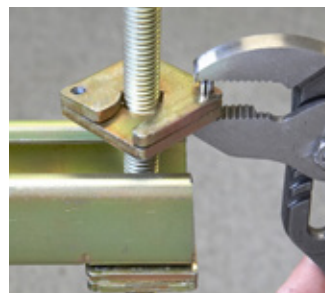

03

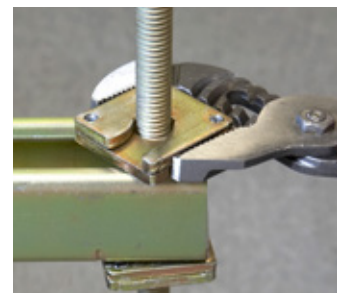

04

Kindorf® channel fittings and hardware

Type 304 and Type 316 stainless steel

Self-holding clamping nut with spring attached.
For use with 1½" deep channels.



B-911 series spring channel nuts

Cat. no.	Size (in.)	Thickness (in.)	lbs./C
B-911-3/8-SS	¾-16	⅜	12.5
B-911-1/2-SS	½-13	⅝	16.0

Square nuts for use with channel and spot-type concrete inserts.

B-914 series

Cat. no.	Size (in.)	Thickness (in.)	Wt. lbs./C
B 914 1/4SS	¼-20	⅜	10.50
B-914-3/8SS	¾-16	⅝	13.25
B-914-1/2SS	½-13	¾	14.00

Diagrams

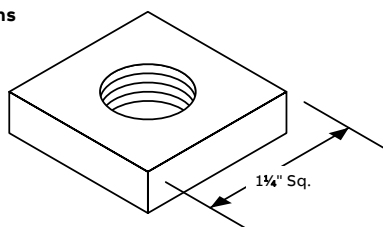

* Standard pipe threads.

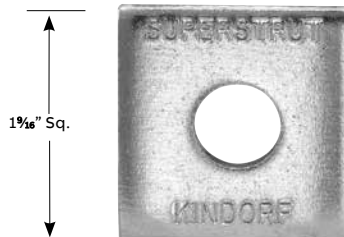

AB-241 series square washers

Cat. no.	Bolt size (in.)	Std. ctn.
AB-241-1/4SS	¼	100
AB-241-5/16SS	⅝	100
AB-241-3/8SS	¾	100
AB-241-1/2SS	½	100

Note: All hardware shown here is made of Type 304 stainless steel. For Type 316 stainless steel, substitute SS6 suffix for SS suffix at the end of catalog number.

Kindorf® channel fittings and hardware

Type 304 stainless steel

B-915 two-hole angle connector

Cat. no.	Description
B 915SS	Type 304

Diagrams

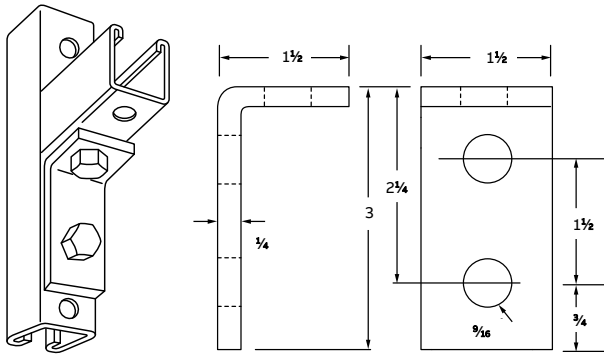

Can also be used as side-beam connector to suspend 1/2" hanger rod.



B-917 five-hole angle connector

Cat. no.	Description
B 917SS	Type 304

Diagrams

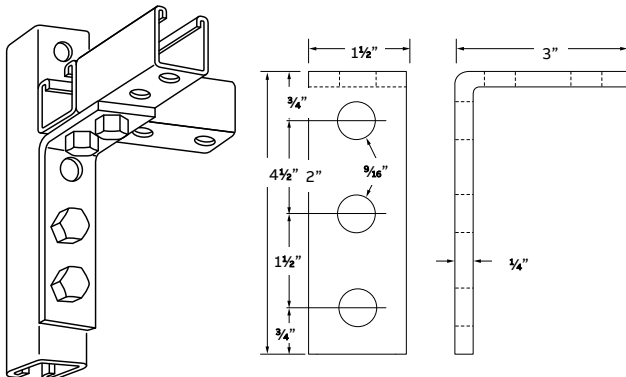

B-924 post base connector

Cat. no.	Description
B 924SS	Type 304

Diagram

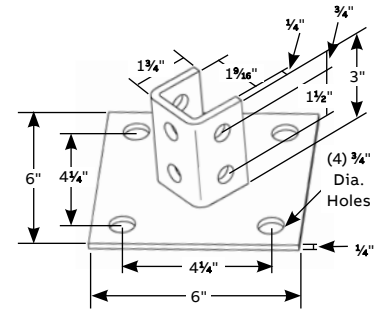

For use with 1 1/2" x 1 1/2" channels.

B-937 T-plate connector

Cat. no.	Description
B 937SS	Type 304

Diagrams

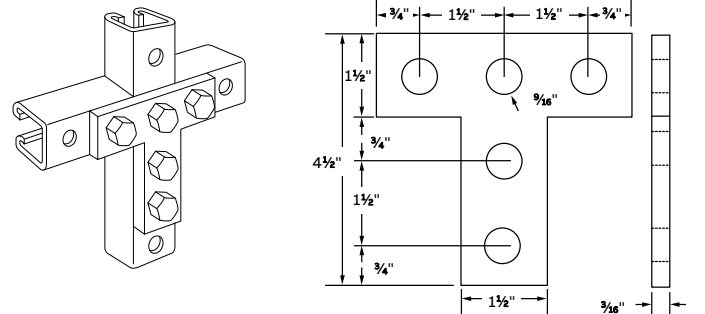

—
Stainless steel helps protect
electrical systems exposed
to water, salt and humidity.



05

Superstrut® channels and accessories



Superstrut® channels and accessories

Stainless steel channels and accessories

Channels	54
Hardware	55
Fittings	57
Threaded rod	58
Beam clamps and pipe straps	59

Superstrut® channels

Type 304 and Type 316 stainless steel



— 01 A1200HS
— 02 B1400
— 03 Half-slot
— 04 A1202



01

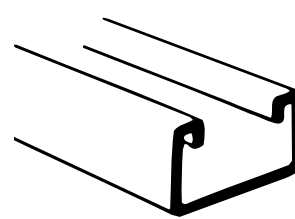
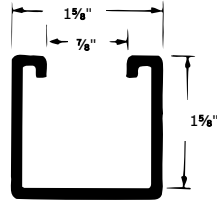

02

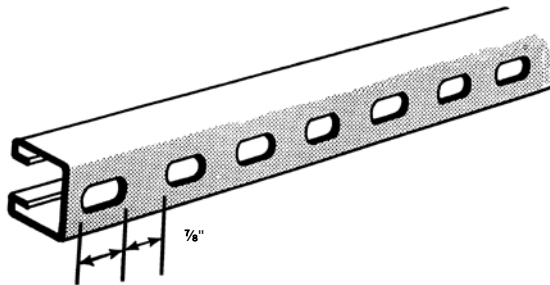
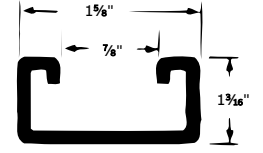

03

7/8"

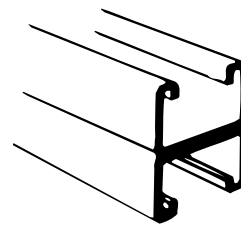

04

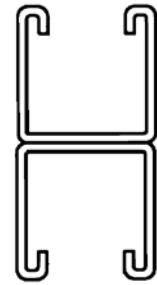

- 12- or 14-gauge Type 304 or Type 316 stainless steel
- Available in 10-ft. and 20-ft. lengths with standard length tolerance of $\pm \frac{1}{8}$ "
- Choose standard or shallow and solid or half-slot style

Type 304 cat. no.	Type 316 cat. no.	Style	Steel gauge	Length (ft.)	Width	In Height
A1200-10-SS	A1200-10-T316SS	Standard	12	10	1.63	1.63
A1200-20-SS	A1200-20-T316SS	Standard	12	20	1.63	1.63
A1200HS-10-SS	A1200HS-10-T316SS	Standard half-slot	12	10	1.63	1.63
A1200HS-20-SS	A1200HS-20-T316SS	Standard half-slot	12	20	1.63	1.63
B1400-10-SS	B1400-10-T316SS	Shallow	14	10	1.63	.81
B1400-20-SS	B1400-20-T316SS	Shallow	14	20	1.63	.81
B1400HS-10-SS	B1400HS-10-T316SS	Shallow half-slot	14	10	1.63	.81
B1400HS-20-SS	B1400HS-20-T316SS	Shallow half-slot	14	20	1.63	.81
A1202-10-SS	A1202-10-T316SS	Back-to-back	12	10	1.63	3.25
A1202-20-SS	A1202-20-T316SS	Back-to-back	12	20	1.63	3.25
A1202HS-10-SS	A1202HS-10-T316SS	Back-to-back half-slot	12	10	1.63	3.25
A1202HS-20-SS	A1202HS-20-T316SS	Back-to-back half-slot	12	20	1.63	3.25

Superstrut® hardware

Type 304 stainless steel



E-145 standard hex nut

Cat. no.	Size (in.)
E-145-1/4SS	1/4
E-145-3/8SS	3/8
E-145-1/2SS	1/2



H-119 rod coupling

Cat. no.	Size (in.)
H-119-1/4SS	1/4
H-119-1/2SS	1/2

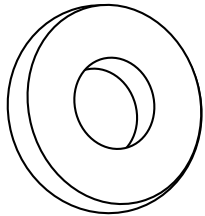

E-147 flat steel washer

Cat. no.	Size (in.)
E-147-1/4SS	1/4
E-147-3/8SS	3/8
E-147-1/2SS	1/2



EF-147 fender washer

Cat. no.	Size (in.)
EF-147-1/4SS	1/4
EF-147-3/8SS	3/8
EF-147-1/2SS	1/2

Superstrut® hardware

Type 304 stainless steel



E-142 hex head cap screw

Cat. no.	Size (in.)
E-142-3/8x1SS	$\frac{3}{8} \times 1$
E-142-3/8x1-1/2SS	$\frac{3}{8} \times 1\frac{1}{2}$
E-142-1/2x1-1/2SS	$\frac{1}{2} \times 1\frac{1}{2}$

Consult your ABB representative for additional sizes.



B-100 short spring nut

Cat. no.	Size (in.)
B-100-1/4SS	$\frac{1}{4}$
B-100-3/8SS	$\frac{3}{8}$
B-100-1/2SS	$\frac{1}{2}$

- Nut is square over $\frac{1}{2}$ " size
- For all "B" series channel and inserts



A-100 regular spring nut

Cat. no.	Size (in.)
A-100-1/4SS	$\frac{1}{4}$
A-100-5/16SS	$\frac{5}{16}$
A-100-3/8SS	$\frac{3}{8}$
A-100-1/2SS	$\frac{1}{2}$
A-100-5/8SS	$\frac{5}{8}$

- Nut is square over $\frac{1}{2}$ " size
- For all "A" and "C" series channel and inserts



AB-100 springless nut

Cat. no.	Size (in.)
AB-100-1/4SS	$\frac{1}{4}$
AB-100-3/8SS	$\frac{3}{8}$
AB-100-1/2SS	$\frac{1}{2}$

- Nut is square over $\frac{1}{2}$ " size
- For use with all channels

Superstrut® fittings

Type 304 stainless steel

Flat plate fittings

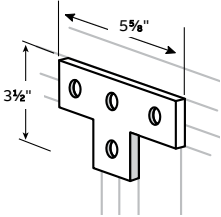

AB220SS

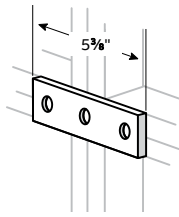

AB207SS

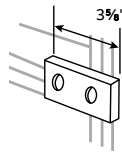

AB206SS

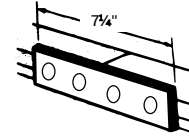

X207SS

90° corner fittings or brackets

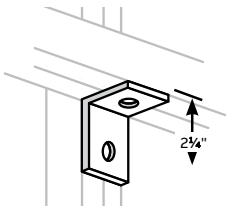

AB201SS

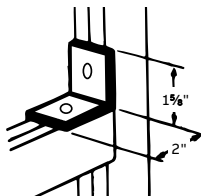

AB202SS

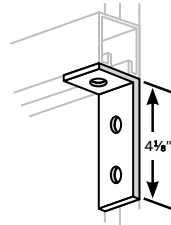

AB203SS

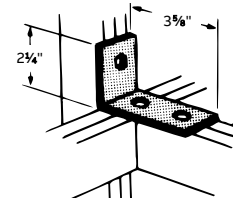

AB204SS

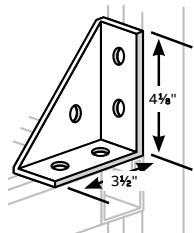

AB213SS

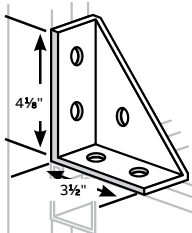

AB214SS

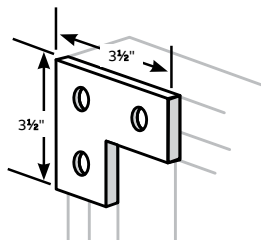

AB219SS

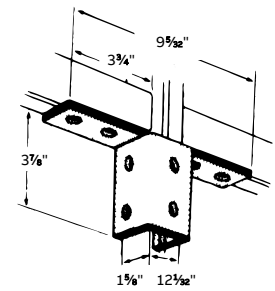

AW219SS

45° fittings

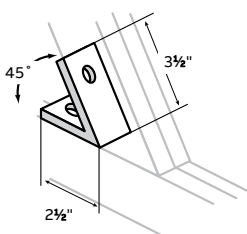

AB225SS

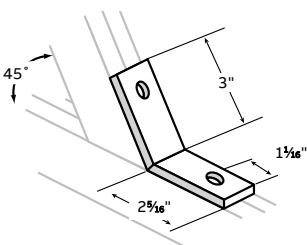

SPAB-227SS

Superstrut® fittings and threaded rod

Type 304 and Type 316 stainless steel

Type 304 fittings Pedestal base

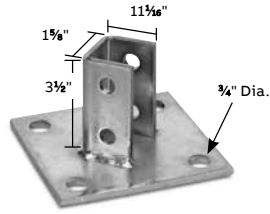

AP-232SS

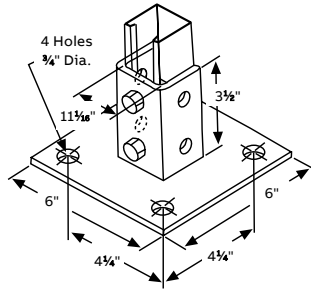

AP-232SQSS

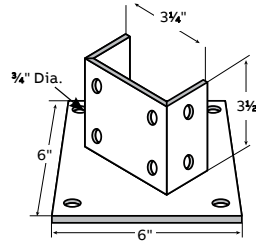

AP-235SS

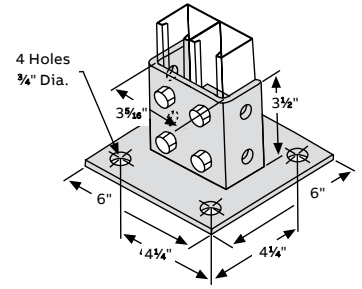

AP-235SQSS

Type 316 fittings Flat plate fitting

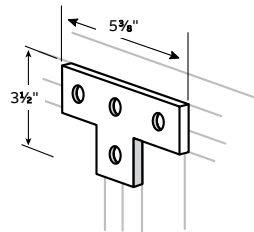

AB220T316SS

90° corner fittings or brackets

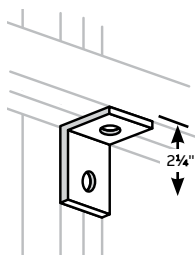

AB201T316SS

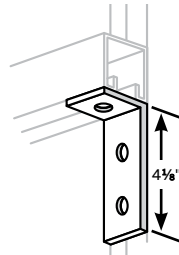

AB203T316SS

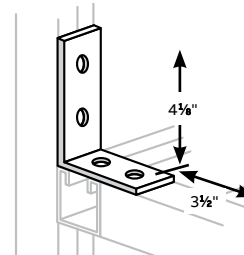

AB205T316SS

45° fitting

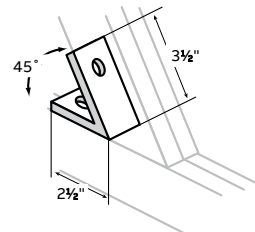

AB225T316SS

All-thread rod



Continuously threaded rod for use with conduit hangers and strut to suspend overhead conduit runs.

- Available in Type 304 or Type 316 stainless steel
- Comes in standard 6- or 12-ft. lengths

All-thread rod

Type 304 cat. no.	Type 316 cat. no.	Size (in.)	Length (ft.)	Threads per inch
H104-1/4X6SS	H104-1/4X6SS316	1/4	6	20
H104-1/4X12SS	H104-1/4X12SS6	1/4	12	20
H104-3/8X6SS	H104-3/8X6SS316	3/8	6	16
H104-3/8X12SS	H104-3/8X12SS6	3/8	12	16
H104-1/2X12SS	H104-1/2X12SS316	1/2	12	13
H104-5/8X12SS	H104-5/8X12SS316	5/8	12	11

Superstrut® beam clamps and pipe straps

Type 304 and Type 316 stainless steel



Type 316 stainless steel beam clamps

Cat. no.	Base size (in.)		Jaw opening (in.)	Tapping of base and back holes	Set screw load rating†	Torque in inch-lbs.	Std. ctn.
	A	B					
500SS316	1	1¼	1½ ₁₆	¼-20	250	60	50
502SS316	2	2	1	¾-16	750	120	50
503SS316	2½	2½	1	½-13	1,250	250	20

Diagrams

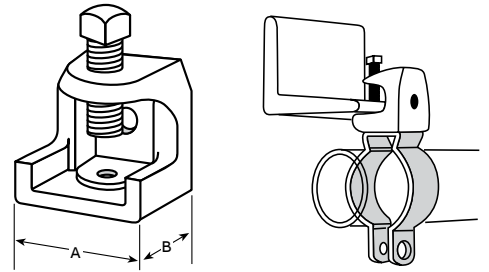

†Safety factor of 3.
Load ratings based on bottom hole of beam clamp.
CSA File No. LR-52208.



Just twist-insert these pipe straps anywhere you need them along the slot side of a channel. For additional flexibility, you can position the straps as closely as your pipe couplings permit.

- Combination slot and hex head bolt for flexibility of attachment
- Captivated square nut on shoulder enables easy one-handed tightening

Type 304 and Type 316 pipe straps

Type 304 cat. no.	Type 316 cat. no.	Conduit size (in.)	O.D. size (in.)
702-3/8SS	702-3/8T316SS	¾	0.675
702-1/2SS	702-1/2T316S	½	0.840
702-3/4SS	702-3/4T316SS	¾	1.050
702-1SS	702-1T316SS	1	1.315
702-1-1/4SS	702-1-1/4T316SS	1¼	1.660
702-1-1/2SS	702-1-1/2T316SS	1½	1.900
702-2-1/2SS	702-2-1/2T316SS	2½	2.875
702-3SS	702-3T316SS	3	3.500
702-3-1/2SS	702-3-1/2T316SS	3½	4.000
702-4SS	702-4T316SS	4	4.500
702-5SS	702-5T316SS	5	5.563
702-6SS	702-6T316SS	6	6.625

06

T&B® Cable Tray cable support systems



T&B® Cable Tray cable support systems

Stainless steel cable tray and accessories

Overview	62
Straight and cover sections	64
Fittings	65
Combo hold-down/guide clamp	67

T&B® Cable Tray

Overview

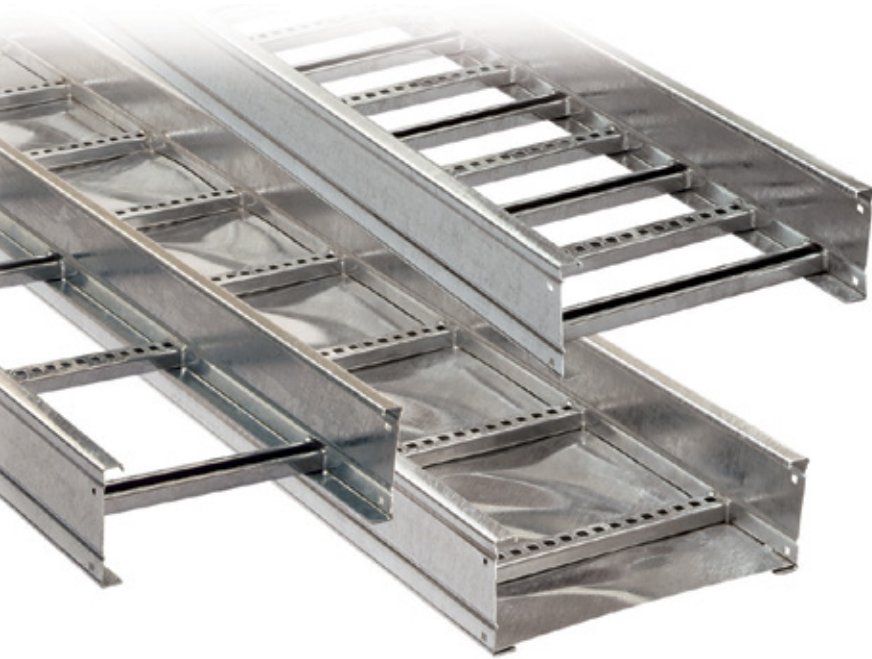

Benefits of cable tray

Cable tray wiring systems offer significant advantages over conduit pipe and other wiring systems. Cable tray is less expensive, more reliable, more adaptable to changing needs and easier to maintain. In addition, it is safer than conventional wiring systems.

An evaluation of the costs and benefits of various wiring systems should be done in the design phase. Unfortunately, many engineers who are unfamiliar with wiring systems avoid the system selection process or defer it until construction — often resulting in higher costs, scheduling delays and a system that will not meet future needs.

Selection of a wiring system that is not the most suitable for a particular application in terms of cost, potential corrosion and electrical considerations can lead to numerous problems, including excessive initial cost, poor design, faulty installation, extra maintenance, future power outages and unnecessary safety concerns.

Costs

Extensive experience has shown that the initial cost of a cable tray installation (including conductor, material and installation labor costs) may be as much as 60% less than a comparable conduit wiring system.

Cable tray systems — including trays, supports, fittings and other materials — are generally much less expensive than conduit wiring systems. In addition, major cost savings are generated by the relative ease of installation. Labor costs of installing a cable tray system can run up to 50% less. Total cost savings will vary with the complexity and size of the installation.

Direct cost savings are easy to calculate during the design phase of an installation, but the enormous advantages of cable tray systems may accrue only over time. A system's reliability, adaptability, ease of maintenance and inherent safety features result in many other types of cost savings, including:

- Lower engineering and maintenance costs
- Less need to reconfigure system as needs change
- Less down time for electrical and data handling systems
- Fewer environmental problems resulting from loss of power to essential equipment

Stainless steel

Stainless steel offers high yield strength and high creep strength at high ambient temperatures.

T&B stainless steel cable tray systems are roll-formed from AISI Type 316 stainless steel.

Stainless steel is resistant to dyestuffs, organic chemicals and inorganic chemicals at elevated temperatures. Higher levels of chromium and nickel and a reduced level of carbon serve to increase corrosion resistance and facilitate welding. Type 316 includes molybdenum to increase high-temperature strength and improve corrosion resistance, especially to chloride and sulfuric acid. Carbon content is reduced to facilitate welding.

T&B® Cable Tray

Sample plant layout

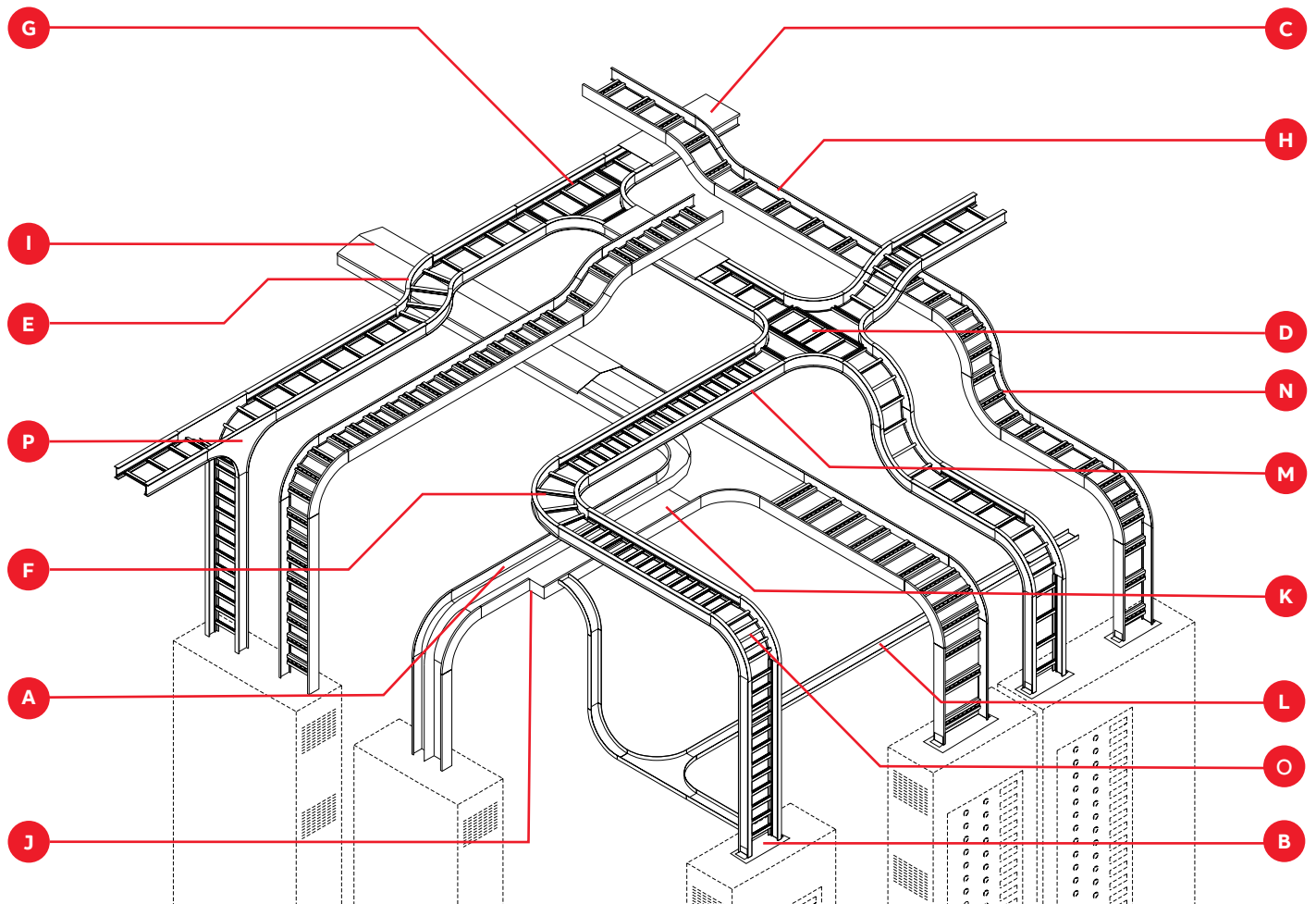

Application

- Commercial
- Schools
- Hospitals
- Office buildings
- Airports
- Casinos
- Stadiums
- Industrial
- Petrochemical plants
- Automotive plants
- Paper plants
- Food processing
- Power plants
- Refineries
- Manufacturing
- Mining

Legend

- A** - Barrier strip
- B** - Box connector
- C** - Flat cover
- D** - Horizontal cross
- E** - Horizontal 45°
- F** - Horizontal 90°
- G** - Horizontal tee
- H** - Ladder tray
- I** - Peaked cover
- J** - Right reducer
- K** - Solid tray
- L** - Solid channel tray
- M** - Ventilated tray
- N** - Vertical 90° inside
- O** - Vertical 90° outside
- P** - Vertical tee

T&B® Cable Tray straight and cover sections

Type 316 stainless steel



Straight section catalog number system

S S 1 3 2 4 L 0 9 1 4 4

Material		Series		Side rail height	Width		Bottom type		Length	
Description	Code	Description	Code	Code	Description	Code	Description	Code	Description	Code
Type 316 stainless steel	SS	Series 1	1**	3 5/8"	6"	06	6" Rung spacing	L06	3 Meters	3
		Series 2	2**	4"	9"	09	9" Rung spacing	L09	6 Meters	6
		Series 3	3**	5"	12"	12	12" Rung spacing	L12	12 Feet	144
		Series 4	4	6"	18"	18	6" Rung spacing	L18*	24 Feet	288
		Series 5	5	7"	24"	24	Ventilated	V		
					30"	30	Solid trough	S		
					36"	36				

** Series 1-3 are not available in 6-meter and 24-foot lengths.

* Only upon request (consult your ABB representative for loading lengths)

Straight cover catalog number system

S S W 2 4 S N C 1 4 4

Material prefix		Width		Type		Length	
Description	Code	Description	Code	Description	Code	Description	Code
Type 316 stainless steel	SSW	6"	06	Solid non-flanged cover	SNC	6 Feet	72
		9"	09	Solid flanged cover	SFC	12 Feet	144
		12"	12	Ventilated flanged cover	VFC	3 Meters	3
		18"	18	Peaked flanged cover	PFC		
		24"	24				
		30"	30				
		36"	36				

T&B® Cable Tray fittings

Type 316 stainless steel



S S F 3 2 4 L V 0 9 0 2 4

Material prefix		Side rail depth		Width		Fitting type		Angle*	
Description	Code	Description	Code	Description	Code	Description	Code	Description	Code
Type 316 stainless steel	SSF	3 3/4"	3	6"	06	Horizontal bend	HB	30°	30
		4"	4	9"	09	Horizontal tee	HT	45°	45
		5"	5	12"	12	Horizontal cross	HX	60°	60
		6"	6	18"	18	Vertical inside bend	VI	90°	90
		7"	7	24"	24	Vertical outside bend	VO		
				30"	30	Vertical tee down	VTD		
				36"	36	Vertical tee up	VTU		
						Horizontal wye right	HYR		
						Horizontal wye left	HYL		
						Horizontal reducing tee	RT		
						Horizontal expanding tee	ET		
						Horizontal expand cross	EX		
						Horizontal left reducer	HLR		
						Horizontal straight reducer	HSR		
						Horizontal right reducer	HRR		
						Cable support fitting	CS		

Bottom type		Nominal radius†	
Description	Code	Description	Code
Ladder	L*	12"	12
Ventilated	V***	24"	24
Solid through	S****	36"	36
		48"	48

* Manufactured with 9" rung spacing measured at the center line of fitting.
 *** Manufactured with 4" edge-to-edge rung spacing measured at the center line of fitting.
 **** Manufactured with flat sheet inserted under rungs with 9" rung spacing measured at the center line of fitting.

† Radius is not required for fitting types HYR, HYL, HLR, HRR, HSR.

T&B® Cable Tray fittings

Type 316 stainless steel

Material

Description	Code
Type 316 stainless steel	SSW

Width

Description	Code
6"	06
9"	09
12"	12
18"	18
24"	24
30"	30
36"	36

Cover type

Description	Code
Solid non-flanged cover	SNC
Solid flanged cover	SFC
Ventilated flanged cover	VFC

Fitting type

Description	Code
Horizontal bend	HB
Horizontal tee	HT
Horizontal cross	HX
Vertical inside bend	VI
Vertical tee up	VTU
Horizontal wye right	HYR
Horizontal wye left	HYL

Degree*

Description	Code
30°	30
45°	45
60°	60
90°	90

Radius

Description	Code
12"	12
24"	24
36"	36
48"	48

* Required for HB and VI only.

Material

Description	Code
Type 316 stainless steel	SSW

Width 1

Description	Code
6"	06
9"	09
12"	12
18"	18
24"	24
30"	30
36"	36

Width 2

Description	Code
6"	06
9"	09
12"	12
18"	18
24"	24
30"	30
36"	36

Cover type

Description	Code
Solid non-flanged cover	SNC
Solid flanged cover	SFC
Ventilated flanged cover	VFC

Fitting type

Description	Code
Horizontal reduce tee	RT
Horizontal expand tee	ET
Horizontal expand tee and reduce cross	EX
Horizontal straight reducer	HSR
Horizontal left reducer	HLR
Horizontal right reducer	HRR

Radius*

Description	Code
12"	12
24"	24
36"	36
48"	48

* Radius not required for HSR, HLR, HRR.

Material

Description	Code
Type 316 stainless steel	SSW

Side rail depth

Description	Code
3 3/8"	3
4"	4
5"	5
6"	6
7"	7

Width

Description	Code
6"	06
9"	09
12"	12
18"	18
24"	24
30"	30
36"	36

Cover type

Description	Code
Solid non-flanged cover	SNC
Solid flanged cover	SFC
Ventilated flanged cover	VFC

Fitting type

Description	Code
Vertical outside bend	VO
Vertical tee down	VTD
Cable support fitting	CS

Degree*

Description	Code
30°	30
45°	45
60°	60
90°	90

Radius

Description	Code
12"	12
24"	24
36"	36
48"	48

* Required for VO only.

T&B® Cable Tray combo hold-down/guide clamp

Type 316 stainless steel



- Easy-to-install design
- Compatible with all series of T&B Cable Tray
- Versatile use for strut and beam installations
- Functional in all cable tray positions, including vertical installations

Cable tray combo clamp

Cat. no.	Description
SSWCHGC	Combo clamp, 316 stainless steel
SSWCHGC-HDW	$\frac{3}{8}$ " hardware, 316 stainless steel





—
07

Ty-Met™ cable ties



Ty-Met™ cable ties

Stainless steel cable ties

Overview	72
Ball-lock type cable ties	74
Multi-Lok type cable ties	77

Ty-Met™ stainless steel cable ties

Features and benefits

—
Ball-lock type
 Easy application and strong self-locking mechanism (steel ball), with low insertion force



—
Ball-lock retained tension type
 Wave-form spring crimp eliminates movement – even in high-vibration applications



—
Multi-Lok
 Self-locking mechanism (pawl and ratchet)

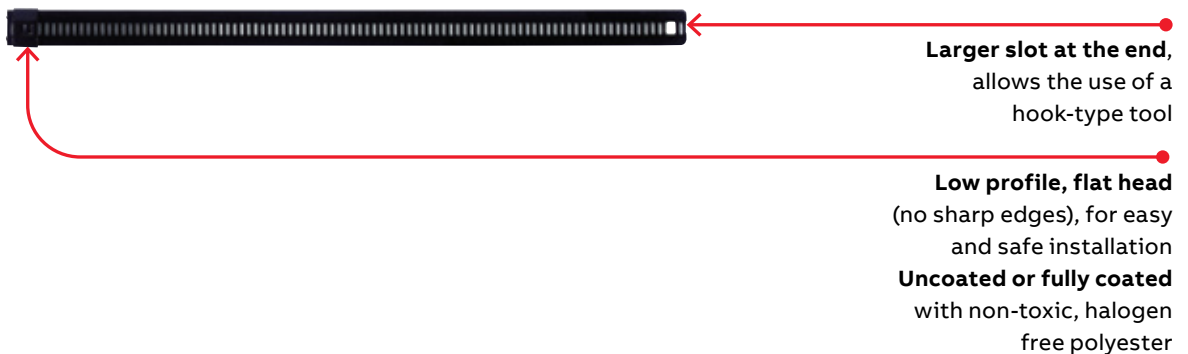

Dual lock ties
 304 and 316 grade stainless steel construction,
 with two-piece design for fast and easy installation



Mini ties (4.5 mm/0.18" wide)
 offer 100 lb tensile strength
Standard ties (6.35 mm/0.25" wide)
 offer 200 lb tensile strength

Bands on reel with separate heads
 Bands and separate heads are made of corrosion-
 resistant 316 grade stainless steel, for high
 mechanical and chemical durability



Available in 5 widths up to
 19.1 mm (0.75"), to suit a wide
 range of applications
 25 m (82.02 ft) reels for a cost-
 saving and customized
 installation, around all sizes and
 shapes of objects

Bands are fully covered
 with non-toxic, halogen -
 free polypropylene

Dedicated heads
 are easy to install



UV-resistant



Flame
 retardant

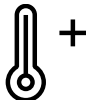

Heat
 resistant

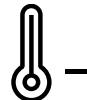

Low
 temperature
 flexibility



Weather-
 proof



Chemical
 resistant



Radiation
 resistant



Low
 smoke



Detectable

Ty-Met™ ball-lock type cable ties

Type 316 stainless steel — Fully coated



Characteristics

The ball-lock type stainless steel ties from ABB are self-locking and require no time-consuming crimping or folding operations.

- Strong self-locking mechanism (stainless steel ball) with low insertion force
- Fast, easy and reliable installation
- Standard widths (4.6 mm and 7.9 mm/0.18" and 0.31"), suitable for most applications, indoor and outdoor
- Corrosion-resistant 316 grade stainless steel (marine grade) for high mechanical and chemical durability
- Fully coated version with non-toxic, halogen-free polyester coating for superior protection of cables and installer's hands and for improved insulation between dissimilar materials

- Applications: installation of cables and pipes in extreme conditions and hazardous areas, such as: petrochemical and food processing industries, power stations, mining, shipbuilding, offshore and other aggressive environments

Technical information

- Material: 316 grade non-magnetic stainless steel
- UV-resistant coating
- Temperature range: -60 °C to +165 °C (-76 °F to 329 °F)
- Color: Black
- Extremely high flame and UV resistance

Ball-lock type — Fully coated, standard widths



Product code	GID No.	Max. bundle diameter		Length L		Width W		Min. tensile strength [lb/N]	Quantity [pieces]
		[mm]	[in]	[mm]	[in]	[mm]	[in]		
LS-4.6-200-C	77TAG009420R0001	50	2	200	7.8	4.6	0.18	175 (778)	100
LS-4.6-260-C	7TAG009410R0001	70	2.8	260	10.2	4.6	0.18	175 (778)	1000
LS-4.6-360-C	7TAG009420R0004	100	3.9	360	14.1	4.6	0.18	175 (778)	100
LS-4.6-520-C	7TAG009420R0007	150	5.9	520	20.4	4.6	0.18	175 (778)	1000
LS-4.6-680-C	7TAG009420R0010	200	7.9	680	26.8	4.6	0.18	175 (778)	100
LS-7.9-200-C	7TAG009420R0017	50	2	200	7.9	7.9	0.31	250 (1112)	50
LS-7.9-360-C	7TAG009410R0005	100	3.9	360	14.2	7.9	0.31	250 (1112)	50
LS-7.9-520-C	7TAG009420R0020	150	5.9	520	20.5	7.9	0.31	250 (1112)	50
LS-7.9-680-C	7TAG009420R0022	200	7.9	680	26.8	7.9	0.31	250 (1112)	500

Some approvals may not be applicable to all product codes.
Contact your Sales Office for approval limitations.

Tooling



DAS250
For use with 175 to 250 lb cable ties.

Dimensions

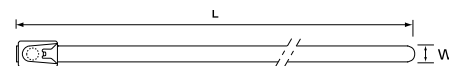

Ty-Met™ ball-lock type cable ties

Type 304 and Type 316 stainless steel — Uncoated



Characteristics

The ball-lock type stainless steel ties from ABB are self-locking and require no time-consuming crimping or folding operations.

- Strong self-locking mechanism (stainless steel ball) with low insertion force
- Fast, easy and reliable installation
- Standard widths (4.6 mm and 7.9 mm/0.18" and 0.31"), suitable for most applications, indoor and outdoor
- Uncoated version, suitable for high temperature environments
- Two grades of non-magnetic stainless steel: 304 grade for standard applications and 316 grade (marine grade) for extra corrosion resistance

- Applications: installation of cables and pipes in extreme conditions and hazardous areas, such as: petrochemical and food processing industries, power stations, mining, shipbuilding, offshore and other aggressive environments

Technical information

- Material: A. 304 grade non-magnetic stainless steel; B. 316 grade non-magnetic stainless steel
- Temperature range: -60 °C to +300 °C (-76 °F to 572 °F)
- Color: Metallic
- Extremely high flame and UV resistance

Ball-lock type — Uncoated 316 stainless steel, 0.187" width



Product code	GID No.	Bundle ø from ... to		Length L		Width W		Min. tensile strength [lb/N]	Quantity [pieces]
		[mm]	[in]	[mm]	[in]	[mm]	[in]		
LS-4.6-200B	7TAG009420R0003	50	2	200	7.9	4.75	0.187	200 (890)	50
LS-4.6-260B	7TAG009410R0003	70	2.7	260	10.2	4.75	0.187	200 (890)	1000
LS-4.6-360B	7TAG009420R0006	102	4	360	14.2	4.75	0.187	200 (890)	50
LS-4.6-520B	7TAG009420R0009	152	6	520	20.5	4.75	0.187	200 (890)	50
LS-4.6-680B	7TAG009420R0012	203	8	680	26.8	4.75	0.187	200 (890)	1000
LS-4.6-840B	7TAG009420R0014	254	10	840	33.1	4.75	0.187	200 (890)	1000

Some approvals may not be applicable to all product codes. Contact your Sales Office for approval limitations.

Ball-lock type — Uncoated 304 stainless steel, 0.187" width

Product code	GID No.	Bundle ø from ... to		Length L		Width W		Min. tensile strength [lb/N]	Quantity [pieces]
		[mm]	[in]	[mm]	[in]	[mm]	[in]		
LS-4.6-200A	7TAG009410R0000	50	2	200	7.9	4.75	0.187	200 (890)	50
LS-4.6-260A	7TAG009410R0002	70	2.7	260	10.2	4.75	0.187	200 (890)	1000
LS-4.6-360A	7TAG009410R0004	102	4	360	14.2	4.75	0.187	200 (890)	50
LS-4.6-520A	7TAG009420R0008	152	6	520	20.5	4.75	0.187	200 (890)	1000
LS-4.6-680A	7TAG009420R0011	203	8	680	26.8	4.75	0.187	200 (890)	1000
LS-4.6-840A	7TAG009420R0013	254	10	840	33.1	4.75	0.187	200 (890)	1000

Tooling



DAS250
For use with 175 to 250 lb cable ties.

Dimensions

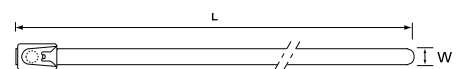

Ty-Met™ ball-lock type cable ties

Type 304 and 316 stainless steel — Uncoated



Characteristics

The ball-lock type stainless steel ties from ABB are self-locking and require no time-consuming crimping or folding operations.

- Strong self-locking mechanism (stainless steel ball) with low insertion force
- Fast, easy and reliable installation
- Standard widths (4.6 mm and 7.9 mm/0.18" and 0.31"), suitable for most applications, indoor and outdoor
- Uncoated version suitable for high temperature environments
- Two grades of non-magnetic stainless steel: 304 grade for standard applications and 316 grade (marine grade) for extra corrosion resistance

- Applications: installation of cables and pipes in extreme conditions and hazardous areas, such as: petrochemical and food processing industries, power stations, mining, shipbuilding, offshore and other aggressive environments

Technical information

- Material: A. 304 grade non-magnetic stainless steel; B. 316 grade non-magnetic stainless steel
- Temperature range: -60 °C to +300 °C (-76 °F to 572 °F)
- Color: Metallic
- Extremely high flame and UV resistance

Ball-lock type — Uncoated 316 stainless steel, 0.305" width



Product code	GID No.	Bundle ø from ... to		Length L		Width W		Min. tensile strength [lb/N]	Quantity [pieces]
		[mm]	[in]	[mm]	[in]	[mm]	[in]		
LS-7.9-200B	7TAG009420R0019	50	2	200	7.9	7.75	0.305	450 (2002)	50
LS-7.9-360B	7TAG009410R0007	102	4	360	14.2	7.75	0.305	450 (2002)	50
LS-7.9-520B	7TAG009420R0021	152	6	520	20.5	7.75	0.305	450 (2002)	50
LS-7.9-680B	7TAG009000R0130	203	8	680	26.8	7.75	0.305	450 (2002)	500
LS-7.9-840B	7TAG009420R0025	254	10	840	33.1	7.75	0.305	450 (2002)	500
LS-7.9-1010B	7TAG009420R0016	304	12	1010	39.8	7.75	0.305	450 (2002)	50

Some approvals may not be applicable to all product codes. Contact your Sales Office for approval limitations.

Ball-lock type — Uncoated 304 stainless steel, 0.305" width

Product code	GID No.	Bundle ø from ... to		Length L		Width W		Min. tensile strength [lb/N]	Quantity [pieces]
		[mm]	[in]	[mm]	[in]	[mm]	[in]		
LS-7.9-200A	7TAG009420R0018	50	2	200	7.9	7.75	0.305	450 (2002)	50
LS-7.9-360A	7TAG009410R0006	70	2.7	360	14.2	7.75	0.305	450 (2002)	50
LS-7.9-520A	7TAG009410R0008	102	4	520	20.5	7.75	0.305	450 (2002)	50
LS-7.9-680A	7TAG009420R0023	152	6	680	26.8	7.75	0.305	450 (2002)	50
LS-7.9-840A	7TAG009420R0024	203	8	840	33.1	7.75	0.305	450 (2002)	50
LS-7.9-1010A	7TAG009420R0015	254	10	1010	39.8	7.75	0.305	450 (2002)	50

Tooling



DAS250
For use with 175 to 250 lb cable ties.

Dimensions

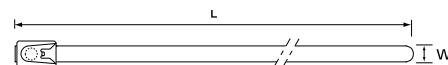

Ty-Met™ Multi-Lok type cable ties

Type 316 stainless steel — Fully coated and uncoated



Characteristics

- The Multi-Lok type stainless steel ties from ABB have a flat, low-profile head for easy application.
- Strong self-locking mechanism (pawl and ratchet) requires no time-consuming crimping or folding operations
 - Flat and low-profile head (no sharp edge) for easy installation
 - Corrosion-resistant 316 grade stainless steel for high mechanical and chemical durability
 - Fully coated version with non-toxic, halogen-free polyester coating for superior protection of cables and installer's hands and for improved insulation between dissimilar materials
 - Increased usable length (slots up to the end of the tail) allows larger bundle diameters with the same tie length

- Larger slot at the end, allows the use of a hook-type tool
- Applications: Installation of cables and pipes in extreme conditions and hazardous areas, indoor and outdoor, such as: petrochemical and food processing industries, power stations, mining, shipbuilding, offshore and other aggressive environments

Technical information

- Material: 316 grade stainless steel
- Coating: Polyester
- Temperature range: -60 °C to +165 °C (-75 °F to 329 °F)
- Color: Black
- Extremely high flame and UV resistance



Multi-Lok type — Fully coated and uncoated

Product code	GID No.	Max bundle diameter		Length L		Width W		Min. tensile strength [lb/N]	Quantity [pieces] Standard
		[mm]	[in]	[mm]	[in]	[mm]	[in]		
Multi-Lok, coated 316									
TYS6-280C	7TAG009450R0207	33	1.3	150	5.9	7	0.28	250 (1112)	100
TYS9-280C	7TAG009450R0209	57	2.24	225	8.8	7	0.28	250 (1112)	100
TYS12-280C	7TAG009450R0201	81	3.19	300	11.8	7	0.28	250 (1112)	100
TYS18-280C	7TAG009450R0204	129	5.08	450	17.7	7	0.28	250 (1112)	100
TYS24-280C	7TAG009460R0118	180	7.09	610	24	7	0.28	250 (1112)	100
TYS6-470C	7TAG009460R0123	33	1.3	150	5.9	12	0.47	250 (1112)	100
TYS9-470C	7TAG009000R0329	57	2.24	225	8.8	12	0.47	250 (1112)	100
TYS12-470C	7TAG009450R0202	81	3.19	300	11.8	12	0.47	250 (1112)	100
TYS18-470C	7TAG009450R0205	129	5.08	450	17.7	12	0.47	250 (1112)	100
TYS24-470C	7TAG009460R0120	180	7.09	610	24	12	0.47	250 (1112)	100
Multi-Lok, uncoated 316									
TYS6-280	7TAG009450R0206	33	1.3	150	5.9	7	0.28	250 (1112)	100
TYS9-280	7TAG009450R0208	57	2.24	225	8.8	7	0.28	250 (1112)	100
TYS12-280	7TAG009450R0200	81	3.19	300	11.8	7	0.28	250 (1112)	100
TYS18-280	7TAG009460R0114	129	5.08	450	17.7	7	0.28	250 (1112)	100
TYS24-280	7TAG009460R0117	180	7.09	610	24	7	0.28	250 (1112)	100
TYS6-470	7TAG009460R0122	33	1.3	150	5.9	12	0.47	250 (1112)	100
TYS9-470	7TAG009000R0328	57	2.24	225	8.8	12	0.47	250 (1112)	100
TYS12-470	7TAG009460R0113	81	3.19	300	11.8	12	0.47	250 (1112)	100
TYS18-470	7TAG009460R0115	129	5.08	450	17.7	12	0.47	250 (1112)	100
TYS24-470	7TAG009460R0119	180	7.09	610	24	12	0.47	250 (1112)	100

* Some approvals may not be applicable to all product codes. Contact your Sales Office for approval limitations.

Dimensions

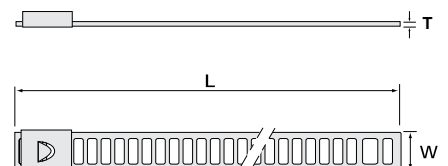





Additional information

ABB has made every attempt to ensure the accuracy and reliability of the contents of this document. However, all content is provided for general informational purposes only, and ABB makes no guaranty or warranty, express or implied, as to the accuracy of any technical content, or that the information contained in this publication will be error free and all such guarantees or warranties are expressly disclaimed. ABB may change or modify the contents at any time, without prior notice. We reserve all rights in this document and in the subject matter and illustrations contained therein. Any reproduction or utilization of its contents — in whole or in parts — is forbidden without prior written consent of ABB.



—
US

ABB Installation Products
Electrification Business
860 Ridge Lake Blvd.
Memphis, TN 38120
+1 901-252-5000

electrification.us.abb.com