

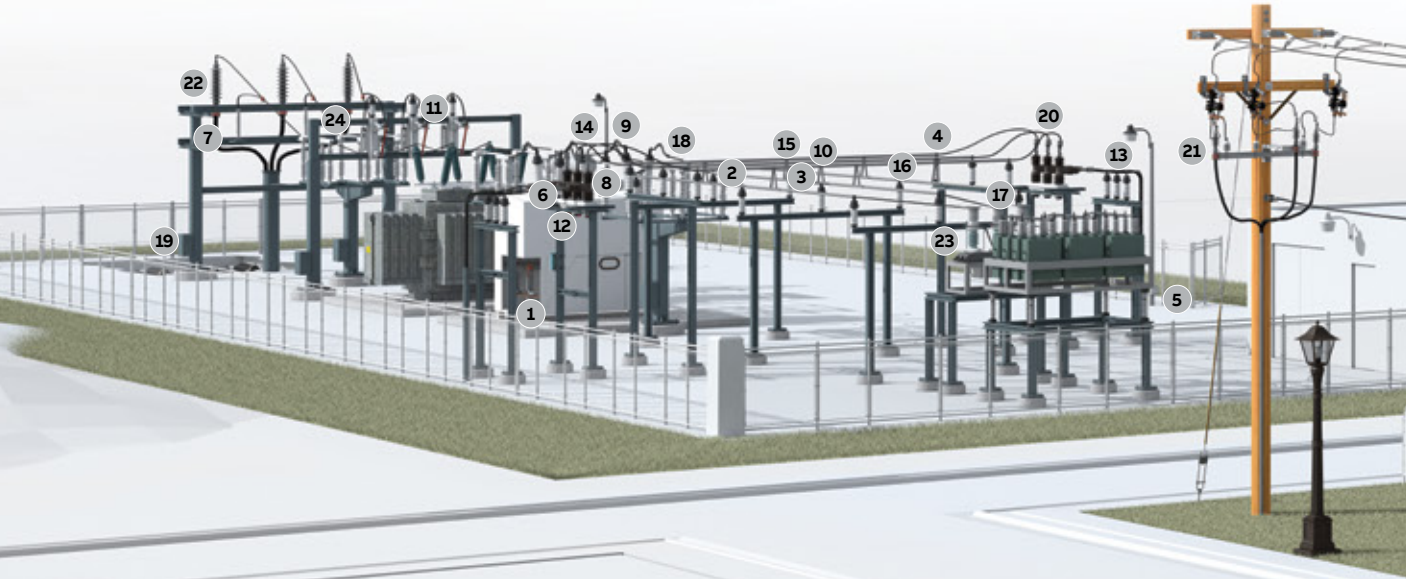



Substation

Our extensive substation solutions — encompassing weldment and bolted connections up to 500kV, current-limiting fuses, capacitor and reactor switches and more — help you improve reliability and increase efficiency.



- | | | | | | |
|--|---|---|---|--|---|
|  |  |  |  |  |  |
| 1 Blackburn® flexible braid | 2 Homac® bolted elbow, pipe to pipe | 3 Homac corona bell, drive fit | 4 Homac bolted expansion bus support, pipe to insulator | 5 Homac bolted ground connector, two or three cables, parallel to pipe or rod | 6 Homac welded cable jumper, flat to flat |
|  |  |  |  |  |  |
| 7 Homac bolted tee, cable to cable | 8 Homac terminal, two cables to flat | 9 Homac bolted terminal, two cables to flat | 10 Homac bolted terminal, pipe to flat | 11 Homac U-bolt parallel clamp, cable to cable | 12 Homac bolted stud connector |
|  |  |  |  |  |  |
| 13 Homac bolted bus support, cable to insulator | 14 Homac bolted cable spacer, two cables | 15 Homac EHV bolted bus support, two cables to insulator | 16 Homac hook-on bus support, weld or slide, pipe to insulator | 17 Homac bolted terminal, pipe to center-formed flat | 18 Homac aluminum compression terminal |
|  |  |  |  |  |  |
| 19 Elastimold® TCJ cable joint | 20 Elastimold vacuum recloser | 21 Elastimold Ranger2 cold-shrink termination | 22 Elastimold 69 kV transmission cable termination | 23 Joslyn Hi-Voltage™ VBM capacitor switches | 24 Hi-Tech® current-limiting substation fuse |