



# 5SDD 0120C0200

Old part no. DS 879D-12000-02

## Welding diode

### Properties

- High forward current capability
- Low forward and reverse recovery losses
- High operational reliability

### Applications

- Welding equipment
- High current application up to 2000 Hz

### Key parameters

$V_{RRM}$	=	200	V
$I_{FAVm}$	=	11 000	A
$I_{FSM}$	=	85 000	A
$V_{TO}$	=	0.75	V
$r_T$	=	0.020	m $\Omega$

### Types

type	$V_{RRM}$
5SDD 0120C0200	200 V
Conditions: $T_j = -40 \div 170$ °C, half sine waveform, $f = 50$ Hz	

### Mechanical data

$F_m$	Mounting force	35 ÷ 40 kN
$m$	Weight	0.22 kg
$D_s$	Surface creepage distance	4 mm
$D_a$	Air strike distance	4 mm

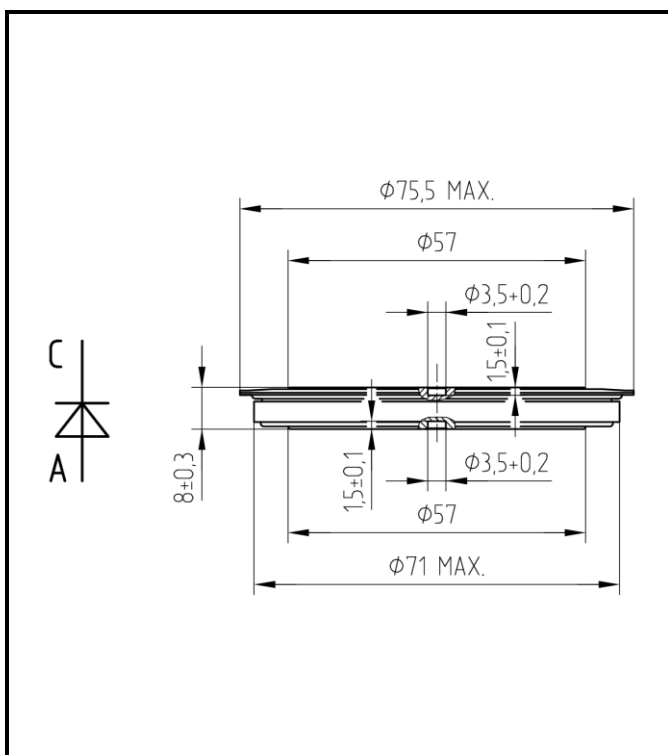

Fig. 1 Case



ABB s.r.o.

Novodvorska 1768/138a, 142 21 Praha 4, Czech Republic

tel.: +420 261 306 250, <http://www.abb.com/semiconductors>

<b>Maximum Ratings</b>		<b>Maximum Limits</b>	<b>Unit</b>
$V_{RRM}$	<b>Repetitive peak reverse voltage</b> $T_j = -40 \div 170 \text{ }^\circ\text{C}$	<b>200</b>	<b>V</b>
$I_{FAVm}$	<b>Average forward current</b> $T_c = 85 \text{ }^\circ\text{C}$	<b>11 000</b>	<b>A</b>
$I_{FRMS}$	<b>RMS forward current</b> $T_c = 85 \text{ }^\circ\text{C}$	<b>17 300</b>	<b>A</b>
$I_R$	<b>Repetitive reverse current</b> $V_R = V_{RRM}$	<b>50</b>	<b>mA</b>
$I_{FSM}$	<b>Nonrepetitive peak surge current</b> $t_p = 10 \text{ ms}, V_R = 0 \text{ V}, \text{ half sine pulse}$	<b>85 000</b>	<b>A</b>
$I^2t$	<b>Limiting load integral</b> $t_p = 10 \text{ ms}, V_R = 0 \text{ V}, \text{ half sine pulse}$	<b>36 000 000</b>	<b>A<sup>2</sup>s</b>
$T_{jmin} - T_{jmax}$	<b>Operating temperature range</b>	<b>- 40 <math>\div</math> 170</b>	<b>°C</b>
$T_{stgmin} - T_{stgmax}$	<b>Storage temperature range</b>	<b>- 40 <math>\div</math> 170</b>	<b>°C</b>

Unless otherwise specified  $T_j = 170 \text{ }^\circ\text{C}$

<b>Characteristics</b>		<b>Value</b>			<b>Unit</b>
		<i>min</i>	<i>typ</i>	<i>max</i>	
$V_{T0}$	<b>Threshold voltage</b>			<b>0.750</b>	<b>V</b>
$r_T$	<b>Forward slope resistance</b> $I_{F1} = 8\ 000 \text{ A}, I_{F2} = 18\ 000 \text{ A}$			<b>0.020</b>	<b>m<math>\Omega</math></b>
$V_{FM}$	<b>Maximum forward voltage</b> $I_{FM} = 8000 \text{ A}$			<b>0.92</b>	<b>V</b>
$Q_{rr}$	<b>Recovered charge</b> $I_{FM} = 1000 \text{ A}, di/dt = -30 \text{ A}/\mu\text{s}, V_R = 50 \text{ V}$		<b>350</b>		<b><math>\mu\text{C}</math></b>

Unless otherwise specified  $T_j = 170 \text{ }^\circ\text{C}$

<b>Thermal Specifications</b>			<b>Value</b>	<b>Unit</b>
$R_{thjc}$	<b>Thermal resistance junction to case</b>	<i>double side cooling</i>	<b>6</b>	<b>K/kW</b>
		<i>single side cooling</i>	<b>12</b>	
$R_{thch}$	<b>Thermal resistance case to heatsink</b>	<i>double side cooling</i>	<b>3</b>	<b>K/kW</b>
		<i>single side cooling</i>	<b>6</b>	

ABB s.r.o., Novodvorska 1768/138a, 142 21 Praha 4, Czech Republic

**Analytical function for transient thermal impedance**

$$Z_{thjc} = \sum_{i=1}^4 R_i (1 - \exp(-t / \tau_i))$$

Conditions:

$F_m = 35 \div 40$  kN, Double side cooled

$i$	1	2	3	4
$R_i$ (K/kW)	4.6507	0.8219	0.4408	0.0870
$\tau_i$ (s)	0.0830	0.0172	0.0040	0.0002

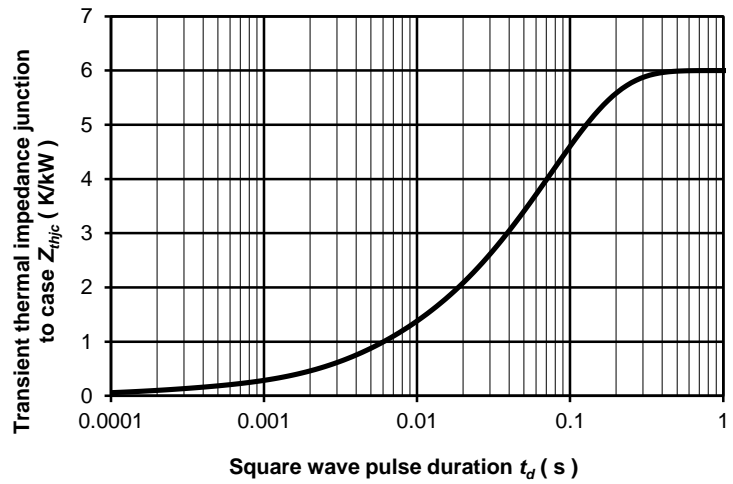

Fig. 2 Dependence transient thermal impedance junction to case on square pulse

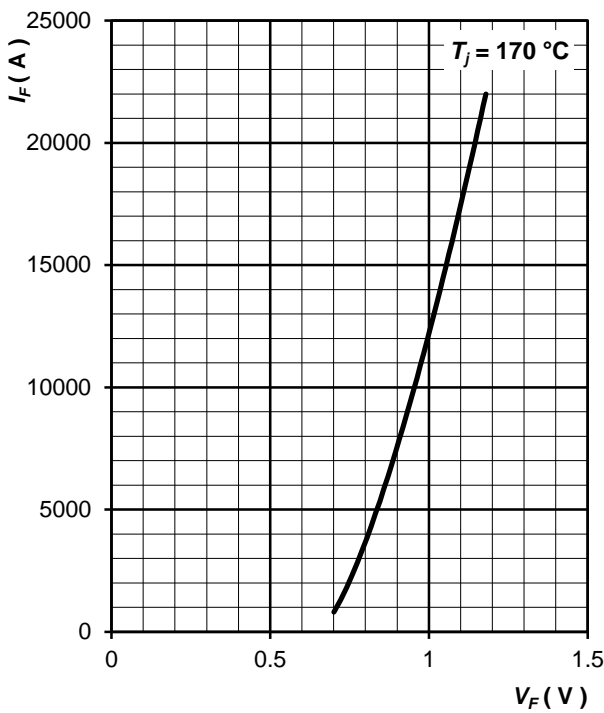

Fig. 3 Maximum forward voltage drop characteristics

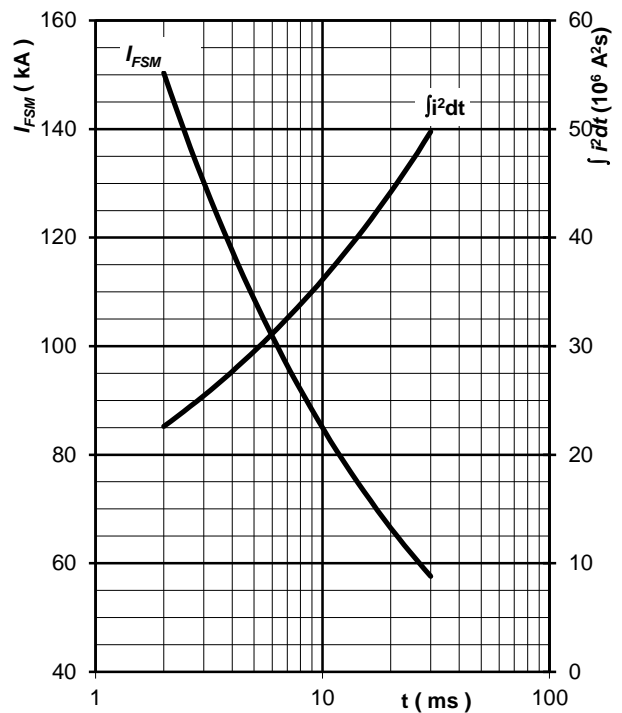

Fig. 4 Surge forward current vs. pulse length, half sine wave, single pulse,  $V_R = 0$  V,  $T_j = T_{jmax}$

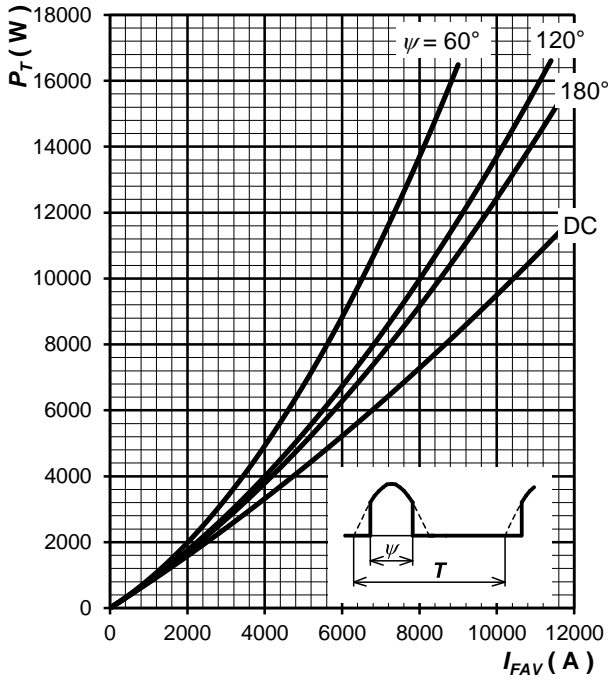

Fig. 5 Forward power loss vs. average forward current, sine waveform,  $f = 50$  Hz

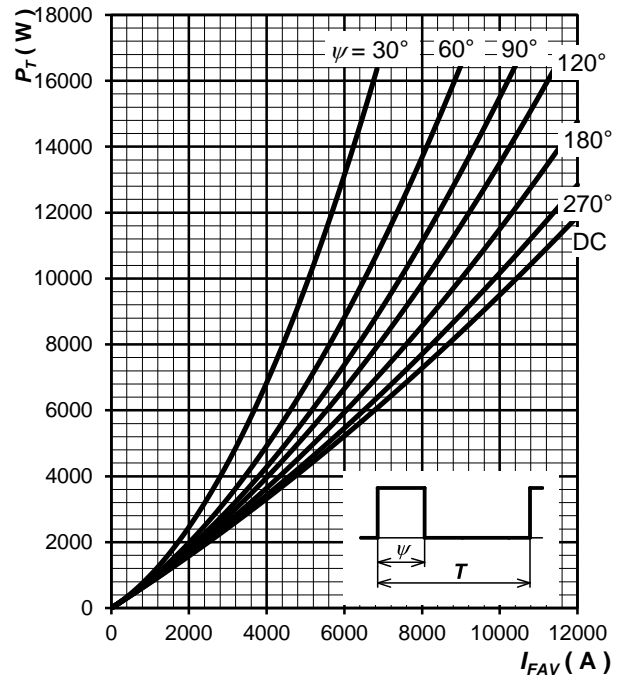

Fig. 6 Forward power loss vs. average forward current, square waveform,  $f = 50$  Hz

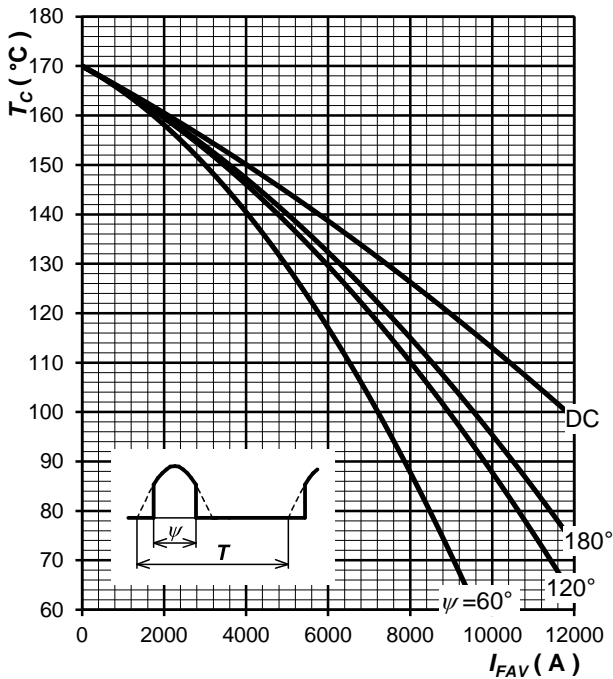

Fig. 7 Max. case temperature vs. aver. forward current, sine waveform,  $f = 50$  Hz

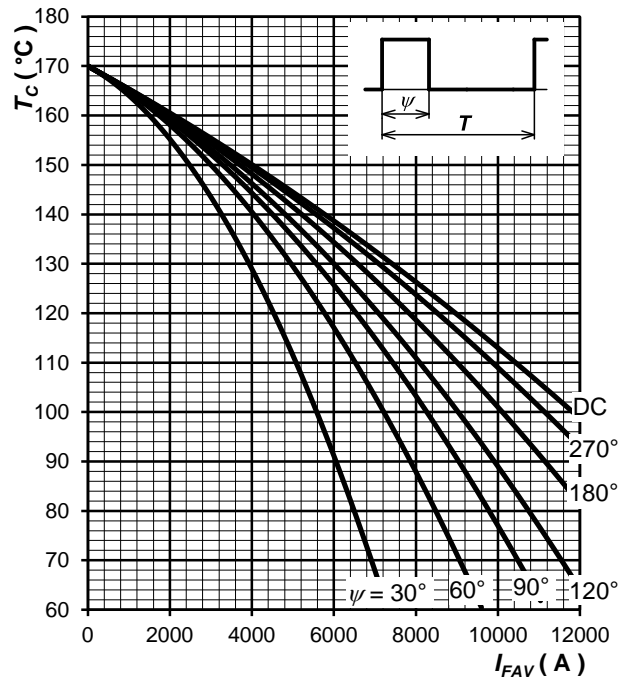

Fig. 8 Max. case temperature vs. aver. forward current, square waveform,  $f = 50$  Hz

ABB s.r.o., Novodvorska 1768/138a, 142 21 Praha 4, Czech Republic

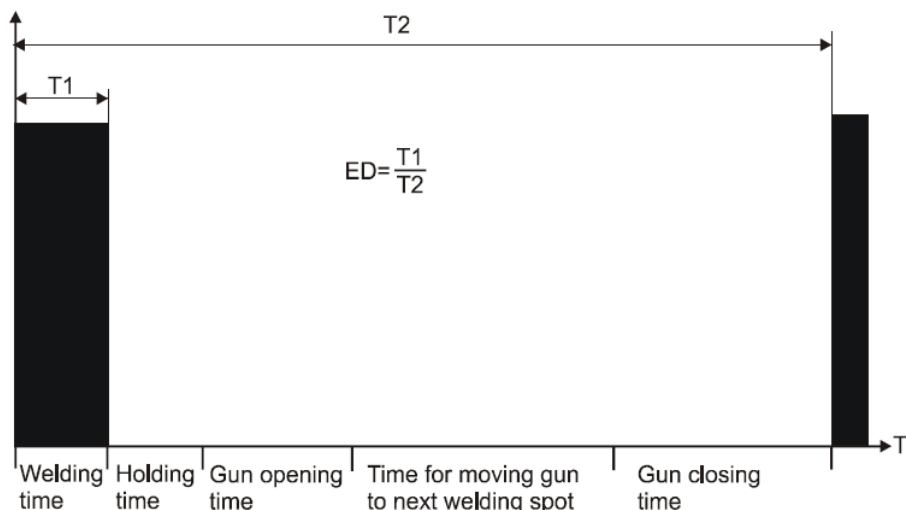

Fig. 9 Definition of ED for typical welding sequence

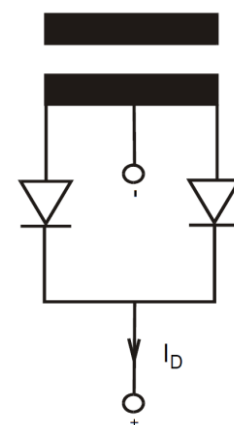

Fig. 10 Definition of  $I_D$  for single-phase centre tap

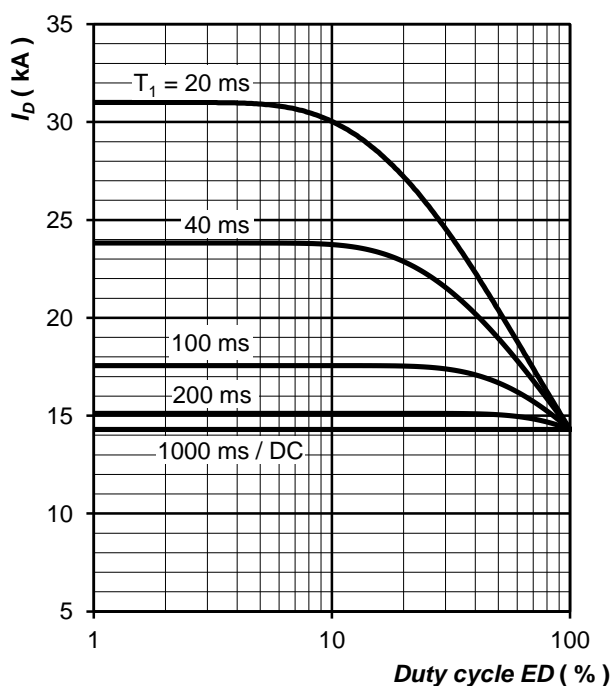

Fig. 11 Current load capacity, cont.,  
DC output welding current with single-phase centre tap vs. duty cycle  
 $f = 1000 \text{ Hz}$ , square wave,  $\Delta T_j = 80 \text{ }^\circ\text{C}$

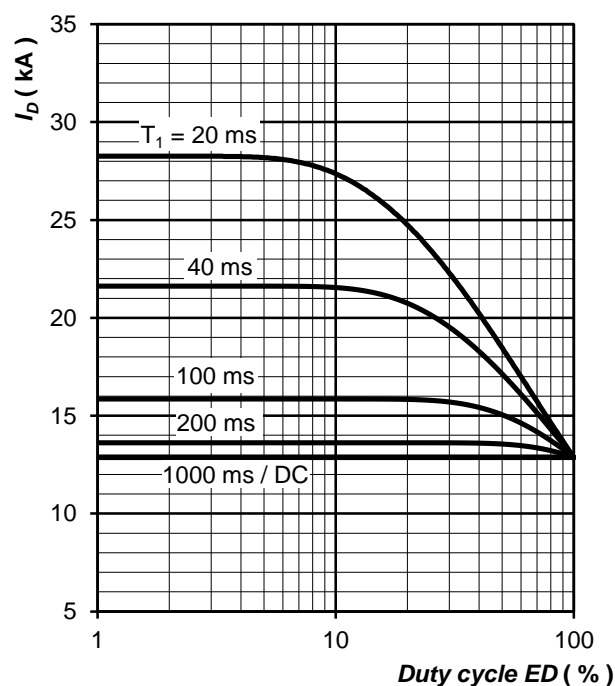

Fig. 12 Current load capacity, cont.,  
DC output welding current with single-phase centre tap vs. duty cycle  
 $f = 1000 \text{ Hz}$ , square wave,  $\Delta T_j = 70 \text{ }^\circ\text{C}$

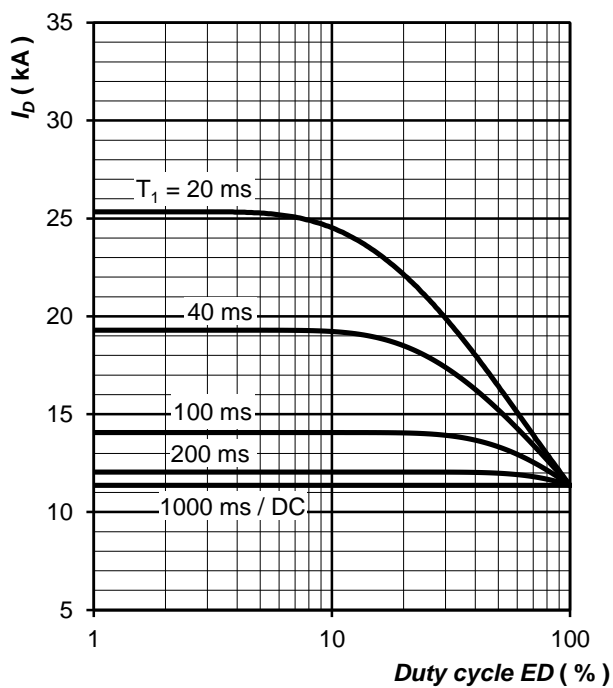

Fig. 13 Current load capacity, cont.,  
DC output welding current with single-phase  
centre tap vs. duty cycle  
 $f = 1000 \text{ Hz}$ , square wave,  $\Delta T_j = 60 \text{ }^\circ\text{C}$

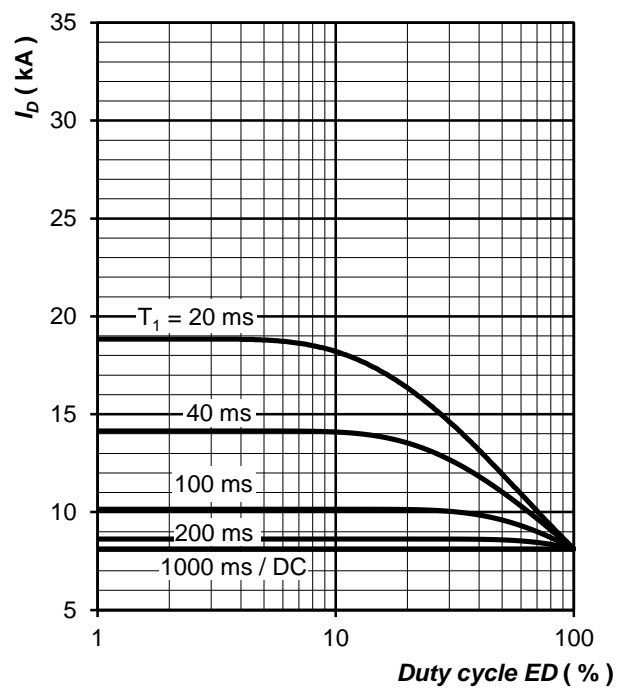

Fig. 14 Current load capacity, cont.,  
DC output welding current with single-phase  
centre tap vs. duty cycle  
 $f = 1000 \text{ Hz}$ , square wave,  $\Delta T_j = 40 \text{ }^\circ\text{C}$

Notes: