

PRODUCT BROCHURE

# Deltec<sup>®</sup> heavy-duty cable strap and accessories

Designed to perform a minimum of 20 years outdoors!





**Designed to withstand harsh outdoor environments.**

- Power transmission and distribution
- Metals and mining
- Renewable energy
- Marine
- Agriculture
- Civil infrastructure
- Oil and gas

**Applications**

- Cable strapping and bundling on utility poles
- Next to conveyors to funnel cables to motors, equipment and lights
- For wire and harness bundling on large equipment
- To hold solar panels in place or run cables behind the panels
- To lash and bundle cables in wind turbines
- For cable management and support on docks, piers and pilings
- For bundling and lashing hoses and wiring on irrigation systems and farm equipment
- Pipeline cabling support system
- Outdoor bundling of cable and fiber optics in cable tray



# Deltec® heavy-duty cable strap and accessories

Designed to perform a minimum of 20 years outdoors.



Lost-time accidents and downtime are often the result of using traditional metal bundling and support systems for high strength and harsh environment applications. Metal support systems can be both difficult and dangerous to install. They can also nick or cut through cable insulation. Insulation failures lead to dangerous and costly situations. There are few options outside of traditional metal for bundling and supporting cable that will withstand the harshest of environments and offer extended outdoor life.



In response to the demand for a better solution, ABB engineers developed the Deltec cable support system. The Deltec system is safe and easy to install with a guaranteed weatherable life, even at temperatures as low as -85 °F.



A three-piece, three-material engineered design provides the ideal solution for bundling in harsh outdoor environments. The Deltec system combines the strength and rigidity of an injection-molded head with marine-grade copper barbs and a soft and pliable, stress-resistant, extruded body. The unique multi-piece design with separate head and strapping also allows installers to select and customize the strap length for any application. The Deltec system provides the ultimate in cable support and management for your most demanding applications.

## Advantages of the Deltec system Include:

- Designed to perform a minimum of 20 years outdoors
- Continuous use temperature: -85 °F to 194 °F (-65 °C to 90 °C)
- No sharp edges
- Perfect for coaxial, fiber optic and all other communication and electrical conducting cables
- Total flexibility in length when using reel
- Extruded body provides total flexibility in length from 10" to 1,000 feet
- Made in the USA
- Rodents and other pests won't eat it
- Strap and body: weatherable acetal; offers superior resistance to sunlight, moisture and salt environments
- Locking device: marine-grade corrosion-resistant copper alloy
- Installation temperature range: -30 °F to 150 °F (-34 °C to 66 °C)
- Minimum tensile strength: 250 lbs. (1,211 N)
- Continuous load: 20 lbs. (9.07 kg)



## Deltec® system



### Strap on reel and reel kits

Product code	GID No.	Length per reel		Width	Min. tensile strength	Included heads	Reel quantity	
		[m]	[ft]					[mm]
TYD-50R	7TAA159090R0005	15.2	50	12.7	0.5	250/1112	0	1
CSS-50R	7TAA159100R0005	15.2	50	12.7	0.5	250/1112	0	10
696-41794	7TAA159090R0000	304.8	1000	12.7	0.5	250/1112	0	1
CSS-5K	7TAA159120R0000	15.2	50	-	-	-	150	5
CSS-10K	7TAA159130R0001	15.2	50	-	-	-	300	5

Note: the recommended maximum continuous static loading for the Deltec® straps is 90 N per strap.

For best results, suggested spacing is 35 to 40cm. It is the responsibility of the user to determine if their installation provides sufficient load support.

Reel kits (CSS-5K / CSS-10K) to be assembled with Deltec® strap on reel.



### Double locking heads

Product code	GID No.	Length		Width		Height	Quantity
		[mm]	[in]	[mm]	[in]		
CSS-LH	7TAA159150R0000	21.6	0.9	19.1	0.75	12.6	25/500
TYD-LH	7TAA159090R0006	21.6	0.9	19.1	0.75	12.6	25/125
696-41795	7TAA159090R0001	21.6	0.9	19.1	0.75	12.6	500

To be assembled with Deltec® strap on reel

### Dimensions

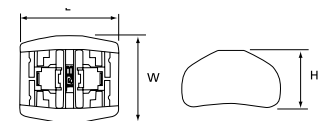

### Deltec installation/cutting tool

Cat. no.	Description	Range (in.)	Wt. each (oz.)	Std. pkg. qty.	UPC no.
WT3D	Installs self-locking Ty-Rap® cable ties and ABB lashing ties	0.184–0.500	8	1	786210-83503

• Twist tool handle one-half turn to cut strapping



Pre-assembled Deltec® cable ties

Product code	GID No.	Max. bundle dia.		Length L		Width W		Min. tensile strength [lb/N]	Quantity [pieces]
		[mm]	[in]	[mm]	[in]	[mm]	[in]		
CSS-100	7TAA159110R0000	76	3	254	10	12.7	0.5	250/1112	25
CSS-135	7TAA159090R0003	89	3.5	343	13.5	12.7	0.5	250/1112	25
CSS-160	7TAA159170R0000	102	4	406	16	12.7	0.5	250/1112	50
CSS-270	7TAA159080R0000	203	8	686	27	12.7	0.5	250/1112	10

Dimensions

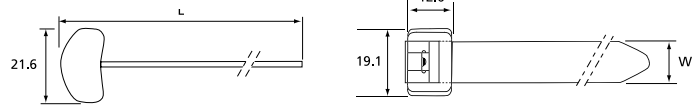

Deltec modular stackable cable spacers

Cat. no.	Description	Std. pkg. qty.	UPC no.
TCP5255	Modular stackable spacer for Deltec straps	25	786210-71338
TCP360	For coaxial cable	100	786210-78784

- Made of weather-resistant polypropylene
- Color — Black



Deltec base and hanger

Cat. no.	Description	Std. pkg. qty.	UPC no.
CSS-B	Base for Deltec strap	50	786210-71212
CSS-H	Hanger for Deltec strap	50	786210-71263

- Made of zinc-plated steel



---

**ABB Installation Products Inc.**

Electrification Business  
860 Ridge Lake Blvd.  
Memphis, TN 38120

Customer Service: 800-816-7809  
Technical Support: 888-862-3289

**[electrification.us.abb.com](http://electrification.us.abb.com)**

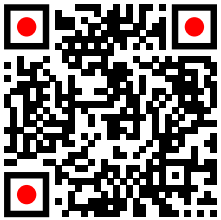

Scan QR code to learn  
more about the Deltec®  
fastening system.