



# OVR BT2 70-440s P TS

Order code : 2TAM 1010 00 R 58 11  
EAN code : 6 940 342 27286 1



OVR BT2 70-440s P TS

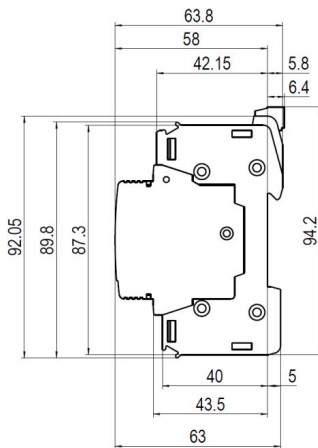

Overall dimensions (in mm)

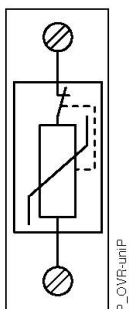

Operating diagram

## Pluggable Unit

### Electrical characteristics

Types of networks		TT – TNS – TNC – IT
Number of poles		1
Type / test class		T2 / II
Type of current		A.C.
Nominal voltage Un	V	400
Maximal continuous operating voltage Uc	V	440
Voltage protection level Up at In	kV	2
Voltage protection level Ures at 3 kA	kV	1.3
Voltage protection level Ures at 5 kA	kV	1.4
Nominal discharge current In (8/20)	kA	30
Maximal discharge current Imax (8/20)	kA	70
TOV withstand Ut (5s)	V	400
Follow current If	A	None
Response time	ns	25
Operating current I <sub>c</sub>	mA	< 1
Short circuit withstand I <sub>cc</sub>	kA	50
Degree of protection		IP 20
Disconnecter		
Curve C Circuit breaker	A	<125
gG - gL fuse	A	<125

### Mechanical characteristics

Wire range		
Solid wire	mm <sup>2</sup>	2.5...25
Stranded wire	mm <sup>2</sup>	2.5...16
Stripping length	mm	12.5
Tightening torque	Nm	2
Overall dimensions		
Length	mm	65
Width	mm	18
Height over DIN rail	mm	95
Integrated thermal disconnecter		Yes
State indicator		Yes
Safety reserve		Yes
TS remote indicator		Yes
Contact complement		1NO – 1NC
Minimal load		12VDC – 10mA
Maximal load		250VAC – 1A
Connection cross section	mm <sup>2</sup>	1.5

### Miscellaneous characteristics

Stocking temperature	°C	- 40 to +80
Operating temperature	°C	- 40 to +80
Maximal altitude	m	2000
Weight	g	140
Color of Housing		PC grey RAL 7035
Fire resistance according to UL 94		V0
Reference standards		GB 18802.1 / IEC 61643-1

### Replacement cartridge

OVR BT2 70-440s C

2TAM 1002 00 R 58 10