

Earth bonds & clamps

Mechanical clamps

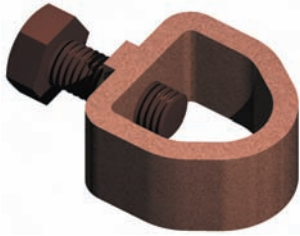

Rod to tape clamp (type A)

Material: Copper alloy

Part No.	Nominal Rod Diameter (")	(mm)	Max. Conductor (mm)	Weight Each (kg)
CR105*	1/2	12.7	26 x 12	0.15
CR105*	5/8	16	26 x 12	0.15
CR105*	3/4	20	26 x 10	0.15
CR108	5/8	16	30 x 2	0.16
CR108	3/4	20	30 x 2	0.16
CR110	5/8	16	40 x 12	0.24
CR115	5/8	16	51 x 8	0.30
CR125	3/4	20	51 x 12	0.30
CR130	1/2	12.7	26 x 20	0.23
CR130	5/8	16	26 x 18	0.23
CR130	3/4	20	26 x 10	0.23
CR130	1	25	26 x 10	0.23

Standards



UL467

BS EN 50164-1 Class H
BS EN 7430

– Designed for connection of flat tape conductor to an earth rod. Corrosion resistance, conductivity and mechanical strength are essential considerations in clamp design to ensure an earthing system remains operative for many years. All Furse earth rod clamps have high strength copper alloy bodies and screws e.g. aluminium bronze, phosphor bronze etc., commercial brass is not used

– Tightening torque 15 Nm

*UL467 (CR105)

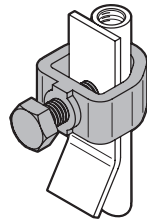

Rod to cable clamp (type G)

Material: Copper alloy

Part No.	Nominal Rod Diameter (")	(mm)	Max. Conductor (mm ²)	Weight Each (kg)
CR505	3/8	9.5	6-35	0.03
CR510-FU*	1/2	12.5	16-50	0.05
G5**	5/8	16	5.2-33.6	0.06
CR515*	5/8	16	16-70	0.06
G6**	3/4	20	5.2-33.6	0.06
CR520*	3/4	20	35-95	0.06
CR525	1	25	70-150	0.14

Standards



UL467

BS EN 50164-1 Class H
BS EN 7430

– High strength copper alloy clamp designed to provide a high quality, low resistance connection between solid circular or stranded conductor and an earth rod.

– Tightening torque 12 Nm

– *Suitable for use with 8 mm Ø solid circular copper conductor

**UL467 (G5 & G6)

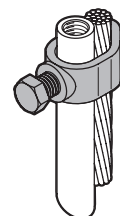

Earth bonds & clamps

Mechanical clamps



'U' bolt rod clamp (type E)

Material: Copper alloy

Part No.	Nominal Rod/ Rebar Diameter (")	(mm)	Hole Centres (mm)	Tape Width (mm)	Weight Each (kg)
CR305**	5/8	16	37	–	0.20
CR310	3/4	20	37	–	0.20
CR315	1	25	37	–	0.20
CR320*	5/8	16	37	25	0.26
CR325	1 1/2	38	54	–	0.37
CR330	2	50	64	–	0.44
CR326	TBC	TBC	TBC	–	TBC

Standards



UL467

BS EN 7430

– High strength copper alloy 'U' bolt clamp designed to provide a high quality, low resistance connection between flat tape or stranded conductor and earth rod or rebar. 'U' Bolt threaded M10

– *CR320 includes additional plate to allow tape to be clamped without drilling

**UL467 (CR305)

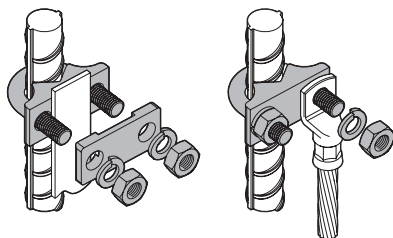

'U' bolt rod clamp (type GUV)

Material: Copper alloy

Part No.	Nominal Rod/ Rebar Diameter (")	(mm)	Conductor Range (mm ²)	Weight Each (kg)
CR700*†	5/8	16	16-95	0.39
CR700*†	3/4	20	16-70	0.39
CR705†	5/8	16	70-185	0.39
CR705†	3/4	20	70-150	0.39
CR730†	5/8	16	150-300	0.62
CR730†	3/4	20	150-300	0.62
CR710	1	25	16-70	0.39
CR740	1	25	70-150	0.39
CR750	1	25	150-300	0.62

Standards



UL467

BS EN 50164-1 Class H

BS EN 7430

– High strength copper alloy 'U' bolt clamp designed to provide a high quality, low resistance connection between solid circular or stranded conductor and an earth rod or rebar.

– Tightening torque 12 Nm

– * Suitable for use with 8 mm Ø solid circular copper conductor.

**UL467 (CR700, CR705, CR730)

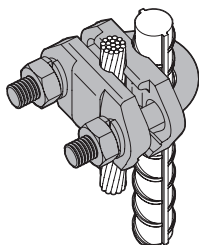

Earth bonds & clamps

Mechanical clamps



Rod to tape clamp (type A)

Material: Copper alloy

Part No.	Nominal Rod Diameter		Rod Type	Bolt Size	Weight Each (kg)
	(")	(mm)			
CR205	3/8	9.5	Copperbond	M8	0.09
CR215	5/8	16	Copperbond	M10	0.30
CR220	5/8	15	Solid copper	M10	0.30
CR225	3/4	20	Copperbond	M10	0.30
CR230	3/4	20	Solid copper	M10	0.30

– High strength copper alloy cable lug clamp designed to provide a high quality, low resistance connection between stranded conductor and earth rod

Standards

BS EN 7430

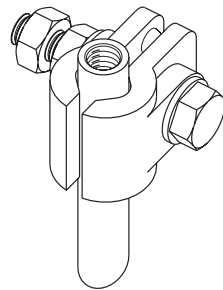

8



Rebar clamp

Material: Copper alloy

Part No.	Conductor Diameter (mm)	Rebar Diameter (mm)	Conductor Material	Weight Each (kg)
BN150	8	8-18	Copper	0.32
BN155	8	18-38	Copper	0.75

– High strength copper alloy rebar clamp for bonding to reinforcing bars, steam pipes, handrails etc.
 – Tightening torque 15 Nm (BN155 - M10); 5 Nm (BN155 - M6)

Standards

BS EN 7430

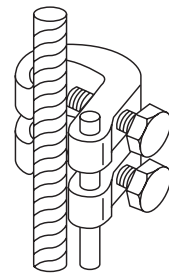

Earth bonds & clamps

Rebar clips



Rebar to rebar connecting clip

Material: Stainless steel 316

Part No.	Maximum Rebar Diameter (A) (mm)	Maximum Rebar Diameter (B) (mm)	Weight Each (kg)
RR812	8	12	0.05
RR1616	16	16	0.05
RR2121	20	20	0.06
RR2626	25	25	0.07
RR3232	32	32	0.07
RR3838	40	40	0.08

Standards

BS EN 50164-1 Class H

- Manufactured from high quality stainless steel for excellent corrosion resistance. Simple to install, providing a secure connection between internal reinforcing bars
- Tightening torque 12 Nm

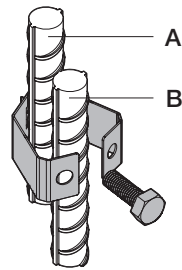

Rebar to conductor connecting clip

Material: Stainless steel 316

Part No.	Rebar Diameter (mm)	Conductor Size	Weight Each (kg)
Rebar to flat tape			
RC25-087095	25	25 x 3 mm	0.07
Rebar to stranded/solid circular conductor			
RC812-0850	12	50 mm ² or 8 mm dia.	0.05
RC16-087095	16	8 mm dia., 50-70-95 mm ²	0.06
RC20-087095	20	8 mm dia., 50-70-95 mm ²	0.07
RC25-087095	25	8 mm dia., 50-70-95 mm ²	0.07
RC32-087095	32	8 mm dia., 50-70-95 mm ²	0.07
RC40-087095	40	8 mm dia., 50-70-95 mm ²	0.08

Standards

BS EN 50164-1 Class H

- Manufactured from high quality stainless steel for excellent corrosion resistance. Simple to install, providing a secure connection between internal reinforcing bars and flat tape, solid circular or stranded conductor
- Tightening torque 12 Nm

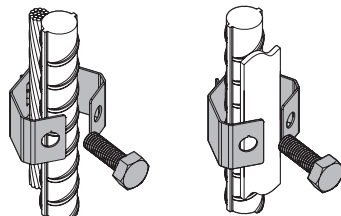

Earth bonds & clamps

Earth points

Earth points

Furse earth points are available for direct connection to conductors, or with additional pre-welded tail (single or double 70 mm² PVC insulated cable) to enable connection to internal rebar arrangements via mechanical clamps (see product tables for individual product availability).

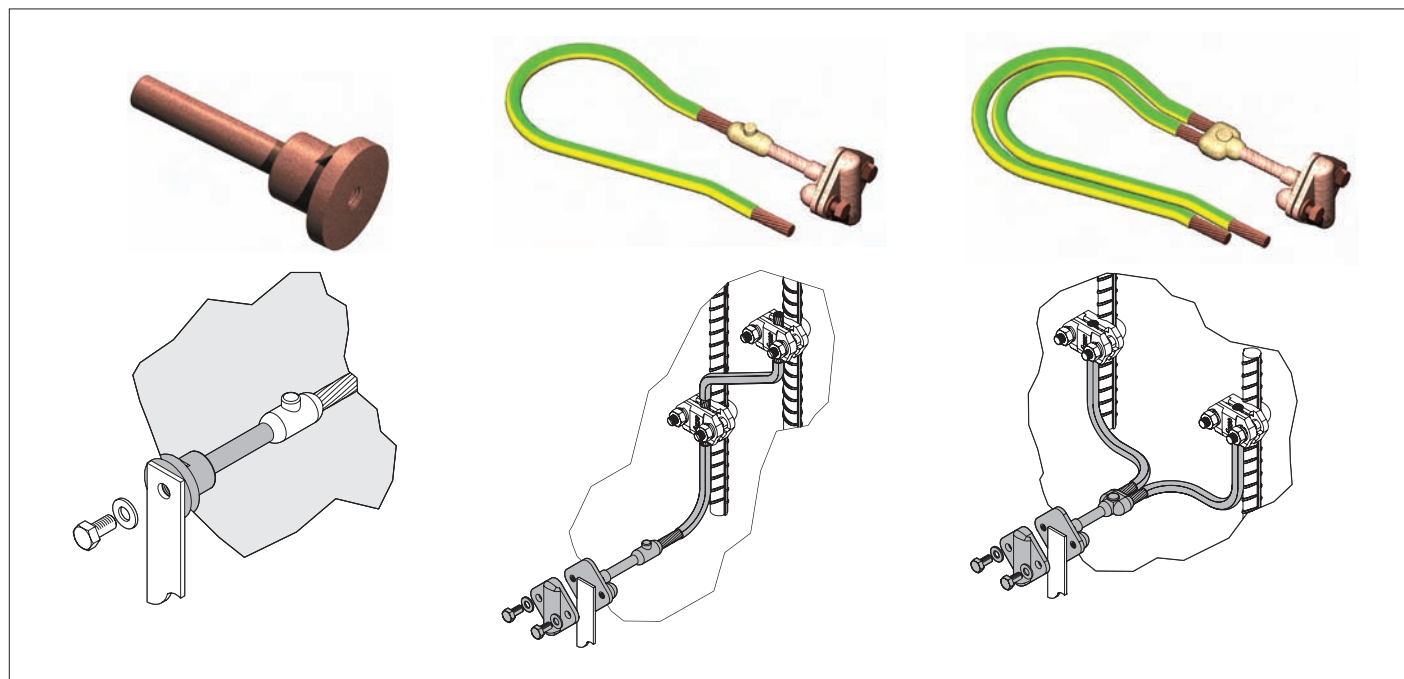

8



Single hole earth point

Part No.	Hole Size (mm)	Length (mm)	Weight Each (kg)
PC100-FU	M8 x 15	80	0.14
PC101	M10 x 15	80	0.14
PC102	M12 x 15	80	0.14
PC103	M16 x 15	80	0.14

Approvals



UL96

BS EN 50164-1 Class H
BS EN 7430

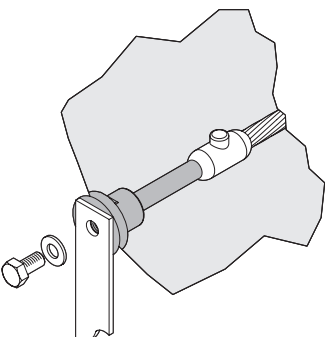

Part No.	Description (mm)	Weight each (kg)
Single hole earth point with single pre-welded tail		
PC105*	PC100-FU earth point with pre-welded 500 earth cable	0.56
PC106*	PC101 earth point with pre-welded 500 earth cable	0.56
PC107*	PC102 earth point with pre-welded 500 earth cable	0.56
PC108*	PC103 earth point with pre-welded 500 earth cable	0.56

Stem diameter = 10.7 mm (70 mm²)

Tightening torque 8 Nm

*UL96 (PC105, PC106, PC107, PC108)

Earth bonds & clamps

Earth points

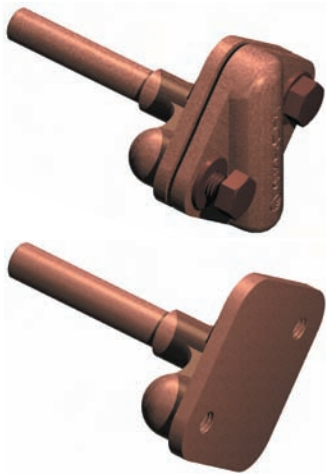

Two hole earth point

Tested to: BS 7430

Part No.	Description	Hole Size (mm)	Length (mm)	Weight Each (kg)
PC115-FU	Supplied c/w front plate for connection of 25 mm x 3 mm copper tape or 70 mm ² stranded copper cable	M8 x 12	80	0.44
PC120	Supplied c/w front plate for connection of 25 mm x 3 mm copper tape or 8 mm diameter solid circular copper	M8 x 12	80	0.44
PC125	Supplied without front plate	M8 x 12	80	0.28

Two hole earth point with single pre-welded tail

PC116*	PC115-FU earth point with pre-welded 500 mm earth cable			0.84
PC121*	PC120 earth point with pre-welded 500 mm earth cable			0.84
PC126-FU*	PC125 earth point with pre-welded 500 mm earth cable			0.84

Two hole earth point with double pre-welded tail

PC216*	PC115-FU earth point with pre-welded 2 x 500 mm earth cable			1.26
PC221	PC120 earth point with pre-welded 2 x 500 mm earth cable			1.26

Stem diameter = 10.7 mm (70 mm²)

Tightening torque 8 Nm

*UL96 (PC116, PC121, PC126-FU, PC216)

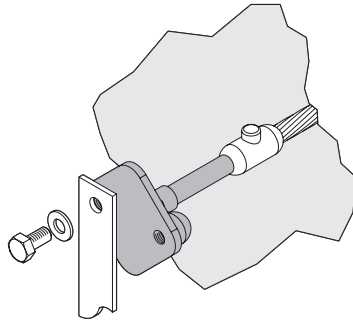

Approvals



UL96

BS EN 50164-1 Class H
BS EN 7430

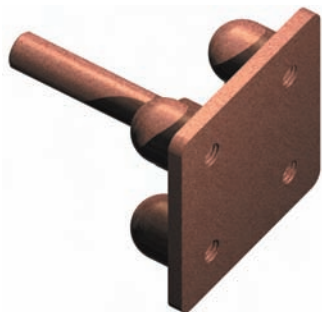

Rebar to conductor connecting clip

Tested to: BS 7430

Part No.	Description	Hole Size (mm)	Length (mm)	Weight Each (kg)
PC110		M8 x 14	75	0.41

Four hole earth point with single pre-welded tail

PC111*	PC110 earth point with pre-welded 500 mm earth cable			1.14
--------	--	--	--	------

Four hole earth point with double pre-welded tail

PC211*	PC110 earth point with pre-welded 2 x 500 mm earth cable			1.23
--------	--	--	--	------

Stem diameter = 10.7 mm (70 mm²)

Tightening torque 12 Nm

*UL96 (PC111, PC211)

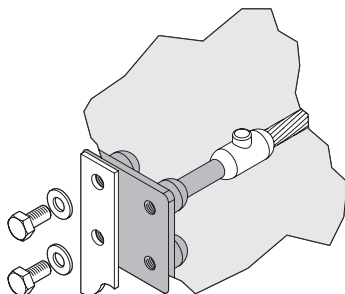

Approvals



UL96

BS EN 50164-1 Class H
BS EN 7430

Earth bonds & clamps

Splitbolt connector



Type H high strength splitbolt connector

Material: Copper alloy

Part No.	Conductor Range				Dimension (B) (mm)	Weight Each (kg)
	Main Min (mm ²)	Main Max (mm ²)	Tap Min (mm ²)	Tap Max (mm ²)		
8H-FU	4	10	2.5	10	4.1	0.02
4H-FU	10	16	2.5	16	5.5	0.03
2H-FU	16	25	4	25	6.9	0.04
1H-FU	25	35	4	35	8.4	0.06
10H-FU	35	50	4	50	9.7	0.09
20H-FU	35	70	4	70	11.2	0.14
30H-FU	50	95	4	95	13.6	0.17
40H-FU	50	120	6	120	14.7	0.18
350M-FU	95	185	6	185	18.2	0.35

– For copper to copper connections. No special tools required

Standards

BS EN 7430

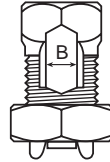
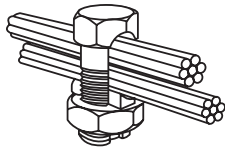

Earth bonds & clamps

Earth bosses

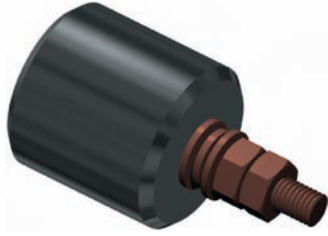

Earth boss

Material: Mild or stainless steel boss

Part No.	Length (mm)	Diameter (mm)	Thread Size	Material	Weight Each (kg)
EB0000	25	25	M8	Mild steel	0.11
EB1000	25	25	M8	Stainless steel	0.11
EB0110	30	30	M8	Mild steel	0.18
EB1110	30	30	M8	Stainless steel	0.18
EB0111	30	30	M10	Mild steel	0.20
EB1111	30	30	M10	Stainless steel	0.20
EB0120	30	40	M8	Mild steel	0.24
EB1120	30	40	M8	Stainless steel	0.24
EB0121	30	40	M10	Mild steel	0.26
EB1121	30	40	M10	Stainless steel	0.26
EB0130	30	50	M8	Mild steel	0.29
EB1130	30	50	M8	Stainless steel	0.29
EB0131	30	50	M10	Mild steel	0.31
EB1131	30	50	M10	Stainless steel	0.31
EB0211	40	30	M10	Mild steel	0.33
EB1211	40	30	M10	Stainless steel	0.33
EB0212	40	30	M12	Mild steel	0.36
EB1212	40	30	M12	Stainless steel	0.36
EB0221	40	40	M10	Mild steel	0.43
EB1221	40	40	M10	Stainless steel	0.43
EB0222	40	40	M12	Mild steel	0.45
EB1222	40	40	M12	Stainless steel	0.45
EB0231	40	50	M10	Mild steel	0.53
EB1231	40	50	M10	Stainless steel	0.53
EB0232	40	50	M12	Mild steel	0.55
EB1232	40	50	M12	Stainless steel	0.55
EB0311	50	30	M10	Mild steel	0.50
EB1311	50	30	M10	Stainless steel	0.50
EB0312	50	30	M12	Mild steel	0.52
EB1312	50	30	M12	Stainless steel	0.52
EB0321	50	40	M10	Mild steel	0.65
EB1321	50	40	M10	Stainless steel	0.65
EB0322	50	40	M12	Mild steel	0.67
EB1322	50	40	M12	Stainless steel	0.67
EB0001	50	50	M10	Mild steel	0.80
EB1331	50	50	M10	Stainless steel	0.80
EB0332	50	50	M12	Mild steel	0.80
EB1332	50	50	M12	Stainless steel	0.80

Standards

BS EN 7430

Continuous
5mm Fillet Weld

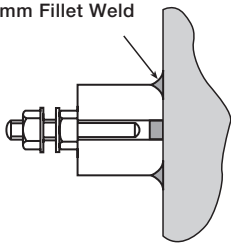

– Earth boss manufactured from mild steel (to 970 230M07 grade EN1A) or stainless steel (grade 316L) complete with stainless steel studs, nuts and washers - grade 316L. For welding to steel vessels, tanks, structures etc. Wrap connections with Denso tape

Earth bonds & clamps

Bonds & clamps

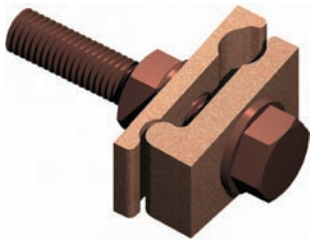

Tower earth clamp

Material: Copper or aluminium alloy

Part No.	Conductor Range (mm ²)	Channel Thickness (mm)	Bolt Size	Conductor Material	Weight Each (kg)
BN125*	16-70	10	M10	Copper	0.13
BN130	70-120	10	M12	Copper	0.22
BN300-FU*	25-50	10	M10	Copper	0.08
BN305*	25-50	10	M10	Aluminium	0.05
BN320	120-185	10	M12	Copper	0.30
BN325	185-240	10	M12	Copper	0.40

- For bonding copper cable or wire to steel structures.
- Tightening torque 12 Nm
- * Suitable for use with 8 mm Ø solid circular conductor

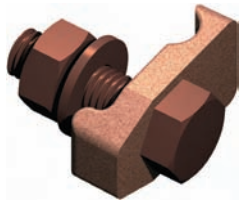

Standards

BS EN 50164-1 Class H
BS EN 7430

8

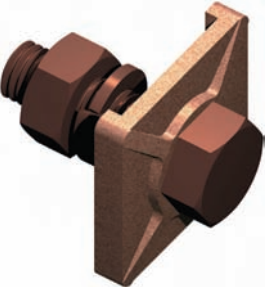

B bond

Material: Copper or aluminium alloy

Part No.	Maximum Tape With (mm)	Bolt Size	Max. Conductor	Weight Each (kg)
BN105	26 mm	M10	Copper	0.12
BN005	26 mm	M10	Aluminium	0.06
BN113	31 mm	M10	Copper	0.15

- For bonding tape to steel structures
- Tightening torque 17 Nm

Standards

BS EN 50164-1 Class H
BS EN 7430

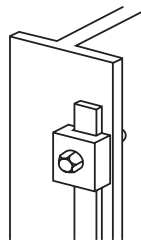

Earth bonds & clamps

Bonds & clamps

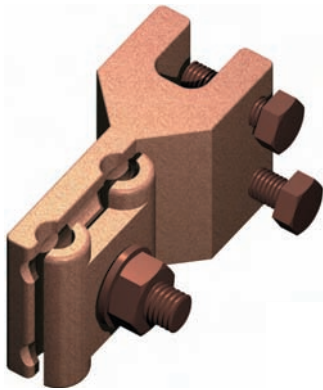

Metalwork bond

Material: Copper or aluminium alloy

Part No.	Conductor Diameter (mm)	Conductor Material	Weight Each (kg)
CS350	8 mm	Copper	0.37
CS355	8 mm	Aluminium	0.17

- For connecting to all types of metal structures up to 13 mm thickness
- Tightening torque - M8 bolt: 10 Nm, M10 bolt: 12 Nm

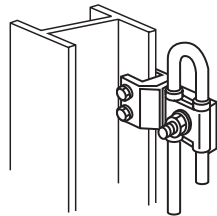

Standards

BS EN 50164-1 Class H
BS EN 7430

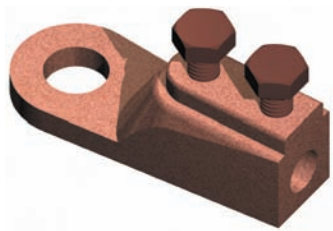

Straight setscrew cable socket

Material: Copper or aluminium alloy

Part No.	Conductor Diameter (mm)	Palm Hole Diameter (mm)	Conductor Material	Weight Each (kg)
SX450	8	12	Copper	0.11
SX455	8	12	Aluminium	0.05

- For bonding copper and aluminium conductors to steelwork
- Tightening torque 3 Nm

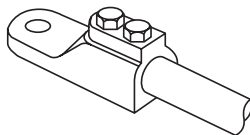

Standards

BS EN 50164-1 Class H

Earth bonds & clamps

Bonds & clamps

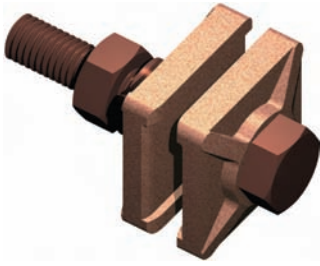

RWP bond

Material: Copper or aluminium alloy

Part No.	Maximum Tape Width (mm)	Bolt Size	Conductor Material	Weight Each (kg)
BN115	26	M10	Copper	0.12
BN010	26	M10	Aluminium	0.07g

– For bonding tape to rainwater pipes, handrails etc.

Standards

BS EN 7430

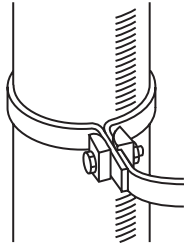

8

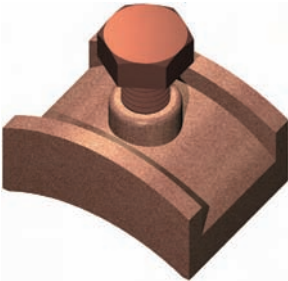

Watermain bond

Material: Copper alloy

Part No.	Maximum Tape Width (mm)	Conductor Material	Weight Each (kg)
BN120	26	Copper	0.26

– For bonding tape to large diameter pipes

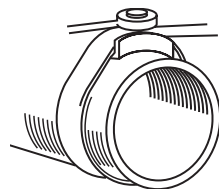

Standards

BS EN 7430

Earth bonds & clamps

Pipe bonds & clamps



Pipe bond

Material: Copper or Aluminium alloy

Part No.	Conductor Diameter (mm)	Pipe Diameter (mm)	Conductor Material	Weight Each (kg)
BN175	8	50-200	Copper	0.46
BN176	8	50-200	Aluminium	0.25

- For bonding to ducts and large diameter pipeworks. Additional lengths available to order
- Tightening torque - M6 bolt: 6 Nm, M10 bolt: 12 Nm
- Manufactured to BS 7430

Standards

BS EN 50164-1 Class H
BS EN 7430

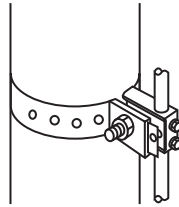

Pipe clamp

Material: Copper alloy clamp with zinc plated U-bolt

Part No.	Pipe Diameter (")	Pipe Diameter (mm)	Conductor Range (mm ²)	Weight Each (kg)
3902	1/2-1	13-25	25-95	0.3
3903	1 1/4-2	32-50	25-95	0.4
3904	2 1/2-3 1/2	65-90	25-95	0.5
3905-TB	4-5	100-125	25-95	0.6
3906-TB	6	150	25-95	0.8
3907	8	200	25-95	1.0
3908	10	250	25-95	1.1
3909-TB	12	300	25-95	1.5

Standards



UL467

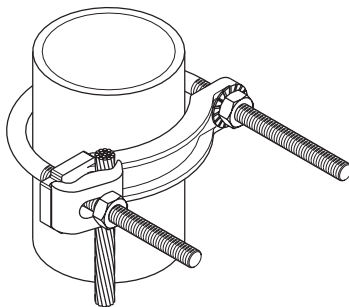

Earth bonds & clamps

Flexible braid bonds



Flexible flat copper braid bond

Material: Copper to BS EN 13602

Part No.	Overall Braid Dimensions (mm)	Length (mm)	Hole Diameter (A) (mm)	Cross-sectional Area (mm ²)	Weight Each (kg)
Copper braid					
FBB-6-200-7	12 x 1	200	7	6	0.01
FBB-6-400-7	12 x 1	400	7	6	0.02
FBB-10-200-7	15 x 1.5	200	7	10	0.02
FBB-10-400-7	15 x 1.5	400	7	10	0.04
FBB-16-200-9	19 x 2.5	200	9	16	0.03
FBB-16-400-9	19 x 2.5	400	9	16	0.06
FBB-25-200-11	25 x 3	200	11	25	0.05
FBB-25-400-11	25 x 3	400	11	25	0.10
BN505	25 x 3.5	200	11	35	0.09
BN515	25 x 3.5	400	11	35	0.15
FBB-50-200-11	30 x 5	200	11	50	0.10
FBB-50-400-11	30 x 5	400	11	50	0.20
FBB-70-200-13	32 x 6	200	13	70	0.13
FBB-70-400-13	32 x 6	400	13	70	0.25
FBB-95-200-13	37 x 6	200	13	95	0.19
FBB-95-400-13	37 x 6	400	13	95	0.37
FBB-120-200-17	45 x 6	200	17	120	0.23
FBB-120-400-17	45 x 6	400	17	120	0.46
FBB-150-200-17	50 x 8	200	17	150	0.30
FBB-150-400-17	50 x 8	400	17	150	0.60
Tinned copper braid					
FBB-6-200-7-T	12 x 1	200	7	6	0.01
FBB-6-400-7-T	12 x 1	400	7	6	0.02
FBB-10-200-7-T	15 x 1.5	200	7	10	0.02
FBB-10-400-7-T	15 x 1.5	400	7	10	0.04
FBB-16-200-9-T	19 x 2.5	200	9	16	0.03
FBB-16-400-9-T	19 x 2.5	400	9	16	0.06
FBB-25-200-11-T	25 x 3	200	11	25	0.05
FBB-25-400-11-T	25 x 3	400	11	25	0.10
BN505-T	25 x 3.5	200	11	35	0.09
BN515-T	25 x 3.5	400	11	35	0.15
FBB-50-200-11-T	30 x 5	200	11	50	0.10
FBB-50-400-11-T	30 x 5	400	11	50	0.20
FBB-70-200-13-T	32 x 6	200	13	70	0.13
FBB-70-400-13-T	32 x 6	400	13	70	0.25
FBB-95-200-13-T	37 x 6	200	13	95	0.19
FBB-95-400-13-T	37 x 6	400	13	95	0.37
FBB-120-200-17-T	45 x 6	200	17	120	0.23
FBB-120-400-17-T	45 x 6	400	17	120	0.46
FBB-150-200-17-T	50 x 8	200	17	150	0.30
FBB-150-400-17-T	50 x 8	400	17	150	0.60

Standards

BS EN 13602

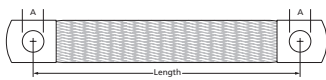

– Flexible copper or flexible tinned copper braid terminated with pressed ferrule connector at each end, suitable for bonding gates, doors, fences etc. Pressed ferrule connection ensures maximum electrical contact with minimum earth resistance
Standard braid sizes are shown. Braids are available in other sizes, lengths, materials or terminations to special order

Earth bonds & clamps

Flexible braid bonds



Flexible circular copper braid bond

Material: Copper to BS EN 13602

Standards

BS EN 13602

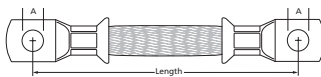

Part No.	Overall Braid Dimensions (mm)	Length (mm)	Hole Diameter (A) (mm)	Cross-sectional Area (mm ²)	Weight Each (kg)
Copper braid					
CBB-6-200-7	4.2	200	7	6	0.01
CBB-6-400-7	4.2	400	7	6	0.02
CBB-10-200-7	5.4	200	7	10	0.02
CBB-10-400-7	5.4	400	7	10	0.04
CBB-16-200-9	7	200	9	16	0.03
CBB-16-400-9	7	400	9	16	0.06
CBB-25-200-11	8.5	200	11	25	0.05
CBB-25-400-11	8.5	400	11	25	0.10
CBB-50-200-11	11.5	200	11	50	0.10
CBB-50-400-11	11.5	400	11	50	0.20
CBB-70-200-13	14.5	200	13	70	0.13
CBB-70-400-13	14.5	400	13	70	0.25
CBB-95-200-13	16	200	13	95	0.19
CBB-95-400-13	16	400	13	95	0.37
Tinned copper braid					
CBB-6-200-7-T	4.2	200	7	6	0.01
CBB-6-400-7-T	4.2	400	7	6	0.02
CBB-10-200-7-T	5.4	200	7	10	0.02
CBB-10-400-7-T	5.4	400	7	10	0.04
CBB-16-200-9-T	7	200	9	16	0.03
CBB-16-400-9-T	7	400	9	16	0.06
CBB-25-200-11-T	8.5	200	11	25	0.05
CBB-25-400-11-T	8.5	400	11	25	0.10
CBB-50-200-11-T	11.5	200	11	50	0.10
CBB-50-400-11-T	11.5	400	11	50	0.20
CBB-70-200-13-T	14.5	200	13	70	0.13
CBB-70-400-13-T	14.5	400	13	70	0.25
CBB-95-200-13-T	16	200	13	95	0.19
CBB-95-400-13-T	16	400	13	95	0.37

– Flexible copper or flexible tinned copper braid terminated with pressed ferrule connector at each end, suitable for bonding gates, doors, fences etc. Pressed ferrule connection ensures maximum electrical contact with minimum earth resistance
Standard braid sizes are shown. Braids are available in other sizes, lengths, materials or terminations to special order

Earth bonds & clamps

Static earth bonds



Eyebolt

Tested to: Copper alloy

Part No.	Nominal Copperbond Rod Diameter (")	Weight Each (kg)
BT150	5/8	0.52
BT160	3/4	0.52

– Screws direct onto a copperbond earth rod, offering an earth point for boats, trucks etc.

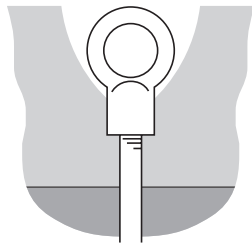

Standards

BS EN 7430

8



Static earth receptacle

Material: Copper alloy

Part No.	Conductor Material	Weight Each (kg)
RX005	Copper	0.64

– For setting into roadways or runways. Provides a static discharge point for aircraft, fuel tankers, etc.

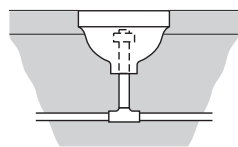

Standards

BS EN 7430

Earth bonds & clamps

Static earth clamps



Stainless steel earthing clamp

Material: Stainless steel clamp; insulated copper wire

Part No.	Description	Jaw Opening (mm)	Cable Length (max) (m)	Weight Each (kg)
SK010	Medium duty earthing clamp	15	3	0.56
SK020	Heavy duty earthing clamp	35	5	1.09

Clamp Certification Ex II 1 GD T6. Heavy duty earthing clamp FM Approved

- Medium duty stainless earthing clamp for earthing buckets, small drums, containers and plant equipment etc.
 - Heavy duty stainless earthing clamp for earthing 205 litre drums, IBCs, production vessels and road tankers etc.
- Clamp features twin tungsten carbide teeth for effective penetration of paint and contamination
Supplied complete with chemically resistant Cen-Stat Spiral Cable and 10 mm ring terminal

Standards



Ex II 1 GD T6

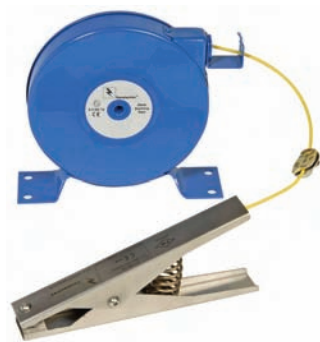

Stainless steel earthing clamp & reel

Material: Stainless steel clamp; insulated copper wire

Part No.	Description	Jaw Opening (mm)	Cable Length (max) (m)	Weight Each (kg)
SK030	Medium duty earthing clamp & reel	15	6.1	3
SK040	Heavy duty earthing clamp & reel	35	15.2	6

Clamp Certification Ex II 1 GD T6. Reel Certification Ex II 1 GD T6. Heavy duty earthing clamp FM Approved

- Medium duty stainless earthing clamp for earthing buckets, small drums, containers and plant equipment etc.
 - Heavy duty stainless earthing clamp for earthing 205 litre drums, IBC's, production vessels and road tankers
- Clamp features twin tungsten carbide teeth for effective penetration of paint and contamination. Supplied complete with retracting cable reel.

Standards



Ex II 1 GD T6

Earth bonds & clamps

Earth bars

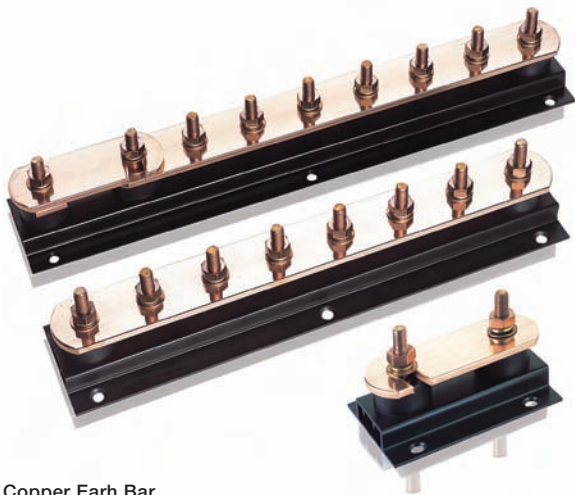

Copper Earth Bar



Tinned copper Earth Bar

Furse earth bars are an efficient and convenient way of providing a common earth point, and integral disconnecting links allow easy isolation for testing purposes.

8

Standard Furse earth bars are available in a variety of lengths, but all consist of a 50 mm wide by 6 mm thick copper bar with M10 termination screws - standard product codes are provided.

Standard features and benefits

- The plastic channel base is entirely corrosion proof - made from high impact uPVC unlike the traditional galvanized steel channel
- Lighter and easier to handle - the use of a modern polymer channel has reduced the weight of the products, making them easier to handle
- Pre-drilled fixing holes for ease of installation
- A range of four designs to meet most installation requirements

- Swan-Neck accessory, to facilitate the main earth bar connection
- Available as bare copper or tinned copper hard drawn bar

Special earth bar requirements

Standard earth bars meet the majority of applications, however where a customer has a specific requirement, we can design and manufacture special earth bars and disconnecting links as appropriate. Special earth bar designs are provided for customer review and approval as required before manufacture.

Special earth bar design variables include:

- Size and type of bolt, hex nut and washer
- Length, width and thickness of earth bar
- Number of disconnecting links, and their position
- Number of insulators
- Supplied with mounting base or without

An example of a customer special earth bar comprising M10 and M6 studs and disconnecting links

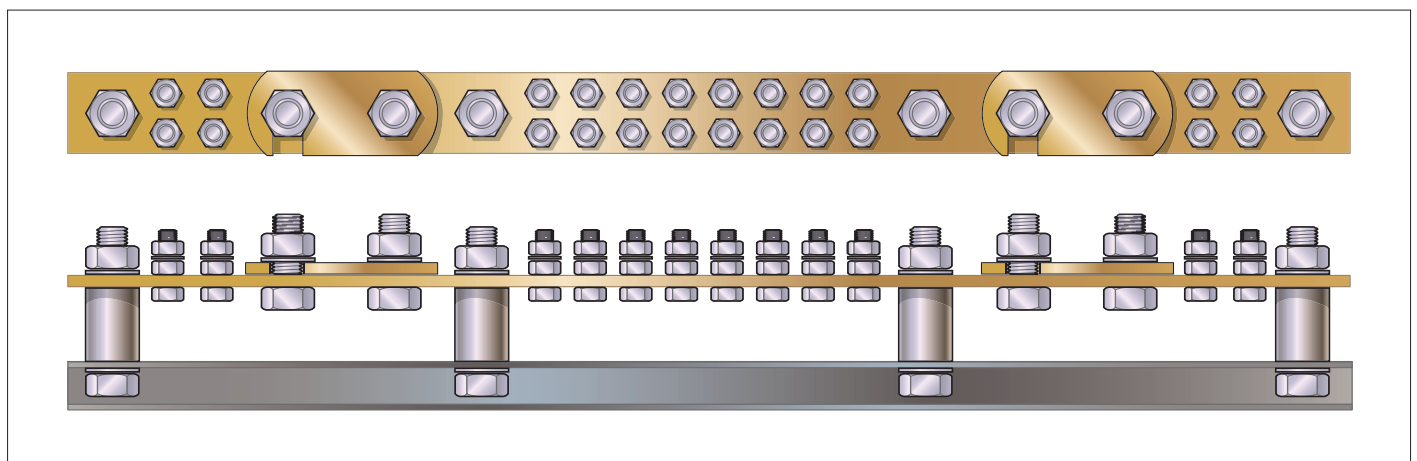

Earth bonds & clamps

Earth bars

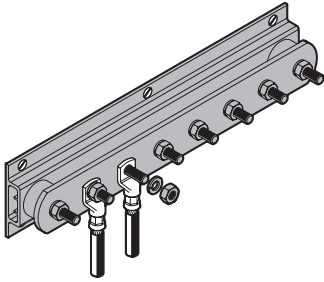

Earth bar

Material: Bare or tinned copper hard drawn bar; uPVC base

Standards

BS EN 7430

Part No.	Description	Length (mm)	Weight Each
Copper earth bar			
LK245-6	6 way	400	1.80
LK245-8	8 way	500	2.20
LK245-10	10 way	650	2.80
LK245-12	12 way	750	3.20
LK245-14	14 way	850	3.60
LK245-16	16 way	950	4.00
LK245-18	18 way	1050	4.40
LK245-20	20 way	1200	5.00
LK245-22	22 way	1300	5.40
LK245-24	24 way	1400	5.80
LK245-26	26 way	1500	6.20
LK245-28	28 way	1650	6.90
LK245-30	30 way	1750	7.30
Tinned copper earth bar			
LK245-6-T	6 way	400	1.80
LK245-8-T	8 way	500	2.20
LK245-10-T	10 way	650	2.80
LK245-12-T	12 way	750	3.20
LK245-14-T	14 way	850	3.60
LK245-16-T	16 way	950	4.00
LK245-18-T	18 way	1050	4.40
LK245-20-T	20 way	1200	5.00
LK245-22-T	22 way	1300	5.40
LK245-24-T	24 way	1400	5.80
LK245-26-T	26 way	1500	6.20
LK245-28-T	28 way	1650	6.90
LK245-30-T	30 way	1750	7.30

– Fix using countersunk wood screws 1½" No. 12 (Part no. SW110) and wall plugs (Part no. PS310)

Standard width x height: 90 mm x 90 mm

Earth bonds & clamps

Earth bars

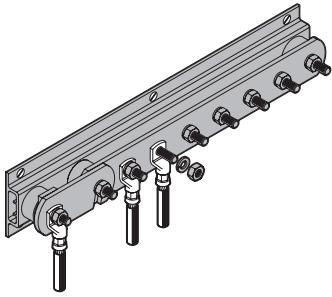

Earth bar with single disconnecting link

Material: Bare or tinned copper hard drawn bar; uPVC base

Part No.	Description	Length (mm)	Weight Each (kg)
Copper earth bar			
LK243-6	6 way	475	2.30
LK243-8	8 way	575	2.70
LK243-10	10 way	725	3.30
LK243-12	12 way	825	3.70
LK243-14	14 way	925	4.10
LK243-16	16 way	1025	4.50
LK243-18	18 way	1125	4.90
LK243-20	20 way	1275	5.50
LK243-22	22 way	1375	5.90
LK243-24	24 way	1475	6.30
LK243-26	26 way	1575	6.70
LK243-28	28 way	1725	7.40
LK243-30	30 way	1825	7.80
Tinned copper earth bar			
LK243-6-T	6 way	475	2.30
LK243-8-T	8 way	575	2.70
LK243-10-T	10 way	725	3.30
LK243-12-T	12 way	825	3.70
LK243-14-T	14 way	925	4.10
LK243-16-T	16 way	1025	4.50
LK243-18-T	18 way	1125	4.90
LK243-20-T	20 way	1275	5.50
LK243-22-T	22 way	1375	5.90
LK243-24-T	24 way	1475	6.30
LK243-26-T	26 way	1575	6.70
LK243-28-T	28 way	1725	7.40
LK243-30-T	30 way	1825	7.80

– Fix using countersunk wood screws 1½" No. 12 (Part no. SW110) and wall plugs (Part no. PS310)

Standard width x height: 90 mm x 96 mm

Standards

BS EN 7430

Earth bonds & clamps

Earth bars

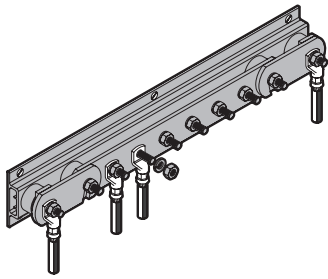

Earth bar with twin disconnecting link

Material: Bare or tinned copper hard drawn bar; uPVC base

Part No.	Description	Length (mm)	Weight Each (kg)
Copper earth bar			
LK207-6	6 way	550	2.80
LK207-8	8 way	650	3.20
LK207-10	10 way	800	3.80
LK207-12	12 way	900	4.20
LK207-14	14 way	1000	4.60
LK207-16	16 way	1100	5.00
LK207-18	18 way	1200	5.40
LK207-20	20 way	1350	6.00
LK207-22	22 way	1450	6.40
LK207-24	24 way	1550	6.80
LK207-26	26 way	1650	7.20
LK207-28	28 way	1800	7.90
LK207-30	30 way	1900	8.30
Tinned copper earth bar			
LK207-6-T	6 way	550	2.80
LK207-8-T	8 way	650	3.20
LK207-10-T	10 way	800	3.80
LK207-12-T	12 way	900	4.20
LK207-14-T	14 way	1000	4.60
LK207-16-T	16 way	1100	5.00
LK207-18-T	18 way	1200	5.40
LK207-20-T	20 way	1350	6.00
LK207-22-T	22 way	1450	6.40
LK207-24-T	24 way	1550	6.80
LK207-26-T	26 way	1650	7.20
LK207-28-T	28 way	1800	7.90
LK207-30-T	30 way	1900	8.30

Standards

BS EN 7430

– Fix using countersunk wood screws 1½" No. 12 (Part no. SW110) and wall plugs (Part no. PS310)

Standard width x height: 90 mm x 96 mm

Earth bonds & clamps

Accessories

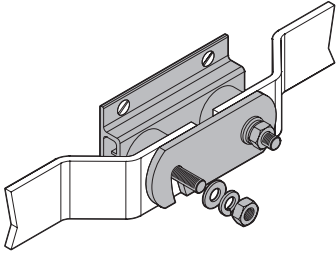

Earth bar accessories

Material: Bare or tinned copper hard drawn bar; uPVC base

Part No.	Description	Length (mm)	Width (mm)	Height	Weight Each (kg)
Copper earth bar					
LK004	Swan-neck link	400	50	36	0.42
LK205	Disconnecting link	125	90	90	0.59
Tinned copper earth bar					
LK004-T	Swan-neck link	400	50	36	0.42
LK205-T	Disconnecting link	125	90	90	0.59

– Fix using countersunk wood screws 1 1/2" No. 12 (Part no. SW110) and wall plugs (Part no. PS310)



Insulator

Material: GRP with brass insert; IN005 stainless steel studs & nuts

Part No.	Description (mm)	Length (mm)	Width (mm)	Height	Dimensions (mm)
Insulator					
IN020	20	14	18	M6	25 x 3
IN030	30	25	33	M6	25 x 6
IN040	40	31	39	M8	38 x 6
IN013	50	27	35	M10	50 x 6
IN060	60	38	52	M10	75 x 6
IN070	70	51	55	M12	100 x 6

Insulator with 2 studs and 3 nuts

IN005	50	27	35	M10	50 x 6
-------	----	----	----	-----	--------

Insulator manufactured from grey GRP material with brass insert

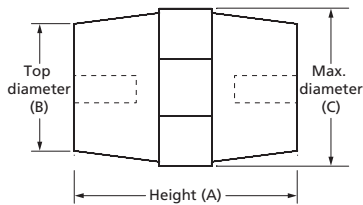
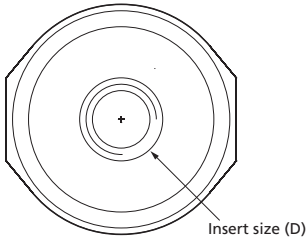

Earth bonds & clamps

Compression connectors

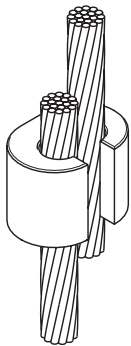

'C' shape connector

Material: Copper

Part No.	Conductor Range (Main) (mm ²)	Conductor Range (Tap) (mm ²)	Box Quantity	Weight Each (kg)
Copper 'C' shape connector				
CN1010	10	1.5-10	100	0.01
CN1616	16	1.5-16	100	0.02
CN2510	16-25	1.5-10	50	0.02
CN2525	25	16-25	50	0.02
CN3516	35	1.5-16	25	0.04
CN3535	35	25-35	25	0.04
CN5025	50	4-25	25	0.09
CN5050	50	35-50	25	0.09
CN7025	70	1.5-25	25	0.04
CN7035	50-70	4-35	25	0.10
CN7070	50-70	35-70	25	0.09
CN9535	95	4-35	25	0.15
CN9570	95	35-70	25	0.15
CN9595	95	70-95	25	0.14
CN120120	120	25-120	25	0.17
CN150120	150	25-120	25	0.16
CN150150	150	70-150	25	0.12
CN18595	185	16-95	25	0.13
CN185185	120-185	120-185	15	0.23
CN240120	150-240	95-120	15	0.24
CN240150	240-150	240-150	10	0.25
CN240185	240-185	240-185	10	0.25
CN240240	240-240	240-240	10	0.27
CN300120	300-120	300-120	10	0.30
CN300300	300-300	300-300	10	0.28

Manufactured from pure or copper. Ensure all underground connections are sealed/waterproofed using Denso Tape
Additional sizes available on request

Earth bonds & clamps

Compression connectors



'C' shape connector

Material: Tinned copper

Part No.	Conductor Range (Main) (mm ²)	Conductor Range (Tap) (mm ²)	Box Quantity	Weight Each (kg)
Tinned copper 'C' shape connector				
CN1010-T	10	1.5-10	100	0.01
CN1616-T	16	1.5-16	100	0.02
CN2510-T	16-25	1.5-10	50	0.02
CN2525-T	25	16-25	50	0.02
CN3516-T	35	1.5-16	25	0.04
CN3535-T	35	25-35	25	0.04
CN5025-T	50	4-25	25	0.09
CN5050-T	50	35-50	25	0.09
CN7025-T	70	1.5-25	25	0.04
CN7035-T	50-70	4-35	25	0.10
CN7070-T	50-70	35-70	25	0.09
CN9535-T	95	4-35	25	0.15
CN9570-T	95	35-70	25	0.15
CN9595-T	95	70-95	25	0.14
CN120120-T	120	25-120	25	0.17
CN150120-T	150	25-120	25	0.16
CN150150-T	150	70-150	25	0.12
CN18595-T	185	16-95	25	0.13
CN185185-T	120-185	120-185	15	0.23
CN240120-T	150-240	95-120	15	0.24
CN240150-T	240-150	240-150	10	0.25
CN240185-T	240-185	240-185	10	0.25
CN240240-T	240-240	240-240	10	0.27
CN300120-T	300-120	300-120	10	0.30
CN300300-T	300-300	300-300	10	0.28

Manufactured from pure or tinned copper. Ensure all underground connections are sealed/waterproofed using Denso Tape

Earth bonds & clamps

Cable lug

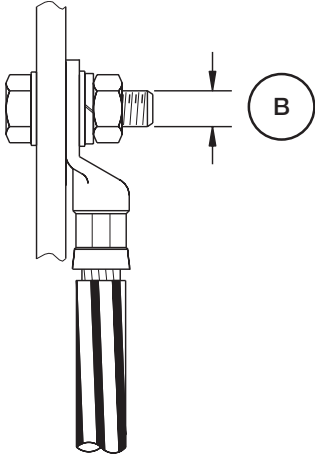

Tinned copper cable lug

Material: Tinned copper

Part No.	Conductor Size (mm ²)	Screw Size (B) (mm)	Weight Each (kg)
FCT166	16	6	0.01
FCT168	16	8	0.01
FCT1610	16	10	0.01
FCT1612	16	12	0.01
FCT256	25	6	0.01
FCT258	25	8	0.01
FCT2510	25	10	0.01
FCT2512	25	12	0.01
FCT356	35	6	0.01
FCT358	35	8	0.01
FCT3510	35	10	0.01
FCT3512	35	12	0.01
FCT506	50	6	0.02
FCT508	50	8	0.02
FCT5010	50	10	0.02
FCT5012	50	12	0.02
FCT708	70	8	0.04
FCT7010	70	10	0.04
FCT7012	70	12	0.04
FCT7014	70	14	0.04
FCT7016	70	16	0.04
FCT958	95	8	0.06
FCT9510	95	10	0.06
FCT9512	95	12	0.06
FCT9514	95	14	0.06
FCT9516	95	16	0.06
FCT12010	120	10	0.06
FCT12012	120	12	0.06
FCT12014	120	14	0.06
FCT12016	120	16	0.06
FCT15010	150	10	0.09
FCT15014	150	12	0.09
FCT15014	150	14	0.09
FCT15016	150	16	0.09
FCT18512	185	12	0.11
FCT18514	185	14	0.11
FCT18516	185	16	0.11
FCT24012	240	12	0.14
FCT24014	240	14	0.14
FCT24016	240	16	0.14
FCT30012	300	12	0.17
FCT30014	300	14	0.17
FCT30016	300	16	0.17
FCT40012	400	12	0.21
FCT40014	400	14	0.21
FCT40016	400	16	0.21

Standards

BS EN 12449
BS EN 1872
BS EN 4579

– Use with tool HT010

Earth bonds & clamps

Compression connector dies



'C' shape connector die

Material: Stainless steel

Part No.	Conductor Range (Main) (mm ²)	Conductor Range (Tap) (mm ²)	Weight Each (g)
HT010 and HT040 tooling			
HD100	10	1.5-10	0.26
HD200	16	1.5-16	0.26
HD200	16-25	1.5-10	0.26
HD200	25	16-25	0.26
HD300	35	1.5-16	0.28
HD300	35	25-35	0.28
HD300	70	1.5-25	0.28
HD400	50	4-25	0.27
HD400	50	35-50	0.27
HD400	50-70	4-35	0.27
HD400	50-70	35-70	0.27
HD500	95	4-35	0.27
HD500	95	35-70	0.27
HD500	95	70-95	0.27
HD600	120	25-120	0.27
HD600	150	25-120	0.27
HD600	150	70-150	0.27
HD600	185	16-95	0.27
HD800	240	95-120	0.28
HT020 and HT030 tooling			
HD700	120-185	120-185	0.22
HD700	150-240	95-120	0.22

Earth bonds & clamps

Mechanical clamps

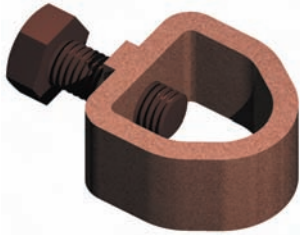

Rod to tape clamp (type A)

Material: Copper alloy

Part No.	Nominal Rod Diameter (")	(mm)	Max. Conductor (mm)	Weight Each (kg)
CR105*	1/2	12.7	26 x 12	0.15
CR105*	5/8	16	26 x 12	0.15
CR105*	3/4	20	26 x 10	0.15
CR108	5/8	16	30 x 2	0.16
CR108	3/4	20	30 x 2	0.16
CR110	5/8	16	40 x 12	0.24
CR115	5/8	16	51 x 8	0.30
CR125	3/4	20	51 x 12	0.30
CR130	1/2	12.7	26 x 20	0.23
CR130	5/8	16	26 x 18	0.23
CR130	3/4	20	26 x 10	0.23
CR130	1	25	26 x 10	0.23

Standards



UL467

BS EN 50164-1 Class H
BS EN 7430

– Designed for connection of flat tape conductor to an earth rod. Corrosion resistance, conductivity and mechanical strength are essential considerations in clamp design to ensure an earthing system remains operative for many years. All Furse earth rod clamps have high strength copper alloy bodies and screws e.g. aluminium bronze, phosphor bronze etc., commercial brass is not used

– Tightening torque 15 Nm

*UL467 (CR105)

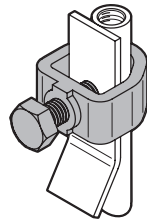

Rod to cable clamp (type G)

Material: Copper alloy

Part No.	Nominal Rod Diameter (")	(mm)	Max. Conductor (mm ²)	Weight Each (kg)
CR505	3/8	9.5	6-35	0.03
CR510-FU*	1/2	12.5	16-50	0.05
G5**	5/8	16	5.2-33.6	0.06
CR515*	5/8	16	16-70	0.06
G6**	3/4	20	5.2-33.6	0.06
CR520*	3/4	20	35-95	0.06
CR525	1	25	70-150	0.14

Standards



UL467

BS EN 50164-1 Class H
BS EN 7430

– High strength copper alloy clamp designed to provide a high quality, low resistance connection between solid circular or stranded conductor and an earth rod.

– Tightening torque 12 Nm

– *Suitable for use with 8 mm Ø solid circular copper conductor

**UL467 (G5 & G6)

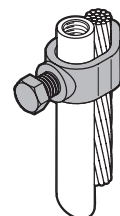

Earth bonds & clamps

Mechanical clamps



'U' bolt rod clamp (type E)

Material: Copper alloy

Part No.	Nominal Rod/ Rebar Diameter (")	(mm)	Hole Centres (mm)	Tape Width (mm)	Weight Each (kg)
CR305**	5/8	16	37	–	0.20
CR310	3/4	20	37	–	0.20
CR315	1	25	37	–	0.20
CR320*	5/8	16	37	25	0.26
CR325	1 1/2	38	54	–	0.37
CR330	2	50	64	–	0.44
CR326	TBC	TBC	TBC	–	TBC

Standards



UL467

BS EN 7430

– High strength copper alloy 'U' bolt clamp designed to provide a high quality, low resistance connection between flat tape or stranded conductor and earth rod or rebar. 'U' Bolt threaded M10

– *CR320 includes additional plate to allow tape to be clamped without drilling

**UL467 (CR305)

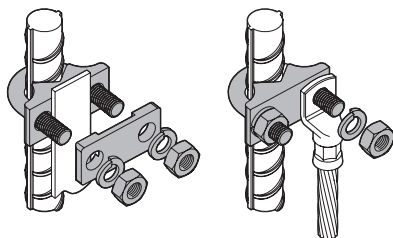

'U' bolt rod clamp (type GUV)

Material: Copper alloy

Part No.	Nominal Rod/ Rebar Diameter (")	(mm)	Conductor Range (mm ²)	Weight Each (kg)
CR700*†	5/8	16	16-95	0.39
CR700*†	3/4	20	16-70	0.39
CR705†	5/8	16	70-185	0.39
CR705†	3/4	20	70-150	0.39
CR730†	5/8	16	150-300	0.62
CR730†	3/4	20	150-300	0.62
CR710	1	25	16-70	0.39
CR740	1	25	70-150	0.39
CR750	1	25	150-300	0.62

Standards



UL467

BS EN 50164-1 Class H

BS EN 7430

– High strength copper alloy 'U' bolt clamp designed to provide a high quality, low resistance connection between solid circular or stranded conductor and an earth rod or rebar.

– Tightening torque 12 Nm

– * Suitable for use with 8 mm Ø solid circular copper conductor.

**UL467 (CR700, CR705, CR730)

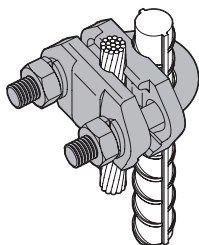

Earth bonds & clamps

Mechanical clamps



Rod to tape clamp (type A)

Material: Copper alloy

Part No.	Nominal Rod Diameter		Rod Type	Bolt Size	Weight Each (kg)
	(")	(mm)			
CR205	3/8	9.5	Copperbond	M8	0.09
CR215	5/8	16	Copperbond	M10	0.30
CR220	5/8	15	Solid copper	M10	0.30
CR225	3/4	20	Copperbond	M10	0.30
CR230	3/4	20	Solid copper	M10	0.30

– High strength copper alloy cable lug clamp designed to provide a high quality, low resistance connection between stranded conductor and earth rod

Standards

BS EN 7430

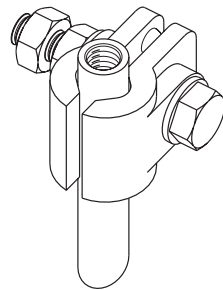

8



Rebar clamp

Material: Copper alloy

Part No.	Conductor Diameter (mm)	Rebar Diameter (mm)	Conductor Material	Weight Each (kg)
BN150	8	8-18	Copper	0.32
BN155	8	18-38	Copper	0.75

– High strength copper alloy rebar clamp for bonding to reinforcing bars, steam pipes, handrails etc.
 – Tightening torque 15 Nm (BN155 - M10); 5 Nm (BN155 - M6)

Standards

BS EN 7430

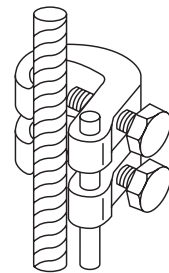

Earth bonds & clamps

Rebar clips



Rebar to rebar connecting clip

Material: Stainless steel 316

Part No.	Maximum Rebar Diameter (A) (mm)	Maximum Rebar Diameter (B) (mm)	Weight Each (kg)
RR812	8	12	0.05
RR1616	16	16	0.05
RR2121	20	20	0.06
RR2626	25	25	0.07
RR3232	32	32	0.07
RR3838	40	40	0.08

Standards

BS EN 50164-1 Class H

- Manufactured from high quality stainless steel for excellent corrosion resistance. Simple to install, providing a secure connection between internal reinforcing bars
- Tightening torque 12 Nm

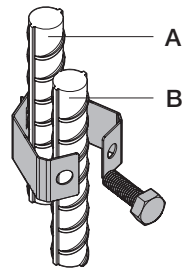

Rebar to conductor connecting clip

Material: Stainless steel 316

Part No.	Rebar Diameter (mm)	Conductor Size	Weight Each (kg)
Rebar to flat tape			
RC25-087095	25	25 x 3 mm	0.07
Rebar to stranded/solid circular conductor			
RC812-0850	12	50 mm ² or 8 mm dia.	0.05
RC16-087095	16	8 mm dia., 50-70-95 mm ²	0.06
RC20-087095	20	8 mm dia., 50-70-95 mm ²	0.07
RC25-087095	25	8 mm dia., 50-70-95 mm ²	0.07
RC32-087095	32	8 mm dia., 50-70-95 mm ²	0.07
RC40-087095	40	8 mm dia., 50-70-95 mm ²	0.08

Standards

BS EN 50164-1 Class H

- Manufactured from high quality stainless steel for excellent corrosion resistance. Simple to install, providing a secure connection between internal reinforcing bars and flat tape, solid circular or stranded conductor
- Tightening torque 12 Nm

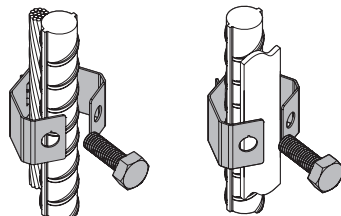

Earth bonds & clamps

Earth points

Earth points

Furse earth points are available for direct connection to conductors, or with additional pre-welded tail (single or double 70 mm² PVC insulated cable) to enable connection to internal rebar arrangements via mechanical clamps (see product tables for individual product availability).

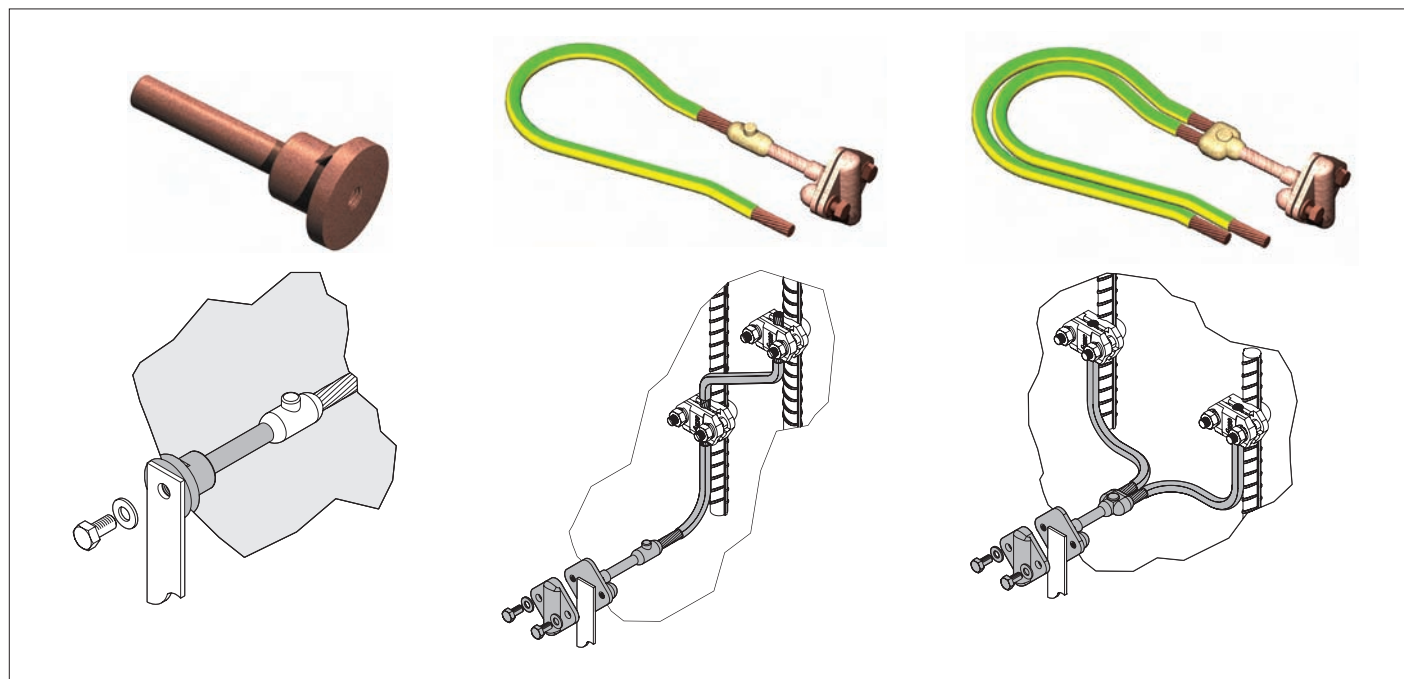

8



Single hole earth point

Part No.	Hole Size (mm)	Length (mm)	Weight Each (kg)
PC100-FU	M8 x 15	80	0.14
PC101	M10 x 15	80	0.14
PC102	M12 x 15	80	0.14
PC103	M16 x 15	80	0.14

Approvals



UL96

BS EN 50164-1 Class H
BS EN 7430

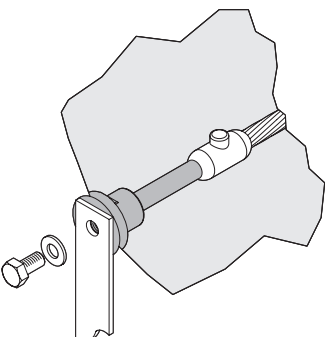

Part No.	Description (mm)	Weight each (kg)
Single hole earth point with single pre-welded tail		
PC105*	PC100-FU earth point with pre-welded 500 earth cable	0.56
PC106*	PC101 earth point with pre-welded 500 earth cable	0.56
PC107*	PC102 earth point with pre-welded 500 earth cable	0.56
PC108*	PC103 earth point with pre-welded 500 earth cable	0.56

Stem diameter = 10.7 mm (70 mm²)

Tightening torque 8 Nm

*UL96 (PC105, PC106, PC107, PC108)

Earth bonds & clamps

Earth points

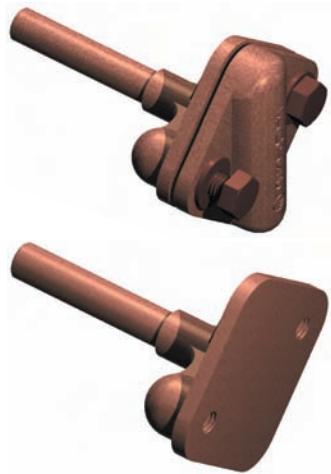

Two hole earth point

Tested to: BS 7430

Part No.	Description	Hole Size (mm)	Length (mm)	Weight Each (kg)
PC115-FU	Supplied c/w front plate for connection of 25 mm x 3 mm copper tape or 70 mm ² stranded copper cable	M8 x 12	80	0.44
PC120	Supplied c/w front plate for connection of 25 mm x 3 mm copper tape or 8 mm diameter solid circular copper	M8 x 12	80	0.44
PC125	Supplied without front plate	M8 x 12	80	0.28

Two hole earth point with single pre-welded tail

PC116*	PC115-FU earth point with pre-welded 500 mm earth cable			0.84
PC121*	PC120 earth point with pre-welded 500 mm earth cable			0.84
PC126-FU*	PC125 earth point with pre-welded 500 mm earth cable			0.84

Two hole earth point with double pre-welded tail

PC216*	PC115-FU earth point with pre-welded 2 x 500 mm earth cable			1.26
PC221	PC120 earth point with pre-welded 2 x 500 mm earth cable			1.26

Stem diameter = 10.7 mm (70 mm²)

Tightening torque 8 Nm

*UL96 (PC116, PC121, PC126-FU, PC216)

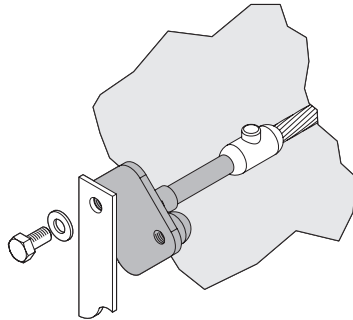

Approvals



UL96

BS EN 50164-1 Class H
BS EN 7430

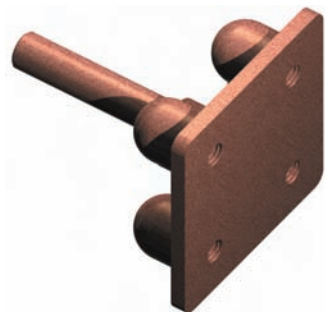

Rebar to conductor connecting clip

Tested to: BS 7430

Part No.	Description	Hole Size (mm)	Length (mm)	Weight Each (kg)
PC110		M8 x 14	75	0.41

Four hole earth point with single pre-welded tail

PC111*	PC110 earth point with pre-welded 500 mm earth cable			1.14
--------	--	--	--	------

Four hole earth point with double pre-welded tail

PC211*	PC110 earth point with pre-welded 2 x 500 mm earth cable			1.23
--------	--	--	--	------

Stem diameter = 10.7 mm (70 mm²)

Tightening torque 12 Nm

*UL96 (PC111, PC211)

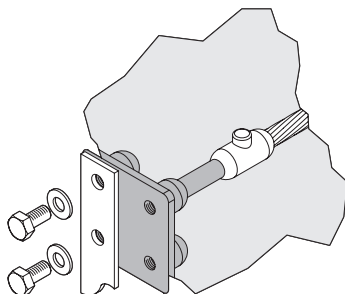

Approvals



UL96

BS EN 50164-1 Class H
BS EN 7430

Earth bonds & clamps

Splitbolt connector



Type H high strength splitbolt connector

Material: Copper alloy

Part No.	Conductor Range				Dimension (B) (mm)	Weight Each (kg)
	Main Min (mm ²)	Main Max (mm ²)	Tap Min (mm ²)	Tap Max (mm ²)		
8H-FU	4	10	2.5	10	4.1	0.02
4H-FU	10	16	2.5	16	5.5	0.03
2H-FU	16	25	4	25	6.9	0.04
1H-FU	25	35	4	35	8.4	0.06
10H-FU	35	50	4	50	9.7	0.09
20H-FU	35	70	4	70	11.2	0.14
30H-FU	50	95	4	95	13.6	0.17
40H-FU	50	120	6	120	14.7	0.18
350M-FU	95	185	6	185	18.2	0.35

– For copper to copper connections. No special tools required

Standards

BS EN 7430

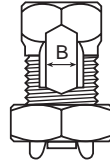
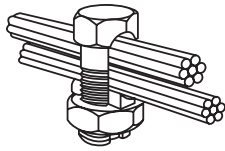

Earth bonds & clamps

Earth bosses

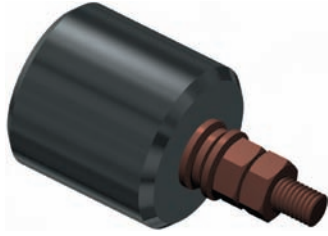

Earth boss

Material: Mild or stainless steel boss

Part No.	Length (mm)	Diameter (mm)	Thread Size	Material	Weight Each (kg)
EB0000	25	25	M8	Mild steel	0.11
EB1000	25	25	M8	Stainless steel	0.11
EB0110	30	30	M8	Mild steel	0.18
EB1110	30	30	M8	Stainless steel	0.18
EB0111	30	30	M10	Mild steel	0.20
EB1111	30	30	M10	Stainless steel	0.20
EB0120	30	40	M8	Mild steel	0.24
EB1120	30	40	M8	Stainless steel	0.24
EB0121	30	40	M10	Mild steel	0.26
EB1121	30	40	M10	Stainless steel	0.26
EB0130	30	50	M8	Mild steel	0.29
EB1130	30	50	M8	Stainless steel	0.29
EB0131	30	50	M10	Mild steel	0.31
EB1131	30	50	M10	Stainless steel	0.31
EB0211	40	30	M10	Mild steel	0.33
EB1211	40	30	M10	Stainless steel	0.33
EB0212	40	30	M12	Mild steel	0.36
EB1212	40	30	M12	Stainless steel	0.36
EB0221	40	40	M10	Mild steel	0.43
EB1221	40	40	M10	Stainless steel	0.43
EB0222	40	40	M12	Mild steel	0.45
EB1222	40	40	M12	Stainless steel	0.45
EB0231	40	50	M10	Mild steel	0.53
EB1231	40	50	M10	Stainless steel	0.53
EB0232	40	50	M12	Mild steel	0.55
EB1232	40	50	M12	Stainless steel	0.55
EB0311	50	30	M10	Mild steel	0.50
EB1311	50	30	M10	Stainless steel	0.50
EB0312	50	30	M12	Mild steel	0.52
EB1312	50	30	M12	Stainless steel	0.52
EB0321	50	40	M10	Mild steel	0.65
EB1321	50	40	M10	Stainless steel	0.65
EB0322	50	40	M12	Mild steel	0.67
EB1322	50	40	M12	Stainless steel	0.67
EB0001	50	50	M10	Mild steel	0.80
EB1331	50	50	M10	Stainless steel	0.80
EB0332	50	50	M12	Mild steel	0.80
EB1332	50	50	M12	Stainless steel	0.80

Standards

BS EN 7430

Continuous
5mm Fillet Weld

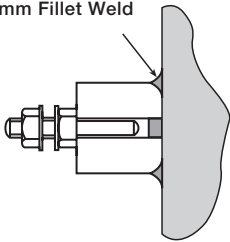

– Earth boss manufactured from mild steel (to 970 230M07 grade EN1A) or stainless steel (grade 316L) complete with stainless steel studs, nuts and washers - grade 316L. For welding to steel vessels, tanks, structures etc. Wrap connections with Denso tape

Earth bonds & clamps

Bonds & clamps

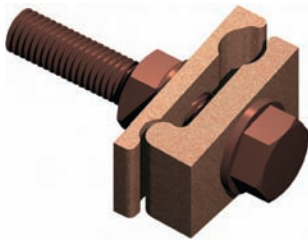

Tower earth clamp

Material: Copper or aluminium alloy

Part No.	Conductor Range (mm ²)	Channel Thickness (mm)	Bolt Size	Conductor Material	Weight Each (kg)
BN125*	16-70	10	M10	Copper	0.13
BN130	70-120	10	M12	Copper	0.22
BN300-FU*	25-50	10	M10	Copper	0.08
BN305*	25-50	10	M10	Aluminium	0.05
BN320	120-185	10	M12	Copper	0.30
BN325	185-240	10	M12	Copper	0.40

- For bonding copper cable or wire to steel structures.
- Tightening torque 12 Nm
- * Suitable for use with 8 mm Ø solid circular conductor

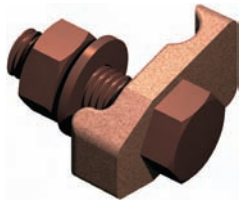

Standards

BS EN 50164-1 Class H
BS EN 7430

8

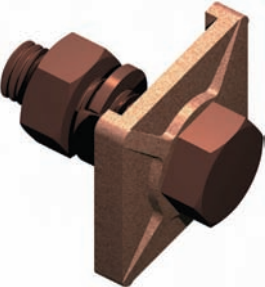

B bond

Material: Copper or aluminium alloy

Part No.	Maximum Tape With (mm)	Bolt Size	Max. Conductor	Weight Each (kg)
BN105	26 mm	M10	Copper	0.12
BN005	26 mm	M10	Aluminium	0.06
BN113	31 mm	M10	Copper	0.15

- For bonding tape to steel structures
- Tightening torque 17 Nm

Standards

BS EN 50164-1 Class H
BS EN 7430

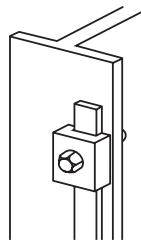

Earth bonds & clamps

Bonds & clamps

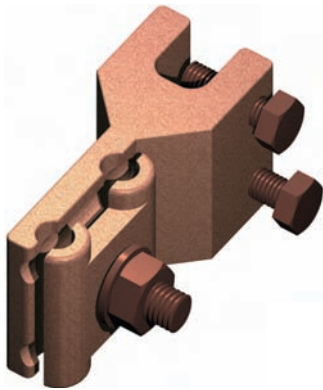

Metalwork bond

Material: Copper or aluminium alloy

Part No.	Conductor Diameter (mm)	Conductor Material	Weight Each (kg)
CS350	8 mm	Copper	0.37
CS355	8 mm	Aluminium	0.17

- For connecting to all types of metal structures up to 13 mm thickness
- Tightening torque - M8 bolt: 10 Nm, M10 bolt: 12 Nm

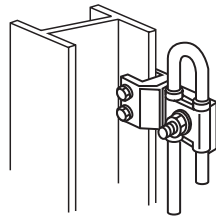

Standards

BS EN 50164-1 Class H
BS EN 7430

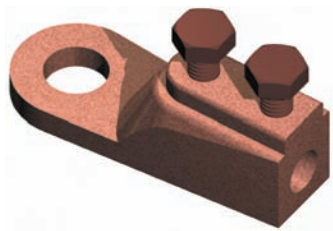

Straight setscrew cable socket

Material: Copper or aluminium alloy

Part No.	Conductor Diameter (mm)	Palm Hole Diameter (mm)	Conductor Material	Weight Each (kg)
SX450	8	12	Copper	0.11
SX455	8	12	Aluminium	0.05

- For bonding copper and aluminium conductors to steelwork
- Tightening torque 3 Nm

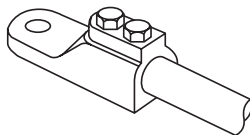

Standards

BS EN 50164-1 Class H

Earth bonds & clamps

Bonds & clamps

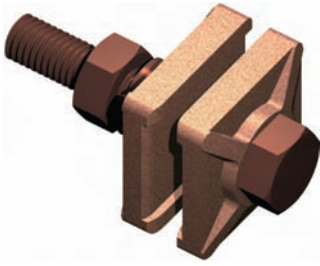

RWP bond

Material: Copper or aluminium alloy

Part No.	Maximum Tape Width (mm)	Bolt Size	Conductor Material	Weight Each (kg)
BN115	26	M10	Copper	0.12
BN010	26	M10	Aluminium	0.07g

– For bonding tape to rainwater pipes, handrails etc.

Standards

BS EN 7430

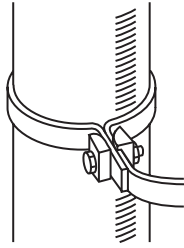

8

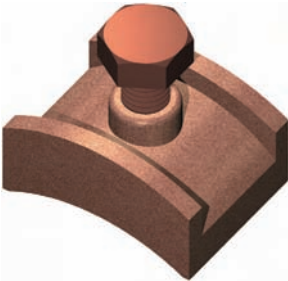

Watermain bond

Material: Copper alloy

Part No.	Maximum Tape Width (mm)	Conductor Material	Weight Each (kg)
BN120	26	Copper	0.26

– For bonding tape to large diameter pipes

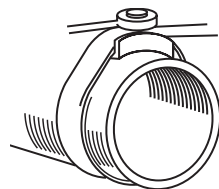

Standards

BS EN 7430

Earth bonds & clamps

Pipe bonds & clamps



Pipe bond

Material: Copper or Aluminium alloy

Part No.	Conductor Diameter (mm)	Pipe Diameter (mm)	Conductor Material	Weight Each (kg)
BN175	8	50-200	Copper	0.46
BN176	8	50-200	Aluminium	0.25

- For bonding to ducts and large diameter pipeworks. Additional lengths available to order
- Tightening torque - M6 bolt: 6 Nm, M10 bolt: 12 Nm
- Manufactured to BS 7430

Standards

BS EN 50164-1 Class H
BS EN 7430

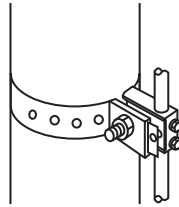

Pipe clamp

Material: Copper alloy clamp with zinc plated U-bolt

Part No.	Pipe Diameter (")	Pipe Diameter (mm)	Conductor Range (mm ²)	Weight Each (kg)
3902	1/2-1	13-25	25-95	0.3
3903	1 1/4-2	32-50	25-95	0.4
3904	2 1/2-3 1/2	65-90	25-95	0.5
3905-TB	4-5	100-125	25-95	0.6
3906-TB	6	150	25-95	0.8
3907	8	200	25-95	1.0
3908	10	250	25-95	1.1
3909-TB	12	300	25-95	1.5

Standards



UL467

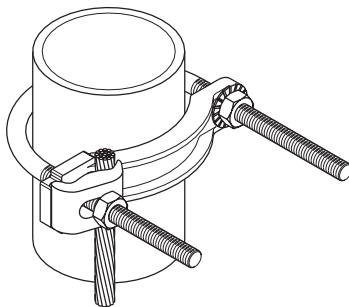

Earth bonds & clamps

Flexible braid bonds



Flexible flat copper braid bond

Material: Copper to BS EN 13602

Part No.	Overall Braid Dimensions (mm)	Length (mm)	Hole Diameter (A) (mm)	Cross-sectional Area (mm ²)	Weight Each (kg)
Copper braid					
FBB-6-200-7	12 x 1	200	7	6	0.01
FBB-6-400-7	12 x 1	400	7	6	0.02
FBB-10-200-7	15 x 1.5	200	7	10	0.02
FBB-10-400-7	15 x 1.5	400	7	10	0.04
FBB-16-200-9	19 x 2.5	200	9	16	0.03
FBB-16-400-9	19 x 2.5	400	9	16	0.06
FBB-25-200-11	25 x 3	200	11	25	0.05
FBB-25-400-11	25 x 3	400	11	25	0.10
BN505	25 x 3.5	200	11	35	0.09
BN515	25 x 3.5	400	11	35	0.15
FBB-50-200-11	30 x 5	200	11	50	0.10
FBB-50-400-11	30 x 5	400	11	50	0.20
FBB-70-200-13	32 x 6	200	13	70	0.13
FBB-70-400-13	32 x 6	400	13	70	0.25
FBB-95-200-13	37 x 6	200	13	95	0.19
FBB-95-400-13	37 x 6	400	13	95	0.37
FBB-120-200-17	45 x 6	200	17	120	0.23
FBB-120-400-17	45 x 6	400	17	120	0.46
FBB-150-200-17	50 x 8	200	17	150	0.30
FBB-150-400-17	50 x 8	400	17	150	0.60
Tinned copper braid					
FBB-6-200-7-T	12 x 1	200	7	6	0.01
FBB-6-400-7-T	12 x 1	400	7	6	0.02
FBB-10-200-7-T	15 x 1.5	200	7	10	0.02
FBB-10-400-7-T	15 x 1.5	400	7	10	0.04
FBB-16-200-9-T	19 x 2.5	200	9	16	0.03
FBB-16-400-9-T	19 x 2.5	400	9	16	0.06
FBB-25-200-11-T	25 x 3	200	11	25	0.05
FBB-25-400-11-T	25 x 3	400	11	25	0.10
BN505-T	25 x 3.5	200	11	35	0.09
BN515-T	25 x 3.5	400	11	35	0.15
FBB-50-200-11-T	30 x 5	200	11	50	0.10
FBB-50-400-11-T	30 x 5	400	11	50	0.20
FBB-70-200-13-T	32 x 6	200	13	70	0.13
FBB-70-400-13-T	32 x 6	400	13	70	0.25
FBB-95-200-13-T	37 x 6	200	13	95	0.19
FBB-95-400-13-T	37 x 6	400	13	95	0.37
FBB-120-200-17-T	45 x 6	200	17	120	0.23
FBB-120-400-17-T	45 x 6	400	17	120	0.46
FBB-150-200-17-T	50 x 8	200	17	150	0.30
FBB-150-400-17-T	50 x 8	400	17	150	0.60

Standards

BS EN 13602

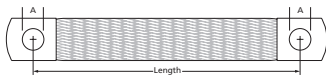

– Flexible copper or flexible tinned copper braid terminated with pressed ferrule connector at each end, suitable for bonding gates, doors, fences etc. Pressed ferrule connection ensures maximum electrical contact with minimum earth resistance
Standard braid sizes are shown. Braids are available in other sizes, lengths, materials or terminations to special order

Earth bonds & clamps

Flexible braid bonds



Flexible circular copper braid bond

Material: Copper to BS EN 13602

Standards

BS EN 13602

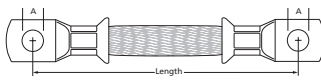

Part No.	Overall Braid Dimensions (mm)	Length (mm)	Hole Diameter (A) (mm)	Cross-sectional Area (mm ²)	Weight Each (kg)
Copper braid					
CBB-6-200-7	4.2	200	7	6	0.01
CBB-6-400-7	4.2	400	7	6	0.02
CBB-10-200-7	5.4	200	7	10	0.02
CBB-10-400-7	5.4	400	7	10	0.04
CBB-16-200-9	7	200	9	16	0.03
CBB-16-400-9	7	400	9	16	0.06
CBB-25-200-11	8.5	200	11	25	0.05
CBB-25-400-11	8.5	400	11	25	0.10
CBB-50-200-11	11.5	200	11	50	0.10
CBB-50-400-11	11.5	400	11	50	0.20
CBB-70-200-13	14.5	200	13	70	0.13
CBB-70-400-13	14.5	400	13	70	0.25
CBB-95-200-13	16	200	13	95	0.19
CBB-95-400-13	16	400	13	95	0.37
Tinned copper braid					
CBB-6-200-7-T	4.2	200	7	6	0.01
CBB-6-400-7-T	4.2	400	7	6	0.02
CBB-10-200-7-T	5.4	200	7	10	0.02
CBB-10-400-7-T	5.4	400	7	10	0.04
CBB-16-200-9-T	7	200	9	16	0.03
CBB-16-400-9-T	7	400	9	16	0.06
CBB-25-200-11-T	8.5	200	11	25	0.05
CBB-25-400-11-T	8.5	400	11	25	0.10
CBB-50-200-11-T	11.5	200	11	50	0.10
CBB-50-400-11-T	11.5	400	11	50	0.20
CBB-70-200-13-T	14.5	200	13	70	0.13
CBB-70-400-13-T	14.5	400	13	70	0.25
CBB-95-200-13-T	16	200	13	95	0.19
CBB-95-400-13-T	16	400	13	95	0.37

– Flexible copper or flexible tinned copper braid terminated with pressed ferrule connector at each end, suitable for bonding gates, doors, fences etc. Pressed ferrule connection ensures maximum electrical contact with minimum earth resistance
Standard braid sizes are shown. Braids are available in other sizes, lengths, materials or terminations to special order

Earth bonds & clamps

Static earth bonds



Eyebolt

Tested to: Copper alloy

Part No.	Nominal Copperbond Rod Diameter (")	Weight Each (kg)
BT150	5/8	0.52
BT160	3/4	0.52

– Screws direct onto a copperbond earth rod, offering an earth point for boats, trucks etc.

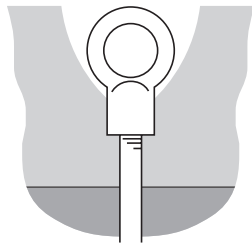

Standards

BS EN 7430

8



Static earth receptacle

Material: Copper alloy

Part No.	Conductor Material	Weight Each (kg)
RX005	Copper	0.64

– For setting into roadways or runways. Provides a static discharge point for aircraft, fuel tankers, etc.

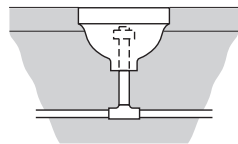

Standards

BS EN 7430

Earth bonds & clamps

Static earth clamps



Stainless steel earthing clamp

Material: Stainless steel clamp; insulated copper wire

Part No.	Description	Jaw Opening (mm)	Cable Length (max) (m)	Weight Each (kg)
SK010	Medium duty earthing clamp	15	3	0.56
SK020	Heavy duty earthing clamp	35	5	1.09

Clamp Certification Ex II 1 GD T6. Heavy duty earthing clamp FM Approved

- Medium duty stainless earthing clamp for earthing buckets, small drums, containers and plant equipment etc.
 - Heavy duty stainless earthing clamp for earthing 205 litre drums, IBCs, production vessels and road tankers etc.
- Clamp features twin tungsten carbide teeth for effective penetration of paint and contamination
Supplied complete with chemically resistant Cen-Stat Spiral Cable and 10 mm ring terminal

Standards



Ex II 1 GD T6

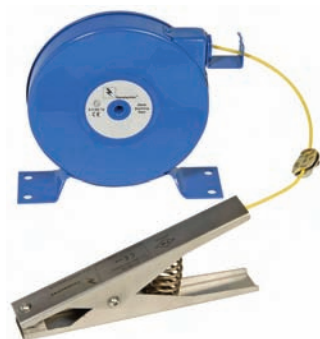

Stainless steel earthing clamp & reel

Material: Stainless steel clamp; insulated copper wire

Part No.	Description	Jaw Opening (mm)	Cable Length (max) (m)	Weight Each (kg)
SK030	Medium duty earthing clamp & reel	15	6.1	3
SK040	Heavy duty earthing clamp & reel	35	15.2	6

Clamp Certification Ex II 1 GD T6. Reel Certification Ex II 1 GD T6. Heavy duty earthing clamp FM Approved

- Medium duty stainless earthing clamp for earthing buckets, small drums, containers and plant equipment etc.
 - Heavy duty stainless earthing clamp for earthing 205 litre drums, IBC's, production vessels and road tankers
- Clamp features twin tungsten carbide teeth for effective penetration of paint and contamination. Supplied complete with retracting cable reel.

Standards



Ex II 1 GD T6

Earth bonds & clamps

Earth bars

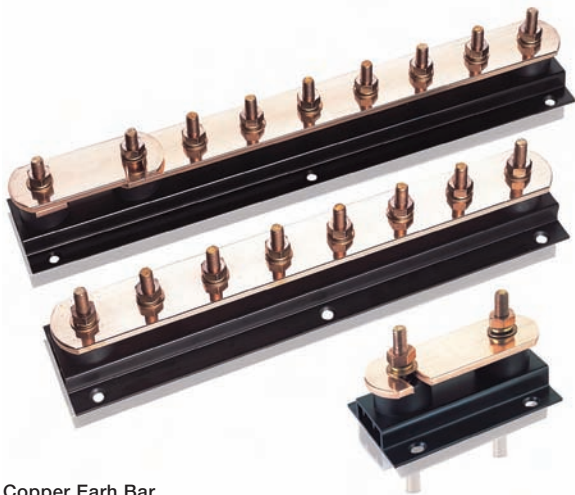

Copper Earth Bar



Tinned copper Earth Bar

Furse earth bars are an efficient and convenient way of providing a common earth point, and integral disconnecting links allow easy isolation for testing purposes.

8

Standard Furse earth bars are available in a variety of lengths, but all consist of a 50 mm wide by 6 mm thick copper bar with M10 termination screws - standard product codes are provided.

Standard features and benefits

- The plastic channel base is entirely corrosion proof - made from high impact uPVC unlike the traditional galvanized steel channel
- Lighter and easier to handle - the use of a modern polymer channel has reduced the weight of the products, making them easier to handle
- Pre-drilled fixing holes for ease of installation
- A range of four designs to meet most installation requirements

- Swan-Neck accessory, to facilitate the main earth bar connection
- Available as bare copper or tinned copper hard drawn bar

Special earth bar requirements

Standard earth bars meet the majority of applications, however where a customer has a specific requirement, we can design and manufacture special earth bars and disconnecting links as appropriate. Special earth bar designs are provided for customer review and approval as required before manufacture.

Special earth bar design variables include:

- Size and type of bolt, hex nut and washer
- Length, width and thickness of earth bar
- Number of disconnecting links, and their position
- Number of insulators
- Supplied with mounting base or without

An example of a customer special earth bar comprising M10 and M6 studs and disconnecting links

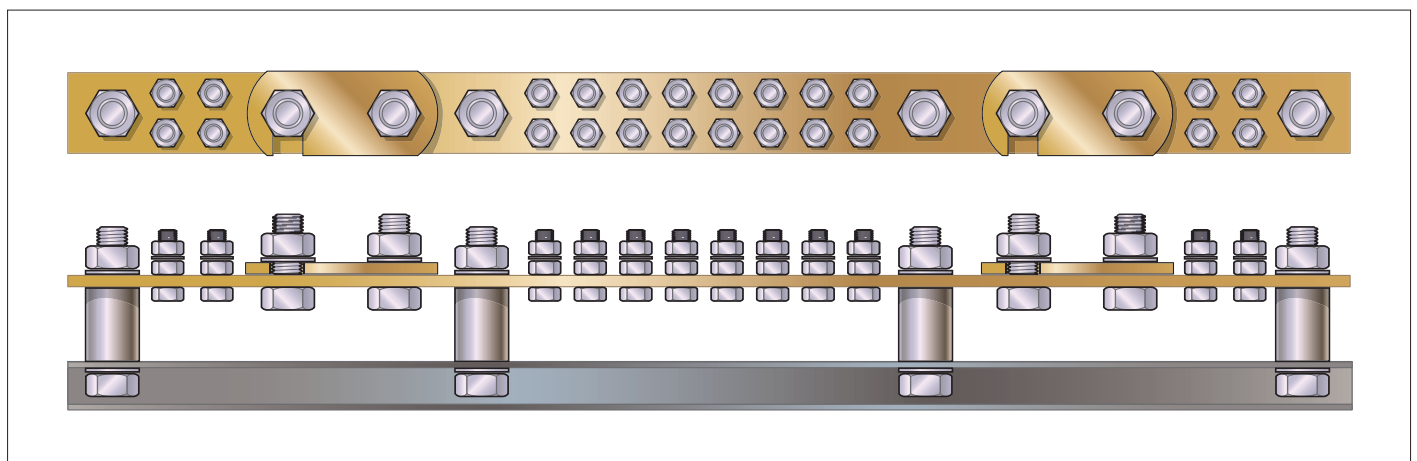

Earth bonds & clamps

Earth bars

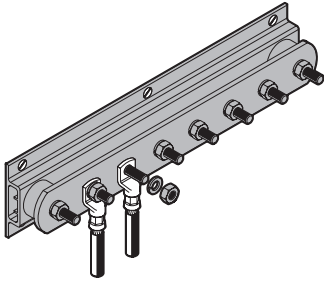

Earth bar

Material: Bare or tinned copper hard drawn bar; uPVC base

Standards

BS EN 7430

Part No.	Description	Length (mm)	Weight Each
Copper earth bar			
LK245-6	6 way	400	1.80
LK245-8	8 way	500	2.20
LK245-10	10 way	650	2.80
LK245-12	12 way	750	3.20
LK245-14	14 way	850	3.60
LK245-16	16 way	950	4.00
LK245-18	18 way	1050	4.40
LK245-20	20 way	1200	5.00
LK245-22	22 way	1300	5.40
LK245-24	24 way	1400	5.80
LK245-26	26 way	1500	6.20
LK245-28	28 way	1650	6.90
LK245-30	30 way	1750	7.30
Tinned copper earth bar			
LK245-6-T	6 way	400	1.80
LK245-8-T	8 way	500	2.20
LK245-10-T	10 way	650	2.80
LK245-12-T	12 way	750	3.20
LK245-14-T	14 way	850	3.60
LK245-16-T	16 way	950	4.00
LK245-18-T	18 way	1050	4.40
LK245-20-T	20 way	1200	5.00
LK245-22-T	22 way	1300	5.40
LK245-24-T	24 way	1400	5.80
LK245-26-T	26 way	1500	6.20
LK245-28-T	28 way	1650	6.90
LK245-30-T	30 way	1750	7.30

– Fix using countersunk wood screws 1½" No. 12 (Part no. SW110) and wall plugs (Part no. PS310)

Standard width x height: 90 mm x 90 mm

Earth bonds & clamps

Earth bars

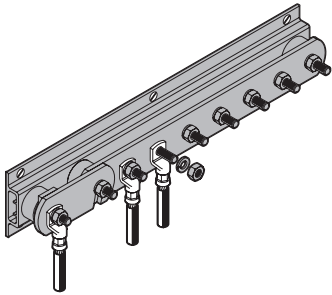

Earth bar with single disconnecting link

Material: Bare or tinned copper hard drawn bar; uPVC base

Part No.	Description	Length (mm)	Weight Each (kg)
Copper earth bar			
LK243-6	6 way	475	2.30
LK243-8	8 way	575	2.70
LK243-10	10 way	725	3.30
LK243-12	12 way	825	3.70
LK243-14	14 way	925	4.10
LK243-16	16 way	1025	4.50
LK243-18	18 way	1125	4.90
LK243-20	20 way	1275	5.50
LK243-22	22 way	1375	5.90
LK243-24	24 way	1475	6.30
LK243-26	26 way	1575	6.70
LK243-28	28 way	1725	7.40
LK243-30	30 way	1825	7.80
Tinned copper earth bar			
LK243-6-T	6 way	475	2.30
LK243-8-T	8 way	575	2.70
LK243-10-T	10 way	725	3.30
LK243-12-T	12 way	825	3.70
LK243-14-T	14 way	925	4.10
LK243-16-T	16 way	1025	4.50
LK243-18-T	18 way	1125	4.90
LK243-20-T	20 way	1275	5.50
LK243-22-T	22 way	1375	5.90
LK243-24-T	24 way	1475	6.30
LK243-26-T	26 way	1575	6.70
LK243-28-T	28 way	1725	7.40
LK243-30-T	30 way	1825	7.80

– Fix using countersunk wood screws 1½" No. 12 (Part no. SW110) and wall plugs (Part no. PS310)

Standard width x height: 90 mm x 96 mm

Standards

BS EN 7430

Earth bonds & clamps

Earth bars

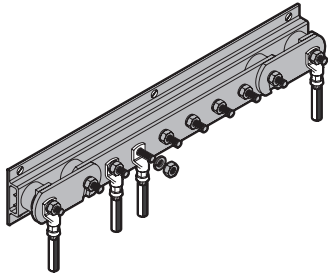

Earth bar with twin disconnecting link

Material: Bare or tinned copper hard drawn bar; uPVC base

Part No.	Description	Length (mm)	Weight Each (kg)
Copper earth bar			
LK207-6	6 way	550	2.80
LK207-8	8 way	650	3.20
LK207-10	10 way	800	3.80
LK207-12	12 way	900	4.20
LK207-14	14 way	1000	4.60
LK207-16	16 way	1100	5.00
LK207-18	18 way	1200	5.40
LK207-20	20 way	1350	6.00
LK207-22	22 way	1450	6.40
LK207-24	24 way	1550	6.80
LK207-26	26 way	1650	7.20
LK207-28	28 way	1800	7.90
LK207-30	30 way	1900	8.30
Tinned copper earth bar			
LK207-6-T	6 way	550	2.80
LK207-8-T	8 way	650	3.20
LK207-10-T	10 way	800	3.80
LK207-12-T	12 way	900	4.20
LK207-14-T	14 way	1000	4.60
LK207-16-T	16 way	1100	5.00
LK207-18-T	18 way	1200	5.40
LK207-20-T	20 way	1350	6.00
LK207-22-T	22 way	1450	6.40
LK207-24-T	24 way	1550	6.80
LK207-26-T	26 way	1650	7.20
LK207-28-T	28 way	1800	7.90
LK207-30-T	30 way	1900	8.30

Standards

BS EN 7430

– Fix using countersunk wood screws 1½" No. 12 (Part no. SW110) and wall plugs (Part no. PS310)

Standard width x height: 90 mm x 96 mm

Earth bonds & clamps

Accessories

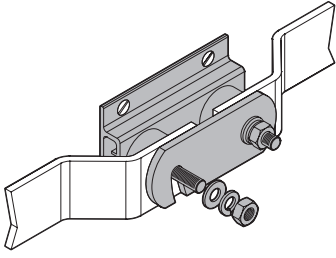

Earth bar accessories

Material: Bare or tinned copper hard drawn bar; uPVC base

Part No.	Description	Length (mm)	Width (mm)	Height	Weight Each (kg)
Copper earth bar					
LK004	Swan-neck link	400	50	36	0.42
LK205	Disconnecting link	125	90	90	0.59
Tinned copper earth bar					
LK004-T	Swan-neck link	400	50	36	0.42
LK205-T	Disconnecting link	125	90	90	0.59

– Fix using countersunk wood screws 1 1/2" No. 12 (Part no. SW110) and wall plugs (Part no. PS310)



Insulator

Material: GRP with brass insert; IN005 stainless steel studs & nuts

Part No.	Description (mm)	Length (mm)	Width (mm)	Height	Dimensions (mm)
Insulator					
IN020	20	14	18	M6	25 x 3
IN030	30	25	33	M6	25 x 6
IN040	40	31	39	M8	38 x 6
IN013	50	27	35	M10	50 x 6
IN060	60	38	52	M10	75 x 6
IN070	70	51	55	M12	100 x 6

Insulator with 2 studs and 3 nuts

IN005	50	27	35	M10	50 x 6
-------	----	----	----	-----	--------

Insulator manufactured from grey GRP material with brass insert

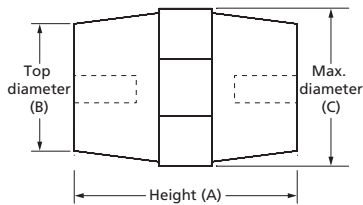
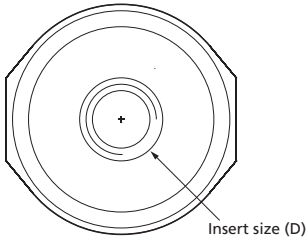

Earth bonds & clamps

Compression connectors

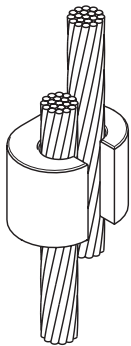

'C' shape connector

Material: Copper

Part No.	Conductor Range (Main) (mm ²)	Conductor Range (Tap) (mm ²)	Box Quantity	Weight Each (kg)
Copper 'C' shape connector				
CN1010	10	1.5-10	100	0.01
CN1616	16	1.5-16	100	0.02
CN2510	16-25	1.5-10	50	0.02
CN2525	25	16-25	50	0.02
CN3516	35	1.5-16	25	0.04
CN3535	35	25-35	25	0.04
CN5025	50	4-25	25	0.09
CN5050	50	35-50	25	0.09
CN7025	70	1.5-25	25	0.04
CN7035	50-70	4-35	25	0.10
CN7070	50-70	35-70	25	0.09
CN9535	95	4-35	25	0.15
CN9570	95	35-70	25	0.15
CN9595	95	70-95	25	0.14
CN120120	120	25-120	25	0.17
CN150120	150	25-120	25	0.16
CN150150	150	70-150	25	0.12
CN18595	185	16-95	25	0.13
CN185185	120-185	120-185	15	0.23
CN240120	150-240	95-120	15	0.24
CN240150	240-150	240-150	10	0.25
CN240185	240-185	240-185	10	0.25
CN240240	240-240	240-240	10	0.27
CN300120	300-120	300-120	10	0.30
CN300300	300-300	300-300	10	0.28

Manufactured from pure or copper. Ensure all underground connections are sealed/waterproofed using Denso Tape
Additional sizes available on request

Earth bonds & clamps

Compression connectors

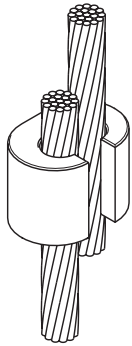

'C' shape connector

Material: Tinned copper

Part No.	Conductor Range (Main) (mm ²)	Conductor Range (Tap) (mm ²)	Box Quantity	Weight Each (kg)
Tinned copper 'C' shape connector				
CN1010-T	10	1.5-10	100	0.01
CN1616-T	16	1.5-16	100	0.02
CN2510-T	16-25	1.5-10	50	0.02
CN2525-T	25	16-25	50	0.02
CN3516-T	35	1.5-16	25	0.04
CN3535-T	35	25-35	25	0.04
CN5025-T	50	4-25	25	0.09
CN5050-T	50	35-50	25	0.09
CN7025-T	70	1.5-25	25	0.04
CN7035-T	50-70	4-35	25	0.10
CN7070-T	50-70	35-70	25	0.09
CN9535-T	95	4-35	25	0.15
CN9570-T	95	35-70	25	0.15
CN9595-T	95	70-95	25	0.14
CN120120-T	120	25-120	25	0.17
CN150120-T	150	25-120	25	0.16
CN150150-T	150	70-150	25	0.12
CN18595-T	185	16-95	25	0.13
CN185185-T	120-185	120-185	15	0.23
CN240120-T	150-240	95-120	15	0.24
CN240150-T	240-150	240-150	10	0.25
CN240185-T	240-185	240-185	10	0.25
CN240240-T	240-240	240-240	10	0.27
CN300120-T	300-120	300-120	10	0.30
CN300300-T	300-300	300-300	10	0.28

Manufactured from pure or tinned copper. Ensure all underground connections are sealed/waterproofed using Denso Tape

Earth bonds & clamps

Cable lug

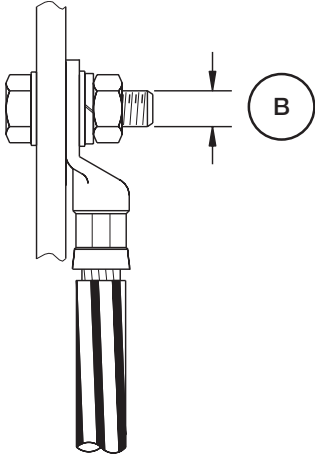

Tinned copper cable lug

Material: Tinned copper

Part No.	Conductor Size (mm ²)	Screw Size (B) (mm)	Weight Each (kg)
FCT166	16	6	0.01
FCT168	16	8	0.01
FCT1610	16	10	0.01
FCT1612	16	12	0.01
FCT256	25	6	0.01
FCT258	25	8	0.01
FCT2510	25	10	0.01
FCT2512	25	12	0.01
FCT356	35	6	0.01
FCT358	35	8	0.01
FCT3510	35	10	0.01
FCT3512	35	12	0.01
FCT506	50	6	0.02
FCT508	50	8	0.02
FCT5010	50	10	0.02
FCT5012	50	12	0.02
FCT708	70	8	0.04
FCT7010	70	10	0.04
FCT7012	70	12	0.04
FCT7014	70	14	0.04
FCT7016	70	16	0.04
FCT958	95	8	0.06
FCT9510	95	10	0.06
FCT9512	95	12	0.06
FCT9514	95	14	0.06
FCT9516	95	16	0.06
FCT12010	120	10	0.06
FCT12012	120	12	0.06
FCT12014	120	14	0.06
FCT12016	120	16	0.06
FCT15010	150	10	0.09
FCT15014	150	12	0.09
FCT15014	150	14	0.09
FCT15016	150	16	0.09
FCT18512	185	12	0.11
FCT18514	185	14	0.11
FCT18516	185	16	0.11
FCT24012	240	12	0.14
FCT24014	240	14	0.14
FCT24016	240	16	0.14
FCT30012	300	12	0.17
FCT30014	300	14	0.17
FCT30016	300	16	0.17
FCT40012	400	12	0.21
FCT40014	400	14	0.21
FCT40016	400	16	0.21

Standards

BS EN 12449
BS EN 1872
BS EN 4579

– Use with tool HT010

Earth bonds & clamps

Compression connector dies



'C' shape connector die

Material: Stainless steel

Part No.	Conductor Range (Main) (mm ²)	Conductor Range (Tap) (mm ²)	Weight Each (g)
HT010 and HT040 tooling			
HD100	10	1.5-10	0.26
HD200	16	1.5-16	0.26
HD200	16-25	1.5-10	0.26
HD200	25	16-25	0.26
HD300	35	1.5-16	0.28
HD300	35	25-35	0.28
HD300	70	1.5-25	0.28
HD400	50	4-25	0.27
HD400	50	35-50	0.27
HD400	50-70	4-35	0.27
HD400	50-70	35-70	0.27
HD500	95	4-35	0.27
HD500	95	35-70	0.27
HD500	95	70-95	0.27
HD600	120	25-120	0.27
HD600	150	25-120	0.27
HD600	150	70-150	0.27
HD600	185	16-95	0.27
HD800	240	95-120	0.28
HT020 and HT030 tooling			
HD700	120-185	120-185	0.22
HD700	150-240	95-120	0.22

Earth bonds & clamps

Compression tools



Hydraulic crimping tool

Part No.	Description	Weight Each (kg)
HT010	Hand operated 13 ton tool with carrying case	8

Self-contained hydraulic crimping tool used for jointing and terminating copper, aluminium and ACSR conductors.

- Crimping force 130 kN
- Two stage 'rapid-ram' advance mechanism for fast installation
- Short fibreglass handle for combined work spaces
- Accepts most U-Type dies of equivalent tonnage
- 180 degree head rotation
- Includes carrying case
- Dies are not included



Hydraulic crimping head and pump

Part No.	Description	Weight Each (kg)
HT020	15 ton hydraulic tool with carrying case	5.5
HT030	Foot operated hydraulic pump with carrying case	16.5

Self-contained hydraulic crimping tool used for jointing and terminating copper, aluminium and ACSR conductors.

- Crimping force 230 kN, maximum operating pressure 700 Bar
- Hydraulic head complete with quick automatic coupler for connection to pump
- Accepts most U-Type dies of equivalent tonnage
- Pump supplied with 3 m long high pressure flexible hose
- Each supplied with carrying case
- Dies are not included

Earth bonds & clamps

Compression tools



Battery powered hydraulic crimping tool

Part No.	Description	Weight Each (kg)
HT040	Battery powered, open head 14 ton tool	10.6

This self-contained, compact, cordless hydraulic tool makes crimping easy with its lightweight single handed design.

- Crimping force 130 kN
- Two stage 'rapid-ram' advance mechanism for fast installation
- Accepts most U-Type dies of equivalent tonnage
- 180 degree head rotation
- Dies are not included

The tool is supplied with:

- Basic tool complete with battery
- Shoulder strap
- Spare battery (14.4 V 3.0 Ah)
- Battery charger
- Carrying case suitable for storing up to 14 sets of dies

8



Battery powered hydraulic cutting tool

Part No.	Description	Weight Each (kg)
HT050	Battery powered 6 ton cutting tool	6.5

This self-contained, compact, cordless hydraulic tool makes cutting copper, aluminium, ACSR and steel earth rods easy with its lightweight single handed design.

- Two stage 'rapid-ram' advance mechanism for fast installation
- Maximum cutting diameter of 25 mm
- Blades manufactured from high strength special steel, heat treated to ensure a long service life
- 180 degree head rotation

The tool is supplied with:

- Basic tool complete with battery
- Battery wrist strap and shoulder strap
- Spare battery (14.4 V 3.0 Ah)
- Battery charger
- Carrying case suitable for storing tool and accessories