

CCSB Conduit Clips

3-in-1 circular clips for strengthening slit conduit



Multi-use conduit clips that provide additional strength to identified areas of high risk in application. Also allows for the maximisation of inventory and increases product installation flexibility via its reduction ratios.

Features & benefits:

- Made from tough and resilient PA66 material
- Designed to work with all Harnessflex backshell interfaces and Y&T pcs
- Aids compression strength and integrity of slit conduits
- Controls gapping and reduces associated risks of damage to cables
- Offers strain relief and increases snap out performance on all backshell and hinged fittings
- Strengthens the connection between fitting/ backshell and conduit, helping to reduce the potential for pull out
- Reduce or step down the size of conduit used within a standard fitting or backshell for true inventory flexibility
- Improves crush strength of slit conduits

Applications:

- For Harness makers and installers
- Securely closes slit conduit to prevent cable exposure, reducing the risk of cable damage
- Improves strain relief on Harnessflex hinged fitting and conduit systems
- Enables installer to reduce hinged fitting outlet sizes

Material:

- Polyamide 6 (Nylon)
 - UV Resistant
 - Heat Stabilised

Temperature range:

- Normal use -40 to +120°C (-40 to +248)°F

Ingress protection:

- N/A

Chemical resistance guide:

- Please refer to TDS000081

Suitable for use with:

- **Conduits**
 - All Harnessflex conduit systems
 - Also compatible with other conduit systems
- **Fittings**
 - TPS - T Piece conduit manifold
 - YPS - Y Piece conduit manifold
 - JPS - Straight conduit joiner
 - EPS - Conduit elbow
 - CI - Conduit to connector interfaces
 - Other harness fitting may also be compatible

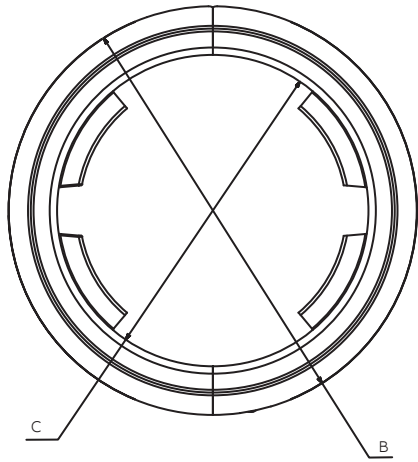
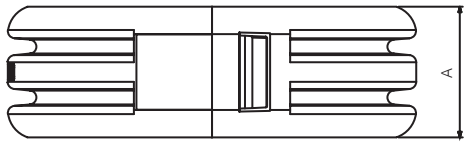

Product selection

Part no:	Dimensions			For conduit	Fits Outlet CCSB Reducer
	A	B	C		
CCSB08	8.1	16.0	10.5	NC08 / NW7.5	NC16 / NW13 CCSB16
CCSB10	9.5	19.4	12.1	NC10 / NW8.5	
CCSB12	9.5	20.8	13.6	NC12 / NW10	NC20 / NW17 CCSB20
CCSB16	9.3	20.9	16.8	NC16 / NW13	NC20 / NW17 CCSB20
CCSB20	9.0	27.8	21.7	NC20 / NW17	NC28 / NW23 CCSB28
CCSB25	10.2	34.2	26.4	NC25 / NW22	NC32 / NW29 CCSB32
CCSB28	10.2	36.0	29.0	NC28 / NW23	
CCSB32	11.5	42.2	35.1	NC32 / NW29	NC40 / NW36 CCSB40
CCSB40	11.5	53.8	43.1	NC40 / NW36	NC50 / NW48 CCSB50
CCSB50	11.5	62.3	55.4	NC50 / NW48	

Colour: Black as standard