

DDA 800

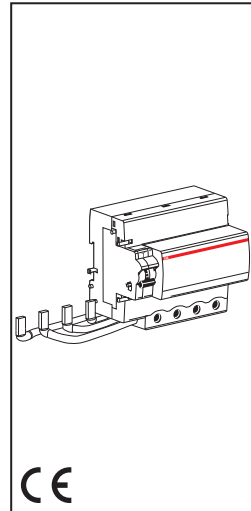

2CSB427001D0006

DDA800 AC	S800P
DDA800 A	S800S
DDA800 A S	S800N
DDA800 A AP-R	S800C
	S800B

ABB S.p.A.
V.le dell'Industria 18
20009 Vittuone (MI), Italy <https://new.abb.com/low-voltage>



S 802 ... + DDA 802 ...

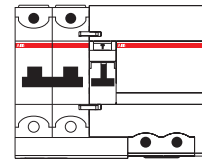

S 803 ... + DDA 803 ...

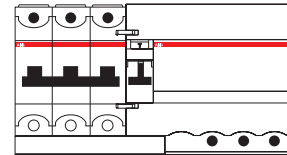

S 804 ... + DDA 804 ...

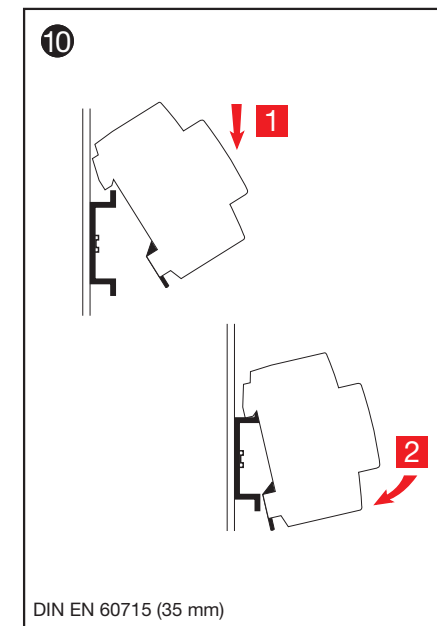
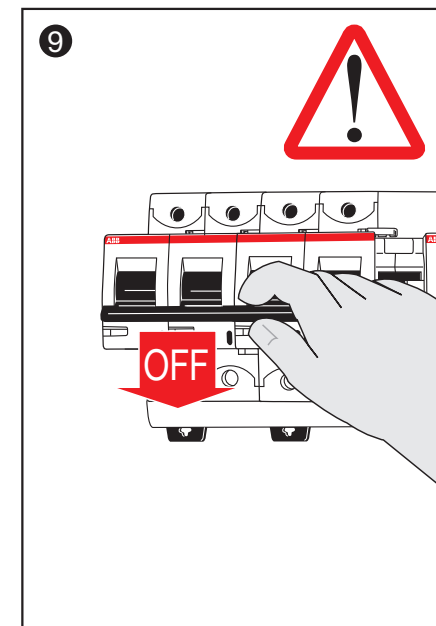
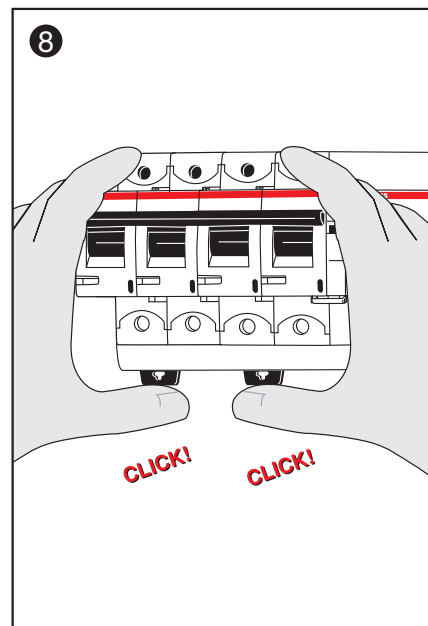
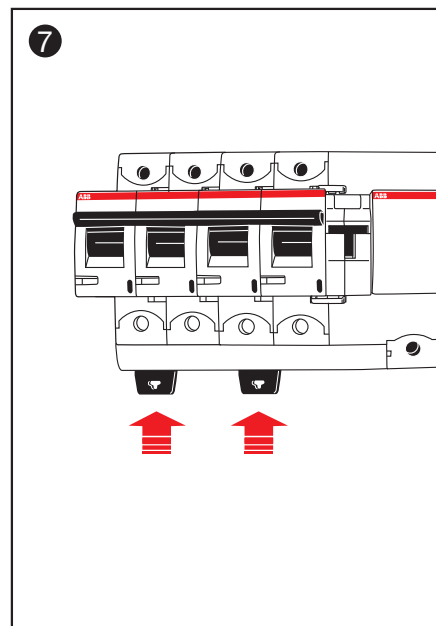
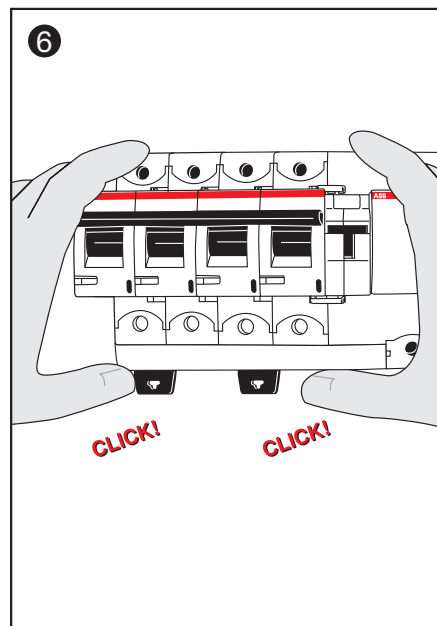
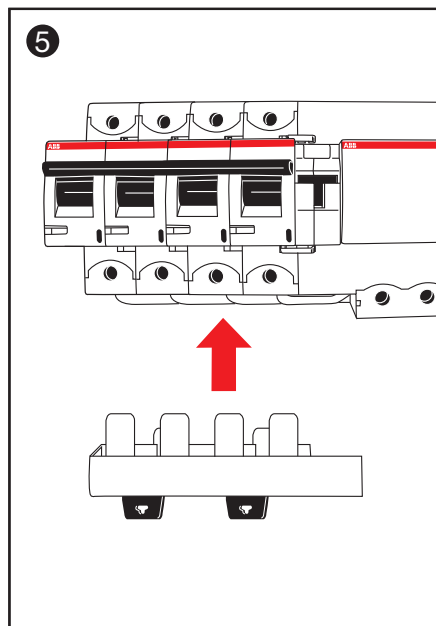
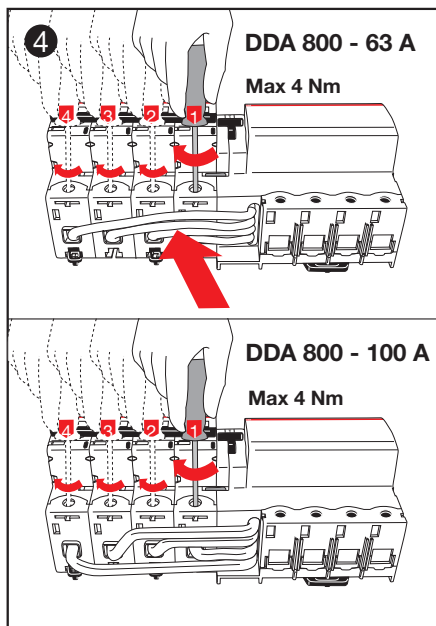
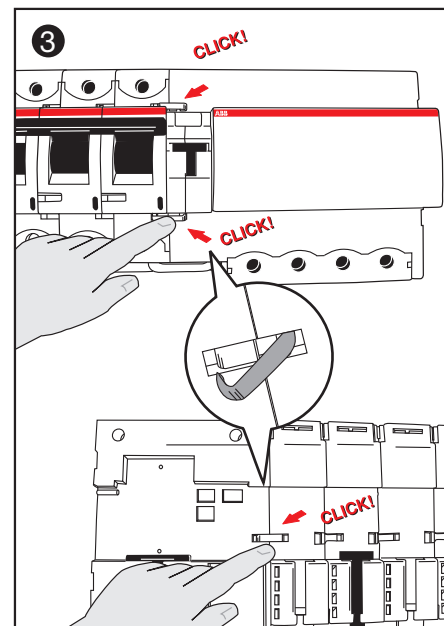
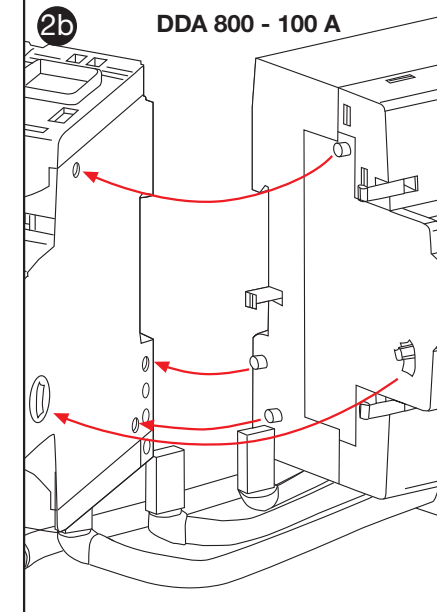
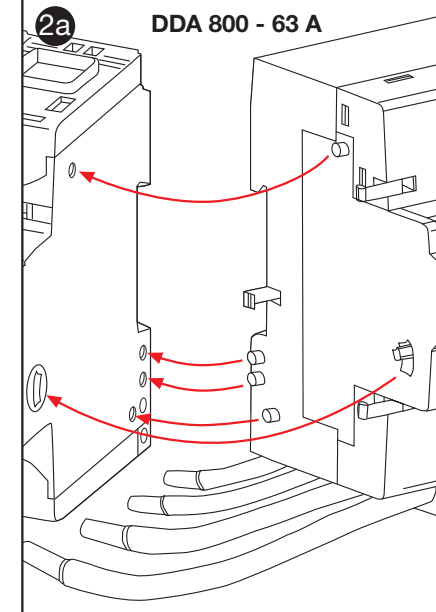
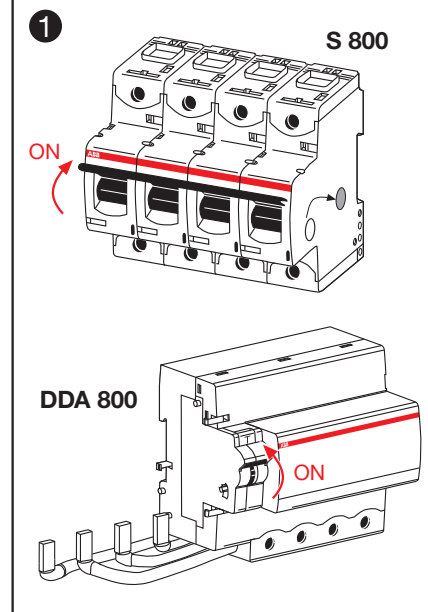
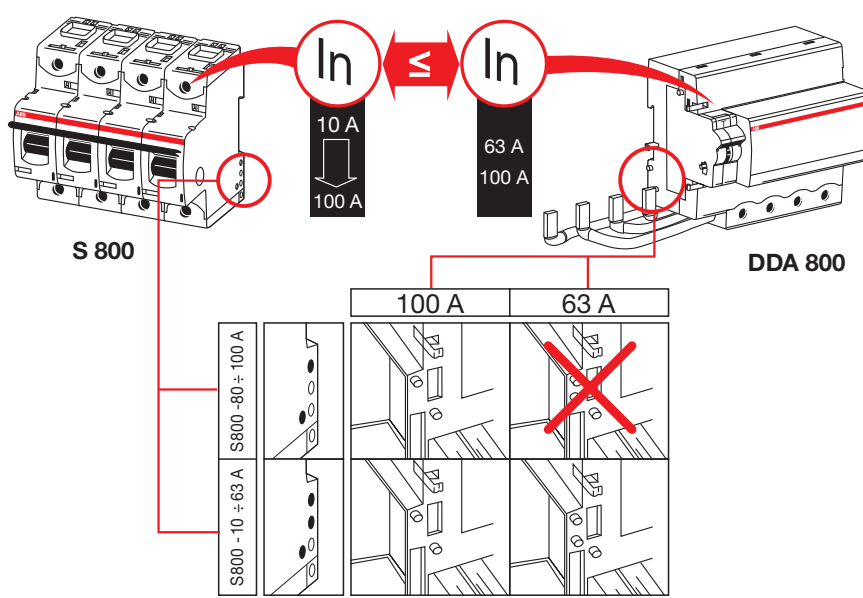
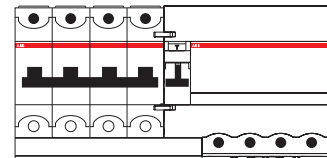

DIN EN 60715 (35 mm)

 **Warning!** Installation by person with electrotechnical expertise only.
Warnung! Installation nur durch elektrotechnische Fachkraft.
Avvertenza! Fare installare solo da un elettricista qualificato.
Avertissement! Installation uniquement par des personnes qualifiées en électrotechnique.
¡Advertencia! La instalación deberá ser realizada únicamente por electricistas especializados.

