



# IRC5 Compact

# IRC5 Compact Controller



- **Compact**
  - Easy to integrate, saves space
- **A fully fledged member of IRC5 family**
  - All the benefits of the #1 robot controller
  - No need to re-train
  - Many common spare parts
- **Easy commissioning**
  - Portable
  - One phase 220/230 V
    - No separate 24 V required
  - External connectors
  - Built-in 16 inputs & 16 outputs
- **Handles robots up to 8 kg payload**

# Single Cabinet vs. Compact Controller

87% smaller, 81% lighter

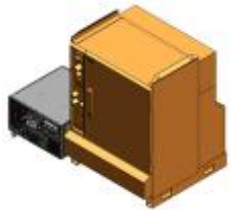
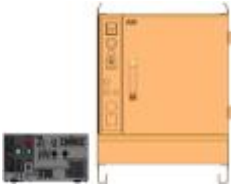

**258 x 450 x 565 (H x W x D) = 66 liters**





**Total Weight = 27.5 kg**



**970 x 725 x 710 (H x W x D) = 499 liters**

**Total Weight = 142 kg**

# Controller Variant Selection Guide

			
Single Cabinet	Dual Cabinet	Panel Mounted	Compact
<ul style="list-style-type: none"><li>▪ “The standard”</li></ul>	<ul style="list-style-type: none"><li>▪ More space</li><li>▪ Distributable</li><li>▪ Height</li><li>▪ Additional robots</li></ul>	<ul style="list-style-type: none"><li>▪ Integration</li><li>▪ Protection</li><li>▪ Size</li><li>▪ Cost</li></ul>	<ul style="list-style-type: none"><li>▪ Size</li><li>▪ Cost</li><li>▪ <i>IRB support</i></li><li>▪ <i>Options</i></li><li>▪ <i>Add. equip.</i></li><li>▪ <i>Protection</i></li></ul>

# IRC5 Variants - IRB Mapping

5 controller variants available  
unique range for small robot!

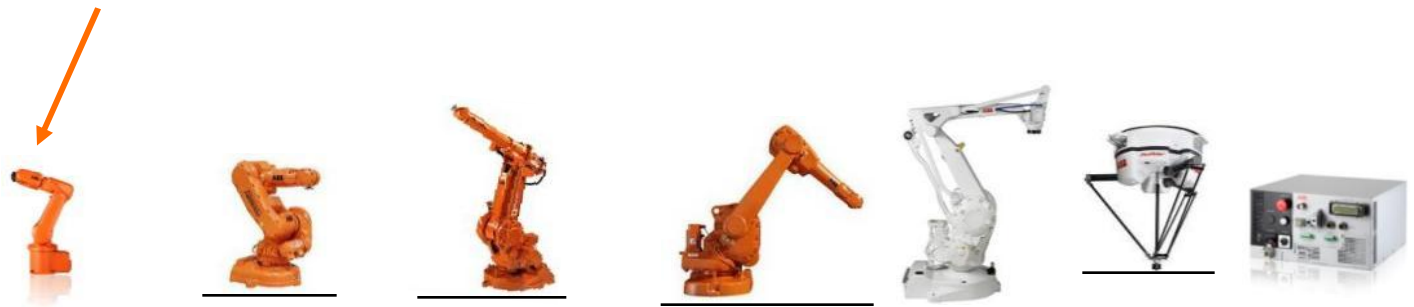

Variant	IRB 120	IRB 140	IRB 1410	IRB 1600	IRB 260	IRB 360	Stand Alone
Compact	Yes	Yes	Yes	Yes	Yes	Yes	Q2 2011
Single Cabinet	Yes	Yes	Yes	Yes	Yes	Yes	Yes
Dual Cabinet	No	Yes	No	Yes	Yes	Yes	Yes
Drive Module only	Yes	Yes	No	Yes	Yes	Yes	Yes
Panel Mounted	No	Yes	No	Yes	Yes	Yes	Yes
Panel Mounted drive only	No	Yes	No	Yes	Yes	Yes	Yes

# Extensive Connectivity

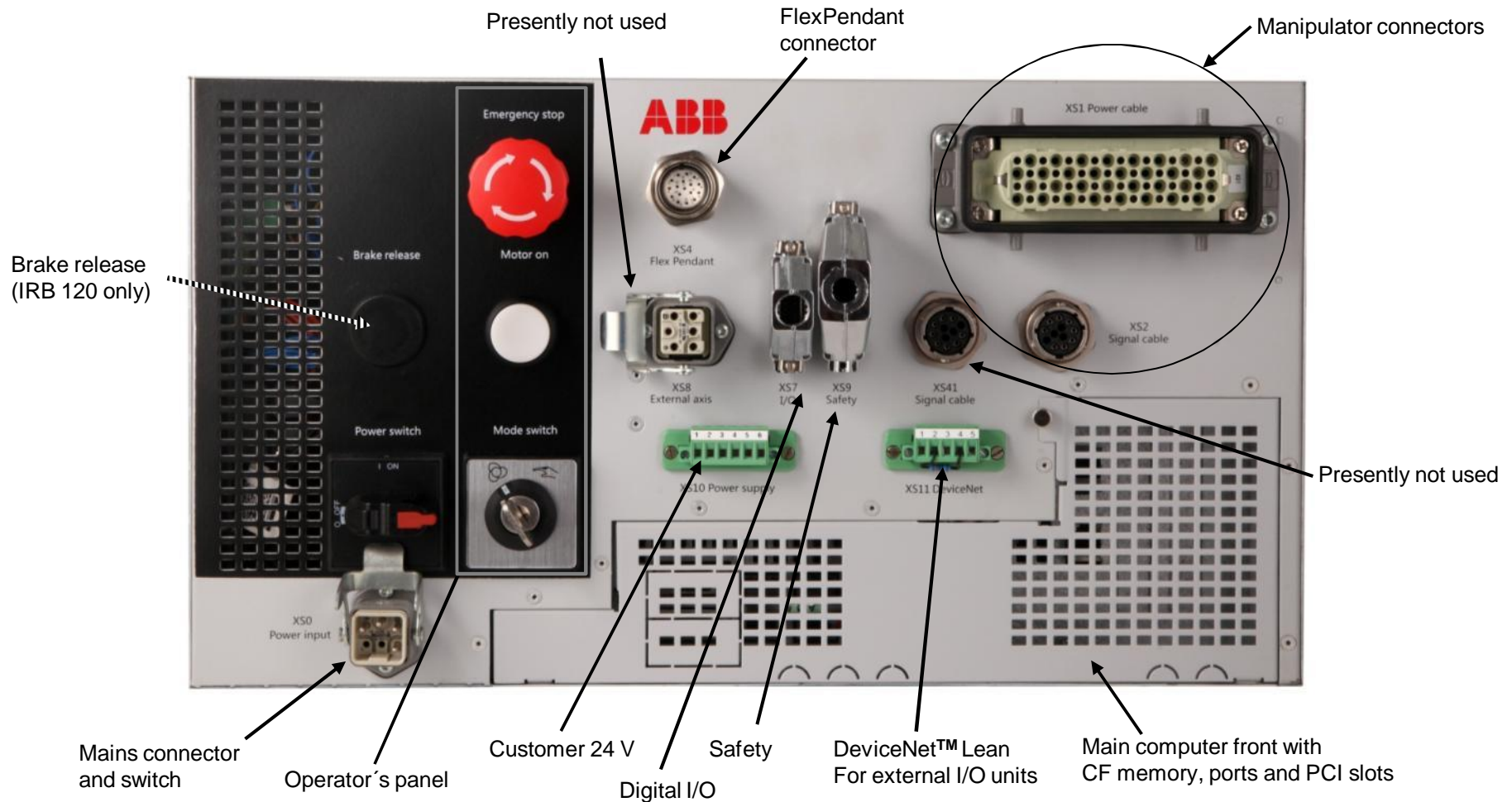

# Inside the IRC5 Compact Controller

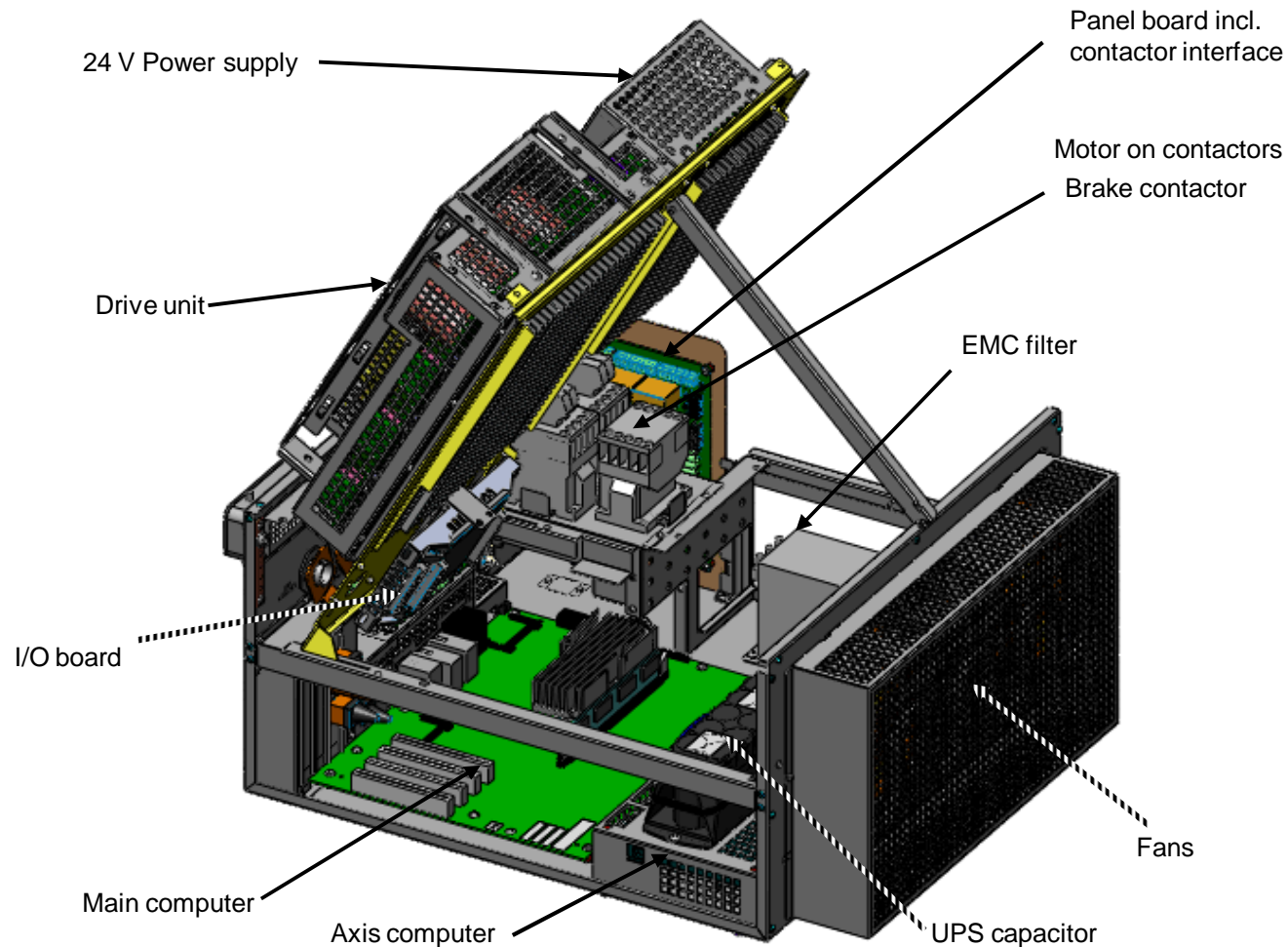



# Options Available



- **Most RobotWare options available.**
  - Including “Prepared for PickMaster”
- **FlexPendant**
- **Most I/O options**
- **Remote Service**
- **Remote operator panel**
  
- **Main limitations**
  - No MultiMove
  - No Force Control (planned for R11.1)
  - No SafeMove
  - No Electronic Positioning Switches (EPS)
  - No additional axes



# Summary

- Fully fledged IRC5 family member
- Same user experience
- Very compact format
- Easy commissioning

Power and productivity  
for a better world™

