

FEATURES

- Response Time From 1 Second
- One Switch for Either Flow or Temperature Applications
- No Moving Parts
- 316L Stainless Steel Wetted Parts
- Explosion Proof Enclosure (IX only)
- Pressure to 4000 psig / 275 bar Standard

OPTIONS:

- Pressure to 10,000 psig / 690 bar (IX only)
- Remote Mounting (IX only)
- Flange Mounting (IX only)

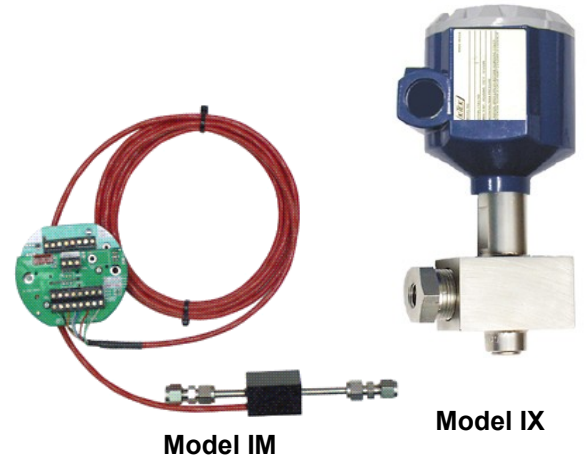

SPECIFICATIONS

Sensor

Materials of Construction	316L Stainless Steel Wetted Parts Standard
Response Time	No Flow to Flow: From 1 Second; Flow to No Flow: From 2 Seconds; Level: $\pm 1/8"$; Temperature from 1 Second
Operating Temperature	-50 to 350°F / -46 to 177°C Standard
Operating Pressure	Full Vacuum to 4000 psig / 276 bar Standard (IX) Full Vacuum to 2000 psig / 138 bar Standard (IM) Options to 10,000 psig / 690 bar optional (IX only)
Repeatability	Flow: 0.5% of maximum flow rating at Constant Conditions Standard Temperature: $\pm 1^\circ\text{C}$
Process Connection	3/4" FNPT Standard Options: 1/2" FNPT, Range Tubes, Flanges

Electronics

Housing (IX only)	Powder Coated Aluminum Standard Optional: Dual Compartment Aluminum; Dual Compartment 316L SS
Operating Temperature	-50 to 140°F/-46 to 60°C Ambient Option: Remote Mounting of Electronics Up to 2000 ft. / 609 meters
Power Input	90-132 VAC, 50/60 Hz, 5.5 watts max Options: 24 VDC, 24 VAC, 208-240 VAC
Relay Output	DPDT 8 amps @ 250 VAC
Conduit Entry	IX: 3/4" FNPT Standard
Approvals (IX only)	CL I, Div I, GP A,B,C,D; CL I, Div II, GP E,F,G; Div III, DIP, NEMA or Type 4X FM: T3A @ Ta = 60C CSA: T3C @ Ta = 60C (For A, A1 and S housing options) GOST Russia, GOST Kazakhstan: 1ExdIICT3
Shipping Weight	5 lbs Standard



ORDERING INFORMATION:

IX 316L Stainless Steel Body; Explosion Proof Housing
IM 316L Stainless Steel wetted parts, composite sensor enclosure; no electronics housing
IX,IM / a / b / c / d / e / f / g / h :

- /a Housing (IX only)**
 A1 Single Compartment Aluminum Housing **Standard**
 A1W Single Compartment Aluminum Housing with glass window cover
 A Dual Compartment Aluminum Housing
 AW Dual Compartment Aluminum Housing with Glass Viewing Window
 S Dual Compartment 316L Stainless Steel Housing
 SW Dual Compartment 316L Stainless Steel Housing with Glass Viewing Window

- Housing (IM only)**
 XX No housing **Standard**
 A1 Single Compartment Aluminum Housing **Optional**

- /b Material Type**
 S6 316L Stainless Steel **Standard**

- /c A) Process Connection – IM Series**
 2525 1/4" x 1/4" O.D. Tubing
A) Process Connection – IX Series Threaded
 7575 3/4" FNPT **Standard**
 5050 1/2" FNPT
 1875 Range Tube #1, 1/4" FNPT x 3/4" FNPT with 1/8" range tube
 2575 Range Tube #2, 1/4" FNPT x 3/4" FNPT with 1/4" range tube
 XXXX Custom Inlet & Outlet 25 = 1/4", 50 = 1/2", 75 = 3/4"

- B) Process Connection – IX Series Flanged**
- | | | |
|-----------------|----------|-----------------------------|
| /AABC AA | B | C |
| 10 1" Flange | 1 150# | 1 Raised Face, 316L SS |
| | 2 300# | 2 Raised Face, Carbon Steel |
| | 3 600# | 3 Flat Face, 316L SS |
| | 4 900# | 4 Flat Face, Carbon Steel |
| | 5 1500# | 6 Special |

- /d Insertion Length**
- | | |
|-----|---|
| 25 | 2.5" Standard (all IX units except 1875 & 2575 connection) |
| 325 | 3.25" (for IX units with 1875 & 2575 connection) |
| 50 | 5.0" Standard (IM units only) |

- /e Power Input**
- | | |
|---|--|
| 1 | 90-132 VAC Standard |
| 2 | 24 VDC or VAC (22.8 - 28.8 VDC; 20 VAC - 25 VAC) |
| 3 | 200-240 VAC |

- /f Process Temperature**
 H0 -50 to 350°F / -46 to 177°C **Standard**

- /g Approvals (IX only)**
 X Not FM or CSA Approved
 FMX Factory Mutual Research Corp. (FMRC) Explosion Proof **Standard**
 CSX CSA Canadian Standard Association Explosion Proof
 GR GOST Russia
 GK GOST Kazakhstan

- /h Options (leave blank if no options required)**
 DS Dual Switch Point Electronics with Millivolt Output
 RJxxxx Remote Electronics with PVC Cable (200°F / 93.3°C) Specify cable length "xxxx" ft. (Max. Length 2000 ft. / 609 m)
 RFxxxx Remote Electronics with Teflon Cable (350°F / 177°C) Specify cable length "xxxx" ft. (Max. Length 2000 ft. / 609 m)
 HP High Pressure Option 10,000 psig / 689 bar (IX Only)
 HS 5 Pin Hermetic Feed-through (not offered with Titanium)

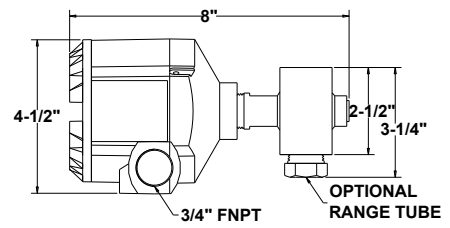

IX Dimensions

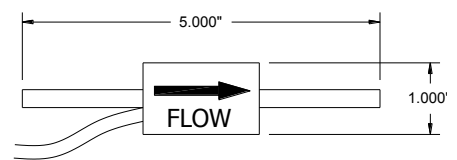

IM Dimensions



INSTRUMENT RANGEABILITY (cc / sec)		CONVERSION CHART TO cc/sec	
Water		From:	Multiply by:
		Gal / Min.	63.1
		Gal / Hr.	1.05
Oil		Gal / Day	0.0438
		L / Min.	16.7
		L / Hr.	.278
Air		L / Day	0.0116
		Ft³ / Min.	472.0
		M³ / Hr.	278.0