

Non-Metallic Systems Accessories - End Cap - Type ECB

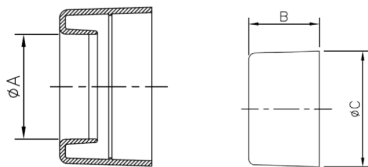

End cap, type ECB, to provide a smooth entry / exit point for conduit when not used with a fitting

Features

- Smooth conduit entry/termination system, black only
- Medium impact resistance
- UV protection is very high

Conformity
N/A

Approvals
N/A

Fire Performance	
Test Standard	Performance Rating
Not Rated	Not Rated

Degree of Mechanical Protection
Medium impact resistance

IP Rating	Appropriate Fitting
For use with: see below	
N/A	

UV Protection
Very High

Temperature Range
Static Application: -45°C to +120°C
Dynamic Application: N/A to N/A

For Use With - Conduit Series
Light, Standard and Heavyweight variants of type PA, PI, CP, PR, PADL & PF

Type of Material	Finish
Acetal (POM)	Black (BL)

Testing Data
See last page

Fitting Characteristics
Smooth conduit entry / termination system

Part No	To Suit Conduit Size	Nominal Dimensions (mm)		
		A	B	C
ECB13	13.0	8.0	15.0	15.8
EBC16	15.8	9.5	15.0	18.0
ECB21	21.2	13.5	18.0	24.6
ECB28	28.5	20.5	20.0	31.7
ECB34	34.5	25.7	20.0	38.0
ECB42	42.5	32.3	25.0	46.3
ECB54	54.5	43.5	25.0	58.2

