

---

 TECHNICAL DATA SHEET

# PMA EcoGuard™ - BRND-M - Fitting

Straight, metric thread, recycled content

## PMA



Presenting PMA EcoGuard™ PA6

- 50% recycled-based content primarily sourced from discarded fishing nets



### Applications:

- In machine building, installation and construction industries

### Features & Benefits:

- Easy „push-in“ installation
- Re-opening with screwdriver (for security reasons hand opening not possible)
- Space saving due to compact design
- Fits both conduit profiles - fine (T) and coarse (G)

### Ingress protection:

- IP66 (EN/IEC 60529)

### Materials:

- Recycle-based polyamide 6
- High-grade, specially formulated polyamide 6

### Compatible with:

- PMA EcoGuard Conduits
- PMAFLEX Pro Conduits
- PMAFLEX Multilayer Conduits
- PMAFLEX Conduits
- PMA Smart Line Conduits

### Sustainability:

- 50% recycle-based content primarily sourced from discarded fishing nets

### Weathering resistance:

- Very good UV resistance and weathering characteristics

### Colour:

- Black

### Chemical properties:

- Please refer to [www.pma.ch](http://www.pma.ch)
- (Technical Information / Chemical Resistance)

### Environmental properties:

- Free from halogens and cadmium
- RoHS and REACH compliant

**Product selection:**

Part no.	Thread size	Conduit size	Dimensions in mm (nom.)				Weight	Packing unit
			g	L	d2	SW		
black	metric	NW	g	L	d2	SW	kg/100 pcs	pcs/PU
BRND-M160	M16x1.5	10	11.0	34.0	21.5	16.0	0.6	100
BRND-M162	M16x1.5	12	11.0	38.0	25.0	19.0	0.6	100
BRND-M202	M20x1.5	12	11.0	38.0	25.0	19.0	0.7	100
BRND-M207	M20x1.5	17	11.0	41.0	31.0	24.0	0.8	100
BRND-M257	M25x1.5	17	12.0	42.0	31.0	24.0	1.0	100
BRND-M253	M25x1.5	23	12.0	45.5	39.0	32.0	1.2	50
BRND-M323	M32x1.5	23	15.0	48.5	39.0	32.0	1.5	50
BRND-M329	M32x1.5	29	15.0	50.5	46.0	38.0	1.9	30
BRND-M406	M40x1.5	36	19.0	60.5	56.0	46.0	3.5	20
BRND-M508	M50x1.5	48	19.0	61.0	69.0	60.0	4.7	10

Our customer service dept. or local distribution partner will be pleased to help you concerning product availability and lead time

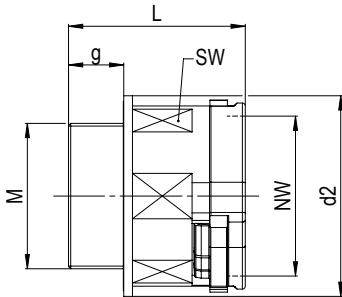

Mechanical Properties:	Value:	Test parameters:	Test method:
Tensile modulus	1'200 ... 3'700 N/mm <sup>2</sup>		ISO 527
Tensile strength	45 ... 65 N/mm <sup>2</sup>		ISO 527
Notched bar impact test	4 ... 20 kJ/m <sup>2</sup>		ISO 180/1C

Thermal properties:	Value:	Test parameters:	Test method:
Continuous application temperature	-50 ... +95°C		PMA DO 9.21-4510
Upper application temperature	+110°C	(20'000 h)	PMA DO 9.21-4360
Short-term	+160°C	(168 h)	PMA DO 9.21-4360

Fire safety properties:	Value:	Test parameters:	Test method:
Fire performance	non flame-propagating		IEC EN 61386-1

**Content of delivery:**

- Fitting

**Assembly instructions:**

- When mounting, push-in conduit completely and then pull back slightly to ensure the locking mechanism is fully engaged  
To Disassembly: reopen with screwdriver and tiwst for easy release  
Please consider the appropriate assembly instructions on [www.pma.ch](http://www.pma.ch)

ABB Switzerland Ltd,  
PMA Cable Protection  
Aathalstrasse 90  
8610 Uster, Switzerland  
Phone: +41 58 585 00 11  
pma-info@ch.abb.com  
[www.pma.ch](http://www.pma.ch)

Let's write the future.  
Together. **abb.com**

We reserve the right to make technical changes or modify the contents of this document without prior notice. With regard to purchase orders, the agreed particulars shall prevail. ABB Installation Products Inc. does not accept any responsibility whatsoever for potential errors or possible lack of information in this document.

We reserve all rights in this document and in the subject matter and illustrations contained therein. Any reproduction, disclosure to third parties or utilization of its contents – in whole or in parts – is forbidden without prior written consent of ABB Inc. Copyright© 2019 ABB Installation Products Inc. All rights reserved

