

Non-metallic nylon conduit EXBQ & EXPQ range - Metallic fittings

2

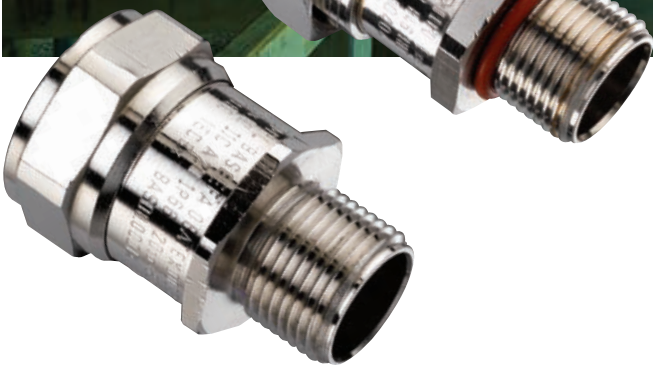

Features

- Manufactured in nickel plated brass
- Approved for use in Ex e applications for Zones 1, 2, 21 & 22
- Available in Metric & NPT thread
- EXPQM for use with unbraided nylon conduit
- EXBQA for use with braided nylon conduit

Certifications



Standards

Approved to:	IEC EN 60079-0, 60079-7, 60079-31
EC Type examination certificate to:	ATEX: Baseefa 08 ATEX 0003X IECEX: IECEX BAS08.0001X Ex e IIC Gb Ex tb IIIC Db
Safe operating temperature range:	-40°C to +85°C
IP test:	IP66

Non-metallic nylon conduit EXBQ & EXPQ range - Metallic fittings

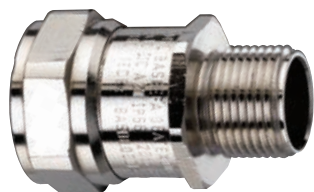

Type EXPQ
Nylon conduit fitting

Dimensions

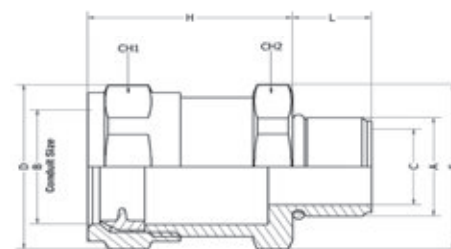

Type EXPQM / EXPQA for use with EXB and XESX conduits

Nylon Conduit Fitting / Materials: Nickel plated brass

Part No.	Thread Size A	Nominal conduit size B (mm)	Cable gland dimensions (mm)						
			C	D	E	L	H	CH1	CH2
EXPQM0303	M16	16.0	11.4	27.4	25.9	16.0	33.3	25.4	24.0
EXPQM0304	M20	16.0	11.4	27.4	25.9	16.0	33.3	25.4	24.0
EXPQM0404	M20	21.0	15.8	30.2	30.2	16.0	32.0	28.0	28.0
EXPQM0505	M25	28.0	19.0	41.0	41.0	16.0	39.0	38.0	38.0
EXPQM0606	M32	34.0	26.4	48.1	45.4	17.0	40.0	44.5	42.0
EXPQM0707	M40	42.0	32.9	61.6	58.3	17.0	49.5	57.0	54.0
EXPQM0808	M50	54.0	43.9	75.6	75.6	16.0	48.0	70.0	70.0
EXPQM0909	M63	63.0	56.0	91.8	91.8	16.0	54.6	84.0	84.0
EXPQM1010	M75	80.0	67.5	104.0	104.0	16.0	52.6	95.3	95.3
EXPQA0304	1/2" NPT	16.0	11.4	33.2	26.6	18.0	43.5	30.0	24.0
EXPQA0404	1/2" NPT	21.0	15.8	38.8	31.0	16.0	43.5	35.0	28.0
EXPQA0505	3/4" NPT	28.0	19.0	49.3	42.1	16.0	50.0	44.5	38.0
EXPQA0606	1" NPT	34.0	26.4	55.4	46.5	18.0	51.0	50.0	42.0
EXPQA0707	1 1/4" NPT	42.0	32.9	77.6	59.8	18.0	67.5	70.0	54.0
EXPQA0808	1 1/2" NPT	54.0	43.9	93.1	77.6	16.0	70.0	84.0	70.0
EXPQA0909	2" NPT	63.0	56.0	91.8	91.8	16.0	54.6	84.0	84.0
EXPQA1010	2 1/2" NPT	80.0	67.5	104.0	104.0	16.0	52.6	95.3	95.3



Type EXBQ
Braided conduit fitting

Dimensions

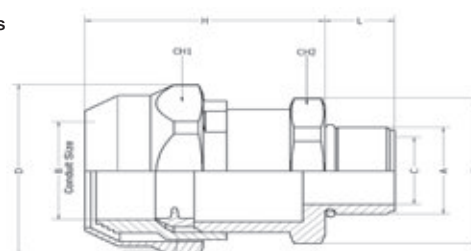

Type EXBQM / EXBQA for use with EXBB conduit

Nylon Conduit Fitting / Materials: Nickel plated brass

Part No.	Thread Size A	Nominal conduit size B (mm)	Cable gland dimensions (mm)						
			C	D	E	L	H	CH1	CH2
EXBQM0303	M16	16.0	11.4	27.4	25.9	16.0	33.3	25.4	24.0
EXBQM0304	M20	16.0	11.4	25.9	27.4	20.0	32.5	24.0	25.4
EXBQM0404	M20	21.0	15.8	30.2	30.2	20.0	31.5	28.0	28.0
EXBQM0505	M25	28.0	19.0	41.0	41.0	20.2	38.3	38.0	38.0
EXBQM0606	M32	34.0	26.4	45.4	48.1	24.2	40.0	42.0	44.5
EXBQM0707	M40	42.0	32.9	58.3	61.6	25.8	49.5	54.0	57.0
EXBQM0808	M50	54.0	40.7	75.6	75.6	26.1	48.0	70.0	70.0
EXBQA0304	1/2" NPT	16.0	11.4	33.2	26.6	20.0	44.5	30.0	24.0
EXBQA0404	1/2" NPT	21.0	15.8	38.8	31.0	20.0	45.0	35.0	28.0
EXBQA0505	3/4" NPT	28.0	19.0	49.3	42.1	20.2	54.0	44.5	38.0
EXBQA0606	1" NPT	34.0	26.4	55.4	46.5	24.2	57.5	50.0	42.0
EXBQA0707	1 1/4" NPT	42.0	32.9	77.6	59.8	25.8	70.0	70.0	54.0
EXBQA0808	1 1/2" NPT	54.0	40.7	93.1	77.6	26.1	70.0	84.0	70.0