

SOLUTION OVERVIEW

## Residential components and systems from ABB

The home of trusted solutions for over 100 years.

For more than a century, electricians have relied on the trusted brands of ABB Installation Products\* — brands like Carlon®, Catamount® and Red•Dot®. You can still count on those same brands for the quality, innovation and performance you need to get the job done right. Plus, now you can combine them with innovative new residential solutions featuring the latest technology from ABB — all available from the same single source you know and trust.



**ABB-free@home™ smart home system**  
 ABB-free@home isn't just another smart home solution. It's smarter than smart. Smarter than complicated installations, one-function devices and automation solutions that don't work together. It performs elaborate functions with ease and simplicity, making the home safer, more comfortable and more enjoyable. Learn more at [abb.com/freathome](http://abb.com/freathome).



**Carlon® non-metallic boxes**  
 Made for quick and easy installation, code compliance and durability, Carlon non-metallic boxes and accessories are widely recognized as the industry standard. Learn more at [www-public.tnb.com/pub/en/node/293](http://www-public.tnb.com/pub/en/node/293).

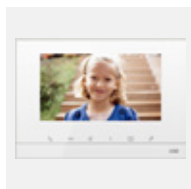

**Welcome® door entry system (DES)**  
 ABB Welcome opens up new possibilities for both residents and guests, providing comprehensive comfort, greater security and elegant design. The fascinating design and innovative technology complement all home designs and expectations for comfort and safety. Learn more at [abb.com/door-entry-system-us](http://abb.com/door-entry-system-us).



**Catamount® cable ties and electricians' supplies**  
 The Catamount brand offers durable, value-priced performance for a variety of commercial and residential applications. The product line encompasses cable ties, wire connectors, application tools, wire pulling lubricants and more. Learn more at [www-public.tnb.com/pub/en/node/182](http://www-public.tnb.com/pub/en/node/182).



**SENTRICITY® load centers and circuit breakers**  
 Home has a power like no other. To comfort us. Keep us safe. And give us peace of mind. But only if the load center can do the same. That's why ABB, inventor of the resettable circuit breaker, has brought its global brand of electrical innovation to the residential market, adding premium features to create a product that's anything but standard. Learn more at [abb.com/sentricity](http://abb.com/sentricity).



**Red•Dot® weatherproof products**  
 The Red•Dot line of weatherproof products includes commercial-, industrial- and residential-grade outlet boxes, covers and lamp holders for outdoor power and lighting applications, available in both metallic and non-metallic materials. Learn more at [www-public.tnb.com/pub/en/node/617](http://www-public.tnb.com/pub/en/node/617).

\* Formerly Thomas & Betts.



# Residential components and systems from ABB

The home of trusted solutions for over 100 years.

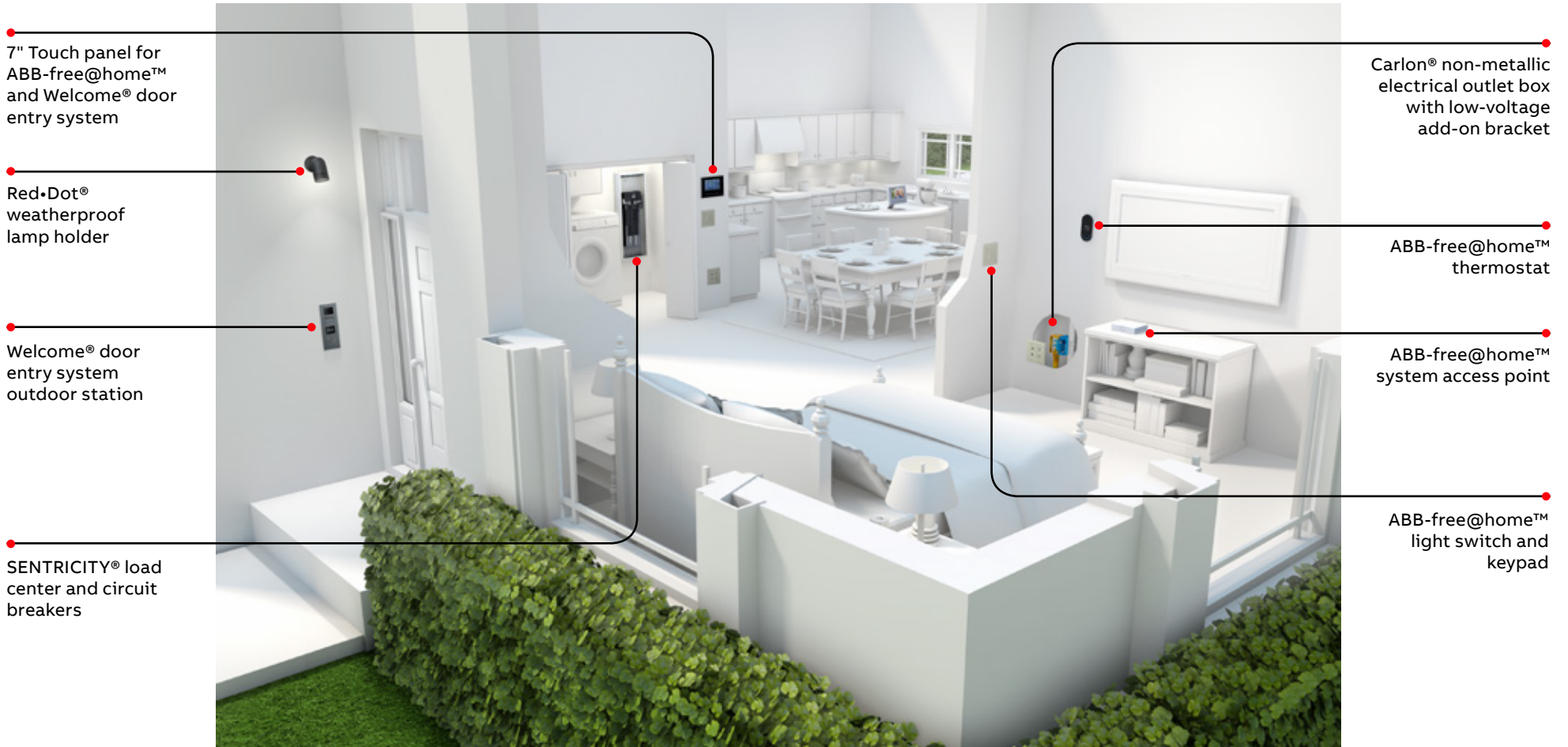

7" Touch panel for ABB-free@home™ and Welcome® door entry system

Red•Dot® weatherproof lamp holder

Welcome® door entry system outdoor station

SENTRICITY® load center and circuit breakers

Carlon® non-metallic electrical outlet box with low-voltage add-on bracket

ABB-free@home™ thermostat

ABB-free@home™ system access point

ABB-free@home™ light switch and keypad

**ABB Inc.**  
Electrification Products  
860 Ridge Lake Blvd.  
Memphis, TN 38120

We reserve the right to make technical changes or modify the contents of this document without prior notice. With regard to purchase orders, the agreed particulars shall prevail. ABB Inc. does not accept any responsibility whatsoever for potential errors or possible lack of information in this document.

We reserve all rights in this document and in the subject matter and illustrations contained therein. Any reproduction or utilization of its contents – in whole or in parts – is forbidden without prior written consent of ABB Inc.  
Copyright© 2018 ABB  
All rights reserved

## Contact us

We'd love to hear from you about your latest single- or multi-family residential construction or retrofit project and discuss how ABB solutions can help. Email us today at [Info.homesolutions@us.abb.com](mailto:Info.homesolutions@us.abb.com).