 TECHNICAL DATA SHEET

PMA Ex system – BETR - T-Junction

PMA



IP68, polyamide T-junction for flexible non-metallic conduit



Applications:

- For indoor and outdoor applications in hazardous areas

Features & Benefits:

- Prevents electrostatic charging
- For indoor and outdoor applications
- High connection strength - to conduit
- Corrosion resistant
- Easy installation
- Very good chemical properties
- For Zone 1, 2, 21 & 22

Ingress protection:

- IP66, IP68

Materials:

- Dissipative polyamide 12

Compatible with:

- PMA Ex-System Conduit

Conforms to:

- IEC EN 60079-0, IEC EN 60079-7, IEC EN 60079-31
- GB/T 3836.1, GB/T 3836.3, GB/T 3836.31

Certificates:

- ATEX: SEV 15 ATEX0121X
- IECEx: IECEx SEV15.0009X
- CCCEX: 2024122313118136

Ex-Markings:

- Ex eb IIC Gb
- Ex tb IIIC Db

Weathering resistance:

- Very good UV resistance and weathering characteristics

Colour:

- Black

Chemical properties:

- Please refer to www.pma.ch for more technical information and informations on chemical resistance

Environmental properties:

- Free from halogens and cadmium
- RoHS and REACH compliant

Product selection:

Part no.	Conduit size			Dimensions in mm (nom.)							Weight	Packing unit
	NW (A)	NW (B)	NW (C)	L	H	M	E	F	N	O		
black											kg/100 pcs	pcs/PU
BETRO20202	10	10	10	59.0	39.5	2xM4	19.0	21.0	21.0	10.5	1.5	10
BETRO30303	12	12	12	71.5	47.5	2xM4	22.5	26.5	24.0	12.0	1.7	10
BETRO40404	17	17	17	93.5	61.5	2xM5	29.5	34.0	30.0	15.0	3.2	10
BETRO50505	23	23	23	106.5	70.0	2xM5	30.5	41.5	37.5	19.0	5.5	10
BETRO60606	29	29	29	111.0	77.5	2xM5	31.5	48.0	44.5	22.5	6.5	10
BETRO70707	36	36	36	150.5	99.0	2xM6	44.0	57.0	54.5	27.5	12.0	10
BETRO80808	48	48	48	163.0	111.5	2xM6	43.0	71.0	66.5	33.5	18.5	10

Our customer service dept. or local distribution partner will be pleased to help you concerning product availability and lead time

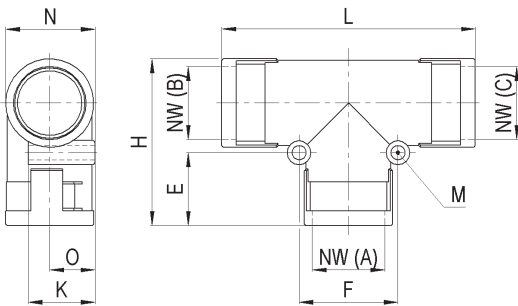

Mechanical Properties:	Value:	Test parameters:	Test method:
Tensile modulus	1100 N/mm ²		ISO 527
Tensile strength	35 N/mm ²		ISO 527
Impact strength	> 7 J	(85°C)	EN 60079-0
Impact strength (NW10-12)	> 7 J	(-5°C)	EN 60079-0
Impact strength (NW17-48)	> 7 J	(-20°C)	EN 60079-0

Thermal properties:	Value:	Test parameters:	Test method:
For use in hazardous locations:			
Temperature range in combination with PMA XESX conduit sizes 02-03 (NW10-12)	-05 ... +85 °C		EN 60079-0
Temperature range in combination with PMA XESX conduit sizes 04-08 (NW17-48)	-20 ... +85 °C		EN 60079-0
General:	-50 ... +95 °C		

Electrical properties:	Value:	Test parameters:	Test method:
Specific surface resistivity	< 10 ⁷ Ω		ASTM D257

Content of delivery:

- T-Junction with conduit locking clips (EVN2),
- Ex-System Conduit gaskets (NEN3)

Assembly instructions:

- Please consider the appropriate assembly instructions on www.pma.ch

ABB Switzerland Ltd,
PMA Cable Protection
Aathalstrasse 90
8610 Uster, Switzerland
Phone: +41 58 585 00 11
pma-info@ch.abb.com
www.pma.ch

Let's write the future.
Together. **abb.com**

We reserve the right to make technical changes or modify the contents of this document without prior notice. With regard to purchase orders, the agreed particulars shall prevail. ABB Installation Products Inc. does not accept any responsibility whatsoever for potential errors or possible lack of information in this document.

We reserve all rights in this document and in the subject matter and illustrations contained therein. Any reproduction, disclosure to third parties or utilization of its contents – in whole or in parts – is forbidden without prior written consent of ABB Inc. Copyright© 2019 ABB Installation Products Inc. All rights reserved

