 TECHNICAL DATA SHEET

PMA Smart Line - ALWD-P - Fitting

90°elbow, one-piece, IP66, PG thread

PMA



One-piece, IP66 polyamide fitting for flexible non-metallic conduit



Applications:

- In machine building, installation and construction industries

Features & Benefits:

- Economical
- Easy „push-in“ installation
- Re-opening with screwdriver (for security reasons hand opening not possible)
- Space saving due to compact design
- Fits both conduit profiles - fine (T) and coarse (G)

Ingress protection:

- IP66 (EN/IEC 60529)

Materials:

- High-grade, specially formulated polyamide 6

Compatible with:

- PMAFLEX Pro Conduits
- PMAFLEX Multilayer Conduits
- PMAFLEX Conduits
- PMA Smart Line Conduits

Weathering resistance:

- Very good UV resistance and weathering characteristics, particularly in black

Colour:

- Black
- Grey

Chemical properties:

- Please refer to www.pma.ch (Technical Information / Chemical Resistance)

Environmental properties:

- Free from halogens and cadmium
- RoHS and REACH compliant

Product selection:

Part no.		Thread size	Conduit size	Dimensions in mm (nom.)				Weight	Packing unit
black	grey	PG	NW	g	d2	A	B	kg/100 pcs	pcs/PU
ALWD-P070*	SLWD-P070*	7	10	7.0	21.5	42.0	37.5	1.3	100
ALWD-P090	SLWD-P090	9	10	11.0	21.5	32.5	37.5	0.6	100
ALWD-P092*	SLWD-P092*	9	12	8.0	25.0	48.0	43.5	1.8	100
ALWD-P110*	SLWD-P110*	11	10	8.0	25.0	44.0	40.0	1.0	100
ALWD-P112	SLWD-P112	11	12	11.0	31.0	36.5	43.5	0.9	100
ALWD-P130*	SLWD-P130*	13.5	10	9.0	31.0	37.5	40.0	1.0	100
ALWD-P132	SLWD-P132	13.5	12	11.0	39.0	36.5	45.0	1.0	100
ALWD-P137	SLWD-P137	13.5	17	11.0	39.0	41.0	50.5	1.4	100
ALWD-P167	SLWD-P167	16	17	11.0	46.0	41.0	51.5	1.4	100
ALWD-P213	SLWD-P213	21	23	12.0	46.0	52.0	61.0	2.2	50
ALWD-P299	SLWD-P299	29	29	12.0	56.0	58.5	70.5	3.1	30
ALWD-P366	SLWD-P366	36	36	13.0	56.0	70.0	85.0	5.8	20
ALWD-P488	SLWD-P488	48	48	13.0	68.0	83.0	97.5	8.8	10

These products will be delivered with a thread adapter.
Our customer service dept. or local distribution partner will be pleased to help you concerning product availability and lead time

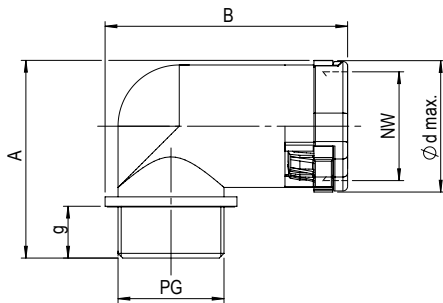

Mechanical Properties:	Value:	Test parameters:	Test method:
Tensile modulus	1'200 ... 3'700 N/mm ²		ISO 527
Tensile strength	45 ... 65 N/mm ²		ISO 527
Notched bar impact test	4 ... 20 kJ/m ²		ISO 180/1C

Thermal properties:	Value:	Test parameters:	Test method:
Continuous application temperature	-50 ... +105°C		PMA DO 9.21-4510
Upper application temperature	+120°C	(20'000 h)	PMA DO 9.21-4360
Short-term	+160°C	(168 h)	PMA DO 9.21-4360

Fire safety properties:	Value:	Test parameters:	Test method:
Fire performance	non flame-propagating		IEC EN 61386-1
Flame class	V2		UL 94

Content of delivery:

- Fitting

Assembly instructions:

- When mounting, push-in conduit completely and then pull back slightly to ensure the locking mechanism is fully engaged
- To Disassembly: reopen with screwdriver and tiwst for easy release
- Please consider the appropriate assembly instructions on www.pma.ch

ABB Switzerland Ltd,
PMA Cable Protection
Aathalstrasse 90
8610 Uster, Switzerland
Phone: +41 58 585 00 11
pma-info@ch.abb.com
www.pma.ch

Let's write the future.
Together. **abb.com**

We reserve the right to make technical changes or modify the contents of this document without prior notice. With regard to purchase orders, the agreed particulars shall prevail. ABB Installation Products Inc. does not accept any responsibility whatsoever for potential errors or possible lack of information in this document.

We reserve all rights in this document and in the subject matter and illustrations contained therein. Any reproduction, disclosure to third parties or utilization of its contents – in whole or in parts – is forbidden without prior written consent of ABB Inc. Copyright© 2019 ABB Installation Products Inc. All rights reserved

