

SAFETY INSTRUCTIONS

ReliaGear neXT

Power Panelboards

Doc.no. 1SQC900026M0201

     			<p>it Attenzione: Tensione pericolosa! Fare riferimento alle istruzioni per l'uso. Prima di intervenire su questo dispositivo, scollegare e isolare tutte le fonti di alimentazione. Attenzione! L'installazione deve essere eseguita esclusivamente da un installatore qualificato.</p>
ar	<p>تحذير: جهد كهربائي خطير! راجع تعليمات التشغيل. افصل الكهرباء وقم بتأمينها قبل العمل في هذا الجهاز تنبيه! يجب عدم التركيب إلا من خلال شخص على دراية بمجال التقنية الكهربائية .</p>	lt	<p>Įspėjimas: Pavojainga įtampa! Žr. naudojimo instrukcijas. Atjunkite ir laikinai užblokuokite maitinimą prieš dirbdami su šiuo įrenginiu. Dėmesio! Įrengti gali tik asmuo, turintis elektrotechnikos patirties.</p>
bg	<p>Предупреждение: Опасно напрежение! Вижте инструкциите за работа. Изключете и блокирайте захранването преди да работите с устройството. Внимание! Да се монтира само от експерт електротехник.</p>	lv	<p>Bīdīnājums: Bīstams spriegums! Skatiet darba norādījumus. Pirms sākat darbu ar šo ierīci, atvienojiet un bloķējiet strāvas padevi. Uzmanību! Uzstādīšanu drīkst veikt tikai persona ar zināšanām par elektrotehniku.</p>
cs	<p>Varování: Nebezpečné napětí! Viz návod k obsluze. Před zahájením prací na tomto zařízení odpojte a uzamkněte napájení. Pozor! Toto zařízení smí instalovat pouze osoba s elektrotechnickou odborností.</p>	nl	<p>Waarschuwing: Gevaarlijke spanning! Raadpleeg de installatie-instructies. Koppel dit apparaat los van de stroomvoorziening voordat u werkzaamheden uitvoert. Let op! Installatie mag alleen worden uitgevoerd door een monteur met elektrotechnische expertise.</p>
da	<p>Advarsel: Farlig elektrisk spænding! Se installationsinstruktioner. Frakobl enheden, og afbryd strømforsyningen, før du arbejder med denne enhed. Giv agt! Installation må kun foretages af personer med elektroteknisk ekspertise.</p>	no	<p>Advarsel: Farlig spenning! Se i bruksanvisningen. Koble fra og steng av strømmen før du arbeider på denne enheten. Forsiktig! Montering skal kun utføres av kvalifiserte personer med elektrokompetanse.</p>
de	<p>Warnung: Gefährliche Spannung! Siehe Installationsanleitung. Vor dem Arbeiten Gerät ausschalten und von der Spannungsversorgung trennen. Achtung! Installation nur durch elektrotechnische Fachkraft.</p>	pl	<p>Ostrzeżenie: Niebezpieczne napięcie! Patrz: instrukcja instalacji. Przed rozpoczęciem wykonywania pracy z tym urządzeniem odłącz i zablokuj zasilanie. Uwaga! Montaż może wykonywać wyłącznie osoba posiadająca doświadczenie elektrotechniczne.</p>
el	<p>Προειδοποίηση: Επικίνδυνη τάση! Ανατρέξτε στις οδηγίες λειτουργίας. Αποσυνδέστε και απομονώστε την παροχή ισχύος προτού ξεκινήσετε τις εργασίες σε αυτήν τη συσκευή. Προσοχή! Η εγκατάσταση πρέπει να γίνεται μόνο από αδειούχο ηλεκτρολόγο εγκαταστάτη.</p>	pt	<p>Aviso: Tensão perigosa! Consulte as instruções de instalação. Desconecte e desligue a energia elétrica antes de trabalhar nesse dispositivo. Atenção! A instalação deve ser feita apenas por uma pessoa com especialidade eletrotécnica.</p>
en	<p>Warning: Hazardous voltage! Refer to installation instructions. Disconnect and lock out power before working on this device. Attention! Installation by person with electrotechnical expertise only.</p>	ro	<p>Avertisment: Tensiune electrică periculoasă! Consultați instrucțiunile de utilizare. Deconectați și închideți sursa de energie înainte de a lucra cu acest dispozitiv. Atenție! Instalarea trebuie realizată doar de către o persoană cu expertiză electrotehnică.</p>
es	<p>Advertencia: ¡Tensión peligrosa! Consulte las instrucciones de instalación. Antes de trabajar con este dispositivo, desconecte y bloquee la corriente. ¡Atención! La instalación debe ser realizada únicamente por un técnico electricista.</p>	ru	<p>Предупреждение: Опасное электрическое напряжение! Обратитесь к инструкциям по монтажу. Отключите электропитание и обеспечьте безопасность перед началом работ. Внимание! Монтаж должен выполняться только специалистом по электротехническим работам.</p>
et	<p>Hoiatus: Elektrilöögi oht! Lisateavet vaadake kasutusjuhendist. Enne selle seadmega töötamist ühendage lahti ja lukustage toide. Tähelepanu! Seadet tohib paigaldada ainult elektrotehnilise kogemusega isik.</p>	sk	<p>Výstraha: Nebezpečné napätie! Pozrite si návod na použitie. Pred začatím prác na tomto zariadení odpojte a zablokujte napájanie. Pozor! Inštaláciu smie vykonávať len osoba s odbornými znalosťami v oblasti elektrotechniky.</p>
fi	<p>Varoitus: Vaarallinen jännite! Katso asennusohje. atkaise virta ja estä virran kytkeneminen lukituksella ennen töiden aloittamista. Huomio! Asennuksen saa suorittaa vain henkilö, jolla on kokemusta sähkötekniikasta.</p>	sl	<p>Opozorilo: Nevarna napetost! Glejte navodila za uporabo. Pred delom na tej napravi izklopite in zaklenite električno napajanje. Pozor! Namestitev sme izvesti samo elektrotehnični strokovnjak.</p>
fr	<p>Avertissement: Tension dangereuse! Consultez les consignes d'installation. Débranchez et verrouillez l'alimentation électrique avant d'entreprendre des travaux sur cet appareil. Attention! L'installation doit être effectuée uniquement par une personne ayant une expertise en électrotechnique.</p>	sv	<p>Varning: Livsfarlig spänning! Se i bruksanvisningen. Frånkoppla och blockera anläggning eller en anläggningsdel innan arbete utförs. Obs! Får endast installeras av behörig elektriker.</p>
hr	<p>Upozorenje: Opasan napon! Pogledajte upute za ugradnju. Odspojite i isključite struju prije rada na ovom uređaju. Pažnja! Ugradnja je dopuštena samo osobama stručnim u području elektrotehnike.</p>	tr	<p>Uyarı: Tehlikeli gerilim! Montaj talimatlarına bakın. Bu cihaz üzerinde çalışmadan önce elektriği kesin ve kilitleyin. Dikkat! Yalnızca elektroteknik uzmanlığa sahip kişiler tarafından kurulabilir.</p>
hu	<p>Figyelmeztetés: Veszélyes feszültség! Lásd a használati utasítást. Válassza le és zárja ki az áramellátást, mielőtt a berendezésen dolgozni kezd. Figyelem! Az üzembe helyezés csak elektrotechnikai szakértelemmel rendelkező személy végezheti el.</p>	zh	<p>警告: 高压危险! 请参见操作手册。操作本设备前请断开并锁定电源。注意! 安装仅限专业电工人员。</p>

ReliaGear neXT

Power Panelboards

Disclaimer

The information presented in this publication does not form part of any quotation or contract, is believed to be accurate and reliable and may be changed without notice. No liability will be accepted by the publisher for any consequences of its use. Publication thereof does not convey nor imply any license under patent - or other industrial or intellectual - property rights.

Target audience

This document is intended for ABB customers and for professional recyclers.

Packaging

You can recycle all packaging materials. To avoid pollution caused by unnecessary transportation, the factory does not take back used packages. Contact your local ABB office for package recycling instructions if needed. ABB recommends package recycling as it preserves raw materials and reduces waste being landfilled.

Product manuals and sales brochures

To save natural resources and reduce paper waste, all product manuals are available in ABB Library and on the Internet.

Disposal

The main parts of the panelboard can be recycled to preserve natural resources and energy. Product parts and materials should be dismantled and separated. Generally all metals, such as steel, aluminum, copper and its alloys, and precious metals can be recycled as material. Plastics, rubber, cardboard and other packaging material can be used in energy recovery.

To aid recycling, plastic parts are marked with an appropriate identification code. Contact your local ABB distributor for further information on environmental aspects. End of life treatment must follow international and national regulations.

Materials of Panelboard Fronts, Gutter Covers, and Fillers

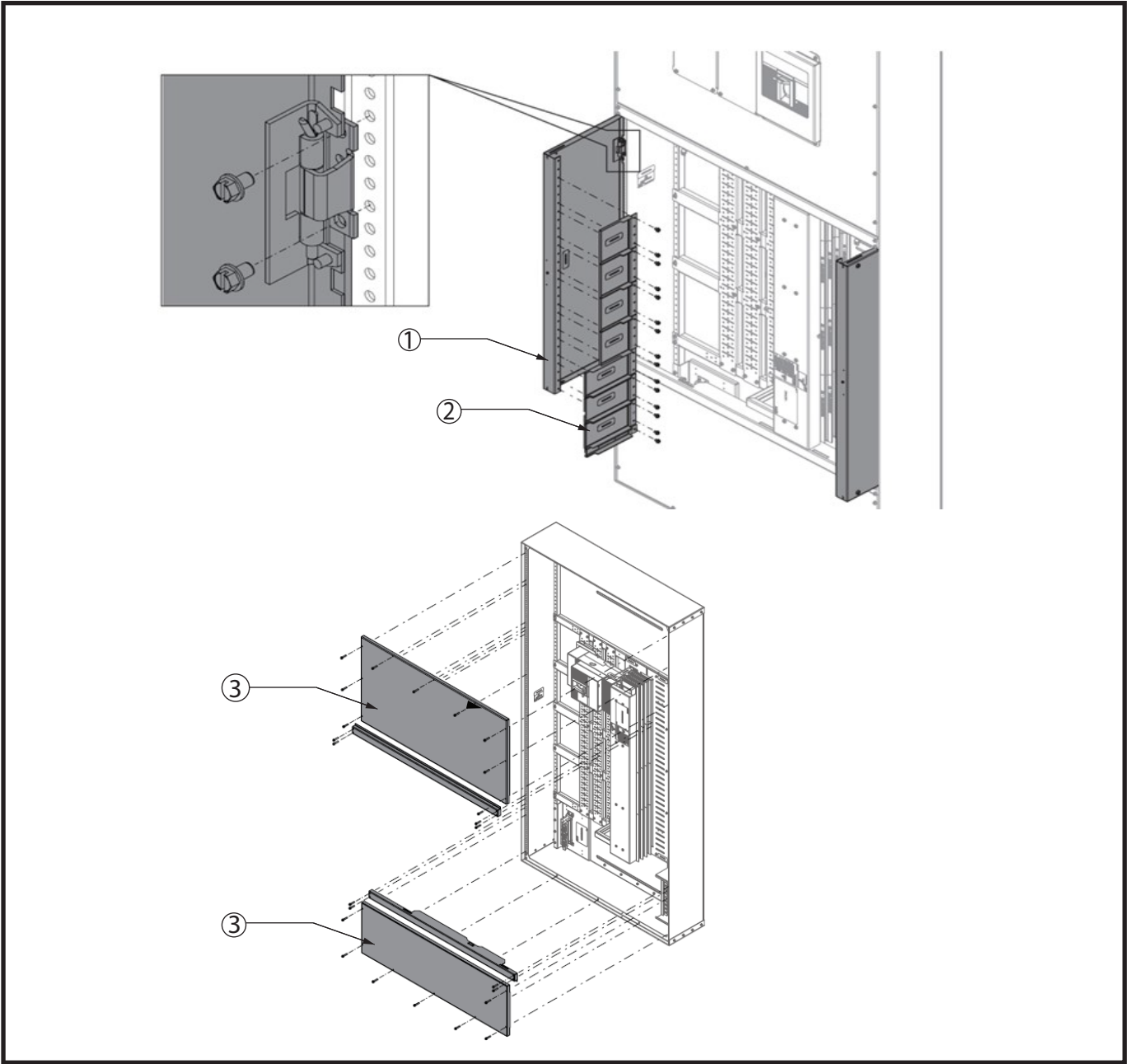

No.	Parts	Catalog Identifier	Category	Materials
1	Gutter Covers	GC *	Metal	Steel
2	Spacers - Fillers	SR *	Metal	Steel
3	Front Covers	FT *	Metal	Steel

Materials of Panelboard Door-in-Door Front

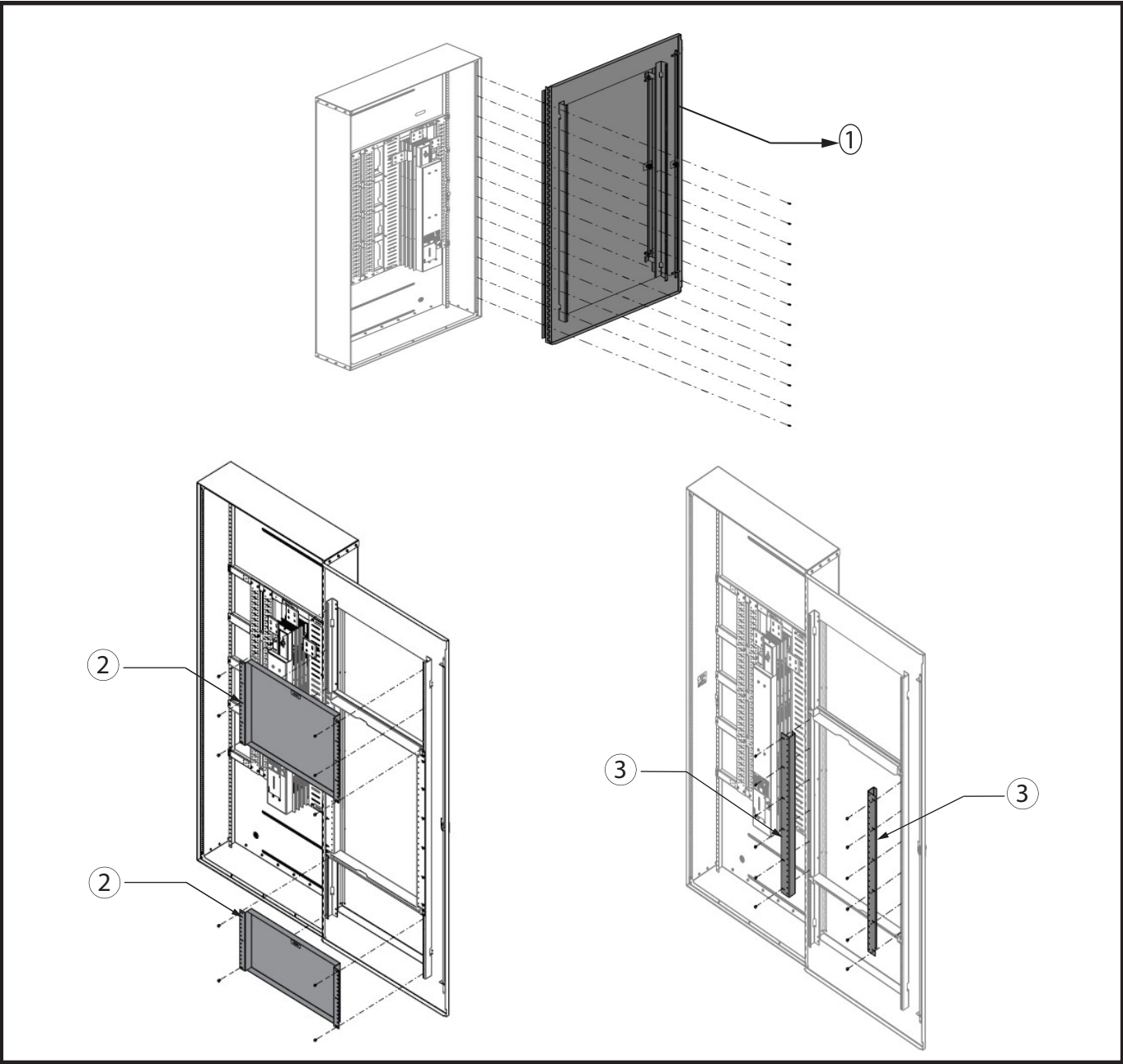

No.	Parts	Catalog Identifier	Category	Materials
1	Door-in-Door Deadfront	DD*	Metal	Steel
2	Door-in-Door Fillers	DDFIL*	Metal	Steel
3	Door-in-Door Support Rails	DDSUP*	Metal	Steel

Materials of Panelboard Neutrals and Grounds

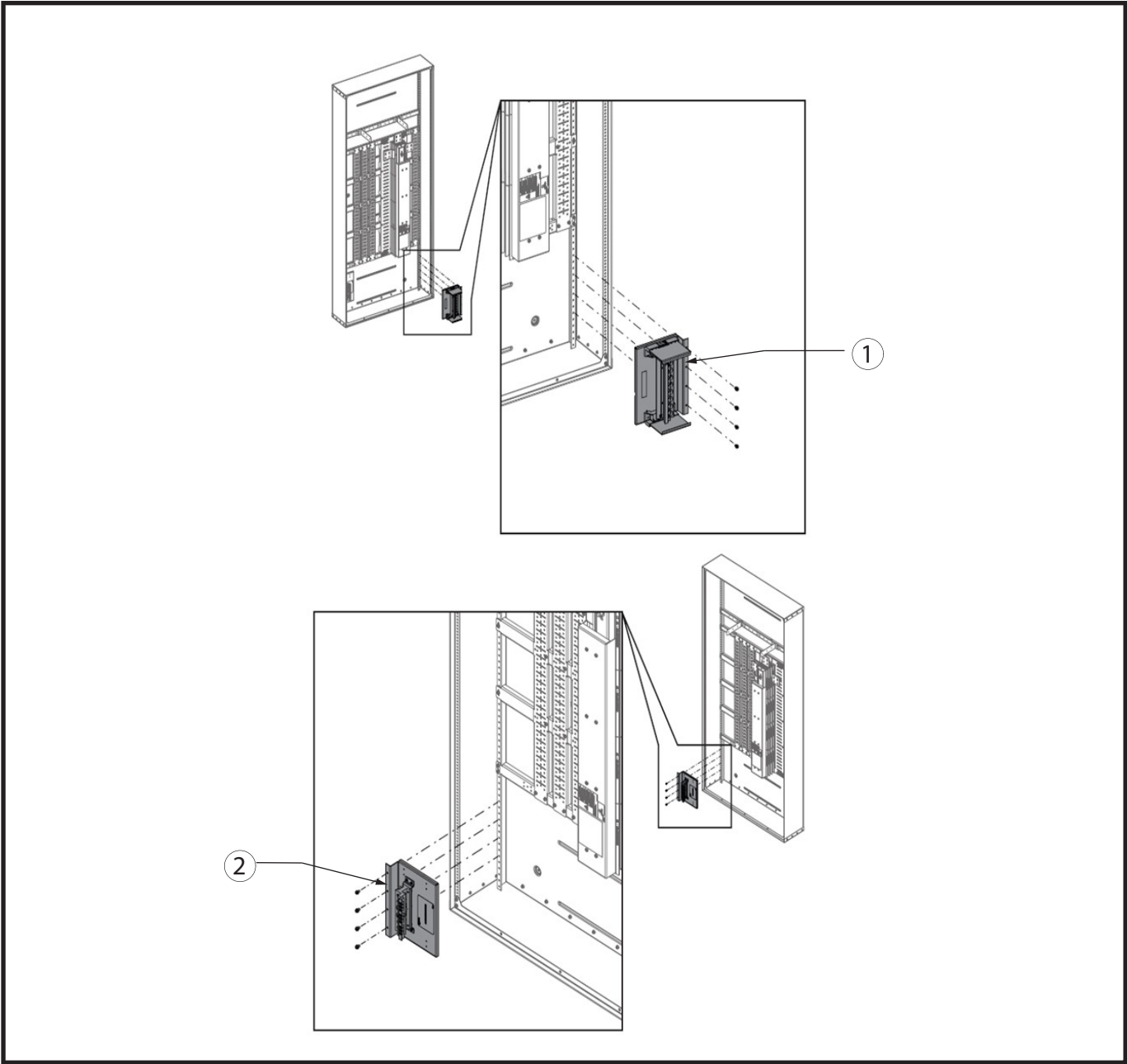

No.	Parts	Catalog Identifier	Category	Materials
1	Neutral	NL*	Metal	Copper/Aluminum, Steel
2	Ground	GD*	Metal	Copper/Aluminum, Steel

Materials of Panelboard Main Lugs and Barrier Posts

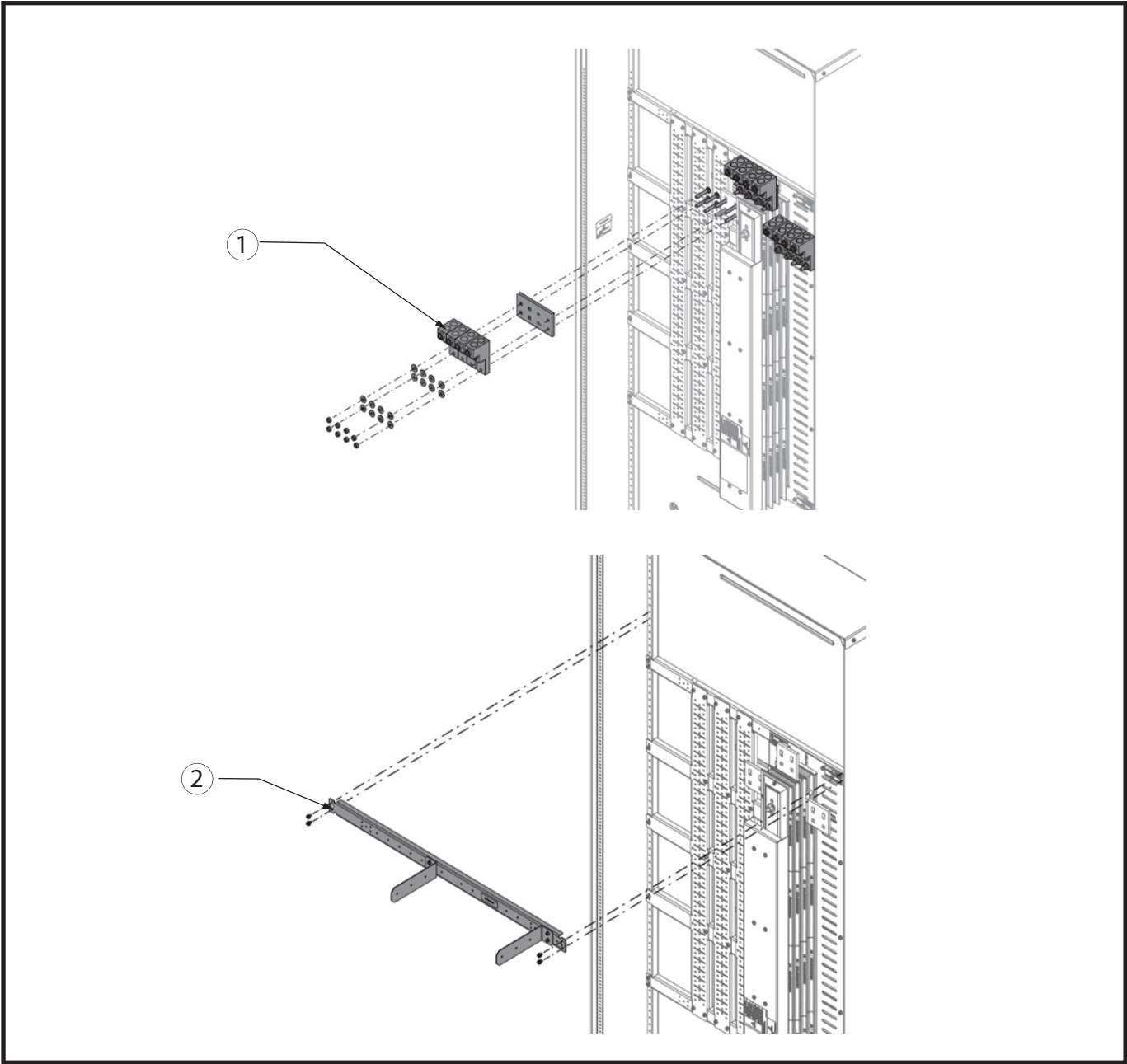

No.	Parts	Catalog Identifier	Category	Materials
1	Lugs	LG*	Metal	Copper/Aluminum
2	Barrier Posts	BP*	Metal	Steel

Materials of Panelboard Horizontal Breakers / Vertical Main Breakers

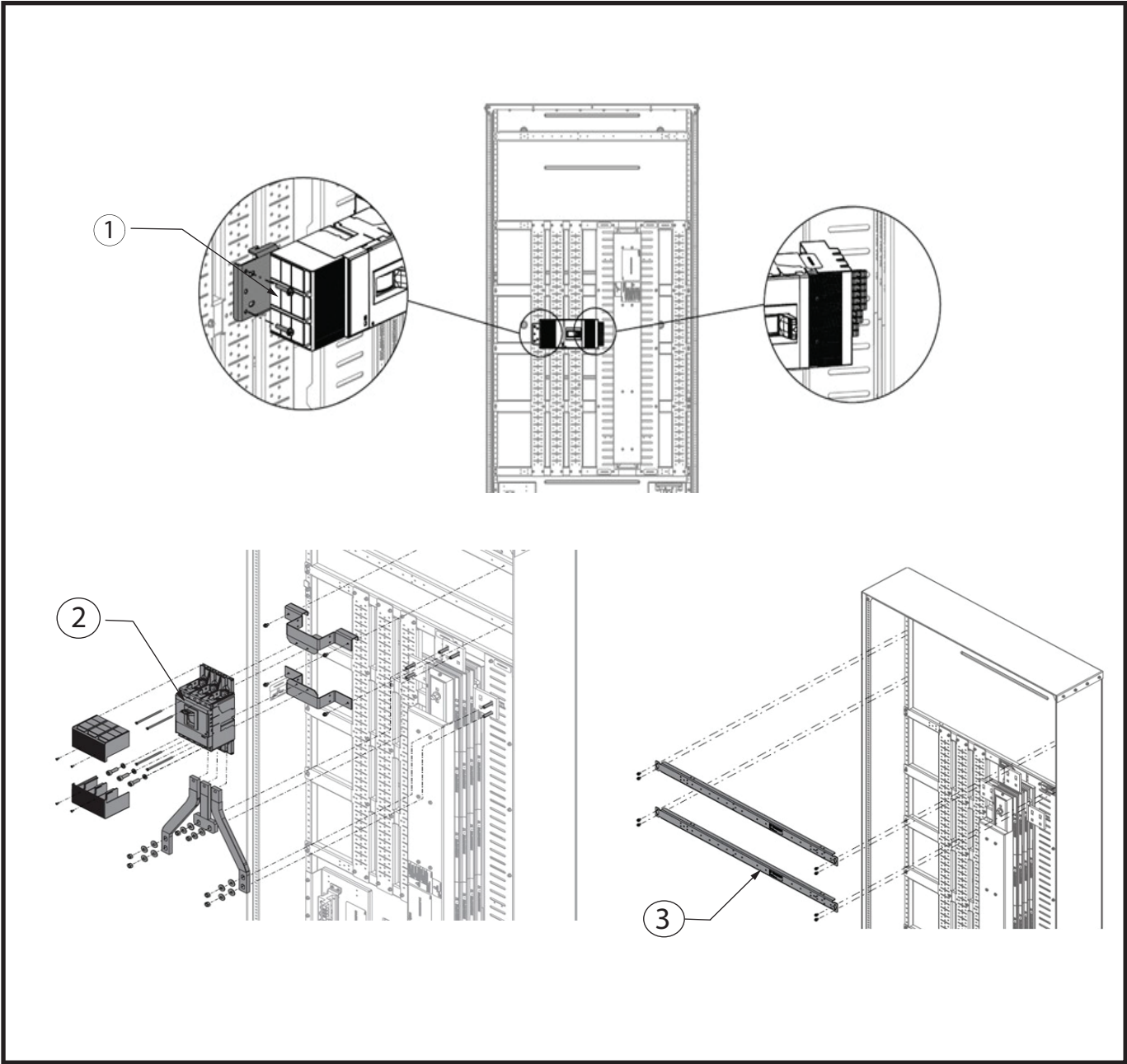

No.	Parts	Catalog Identifier	Category	Materials
1	Horizontal Breaker	XT*,A2*,TEY*,NEFB*	Electrical	Copper, Steel, Plastic
2	Vertical Main Breaker Kit	XT*,VM*	Electrical	Copper, Steel, Plastic
3	Vertical Main Mounting Rail	VMR*	Metal	Steel

Catalog numbers identified as Electrical contain additional electrical devices - separate disassembly guides should be referenced for these devices.

Materials of Panelboard Blanks and Interior Lifting Kits

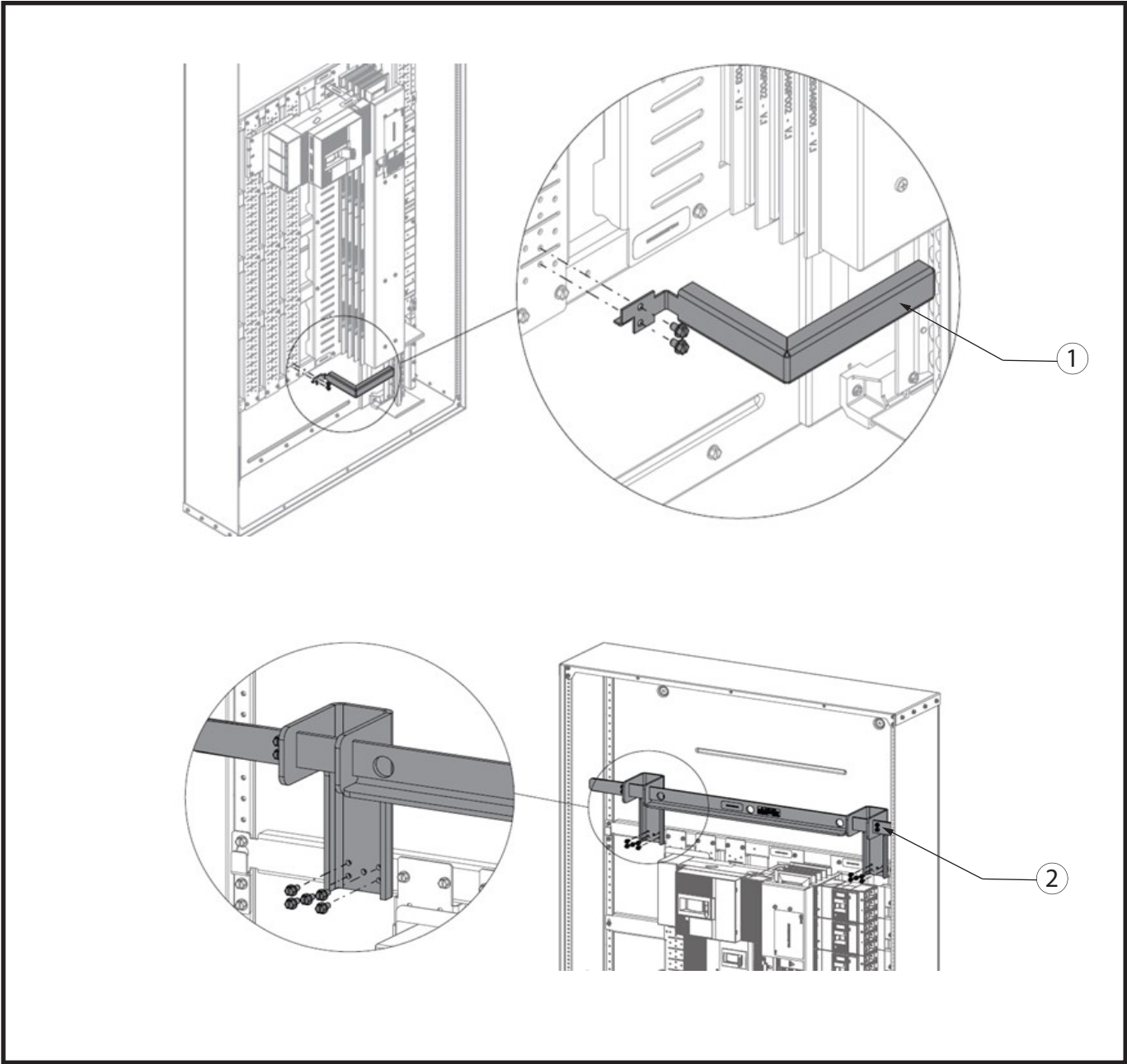

No.	Parts	Catalog Identifier	Category	Materials
1	Spacers - Blanks	SR*	Metal	Steel
2	Interior Lifting Kit	IL *	Metal	Steel

Materials of Panelboard RELT and SPD Accessories

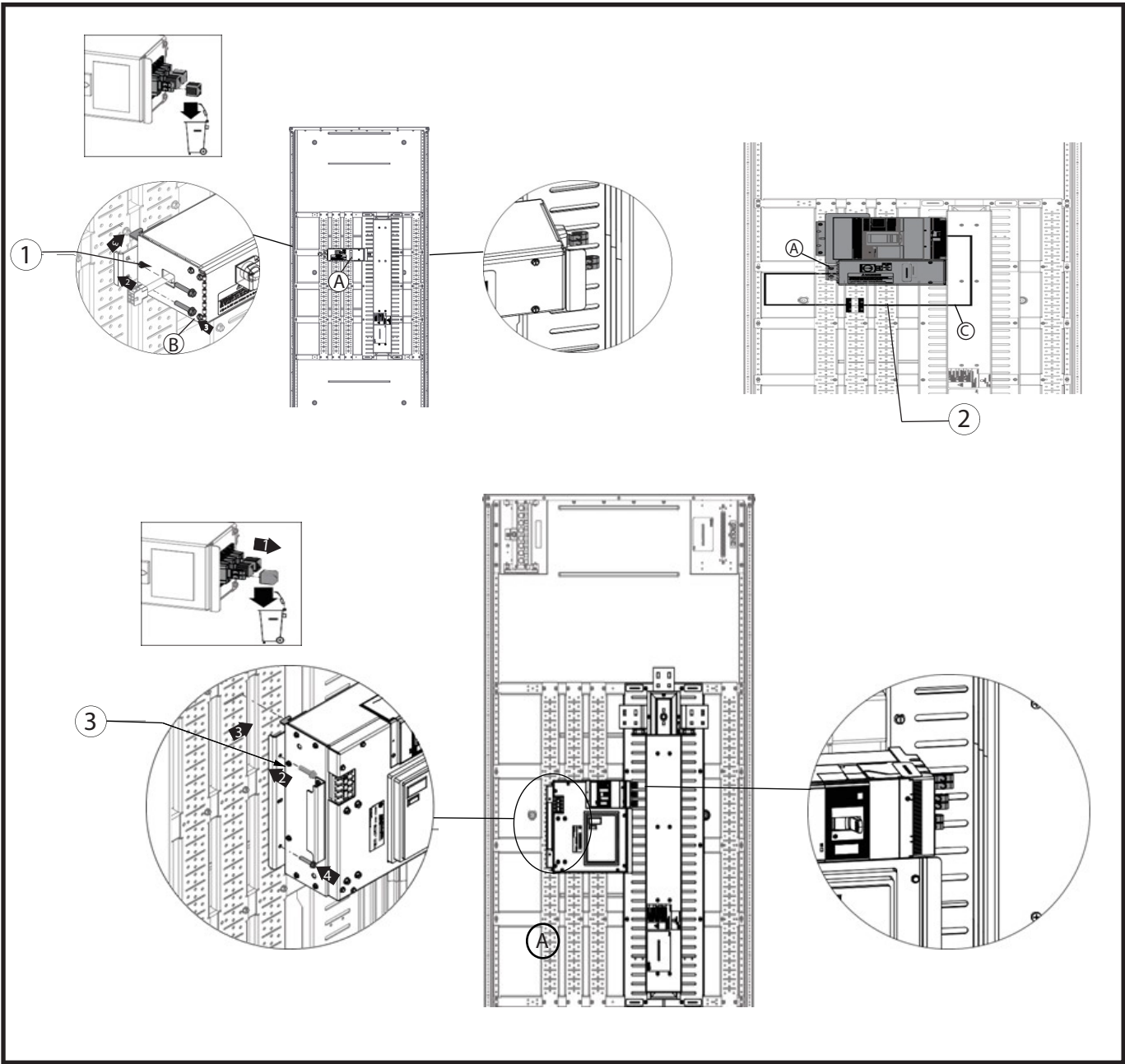

No.	Parts	Catalog Identifier	Category	Materials
1	RELT Module	RT*	Electrical	Copper, Steel, Plastic
2	Wire Connector Kit	CN*	Electrical	Copper (wires), Plastic
3	SPD Module	SP*	Electrical	Copper, Steel, Plastic

Catalog numbers identified as Electrical contain additional electrical devices - separate disassembly guides should be referenced for these devices.

Materials of Panelboard Metering Accessory

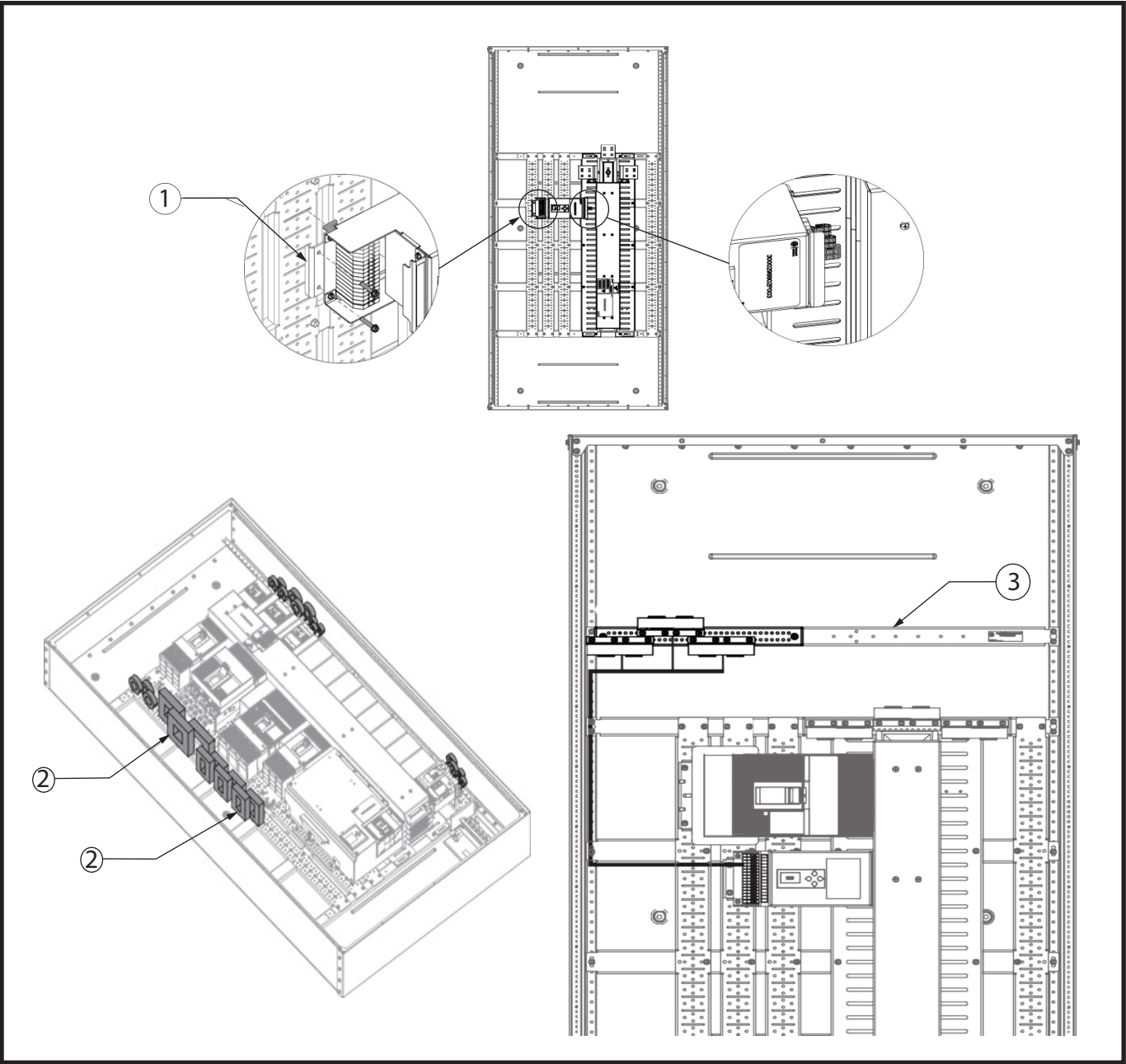

No.	Parts	Catalog Identifier	Category	Materials
1	Meter Module	MT04* , RGM*	Electrical	Copper, Steel, Plastic
2	Meter CT Kit	MTA*	Electrical	Copper, Steel, Plastic
3	Meter CT Mounting Kit	MT4*	Metal	Steel

Catalog numbers identified as Electrical contain additional electrical devices - separate disassembly guides should be referenced for these devices.

Materials of Panelboard Service Entrance Barriers and IP20 Main Lug Barrier

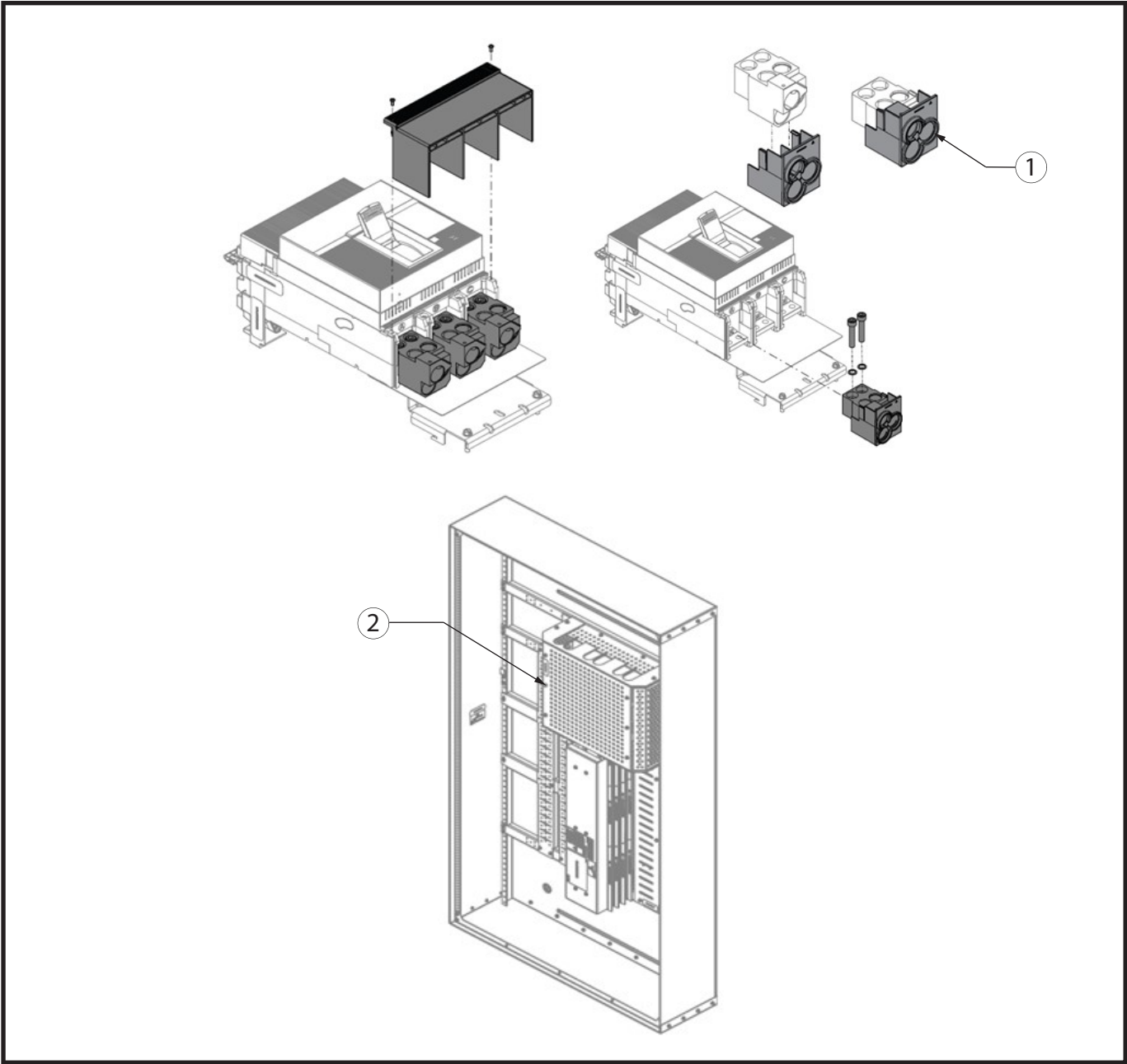

No.	Parts	Catalog Identifier	Category	Materials
1	Service Entrance Barriers	SB*	Plastic	Plastic
2	IP20 Main Lug Barrier	IP20B*	Metal/Plastic	Plastic, Steel

Materials of Panelboard Bus, Frame, and Enclosure

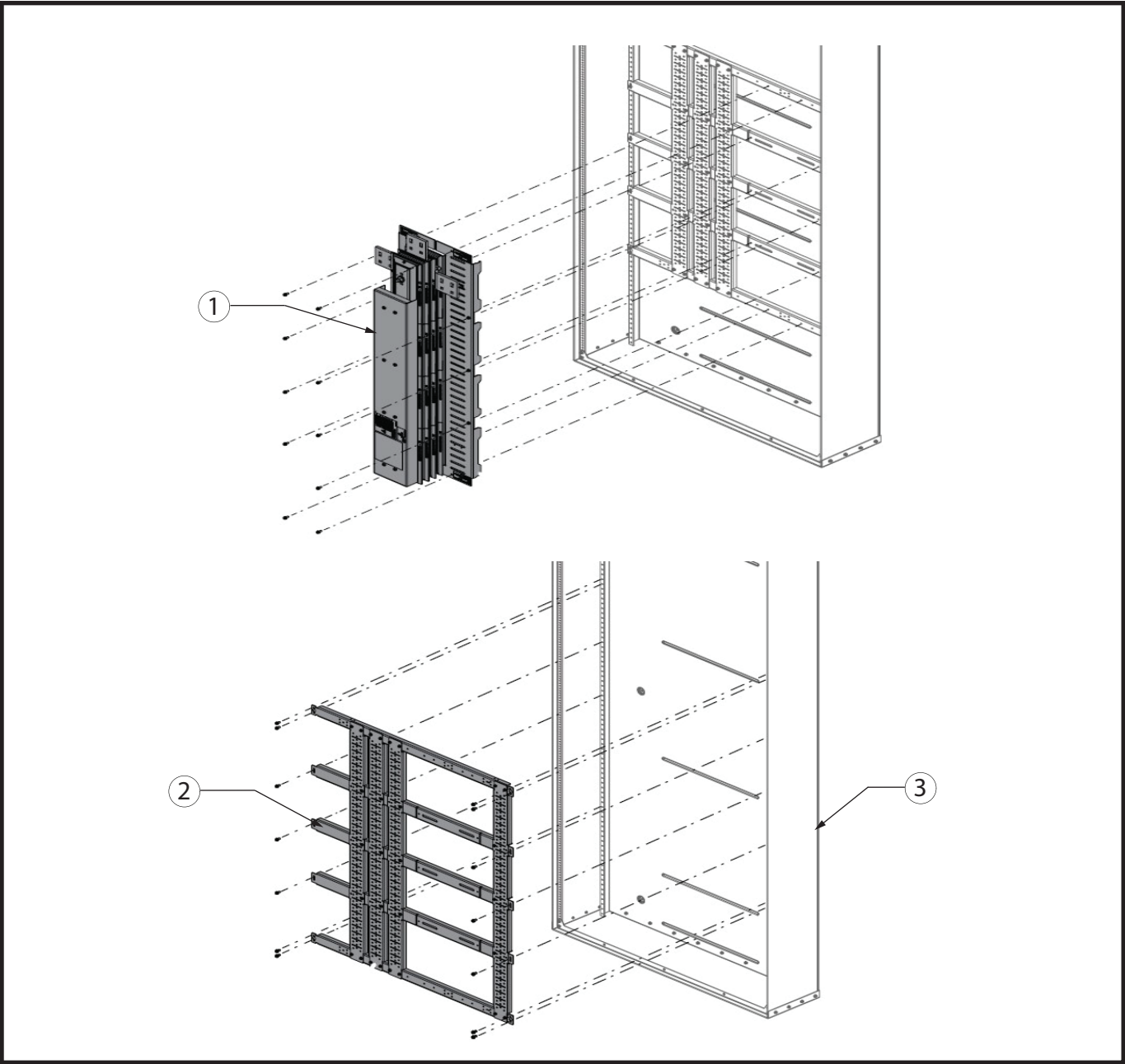

No.	Parts	Catalog Identifier	Category	Materials
1	Panelboard Bus Stack	IN*	Metal/Plastic	Copper, Steel, Plastic
2	Interior Frame	IF*	Metal	Steel
3	Enclosure	ER*	Metal	Steel

US
ABB Inc.
305 Gregson Drive
Cary, NC 27511

Link:
<https://new.abb.com/low-voltage/launches/reliagear-next>

Revision
A

Revision Date
7/12/2024

Document Number
15QC900026M0201

© Copyright 2024 ABB.
All rights reserved.
Specifications subject
to change without notice.