

CONNECTION FOR E4.2 3200A WITHDRAWABLE (COUPLER COLUMN)

SPEP P = 900mm
BUSBARS HOLDER PBHB3121 (100mm)

MAIN BUSBAR IP40 / IP41 / IP65 : 3200A (3x100x10)

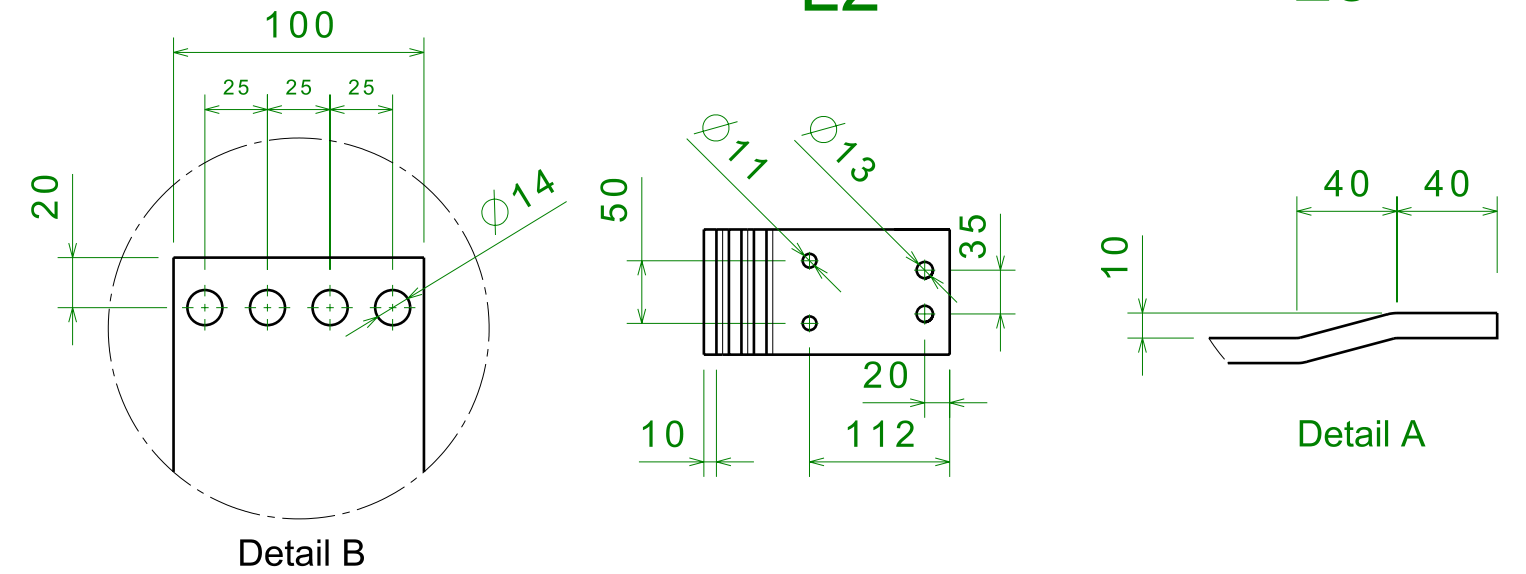
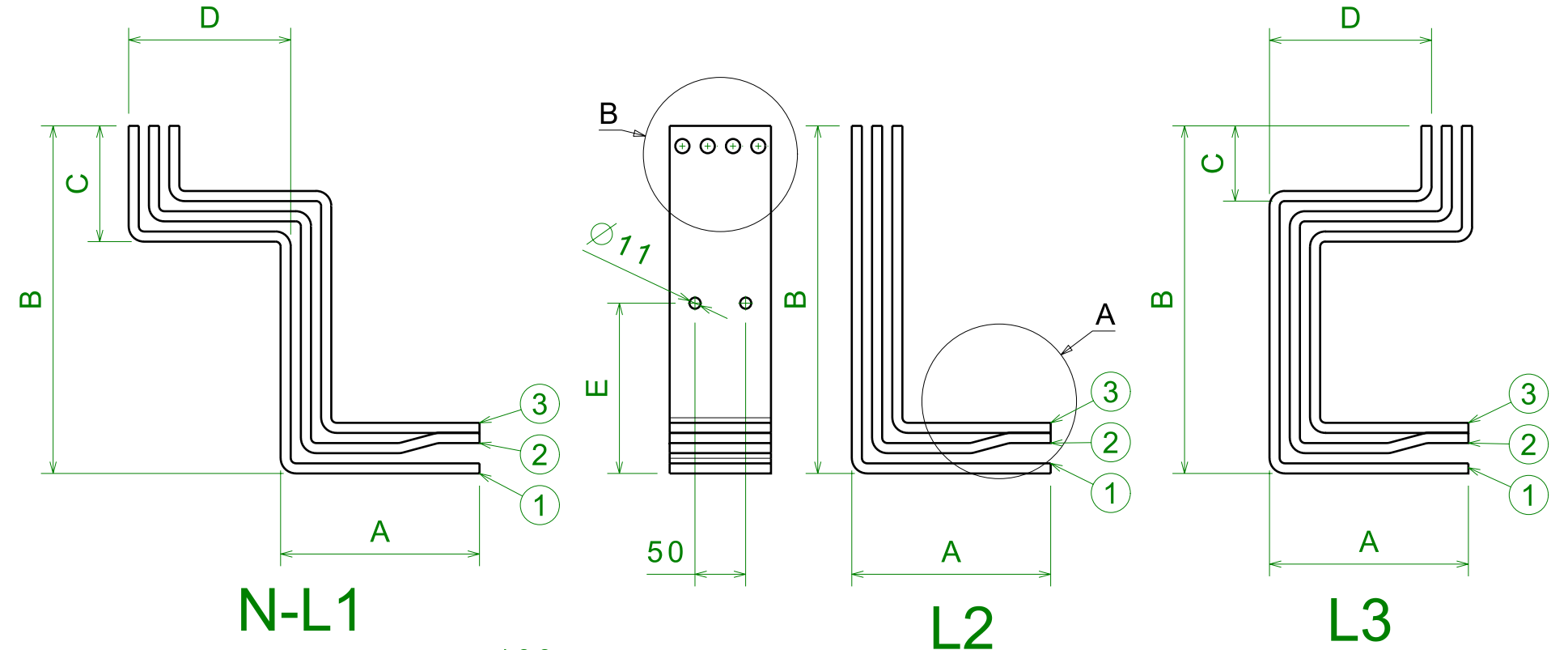
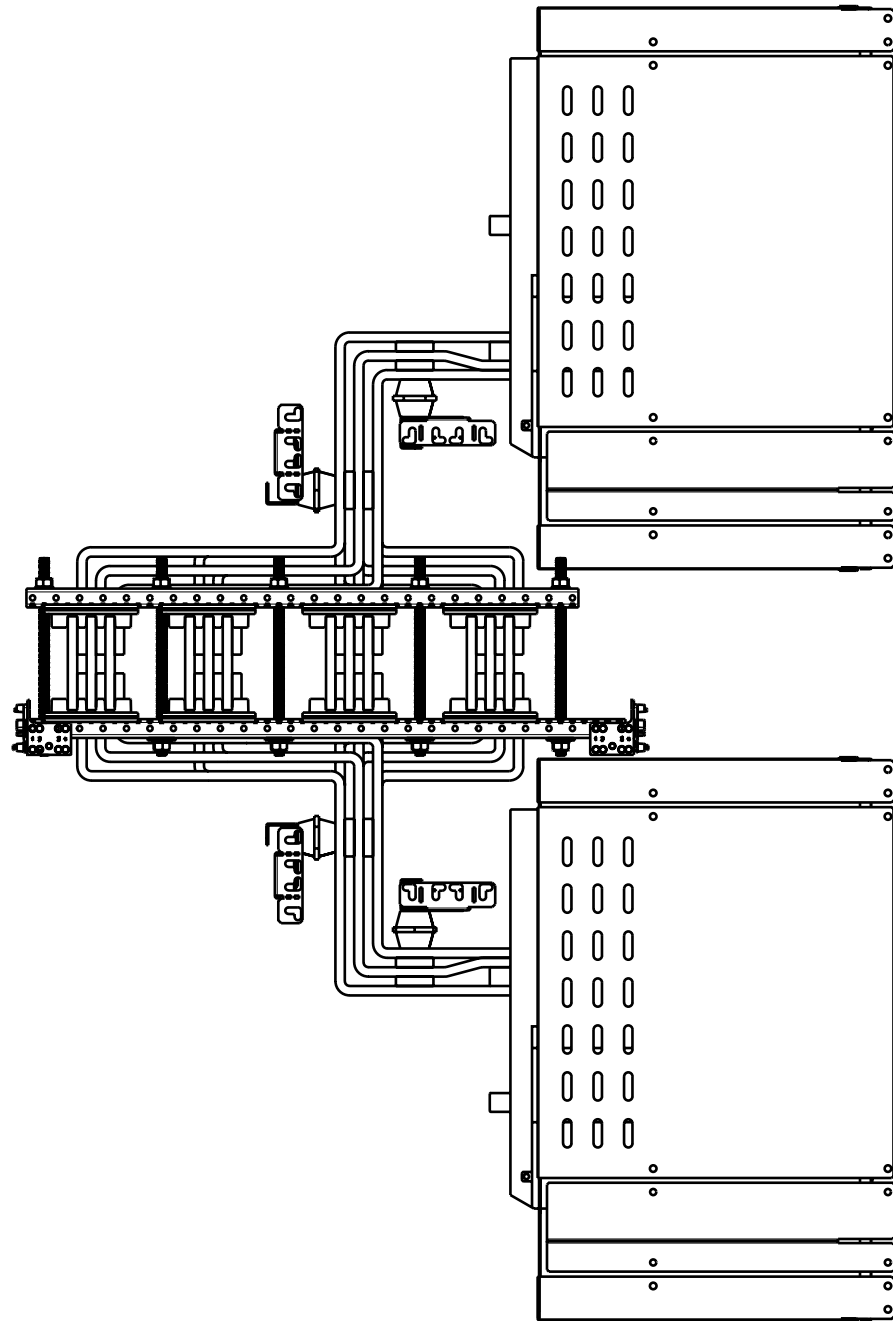

PHASE	POS	A	B	C	D	E
L3	1 L3.1	196.4	343	74.25	160	168
	2 L3.2	176.4	323	94.25	160	148
	3 L3.3	156.4	303	114.25	160	128
L2	1 L2.1	196.4	343	-	-	168
	2 L2.2	176.4	323	-	-	148
	3 L2.3	156.4	303	-	-	128
L1	1 L1.1	196.4	343	114.25	160	168
	2 L1.2	176.4	323	94.25	160	148
	3 L1.3	156.4	303	74.25	160	128
N	1 N.1	196.4	343	114.25	285	168
	2 N.2	176.4	323	94.25	285	148
	3 N.3	156.4	303	74.25	285	128

SCALA SCALE	: 1:6	N° PROGETTO : PROJECT	XXX.XX
DISEGNATORE DESIGNER	:	ABB SACE ADB	
APPROVAZIONE APPROVAL	:	DISEGNO N° /DRAWING N°	
DATA DATE	: XX-XX-XX	E4.2 3200A WITHDRAWABLE (COUPLER COLUMN) CONNECTION BUSBARS 3x100x10XP	
FORMATO FORMED	Formato A3 Formed	8 6 3 8 2 7	

Questo disegno e' di esclusiva proprieta' di ABB SACE ADB. Ne e' vietata la riproduzione a termini di legge.

HOLDER FOR 36<I_{cw}<=50KA

Vista isometrica
Scala: 1:8

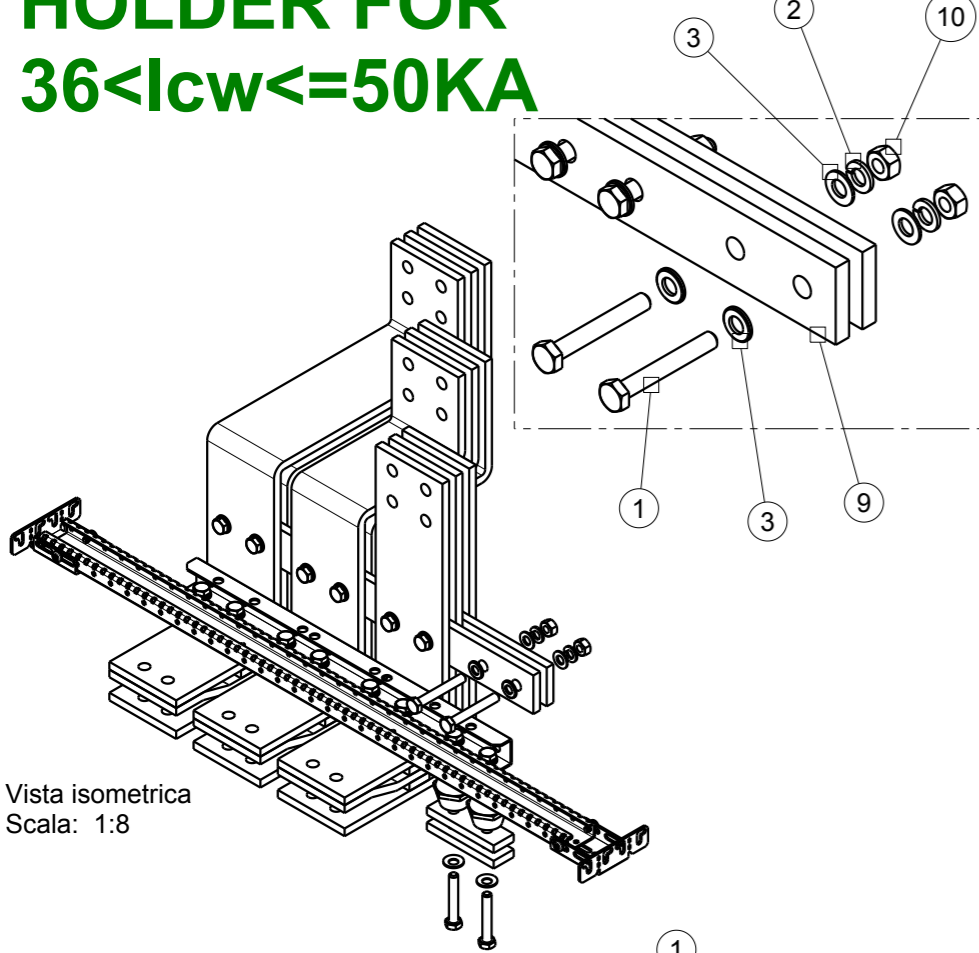

BOM 36<I_{cw}<=50KA

POS	DESCRIPTION
1	HEX CAP SCREWS M10x16 - 8.8 (VITE TESTA ESAGONALE M10x16 - 8.8)
2	FLAT WASHER M10 (RONDELLA PIANA M10)
3	SPRING LOCK WASHER M10 (ROSETTA ELASTICA GROWER M10)
4	BRACKET FOR INSULATOR (STAFFA ISOLATORI)
5	INSULATOR H40 M10 (ISOLATORI H40 M10)
6	CUPPER SPACER H10mm (SPESSORE IN RAME H10mm)
7	CONICAL SPRING WASHER M10 (ROSETTE ELASTICHE CONICHE M10)
8	HEX CAP SCREWS M10x__ - 8.8 (VITE TESTA ESAGONALE M10x__ - 8.8)
9	GPO3 PROFILE
10	NUT M10 - DADO M10

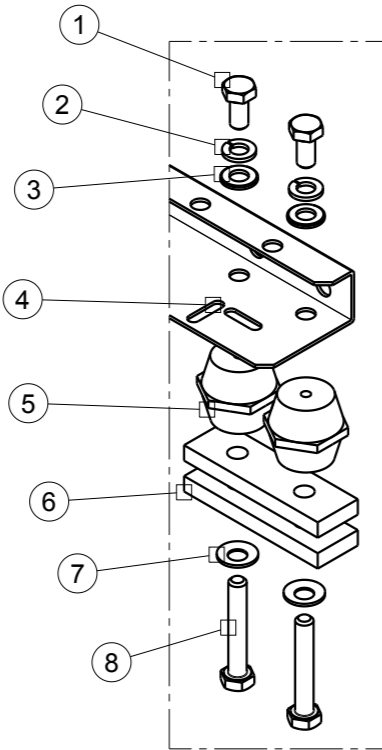

HOLDER FOR 50<I_{cw}<=75KA

Vista isometrica
Scala: 1:8

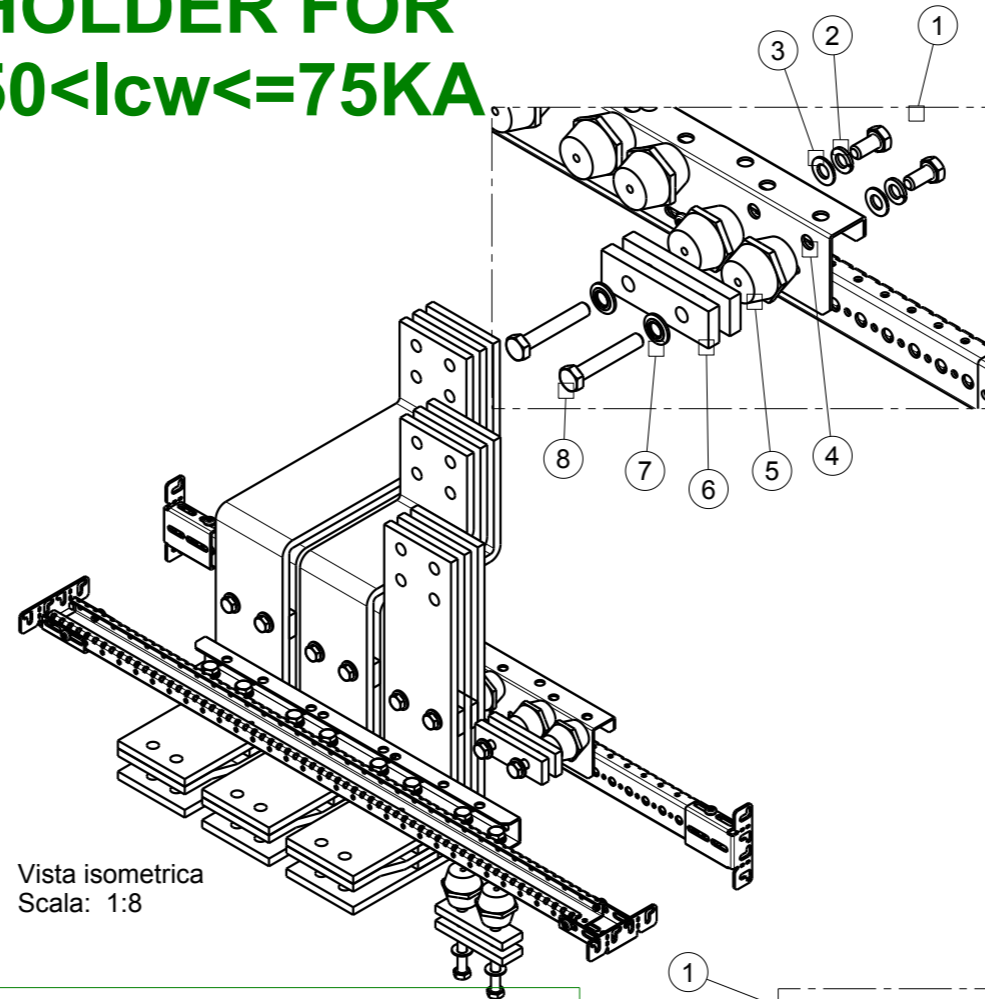

BOM 50<I_{cw}<=75KA

POS	DESCRIPTION
1	HEX CAP SCREWS M10x16 - 8.8 (VITE TESTA ESAGONALE M10x16 - 8.8)
2	FLAT WASHER M10 (RONDELLA PIANA M10)
3	SPRING LOCK WASHER M10 (ROSETTA ELASTICA GROWER M10)
4	BRACKET FOR INSULATOR (STAFFA ISOLATORI)
5	INSULATOR H40 M10 (ISOLATORI H40 M10)
6	CUPPER SPACER H10mm (SPESSORE IN RAME H10mm)
7	CONICAL SPRING WASHER M10 (ROSETTE ELASTICHE CONICHE M10)
8	HEX CAP SCREWS M10x__ - 8.8 (VITE TESTA ESAGONALE M10x__ - 8.8)
9	GPO3 PROFILE

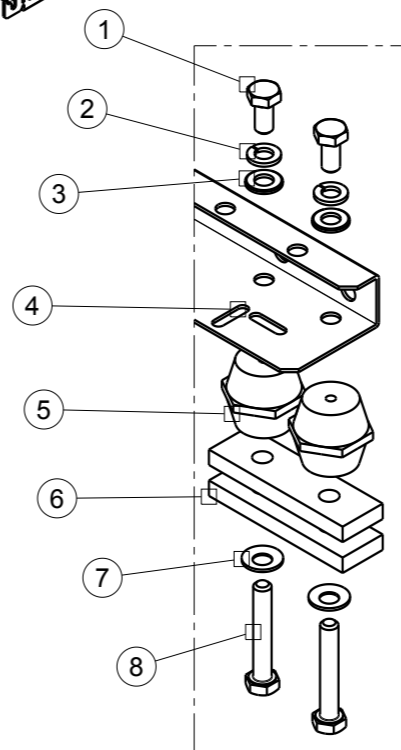

HOLDER FOR I_{cw} >75KA

Vista isometrica
Scala: 1:8

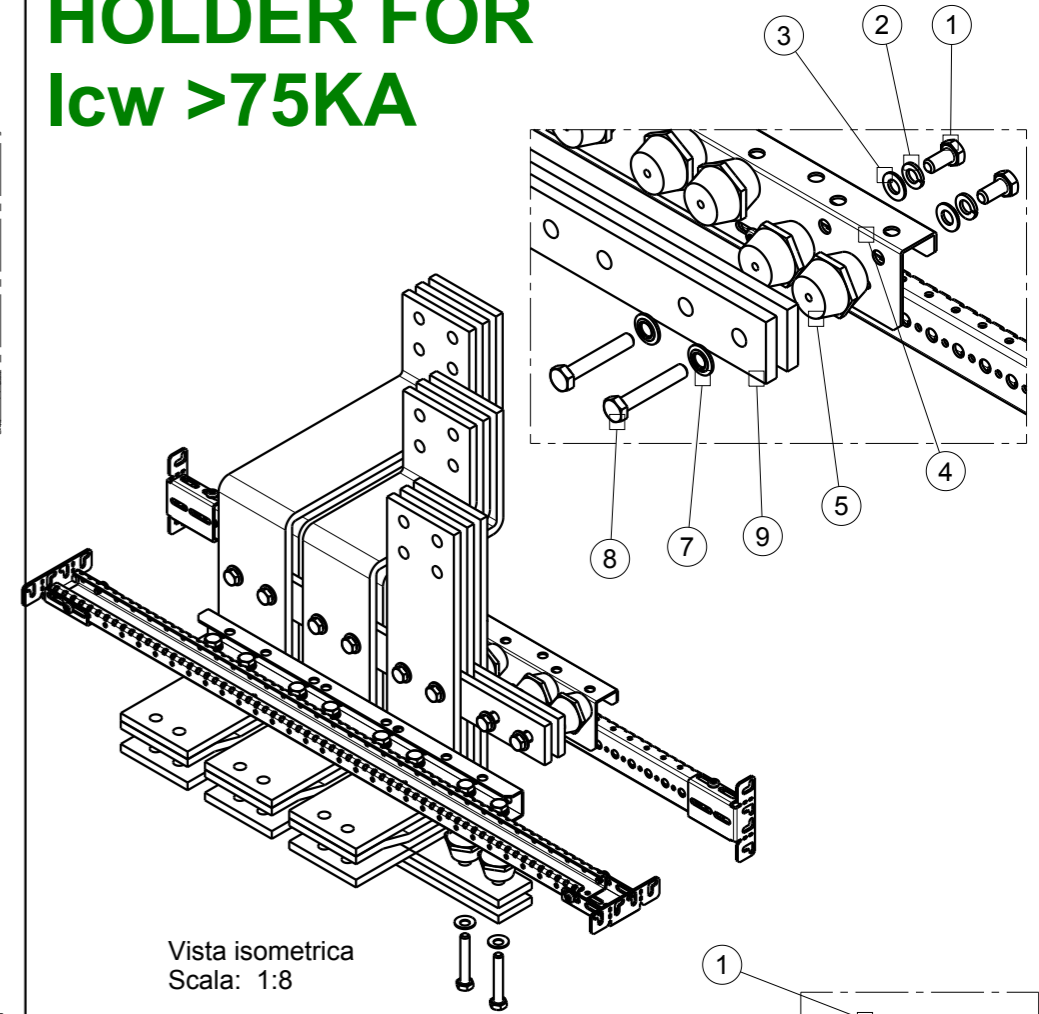

BOM I_{cw}>75KA

POS	DESCRIPTION
1	HEX CAP SCREWS M10x16 - 8.8 (VITE TESTA ESAGONALE M10x16 - 8.8)
2	FLAT WASHER M10 (RONDELLA PIANA M10)
3	SPRING LOCK WASHER M10 (ROSETTA ELASTICA GROWER M10)
4	BRACKET FOR INSULATOR (STAFFA ISOLATORI)
5	INSULATOR H40 M10 (ISOLATORI H40 M10)
6	CUPPER SPACER H10mm (SPESSORE IN RAME H10mm)
7	CONICAL SPRING WASHER M10 (ROSETTE ELASTICHE CONICHE M10)
8	HEX CAP SCREWS M10x__ - 8.8 (VITE TESTA ESAGONALE M10x__ - 8.8)
9	GPO3 PROFILE

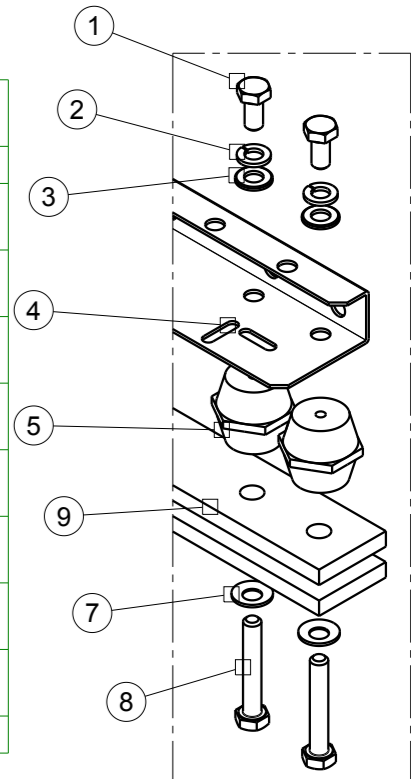

GPO3 PROFILE

E1.2 4P

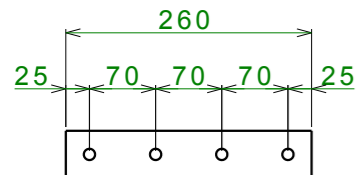

E2.2 4P

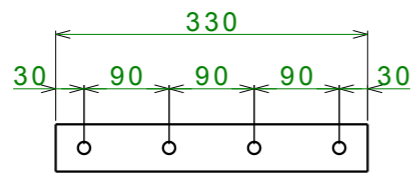

E4.2 4P

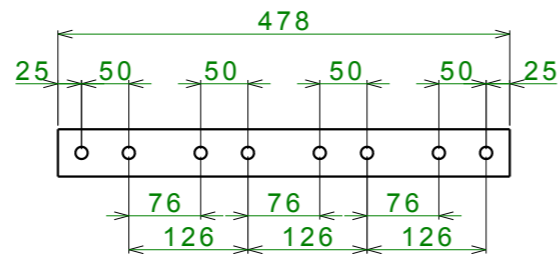

801

FIG.

DIMENSIONI / DIMENSION

PESO / WEIGHT

mm

UNITA' DI MISURA
UNITS OF MEASUREMENT

AGG. DI SEGNO DISTR. MOD.	SCALA SCALE	MAT. / MAT. :
VERSIONE VERSION	DISEGNATO DA DRAW BY	TRATT. / TREAT :
DATA DATE	APPROVAZIONE APPROVAL	PROGETTO N° : PROJECT N° : 142.00
	ABB	ABB SACE ADB
	Formato Format A3	DESCRIZIONE / DESCRIPTION: DIVERSI TIPI DI ANCORAGGIO DIFFERENT TYPES OF SUPPORT

DISEGNO N° / DRAWING N°

863877