

Issue 07/25/2018

Date:

Page: 1 of 2

File: PSS-K676CY-BUS

15/25kV	900A Deadbreak Separable “Y” Joint-BUS	w/ Test Point	K676CY-BUS
---------	---	---------------	------------



Features:

- **15/25kV, 900A Deadbreak rated separable connector**
- **Design with Compression or Shear bolt connectors**
- **Fully shielded, fully submersible, 100% peroxide cured EPDM molded rubber and electrolytic Copper**
- **Reusable components reduce inventory and other costs**
- **Includes integral capacitive test point**

K676CY-BUS Deadbreak Separable “Y” Joint-BUS

Applications:

Elastimold® separable cable joints are modular kits: 2-way, 3-way or 4-way insulated bus bars and retractable straight receptacle housings. The K676CY-BUS separable “Y” joint is based on 3-way bus bar. The cables are bolted via compression lug or shear bolt connectors to the bar. The straight receptacle house slides over the connections to form a fully shielded, fully submersible 3-way disconnectable cable joint. The K676CY-BUS cable joint is used to join cables in a disconnectable 3-way joint. It is compact size and ideal for small vaults and manholes application.

K676CY-BUS is modular and ideal where separable components are required to accommodate future system circuit changes or expansions. It can also be used initially as 3-way joint with insulated caps on the unused interfaces. The K676CY-BUS can also be used in direct buried applications.

Ratings:

Meets ANSI/IEEE Standard 386, Latest Revision

For 15kV Voltage Class:

8.3kV Max Phase-to-Ground – Operating Voltage
 14.4kV Max Phase-to-Phase
 95kV BIL – Impulse Withstand (1.2 x 50 microsecond wave)
 34kV AC – One minute withstand
 53kV DC – 15 minutes withstand
 11kV AC – Corona Extinction @ 3pC sensitivity
900 Amp – Continuous
 25kA Sym – 10 Cycles Momentary

For 25kV Voltage Class:

16.2kV Max Phase-to-Ground – Operating Voltage
 28kV Max Phase-to-Phase
 140kV BIL – Impulse Withstand (1.2 x 50 microsecond wave)
 45kV AC – One minute withstand
 84kV DC – 15 minutes withstand
 21kV AC – Corona Extinction @ 3pC sensitivity
900 Amp – Continuous
 25kA Sym – 10 Cycles Momentary

Issue: 07/25/2018
Date:
Page: 2 of 2
File: PSS-K676CY-BUS

15/25kV	900A Deadbreak Separable "Y" Joint-BUS	w/ Test Point	K676CY-BUS
---------	---	---------------	------------

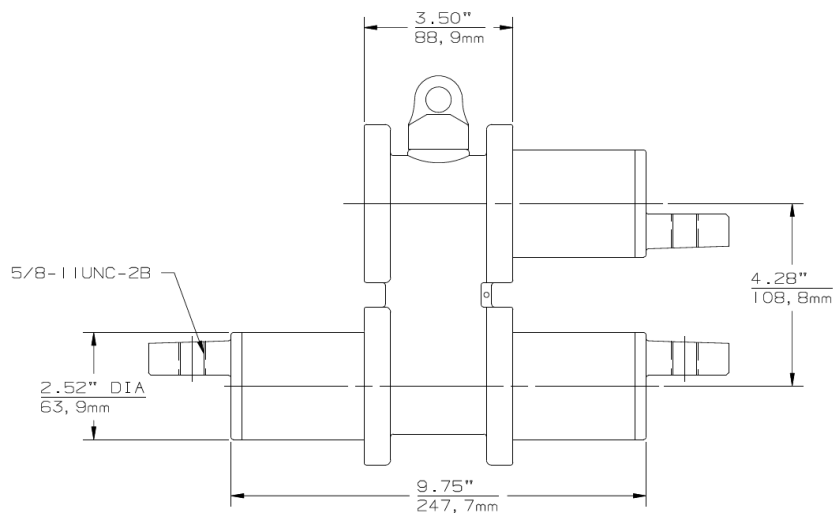

Contents:

- 1 3-Way Bus Bar K676CY-BUS
- 2 Si-Lubricant 82-08
- 1 Installation Instruction IS-1074