

FurseWELD

Cable to earth rod CR2

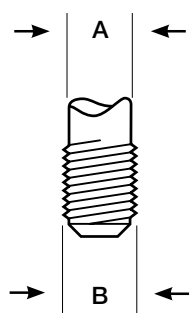
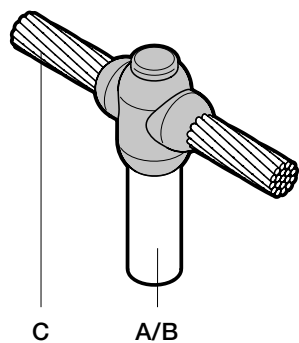

Cable to earth rod CR2 - FurseWELD

Earth rod A Ø (mm)	Earth rod B Ø (")	Stranded/ solid circular conductor size C (mm ²)	Part no.				
			Powder cartridge	Standard mould	Handle clamp	Mini mould	Mini handle clamp
12.7	½	16 *	90P10	CR2-4-12716	HCPK4	CR2-3-12716	HCPK3
12.7	½	25	90P10	CR2-4-12725	HCPK4	CR2-3-12725	HCPK3
12.7	½	35	90P10	CR2-4-12735	HCPK4	CR2-3-12735	HCPK3
12.7	½	50	90P10	CR2-4-12750	HCPK4	CR2-3-12750	HCPK3
12.7	½	Ø 8	90P10	CR2-4-1278SC	HCPK4	CR2-3-1278SC	HCPK3
12.7	½	70	90P10	CR2-4-12770	HCPK4	CR2-3-12770	HCPK3
12.7	½	95	115P10	CR2-4-12795	HCPK4	CR2-3-12795	HCPK3
12.7	½	120	150P10	CR2-4-127120	HCPK4	-	-
14.2	¾	16 *	90P10	CR2-4-14216	HCPK4	CR2-3-14216	HCPK3
14.2	¾	25	90P10	CR2-4-14225	HCPK4	CR2-3-14225	HCPK3
14.2	¾	35	90P10	CR2-4-14235	HCPK4	CR2-3-14235	HCPK3
14.2	¾	50	90P10	CR2-4-14250	HCPK4	CR2-3-14250	HCPK3
14.2	¾	Ø 8	90P10	CR2-4-1428SC	HCPK4	CR2-3-1428SC	HCPK3
14.2	¾	70	115P10	CR2-4-14270	HCPK4	CR2-3-14270	HCPK3
14.2	¾	95	115P10	CR2-4-14295	HCPK4	CR2-3-14295	HCPK3
14.2	¾	120	150P10	CR2-4-142120	HCPK4	-	-
14.2	¾	150	200P10	CR2-4-142150	HCPK4	-	-
14.2	¾	185	200P10	CR2-4-142185	HCPK4	-	-
14.2	¾	240	250P10	CR2-4-142240	HCPK4	-	-
17.2	¾	16 *	90P10	CR2-4-17216	HCPK4	CR2-3-17216	HCPK3
17.2	¾	25	90P10	CR2-4-17225	HCPK4	CR2-3-17225	HCPK3
17.2	¾	35	90P10	CR2-4-17235	HCPK4	CR2-3-17235	HCPK3
17.2	¾	50	115P10	CR2-4-17250	HCPK4	CR2-3-17250	HCPK3
17.2	¾	Ø 8	115P10	CR2-4-1728SC	HCPK4	CR2-3-1728SC	HCPK3
17.2	¾	70	115P10	CR2-4-17270	HCPK4	CR2-3-17270	HCPK3
17.2	¾	95	115P10	CR2-4-17295	HCPK4	CR2-3-17295	HCPK3
17.2	¾	120	150P10	CR2-4-172120	HCPK4	-	-
17.2	¾	150	200P10	CR2-4-172150	HCPK4	-	-
17.2	¾	185	200P10	CR2-4-172185	HCPK4	-	-
17.2	¾	240	250P10	CR2-4-172240	HCPK4	-	-
17.2	¾	300	2 x 150P10	CR2-5-172300	HCPK5	-	-

Suitable for connections to copperbond rods - for connections to solid copper and stainless steel rods please contact our sales office
Threaded portion of copperbond rods must be removed prior to welding

Special moulds for all FurseWELD products can be manufactured to meet specific customer applications on request

*2 x S103 Sleeve required when joining conductors 16 mm² or smaller