

# — FH202 A | FH204 A

## End of Life Instruction

Decommissioning instructions available to enable responsible recycling or disposal



PREPARED 2024-05-31 Angelo Giugno	DOCUMENT KIND EoL Instructions	SECURITY LEVEL Public		
OWNING ORGANIZATION ABB - ELSB	DOCUMENT ID. 9AKK108469A2269	REV. B	LANG. en	PAGE 1/6

# Contents

- 1. Purpose and Basic Description ..... 3**
- 2. Dismantling instructions ..... 3**
  - 2.1. 2 & 4 Poles product:.....3
  - 2.1.1. 4 pole product: ..... 4
  - 2.1.2. Electronic Board .....5
- 3. Constituent materials ..... 6**
  - 3.1. Constituent materials ..... 6
- 4. Additional Information..... 6**

# 1. Purpose and Basic Description

This product family is in the scope of European Union directive 2012/19/EU on Waste Electrical and Electronic Equipment (WEEE). The product family must be disposed according to the legislation of the country. This the end-of-life instructions is intended for use by customers and recycling companies which outline the responsible recycling or disposal method of the ABB product.

The RCCBs FH200 series assures protection to people and installations against fault current to earth. A large offer for standard instantaneous AC and A types is particularly suitable for installation in domestic applications.

## 2. Dismantling instructions

### 2.1. 2 & 4 Poles product:

First, remove the handle toggle, the rail clip and the screw, this part should be removed to split the cover from the housing.

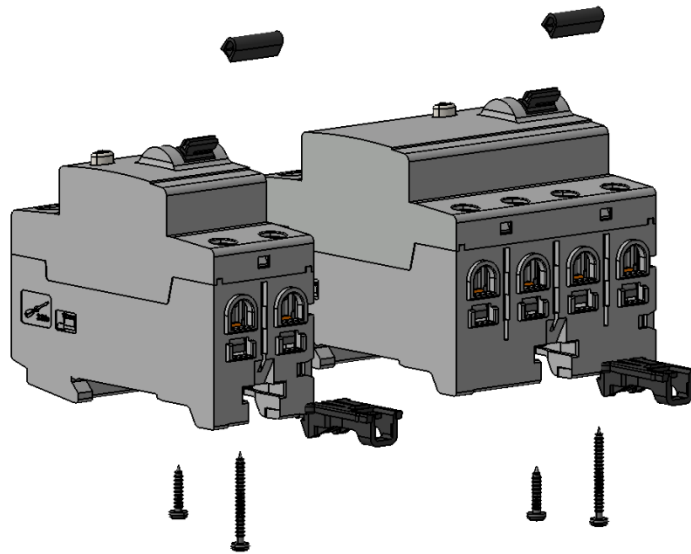

**2.1.1. 4 pole product:**

On this case, 4 poles products, there is an extra screw that needs to be remove before remove the mechanism from the housing.

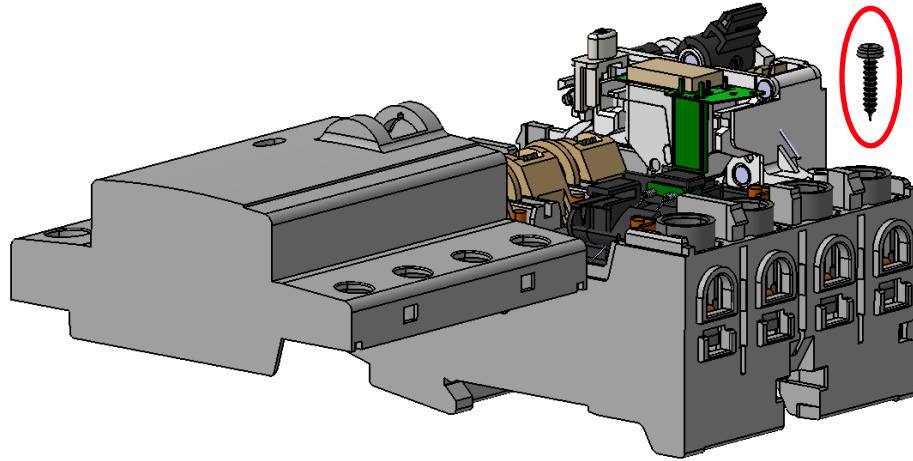

Once we remove the mechanism form the base, the different parts will be extracted until reaching the configuration of the figure below.

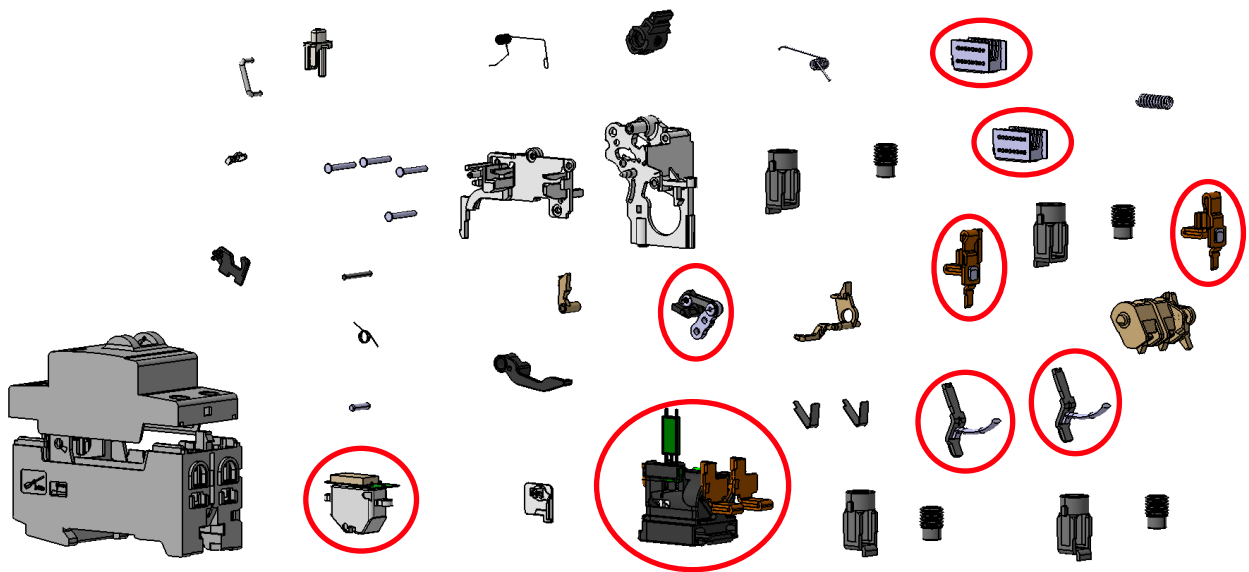

\*Rounded parts have soldered or riveted pieces that cannot be manually disassembled.

### 2.1.2. Electronic Board

At the end, the Electronic Board must be depolluted to assure an appropriate end of life treatment.

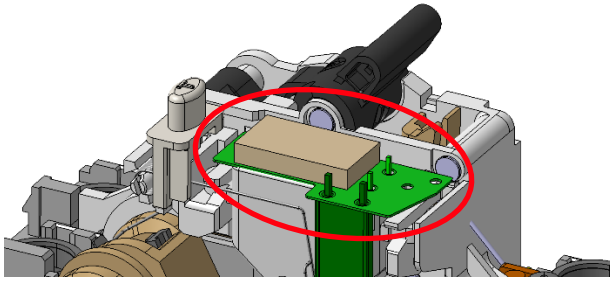

*Weight of the Electronic Board = 0.5 g*

## 3. Constituent materials

### 3.1. Constituent materials

Plastics		Metals		Packaging	
PA6 + GF	24.2%	Steel	19.4%	Cardboard	19.6%
PPS + GF + PTFE	5.5%	Brass	7.4%	Magnetic core	3.6%
PA66 + GF	5.1%	Copper	4.1%	Magnetic relay	2.3%
PPS + GF	2.9%	Stainless steel	1.6%	Other	1.3%
Others	2.5%	Others	0.5%		

\*% of total weight for two pole.

## 4. Additional Information

<b>Weight for 2 Pole</b>	203 g
<b>Weight for 4 Pole</b>	322 g
<b>Overall dimensions (H x D x W) 2P</b>	88 <sup>(1)</sup> x 68.9 x 35 mm
<b>Overall dimensions (H x D x W) 4P</b>	88 <sup>(1)</sup> x 68.9 x 70 mm

<sup>(1)</sup> Without considering rail clip