

A

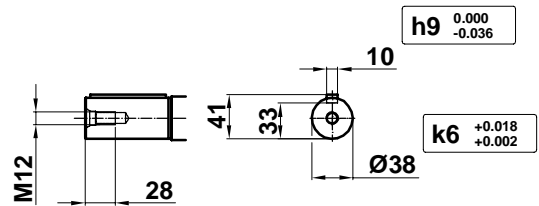

S = { Ø15 – Special IM 3001/*11
M12 – Special IM 3601/*11

M2AA 132

Additional information:

VC005: Metal protective roof, vertical motor, shaft down / Doble protector de ventilador

VC253: Flange ring FF 265 / Aro brida FF 265 // VC254: Flange ring FT265 / Aro brida FT 265

Motor Dimension Print

Motor Type :
M2AA 132 Short

Document Nº :
3GZE 500 132-971.005

Description : Motor flange mounted special (2-pieces) IM3001/*11 or IM3601/*11
Motor con brida (2 piezas) IM3001/*11 o IM3601/*11

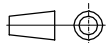

Unit : Discret Automation & Motion - Fábrica Motores
Date : 2012-12-13

Issued by : ERM/ A. Caubera
Approved by : ERM/ G. Blanes

Replaces :
Replaced by :

Asea Brown Boveri, S.A

Customer Reference :

ABB