

Issue 07/25/2018
 Date:
 Page: 1 of 2
 File: PSS-K676CH-BUS

15/25kV	900A Deadbreak Separable "H" Joint-BUS	w/ Test Point	K676CH-BUS
---------	--	---------------	------------



Features:

- 15/25kV, 900A Deadbreak rated separable connector
- Design with Compression or Shear bolt connectors
- Fully shielded, fully submersible, 100% peroxide cured EPDM molded rubber and electrolytic Copper
- Re-usable components reduce inventory and other costs
- Includes integral capacitive test point

K676CH-BUS Deadbreak Separable "H" Joint-BUS

Applications:

Elastimold® separable cable joints are modular kits: 2-way, 3-way or 4-way insulated bus bars and retractable straight receptacle housings. The K676CH-Bus Separable "H" joint is based on the 4-way bus bar. The cables are bolted via compression lug or shear bolt connectors to the bar. The straight receptacle house slides over the connections to form a fully shielded, fully submersible 4-way disconnectable cable joint. The K676CH-Bus cable joint is used to join cables in a disconnectable 4-way joint. It is compact size and ideal for small vaults and manholes application. K676CH-Bus is modular and ideal where separable components are required to accommodate future system circuit changes or expansions. It can also be used initially as 4-way joint with insulated caps on the unused interfaces. The K676CH-Bus can also be used in direct -buried applications.

Ratings:

Meets ANSI/IEEE Standard 386, Latest Revision

For 15kV Voltage Class:

8.3kV Max Phase-to-Ground – Operating Voltage
 14.4kV Max Phase-to-Phase
 95kV BIL – Impulse Withstand (1.2 x 50 microsecond wave)
 34kV AC – One minute withstand
 53kV DC – 15 minutes withstand
 11kV AC – Corona Extinction @ 3pC sensitivity
900 Amp – Continuous
 25kA Sym – 10 Cycles Momentary

For 25kV Voltage Class:

16.2kV Max Phase-to-Ground – Operating Voltage
 28kV Max Phase-to-Phase
 140kV BIL – Impulse Withstand (1.2 x 50 microsecond wave)
 45kV AC – One minute withstand
 84kV DC – 15 minutes withstand
 21kV AC – Corona Extinction @ 3pC sensitivity
900 Amp – Continuous
 25kA Sym – 10 Cycles Momentary

Issue: 07/25/2018
Date:
Page: 2 of 2
File: PSS-K676CH-BUS

15/25kV	900A Deadbreak Separable "H" Joint-BUS	w/ Test Point	K676CH-BUS
---------	---	---------------	------------

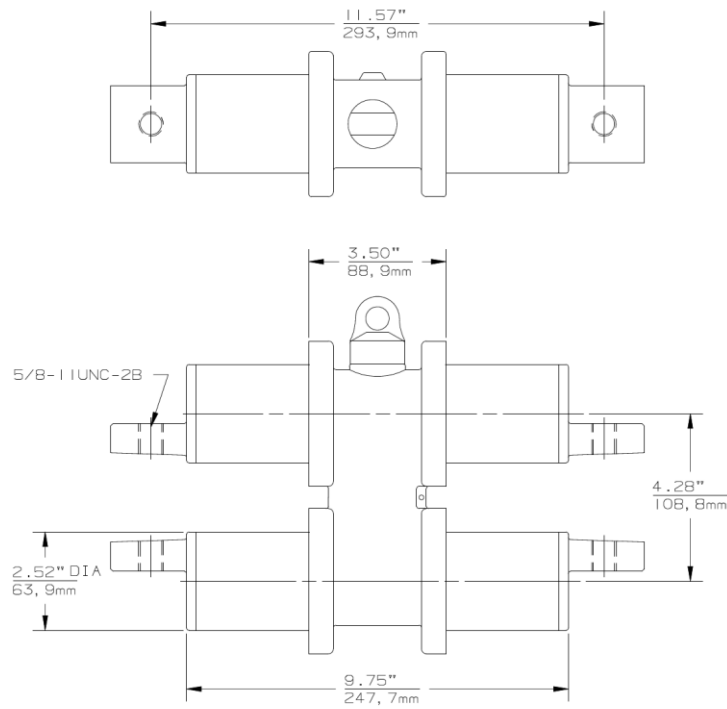

Contents:

1	4-Way Bus Bar	K676CH-BUS
2	Si-Lubricant	82-08
1	Installation Instruction	IS-1074