

Microgrid efficiency and productivity for next generation ships

The Emax 2 all-in-one solution makes it simpler

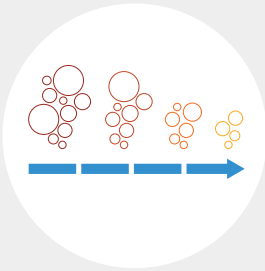

Energy Efficiency

IMO* targets CO₂ emission reduction of 15 times within 30 years.

*International Maritime Organization

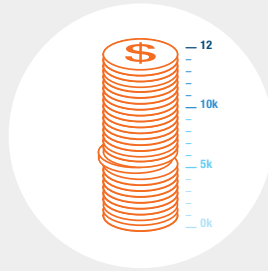

Continuous operation

Due to non productive time, annual average losses up to 12M\$ for a drill ship.



Space saving

Space is getting crucial for the ship building industry: more than 200M\$ invested to add 200 cabins per ship, by one of the biggest cruise ship companies.

Market Drivers in marine industry

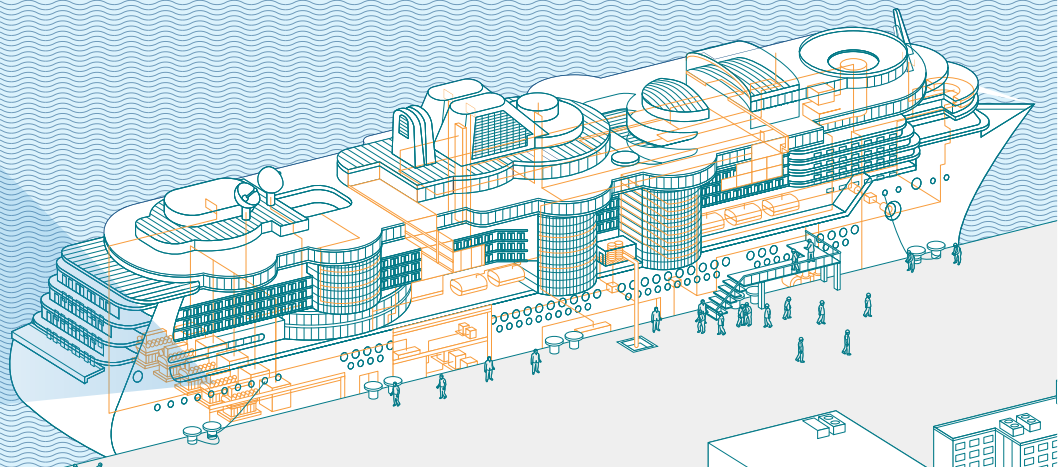
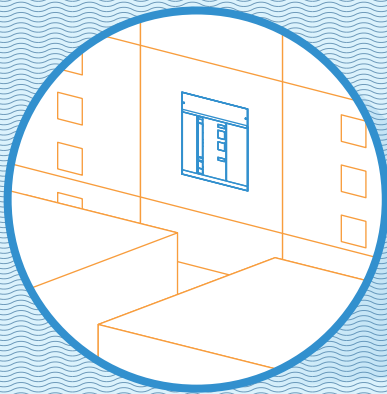

Key Benefits with Emax 2 smart circuit breaker



Simpler integration thanks to **cloud connectivity** and **7 communication protocols** for more than **3000 information** and energy measures available. Power profile optimization thanks to intelligent **peak shaving and load shifting**.

[Discover more >](#)

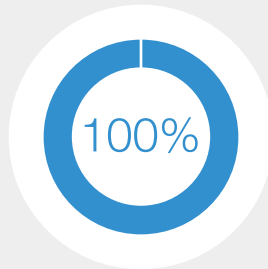

Protection of 100% loads and generators.

Reliability x 2 thanks to redundant **digital selectivity** and **fast load shedding** to enhance service continuity.

[Discover more >](#)

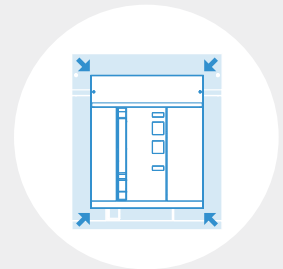

Switchgear optimization for **reduced weight and space up to 25%** guaranteed by the most compact performance.

[Discover more >](#)



Power and productivity
for a better world™