

# Tmax Link OEM UL891 Switchboard Program

## Introducing the Tmax Link

TMAX Link is a group and individually mounted circuit breaker switchboard design that has been tested and certified to UL® 891. With Tmax Link the OEMs can manufacture a switchboard with ABB Tmax breakers, the most innovative breakers in the market.

- Easy to manufacture mounting straps (no casting components)
- Covers different hole spacings on the vertical bus
- Up to 1200A frame breaker in 32" width section
- No limitation in the use of 100% Rated Circuit Breakers
- Up to 200kAIC

## OEM UL891 Switchboard Program

The ABB UL file extension enables OEMs to build and assemble switchboard chassis and enclosures with a UL® listing mark together with the OEM logo.

ABB provides to its customers an extension procedure to facilitate the formal process and an extension package with 2D and 3D drawings to facilitate customer design and engineering.



Complete section

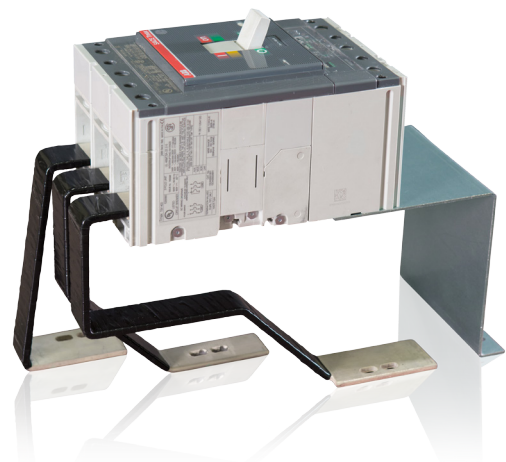

Breaker plus straps plus breaker support

## Switchboard Characteristics

<b>Certification</b>	UL891
<b>Rated Operated Voltages</b>	240Vac, 480Vac, 600Vac
<b>Frequency</b>	50 Hz, 60 Hz
<b>System Phases</b>	3 phases, 3 wires 3 phases, 4 wires (100% neutral)
<b>Short Circuit Current</b>	up to 200ka
<b>Dielectric Test Voltage</b>	2.2kV RMS
<b>Rated Horizontal Bus</b>	up to 5000A
<b>Distribution bus (vertical bus)</b>	
<b>Tin Plated Aluminum</b>	up to 1600A
<b>Silver/Tin Plated Copper</b>	up to 2000A
<b>Connection Options</b>	MCB, MLO, THROUGH BUS
<b>Interior Height</b>	up to 68.75"
<b>Hole Spacing</b>	1.25", 1.38"
<b>Minimum Width</b>	32" (38"w/T5 400A dual mounted)

## Mounting Straps

ABB has designed two different series of mounting straps able to fit on 1.25" and 1.38" holes patterns. Special care has been taken to ensure that no extraordinary forging, die casting process or specialized tooling is required to fabricate the mounting straps, thereby reducing the OEMs cost and lead-times. Additionally to the extension, ABB will offer the ability to purchase the mounting strap kits.

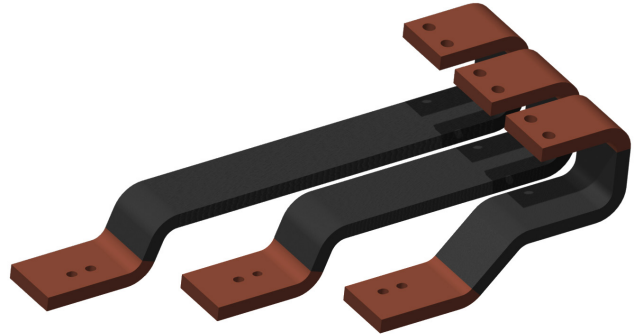

1SXU210196L0201 April 2014

## Breaker Characteristics

### Circuit Breaker Ratings

Type	Continuous Ampere Rating	Mounting Configuration	Version	Trip Unit	Poles	Rated	UL 489 Maximum Interrupting Capacity			
							Volts AC			
							240V	480V	600V	600/347V
T1	100A	Dual	N	TM	3	100%	50kA <sup>(1)</sup>	22kA <sup>(1)</sup>	—	10kA
T2	100A	Dual	H	TM/ELT	3	100%	150kA	65kA	—	—
T3	225A	Dual	S	TM	3	100%	65kA	35kA	—	10kA
T4	250A	Single/Dual	V	TM/ELT	3	100%	200kA	150kA	100kA	—
T5	400A	Single/Dual	V	TM/ELT	3	100%	200kA	150kA	100kA	—
T6	600A	Single	L	TM/ELT	3	100%	200kA	100kA	42kA	—
T6	800A	Single	L	TM/ELT	3	100%	200kA	100kA	42kA	—
T7	1200A	Single	L	ELT	3	100%	150kA	100kA	65kA	—

<sup>(1)</sup> In 15A ≥35kA @ 240 V AC - 14 kA @ 480Y/277 V AC

For more information, please contact:

### ABB Inc.

#### Low Voltage Control Products

North American Division  
16250 W. Glendale Drive  
New Berlin, WI 53151  
Phone: 888-385-1221

[www.abb.us/lowvoltage](http://www.abb.us/lowvoltage)

© Copyright 2014 ABB.  
All rights reserved.