

50V_1000 / 50S_1000 Vortex Flowmeter / Swirl Flowmeter

Compact version and
2-component design



1 Name plate specifications for spare parts orders

The flowmeter version can be identified by referring to the name plate that is attached to the housing.
When placing spare parts orders, always remember to state the order number as shown on the name plate.

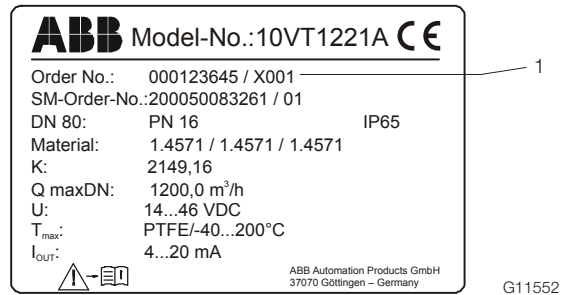
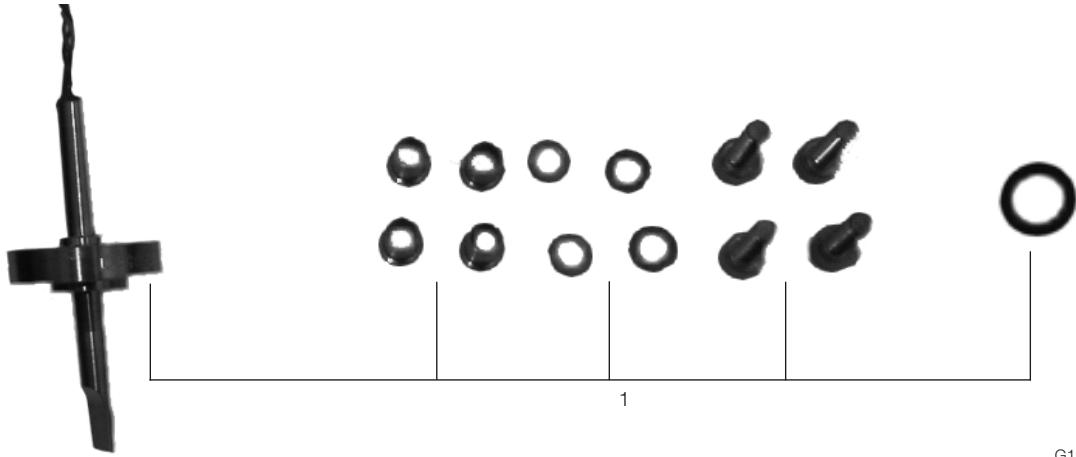

Fig. 1: Name plate
1 Order number

2 Accessories



G11509

Fig. 2

Position	Name of part	Variant	Order number	Weight kg (lb)	Price (€)
1	Set "Viton" includes: Sensor Viton gasket Sleeve Spring washer Screws	-	D614L990U02	0,25	
1	Set "Kalrez" includes: Sensor Kalrez gasket Sleeve Spring washer Screws	-	D614L990U03	0,25	
1	Set "PTFE" includes: Sensor PTFE gasket Sleeve Spring washer Screws	-	D614L990U04	0,25	
1	Set "Graphit" includes: Sensor PTFE gasket Sleeve Spring washer Screws	-	D614L990U06	0,25	



IMPORTANT (NOTE)

For sensor delivery, please provide the order number!

Contact us

To find your local ABB branch, go to:
www.abb.com/contacts

Additional product information is
available at:
www.abb.com

ABB Automation GmbH

Service Instrumentation
Dransfelder Str. 2
37079 Göttingen
Germany

Note

We reserve the right to make technical changes and changes affecting content to this document at any time without prior notice.

Orders are subject to the agreed detailed terms and conditions. ABB cannot be held responsible for any errors or omissions in this document.

We reserve all rights to this document and its content, including images. This document must not be copied, shared with third parties, or its content (in whole or in part) used without the prior written permission of ABB.

Copyright© 2013 ABB
All rights reserved

3KXF300001R4701

SPL/50V_1000_50S_1000-EN Rev. B 02.2013