

PrimEvo XT100

Productivity & reliability



PrimEvo XT100

- Available at your local wholesaler
- Plug and play, maintained and non-maintained in one
- Full LED range with best price/performance ratio
- Manual and Self-test

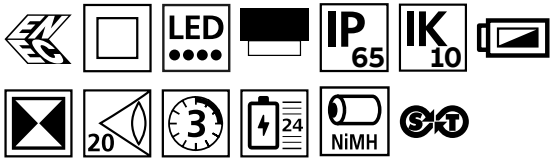

Luminaire

Order Code	Description	Input voltage	Lamp type	Lamp output (lm)	Power consumption (VA/W)	Operation duration (hrs)	Environment temperature (°C)	Weight (kg)
XT100E	PrimEvo Bulkhead	220 - 240 Vac, 50/60Hz	2 x LED 0.5W	110	5/2	3	0 - 40	0.6
XT100ST	PrimEvo Bulkhead Self-test	220 - 240 Vac, 50/60Hz	2 x LED 0.5W	110	5/2	3	0 - 40	0.6

Configurable pictograms included

Accessories

Order Code	Description
642 202	Recess Kit 100% – Wall/Ceiling ⁽¹⁾
642 102	Recess Kit 50% - Wall/Ceiling ⁽²⁾
663 325	Pictogram holder with 3 legends
663 330	Pack of 3 legends for signaling (Left, right and down arrow)
642 015	Protective grid cover ⁽³⁾

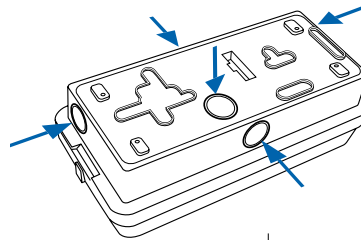

01



02



03

