



5SDA 09D2604

Old part no. DA 807-880-26

Avalanche Diode

Properties

- low on-state voltage
- avalanche reverse characteristics
- high operational reliability
- suitable for parallel operation

Key Parameters

| | | | |
|------------|---|--------|----|
| V_{RRM} | = | 2 600 | V |
| I_{FAVm} | = | 1 020 | A |
| I_{FSM} | = | 11 500 | A |
| V_{TO} | = | 0.870 | V |
| r_T | = | 0.390 | mΩ |

Types

| | V_{RRM} |
|--|-----------|
| 5SDA 09D2604 | 2 600 V |
| 5SDA 09D2304 | 2 300 V |
| Conditions: $T_j = -40 \div 160$ °C, half sine waveform, $f = 50$ Hz | |

Mechanical Data

| | | |
|-------|---------------------------|-----------|
| F_m | Mounting force | 11 ± 1 kN |
| m | Weight | 0.23 kg |
| D_s | Surface creepage distance | 30 mm |
| D_a | Air strike distance | 20.5 mm |

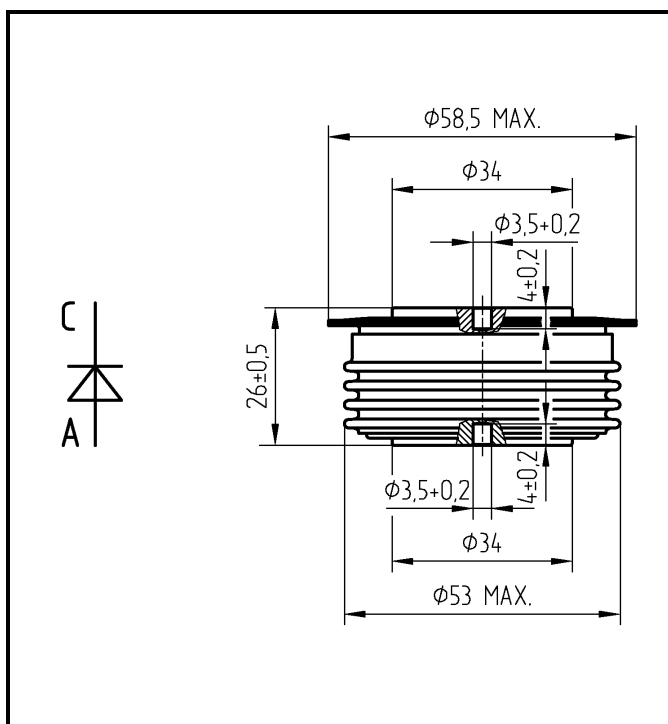

Fig. 1 Case



ABB s.r.o.

Novodvorska 1768/138a, 142 21 Praha 4, Czech Republic

tel.: +420 261 306 250, <http://www.abb.com/semiconductors>

| Maximum Ratings | | | Maximum Limits | Unit |
|------------------------|---|--|----------------------------------|------------------------------------|
| V_{RRM} | Repetitive peak reverse voltage $T_j = -40 \div 160 \text{ }^\circ\text{C}$ | 5SDA 09D2604 5SDA 09D2304 | 2 600 2 300 | V |
| I_{FAVm} | Average forward current $T_c = 85 \text{ }^\circ\text{C}$ | | 1 020 | A |
| I_{FRMS} | RMS forward current $T_c = 85 \text{ }^\circ\text{C}$ | | 1 600 | A |
| I_{RRM} | Repetitive reverse current $V_R = V_{RRM}$ | | 50 | mA |
| I_{FSM} | Non repetitive peak surge current $V_R = 0 \text{ V, half sine pulse}$ | $t_p = 8.3 \text{ ms}$ | 12 300 | A |
| | | $t_p = 10 \text{ ms}$ | 11 500 | A |
| I^2t | Limiting load integral $V_R = 0 \text{ V, half sine pulse}$ | $t_p = 8.3 \text{ ms}$ | 630 000 | A²s |
| | | $t_p = 10 \text{ ms}$ | 661 000 | A²s |
| P_{RSM} | Maximum avalanche power dissipation <i>rectangular pulse 20 μs</i> | | 50 | kW |
| $T_{jmin} - T_{jmax}$ | Operating temperature range | | -40 \div 160 | $^\circ\text{C}$ |
| T_{STG} | Storage temperature range | | -40 \div 160 | $^\circ\text{C}$ |

Unless otherwise specified $T_j = 160 \text{ }^\circ\text{C}$

| Characteristics | | Value | | | Unit |
|------------------------|---|--------------|------------|--------------|---------------------------------|
| | | <i>min</i> | <i>typ</i> | <i>max</i> | |
| V_{TO} | Threshold voltage | | | 0.870 | V |
| r_T | Forward slope resistance $I_F = 1000 \div 3000 \text{ A}$ | | | 0.390 | mΩ |
| V_{FM} | Maximum forward voltage $I_{FM} = 1\,800 \text{ A}$ | | | 1.600 | V |
| Q_{rr} | Recovered charge $V_R = 100 \text{ V, } I_{FM} = 1\,000 \text{ A, } di_F/dt = -5 \text{ A}/\mu\text{s}$ | | 810 | | μC |

Unless otherwise specified $T_j = 160 \text{ }^\circ\text{C}$

| Thermal Parameters | | | Value | Unit |
|---------------------------|--|-----------------------------|--------------|-------------|
| R_{thjc} | Thermal resistance junction to case | <i>double side cooling</i> | 40 | K/kW |
| | | <i>anode side cooling</i> | 65 | |
| | | <i>cathode side cooling</i> | 104 | |
| R_{thch} | Thermal resistance case to heatsink | <i>double side cooling</i> | 10 | K/kW |
| | | <i>single side cooling</i> | 20 | |

ABB s.r.o., Novodvorska 1768/138a, 142 21 Praha 4, Czech Republic

ABB s.r.o. reserves the right to change the data contained herein at any time without notice

Transient Thermal Impedance

Analytical function for transient thermal impedance

$$Z_{thjc} = \sum_{i=1}^4 R_i (1 - \exp(-t / \tau_i))$$

Conditions:

$F_m = 11 \pm 1$ kN, Double side cooled

| i | 1 | 2 | 3 | 4 |
|--------------|-------|-------|-------|--------|
| R_i (K/kW) | 20.95 | 10.57 | 7.15 | 1.33 |
| τ_i (s) | 0.396 | 0.072 | 0.009 | 0.0044 |

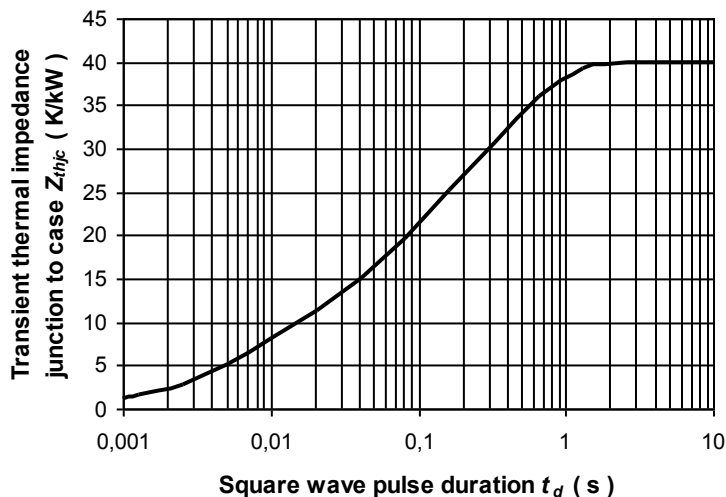

Fig. 2 Transient thermal impedance junction to case

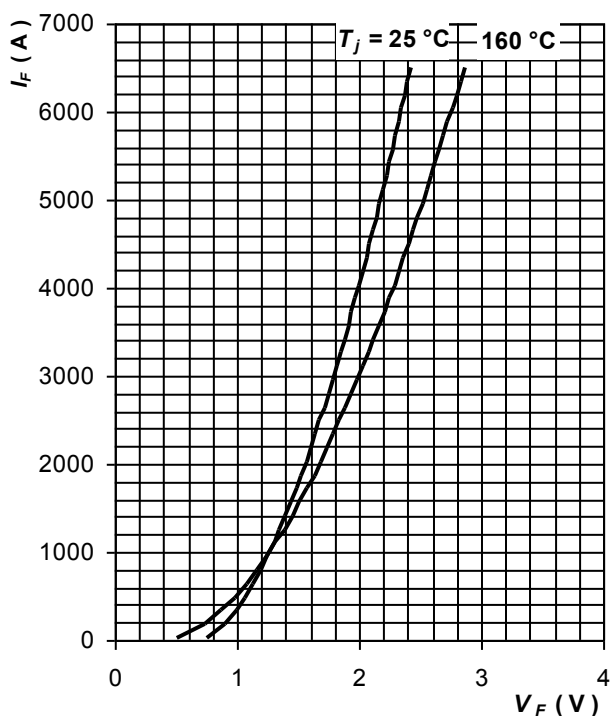

Fig. 3 Maximum forward voltage drop characteristics

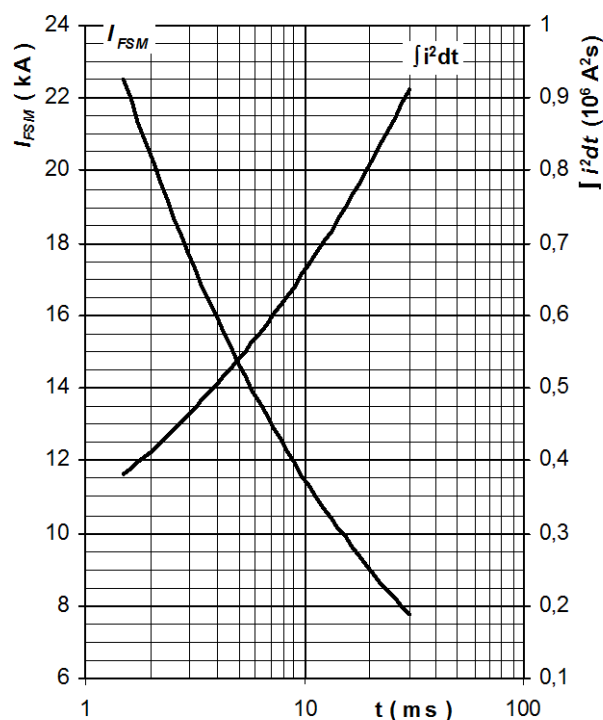

Fig. 4 Surge forward current vs. pulse length, half sine wave, single pulse, $V_R = 0$ V, $T_j = T_{jmax}$

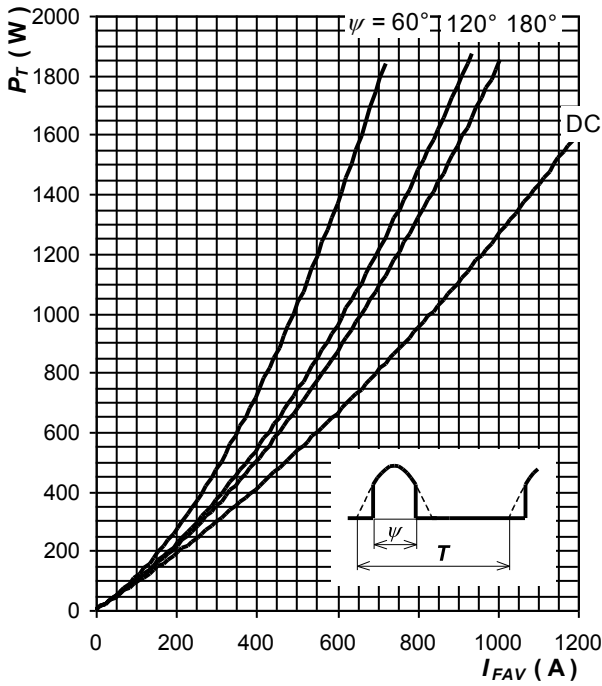

Fig. 5 Forward power loss vs. average forward current, sine waveform, $f = 50 \text{ Hz}$, $T = 1/f$

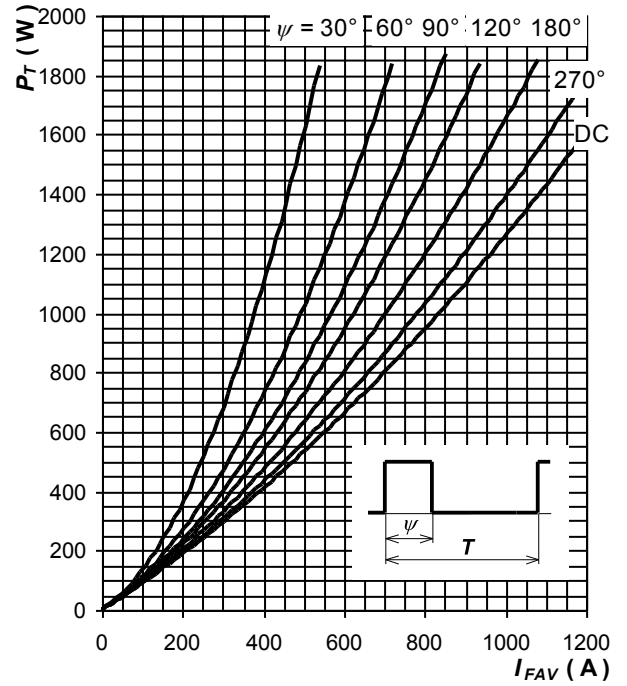

Fig. 6 Forward power loss vs. average forward current, square waveform, $f = 50 \text{ Hz}$, $T = 1/f$

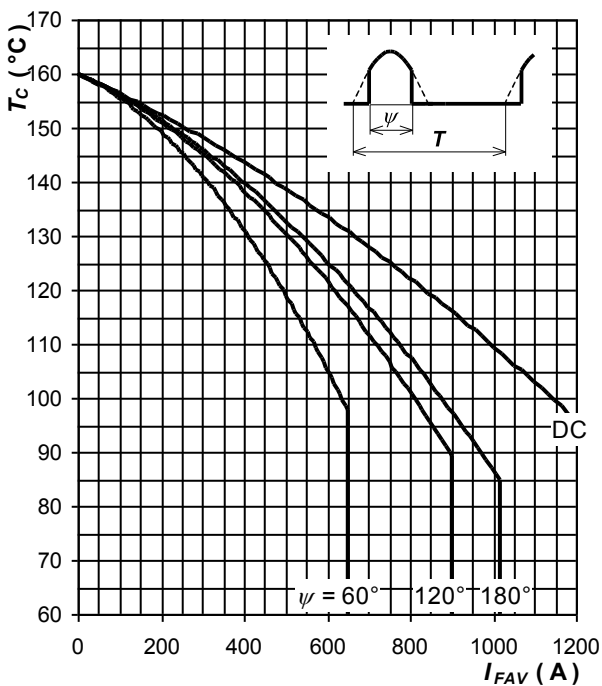

Fig. 7 Max. case temperature vs. aver. forward current, sine waveform, $f = 50 \text{ Hz}$, $T = 1/f$

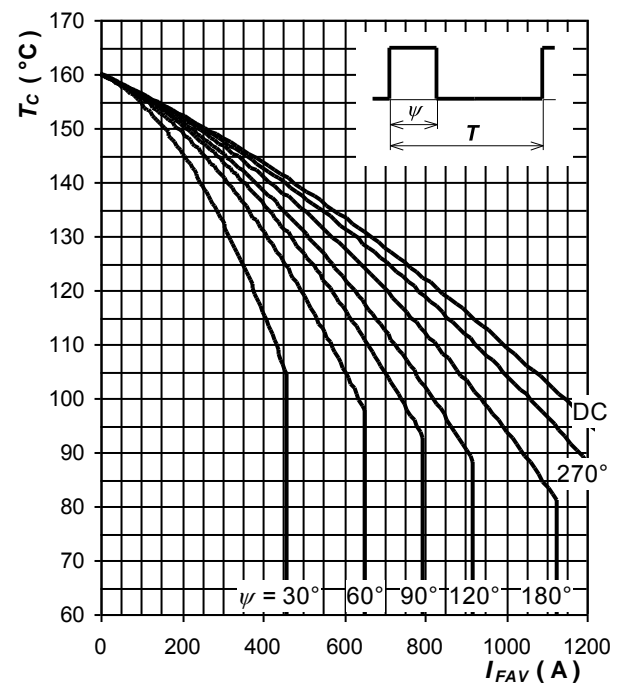

Fig. 8 Max. case temperature vs. aver. forward current, square waveform, $f = 50 \text{ Hz}$, $T = 1/f$

Notes: