

AquaMaster Explorer Upgrade to Plastic MIL-Style Connector

1 Introduction

This publication details the procedure for upgrading an existing AquaMaster flowmeter installation to enable a plug and socket type AquaMaster Explorer transmitter to be connected.

The upgrade is suitable for either a hard-wired installation where the sensor cable was connected through a gland into the transmitter or an existing Bulgin (blue plastic) connector type.

The contents of the upgrade kit are shown in Table 1.1:

Description	Qty
Terminal box with fitted MIL-style connector and potting compound	1
Information Sheet – AquaMaster Explorer Upgrade to Plastic MIL-style Connector – part no. INF09/024	1

Table 1.1 AquaMaster Explorer
Plastic MIL-Style Sensor Upgrade Kit (Part No. WAB2035)
Plastic MIL-Style Pressure Upgrade Kit (Part No. WAB2036)

2 Connecting the Terminal Box

Warning. Isolate the sensor and flowmeter from power supplies before carrying out this procedure.

Referring to Fig. 2.1, connect the terminal box between the sensor cable and an AquaMaster Explorer flowmeter:

1. Cut the Bulgin connector off the cable (A) (if present), strip back the cable (B) 60 mm (2.4 in.) and prepare wire ends (C) by exposing 5 mm (0.2 in.) of conductor.
2. Thread the cable through gland (D) and screw wire ends (E) into terminals with corresponding colors.
3. Tighten cable gland (D).

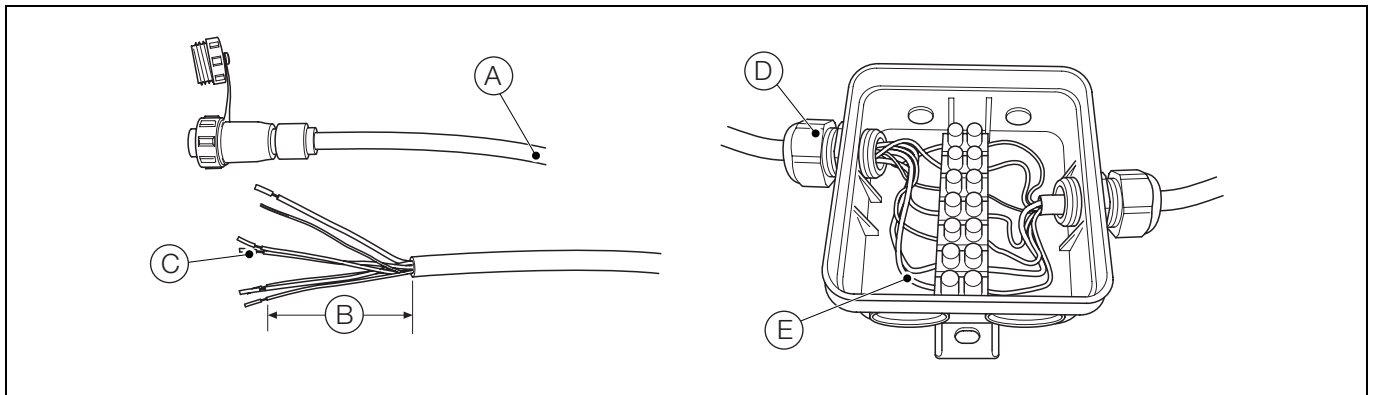

Fig. 2.1 Cable Preparation and Connections

3 Potting the Terminal Box

Referring to Fig. 3.1:

1. Fill the terminal box with potting compound (G), following the potting instructions.

- Potting materials are toxic. Read the manufacturers' instructions carefully before preparing the potting material and use suitable safety precautions.
- Power up and check all connections before potting.
- The remote terminal box connections must be potted immediately on completion to prevent the ingress of moisture.
- Do not overfill or allow the potting material to come into contact with 'O' rings or grooves.
- Do not let potting material enter conduit (if used).

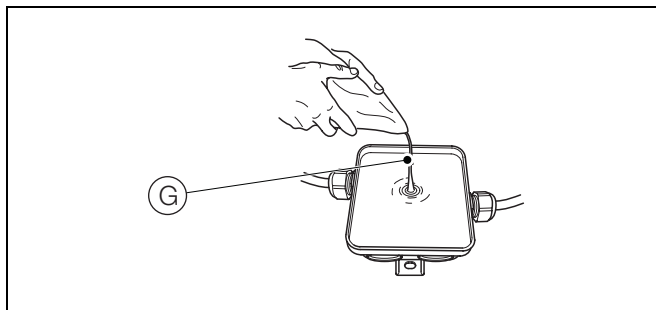

Fig. 3.1 Potting the Terminal Box

2. Refit the terminal box lid.
3. Allow sufficient curing time as specified in the potting instructions.
4. Connect the sensor cable to the AquaMaster Explorer.

ABB has Sales & Customer Support expertise in over 100 countries worldwide

www.abb.com

The Company's policy is one of continuous product improvement and the right is reserved to modify the information contained herein without notice.

Printed in UK (04.10)

© ABB 2010

ABB

ABB Limited
Oldends Lane, Stonehouse
Gloucestershire
GL10 3TA
UK
Tel: +44 (0)1453 826661
Fax: +44 (0)1453 829671

ABB Inc.
125 E. County Line Road
Warminster
PA 18974
USA
Tel: +1 215 674 6000
Fax: +1 215 674 7183