

---

CATALOG

# Steel City<sup>®</sup> Conduit Systems

## Commercial solutions

*Steel City*<sup>®</sup>



---

**ABB Steel City® Conduit Systems provide cable protection system solutions primarily for commercial construction applications such as light industrial facilities, office buildings, commercial spaces and residential structures.**

**Steel City® Conduit Systems bring together high-quality, market-leading brands such as T&B® Fittings, Steel City® Fittings and T&B Liquidtight Systems® fittings for high-performance system solutions.**

---

# Table of contents

<b>004–005</b>	<b>Introduction</b>
<b>006–009</b>	<b>Commercial liquid-tight conduit and fittings</b>
<b>010–011</b>	<b>Steel “thin wall” flexible metallic conduit and fittings</b>
<b>012–013</b>	<b>Aluminum “thin wall” flexible metallic conduit and fittings</b>
<b>014–015</b>	<b>Aluminum “heavy wall” flexible metallic conduit and fittings</b>
<b>016</b>	<b>Accessories</b>
<b>017–022</b>	<b>Technical data</b>
<b>023–025</b>	<b>Index</b>

# Introduction

## Steel City® Conduit Systems solutions

—  
01 Commercial  
liquid-tight

—  
02 Steel “thin wall”  
flexible metallic

—  
03 Aluminum “thin wall”  
flexible metallic

—  
04 Aluminum “heavy wall”  
flexible metallic

### Commercial liquid-tight

#### Typical applications

- Light industrial and commercial installations
- Wet and oily environments
- UV resistant for outdoor use

#### Products

- **Conduit:**
  - LTGU flexible metal conduit (UL, CSA)
  - CLGE general purpose liquid-tight conduit
  - PVC jacket
  - Galvanized steel core — 3/8 to 4" trade sizes
  - Designed to UL 360 ID/OD dimensions
- **Fittings:**
  - Series LT steel — straight, 45° and 90°
  - 3/8 to 4" trade sizes
  - NPT
  - Meets UL 514B, CSA C22.2 No. 18.3

### Steel “thin wall” flexible metallic

#### Typical applications

- “Greenfield”, universal wiring applications
- Metal raceway to NEC Article 348
- Exposed and concealed locations (348.10)

#### Products

- **Conduit:**
  - CMSU flexible metal conduit (UL, CSA)
  - Non-jacketed, galvanized steel core
  - “Reduced wall” gauge
  - Helically wound, formed strip
  - 3/8 to 4" trade sizes
  - Meets UL-1, CSA C22.2 No. 56 (See TDS)
- **Fittings:**
  - Series XC squeeze clamp die-cast zinc
  - Series 200 squeeze clamp steel
  - Series 300 Tite-Bite®
  - Listed for use with FMC (flexible metal conduit)
  - Meets UL 514B, CSA C22.2 No. 18.3

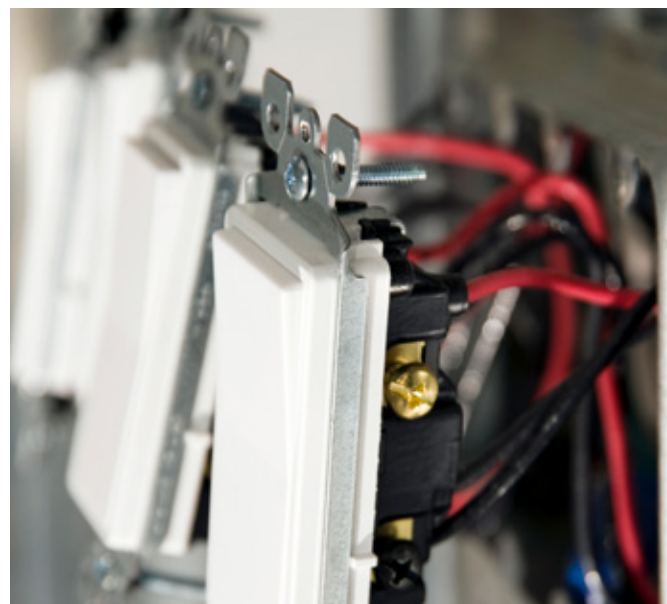

## Aluminum “thin wall” flexible metallic

### Typical applications

- “Greenfield”, universal wiring applications
- Metal raceway to NEC Article 348
- Installations where reduced weight is required

### Products

- **Conduit:**  
CMAU flexible metal conduit (UL, CSA)  
Non-jacketed, aluminum core  
“Reduced wall” gauge  
Helically wound, formed strip  
¾ to 4" trade sizes  
Meets UL-1, CSA C22.2 No. 56 (See TDS)
- **Fittings:**  
Series XC squeeze clamp die-cast zinc  
Series 200 squeeze clamp steel  
Series 300 Tite-Bite®  
Listed for use with FMC (flexible metal conduit)  
Meets UL 514B, CSA C22.2 No. 18.3

## Aluminum “heavy wall” flexible metallic

### Typical applications

- Meets CEC C22.1 Section 12-1000
- Intended for use as metal raceway
- Industrial and commercial installations

### Products

- **Conduit:**  
CMAC flexible metal conduit (CSA)  
Non-jacketed, aluminum core  
“Heavy wall” gauge  
Helically wound, formed strip  
¾ to 4" trade sizes  
Meets UL-1, CSA C22.2 No. 56 (See TDS)
- **Fittings:**  
Series XC squeeze clamp die-cast zinc  
Series 200 squeeze clamp steel  
Series 300 Tite-Bite®  
Listed for use with FMC (flexible metal conduit)  
Meets UL 514B, CSA C22.2 No. 18.3



## General purpose — liquid-tight flexible metal conduits

Type LTGU — UL Listed

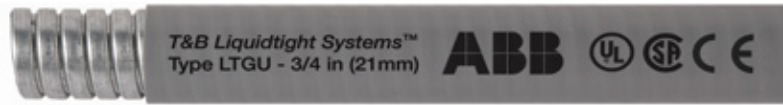

### Type LTGU — general purpose

Industrial grade liquid-tight flexible metal conduits, designed for use with Steel City® liquid-tight fittings. Typically used in industrial, commercial construction and infrastructure applications.

**Materials:** Galvanized steel core, bonding wire, smooth PVC jacket

**Color:** Gray (standard)

### Approvals:



Trade size			Coil length										Specifications			
UL	CSA	ISO/ BS EN	Standard carton			Small reel			Bulk reel				ID range (nominal)		Min. Inside bend radius	
Inch	mm	mm	Part no.	Ft	M	Part no.	Ft	M	Part no.	Ft	M	UL bond wire	Inch	mm	Inch	mm
¾	12	16	LTGUS01G-C	100	30	LTGUS01G-K	500	150	LTGUS01G-L	1,000	300	Yes	0.484 to 0.505 (0.493)	12.3 to 12.8 (12.5)	2.0	51
½	16	20	LTGUS02G-C	100	30	LTGUS02G-K	500	150	LTGUS02G-L	1,000	300	Yes	0.622 to 0.642 (0.632)	15.8 to 16.3 (16.0)	2.5	64
¾	21	25	LTGUS03G-C	100	30	LTGUS03G-K	500	150	LTGUS03G-L	1,000	300	Yes	0.820 to 0.840 (0.830)	20.8 to 21.3 (21.1)	3.0	76
1	27	32	LTGUS04G-C	100	30	LTGUS04G-J	400	120	-	-	-	Yes	1.041 to 1.066 (1.053)	25.4 to 27.1 (26.8)	4.0	102
1¼	35	40	LTGUS05G-B	50	15	LTGUS05G-E	200	60	-	-	-	Yes	1.380 to 1.410 (1.395)	35.1 to 35.8 (35.5)	4.5	114
1½	41	50	LTGUS06G-B	50	15	LTGUS06G-D	150	45	-	-	-	No	1.575 to 1.600 (1.587)	40.0 to 40.6 (40.3)	5.5	140
2	53	63	LTGUS07G-B	50	15	LTGUS07G-C	100	30	-	-	-	No	2.020 to 2.045 (2.032)	51.3 to 51.9 (51.6)	7.0	178
2½	63	70	LTGUS08G-A	25	8	-	-	-	-	-	-	No	2.480 to 2.505 (2.492)	63.0 to 63.6 (63.3)	9.5	241
3	78	80	LTGUS09G-A	25	8	-	-	-	-	-	-	No	3.070 to 3.100 (3.085)	78.0 to 78.7 (78.4)	11.5	292
4	103	100	LTGUS11G-A	25	8	-	-	-	-	-	-	No	4.000 to 4.040 (4.020)	101.6 to 105.6 (102.1)	14.0	356

### System ingress ratings

UL 50E "tested"	
NEMA 250	Type 3, 3R, 4, 12, 14
IEC 60529	IP66

### System temperature ratings

Gen	Dry: -20 to +80 °C (-4 to +176 °F)
	Oil: -20 to +70 °C (-4 to +158 °F)
	Wet: -20 to +60 °C (-4 to +140 °F)
IEC/CE	Gen: -15 to +60 °C (+5 to +140 °F)

For more information see  
Technical Data Sheet TDS000001.  
For download on our website.  
Please see also page 25  
for more information.

## General purpose commercial — liquid-tight fittings

### Series LT



**Approvals:**



UL File: E23018  
CSA File: LR-12798

**Steel City® liquid-tight fittings**

					Series LT, steel						Series LT, die-cast zinc			
Trade size		Type			Non-insulated			Insulated			Non-insulated		Insulated	
UL	CSA	ISO/ BS EN	Std.	Thread	Straight Part no.	45° Part no.	90° Part no.	Straight Part no.	45° Part no.	90° Part no.	Straight Part No.	90° Part No.	Straight Part no.	90° Part No.
¾	12	16	NPT	¾	LT38-SC	LT438-SC	LT938-SC	LT38T-SC	LT438T-SC	LT938T-SC	LT-200	LT-290	LT-800	LT-890
½	16	20	NPT	½	LT50-SC	LT450-SC	LT950-SC	LT50T-SC	LT450T-SC	LT950T-SC	LT-201	LT-291	LT-801	LT-891
¾	21	25	NPT	¾	LT75-SC	LT475-SC	LT975-SC	LT75T-SC	LT475T-SC	LT975T-SC	LT-202	LT-292	LT-802	LT-892
1	27	32	NPT	1	LT100-SC	LT4100-SC	LT9100-SC	LT100T-SC	LT4100T-SC	LT9100T-SC	LT-203	LT-293	LT-803	LT-893
1¼	35	40	NPT	1¼	LT125-SC	LT4125-SC	LT9125-SC	LT125T-SC	LT4125T-SC	LT9125T-SC	LT-204	LT-294	LT-804	LT-894
1½	41	50	NPT	1½	LT150-SC	LT4150-SC	LT9150-SC	LT150T-SC	LT4150T-SC	LT9150T-SC	LT-205	LT-295	LT-805	LT-895
2	53	63	NPT	2	LT200-SC	LT4200-SC	LT9200-SC	LT200T-SC	LT4200T-SC	LT9200T-SC	LT-206	LT-296	LT-806	LT-896
2½	63	70	NPT	2½	LT250-SC	LT4250-SC	LT9250-SC	LT250T-SC	LT4250T-SC	LT9250T-SC	LT-207	LT-297	LT-807	LT-897
3	78	80	NPT	3	LT300-SC	LT4300-SC	LT9300-SC	LT300T-SC	LT4300T-SC	LT9300T-SC	LT-208	LT-298	LT-808	-
4	103	100	NPT	4	LT400-SC	LT4400-SC	LT9400-SC	LT400T-SC	LT4400T-SC	LT9400T-SC	LT-210	LT-2910	LT-810	-

**Sealing o-rings — die-cast zinc**

Trade size	Part no.
¾"	SR 101
½"	SR 102
¾"	SR 103
1"	SR 104
1¼"	SR 105
1½"	SR 106

## General purpose commercial — liquid-tight flexible metal conduits

Type CLGE — CE Certified

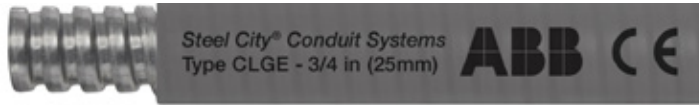

### Type CLGE — general purpose

Commercial grade liquid-tight flexible metal conduits, designed for use with Steel City® liquid-tight fittings. Typically used in commercial construction and infrastructure applications.

**Materials:** Galvanized steel core, smooth PVC jacket

**Color:** Gray (standard)

### Approvals:



Trade size			Coil length										Specifications			
UL	CSA	ISO/ BS EN	Standard carton			Small reel			Bulk reel			UL bond wire	ID range (nominal)		Min. inside bend radius	
Inch	mm	mm	Part no.	Ft	M	Part no.	Ft	M	Part no.	Ft	M		Inch	mm	Inch	mm
3/8	12	16	CLGES01G-C	100	30	CLGES01G-K	500	150	CLGES01G-L	1,000	300	No	0.484 to 0.505 (0.493)	12.3 to 12.8 (12.5)	2.0	51
1/2	16	20	CLGES02G-C	100	30	CLGES02G-K	500	150	CLGES02G-L	1,000	300	No	0.622 to 0.642 (0.632)	15.8 to 16.3 (16.0)	2.5	64
3/4	21	25	CLGES03G-C	100	30	CLGES03G-K	500	150	CLGES03G-L	1,000	300	No	0.820 to 0.840 (0.830)	20.8 to 21.3 (21.1)	3.0	76
1	27	32	CLGES04G-C	100	30	CLGES04G-J	400	120	-	-	-	No	1.041 to 1.066 (1.053)	25.4 to 27.1 (26.8)	4.0	102
1 1/4	35	40	CLGES05G-B	50	15	CLGES05G-E	200	60	-	-	-	No	1.380 to 1.410 (1.395)	35.1 to 35.8 (35.5)	4.5	114
1 1/2	41	50	CLGES06G-B	50	15	CLGES06G-D	150	45	-	-	-	No	1.575 to 1.600 (1.587)	40.0 to 40.6 (40.3)	5.5	140
2	53	63	CLGES07G-B	50	15	CLGES07G-C	100	30	-	-	-	No	2.020 to 2.045 (2.032)	51.3 to 51.9 (51.6)	7.0	178
2 1/2	63	70	CLGES08G-A	25	8	-	-	-	-	-	-	No	2.480 to 2.505 (2.492)	63.0 to 63.6 (63.3)	9.5	241
3	78	80	CLGES09G-A	25	8	-	-	-	-	-	-	No	3.070 to 3.100 (3.085)	78.0 to 78.7 (78.4)	11.5	292
4	103	100	CLGES11G-A	25	8	-	-	-	-	-	-	No	4.000 to 4.040 (4.020)	101.6 to 105.6 (102.1)	14.0	356

**Note:** Product must be installed with applicable national and local electrical codes

### System ingress ratings

UL 50E "tested"	
NEMA 250	Type 3, 3R, 4, 12, 13
IEC/EN 60529	IP66

### System temperature ratings

Gen	Dry: -20 to +80 °C (-4 to +176 °F)
	Oil: -20 to +70 °C (-4 to +158 °F)
	Wet: -20 to +60 °C (-4 to +140 °F)
IEC/CE	Gen: -15 to +60 °C (+5 to +140 °F)

For more information see  
Technical Data Sheet TDS000016.  
For download on our website.  
Please see also page 25  
for more information.



## General purpose commercial — liquid-tight fittings

### Series LT



**Approvals:**



**Steel City® liquid-tight fittings**

					Series LT, steel						Series LT, die-cast zinc			
Trade size		Type			Non-insulated			Insulated			Non-insulated		Insulated	
UL Inch	CSA mm	ISO/BS EN mm	Std.	Thread	Straight Part no.	45° Part no.	90° Part no.	Straight Part no.	45° Part no.	90° Part no.	Straight Part No.	90° Part No.	Straight Part no.	90° Part No.
3/8	12	16	NPT	3/8"	LT38-SC	LT438-SC	LT938-SC	LT38T-SC	LT438T-SC	LT938T-SC	LT-200	LT-290	LT-800	LT-890
1/2	16	20	NPT	1/2"	LT50-SC	LT450-SC	LT950-SC	LT50T-SC	LT450T-SC	LT950T-SC	LT-201	LT-291	LT-801	LT-891
3/4	21	25	NPT	3/4"	LT75-SC	LT475-SC	LT975-SC	LT75T-SC	LT475T-SC	LT975T-SC	LT-202	LT-292	LT-802	LT-892
1	27	32	NPT	1"	LT100-SC	LT4100-SC	LT9100-SC	LT100T-SC	LT4100T-SC	LT9100T-SC	LT-203	LT-293	LT-803	LT-893
1-1/4	35	40	NPT	1-1/4"	LT125-SC	LT4125-SC	LT9125-SC	LT125T-SC	LT4125T-SC	LT9125T-SC	LT-204	LT-294	LT-804	LT-894
1-1/2	41	50	NPT	1-1/2"	LT150-SC	LT4150-SC	LT9150-SC	LT150T-SC	LT4150T-SC	LT9150T-SC	LT-205	LT-295	LT-805	LT-895
2	53	63	NPT	2"	LT200-SC	LT4200-SC	LT9200-SC	LT200T-SC	LT4200T-SC	LT9200T-SC	LT-206	LT-296	LT-806	LT-896
2-1/2	63	70	NPT	2-1/2"	LT250-SC	LT4250-SC	LT9250-SC	LT250T-SC	LT4250T-SC	LT9250T-SC	LT-207	LT-297	LT-807	LT-897
3	78	80	NPT	3"	LT300-SC	LT4300-SC	LT9300-SC	LT300T-SC	LT4300T-SC	LT9300T-SC	LT-208	LT-298	LT-808	-
4	103	100	NPT	4"	LT400-SC	LT4400-SC	LT9400-SC	LT400T-SC	LT4400T-SC	LT9400T-SC	LT-210	LT-2910	LT-810	-

**Sealing o-rings - die-cast zinc**

Trade size	Part no.
3/8"	SR 101
1/2"	SR 102
3/4"	SR 103
1"	SR 104
1-1/4"	SR 105
1-1/2"	SR 106

## General purpose steel — flexible metal conduits

Type CMSU — UL Listed



### Type CMSU — general purpose “thin wall” steel

Commercial grade liquid-tight flexible metal conduits, designed for use with Steel City® liquid-tight fittings. Typically used in “Greenfield” commercial construction and infrastructure applications.

**Materials:** Reduced wall galvanized steel core, non-jacketed

**Color:** Metallic

### Approvals:



UL1  
File No. E484989  
(excludes 4")



CSA C 22.2, No. 56  
File No.: LR-72635  
(3/8 and 7/16 Size Only)



IEC EN 61386-1, -23  
EU DoC: EC-012-17-173



### Steel City® flexible metal conduits

Trade size			Coil length									Specifications				
UL	CSA	ISO/ BS EN	Standard carton			Small reel			Bulk reel			UL bond wire	Id range (nominal)		Min. inside bend radius	
			Part no.	Ft	M	Part no.	Ft	M	Part no.	Ft	M		Inch	mm	Inch	mm
3/8	12	16	CMSUS01M-C	100	30	-	-	-	CMSUS01M-L	1,000	300	No	0.375 to 0.393 (0.384)	9.5 to 10.0 (9.75)	2.0	51
1/2	16	20	CMSUS02M-C	100	30	-	-	-	CMSUS02M-L	1,000	300	No	0.625 to 0.645 (0.635)	15.9 to 16.4 (16.2)	3.0	76
3/4	21	25	CMSUS03M-C	100	30	CMSUS03M-K	500	150	-	-	-	No	0.815 to 0.825 (0.825)	20.6 to 21.2 (20.9)	4.0	10
1	27	32	CMSUS04M-B	50	15	CMSUS04M-J	400	120	-	-	-	No	1.000 to 1.040 (1.020)	25.4 to 26.1 (25.8)	5.0	127
1 1/4	35	40	CMSUS05M-B	50	15	CMSUS05M-J	400	120	-	-	-	No	1.250 to 1.300 (1.275)	31.8 to 33.0 (32.4)	6.2	157
1 1/2	41	50	CMSUS06M-A	25	8	CMSUS06M-H	300	90	-	-	-	No	1.500 to 1.575 (1.538)	38.1 to 40.0 (39.0)	7.5	191
2	53	63	CMSUS07M-A	25	8	CMSUS07M-D	150	45	-	-	-	No	2.000 to 2.080 (2.040)	50.8 to 52.8 (51.8)	10.0	254
2 1/2	63	70	CMSUS08M-A	25	8	-	-	-	-	-	-	No	2.500 to 2.700 (2.600)	63.5 to 68.5 (66.0)	12.5	318
3	78	80	CMSUS09M-A	25	8	-	-	-	-	-	-	No	3.000 to 3.200 (3.100)	76.2 to 81.3 (78.7)	15.0	381
4	103	100	CMSUS11M-A	25	8	-	-	-	-	-	-	No	4.000 to 4.200 (4.100)	106.7 to 110.7 (108.7)	20.0	508

**Note:** Product must be installed in accordance with applicable national and local electrical codes

For more information see  
Technical Data Sheet TDS000019.  
For download on our website.  
Please see also page 25  
for more information.

## Flexible metal conduit fittings

Series XC, 200 and 300





**Approvals:**

 **UL 514B**  
File No.: E1383, E-17909, E23018

 **UL 514B**  
File No.: 23018

 **UL 514B**  
File No.: 23018

 **CSA C22.2, No. 18**  
File No LR-12798, LR-18130M57

 **CSA C22.2, No. 18**  
File No. LR-2884



 **CSA 22.2, No. 18**  
File No.: LR-2884



		Steel City® fittings								T&B fittings						
		Series XC squeeze type				Series 200 squeeze type				Series 300/3100 Tite-Bite®						
		Die-cast zinc				Steel/malleable iron				Steel/malleable iron						
Trade size		Type		Non-insulated		Insulated		Non-insulated		Insulated		Non-insulated		Insulated		
UL	CSA	ISO/ BS EN	Std.	Thread	Straight Part no.	90° Part no.	Straight Part no.	90° Part no.	Straight Part no.	90° Part no.	Straight Part no.	90° Part no.	Straight Part No.	90° Part No.	Straight Part no.	90° Part No.
3/8	12	16	NPS	3/8	XC-269	XC-290	-	XC-890	253-TB	272	253-I-TB	272-I	301-TB	321-TB	3110-TB	3130-TB
1/2	16	20	NPS	1/2	XC-270	XC-291	XC-870	XC-891	254-TB	268-TB	254-I-TB	268-I-TB	302-TB	323	3112	3132
3/4	21	25	NPS	3/4	XC-272	XC-292	XC-872	XC-892	255	270	255-I	270-I	304	325	3115	3135
1	27	32	NPS	1	XC-273	XC-293	XC-873	XC-893	256	273-TB	256-I	273-I-TB	306	326-TB	3117	3137
1 1/4	35	40	NPS	1 1/4	XC-274	XC-294	XC-874	XC-894	257	274	257-I	274-I	308	327-TB	3118	3138
1 1/2	41	50	NPS	1 1/2	XC-275	XC-295	XC-875	XC-895	258	275	258-I	275-I	310	328	3119	3139
2	53	63	NPS	2	XC-276	XC-296	XC-876	XC-896	259	276	259-I	276-I	312	329	3120	3140
2 1/2	63	70	NPS	2 1/2	XC-277	XC-297	XC-877	XC-897	249	282-TB	249-I	282-I-TB	314	330-TB	3121	3141
3	78	80	NPS	3	XC-278	XC-298	XC-878	XC-898	277	283-TB	277-I	283-I-TB	316	331	3122	3142
4	103	100	NPS	4	XC-2710	XC-2910	XC-8710	XC-8910	281-TB	285-TB	281-I-TB	285-I-TB	320	3144-TB	3124	3144-TB

## General purpose aluminum — flexible metal conduits

Type CMAU — UL Listed



### Type CMAU — general purpose “thin wall” aluminum

Commercial grade aluminum flexible metal conduits, designed for use with Steel City® fittings. Typically used in “Greenfield” commercial construction and infrastructure applications.

**Materials:** Reduced wall aluminum core, non-jacketed

**Color:** Metallic

### Approvals:



**UL1**  
File No.: E484989  
(excludes 7/16" size)



**IEC EN 61386-1, -23**  
EU DoC: EC-012-17-174



**CSA C22.2, No. 56**  
File No.: LR-72635  
(3/8 and 7/16" only)



### Steel City® flexible metal conduits

Trade size			Coil length										Specifications			
UL	CSA	ISO/ BS EN	Standard carton			Small reel			Bulk reel			UL bond wire	ID range (nominal)		Min. Inside bend radius	
			Part no.	Ft	M	Part no.	Ft	M	Part no.	Ft	M		Inch	mm	Inch	mm
3/8	12	16	CMAUS01M-C	100	30	-	-	-	CMAUS01M-L	1,000	300	No	0.375 to 0.393 (0.384)	9.5 to 10.0 (9.75)	2.0	51
7/16	14	18	CMAUS14M-C	100	30	-	-	-	CMAUS14M-L	1,000	300	No	0.437 to 0.457 (0.447)	11.1 to 11.5 (9.75)	2.3	57
1/2	16	20	CMAUS02M-C	100	30	-	-	-	CMAUS02M-L	1,000	300	No	0.625 to 0.645 (0.635)	15.9 to 16.4 (16.2)	3.0	76
3/4	21	25	CMAUS03M-C	100	30	CMAUS03M-K	500	150	-	-	-	No	0.815 to 0.825 (0.825)	20.6 to 21.2 (20.9)	4.0	102
1	27	32	CMAUS04M-B	50	15	CMAUS04M-J	400	120	-	-	-	No	1.000 to 1.040 (1.020)	25.4 to 26.1 (25.8)	5.0	127
1 1/4	35	40	CMAUS05M-B	50	15	CMAUS05M-J	400	120	-	-	-	No	1.250 to 1.300 (1.275)	31.8 to 33.0 (32.4)	6.2	157
1 1/2	41	50	CMAUS06M-A	25	8	CMAUS06M-H	300	90	-	-	-	No	1.500 to 1.575 (1.538)	38.1 to 40.0 (39.0)	7.5	191
2	53	63	CMAUS07M-A	25	8	CMAUS07M-D	150	45	-	-	-	No	2.000 to 2.080 (2.040)	50.8 to 52.8 (51.8)	10.0	254
2 1/2	63	70	CMAUS08M-A	25	8	-	-	-	-	-	-	No	2.500 to 2.700 (2.600)	63.5 to 68.5 (66.0)	12.5	318
3	78	80	CMAUS09M-A	25	8	-	-	-	-	-	-	No	3.000 to 3.200 (3.100)	76.2 to 81.3 (78.7)	15.0	381
4	103	100	CMAUS11M-A	25	8	-	-	-	-	-	-	No	4.000 to 4.200 (4.100)	106.7 to 110.7 (108.7)	20.0	508

**Note:** Product must be installed in accordance with applicable national and local electrical codes

For more information see  
Technical Data Sheet TDS000018.  
For download on our website.  
Please see also page 25 for more  
information.

## Flexible metal conduit fittings

Series XC, 200 and 300



**Approvals:**



**UL 514 B**  
File No.: E1383, E-17909,  
E23018



**UL 514 B**  
File No.: E23018



**UL 514B**  
File No.: 23018



**CSA C22.2, No. 18**  
File No. LR-12798,  
LR-18130M57



**CSA C22.2, No. 18**  
File No. LR-2884



**CSA 22.2, No. 18**  
File No.: LR-2884



		Steel City® fittings								T&B fittings						
		Series XC squeeze type				Series 200 squeeze type				Series 300/3100 Tite-Bite®						
		Die-cast zinc				Steel/malleable iron				Steel/malleable iron						
Trade size		Type		Non-insulated		Insulated		Non-insulated		Insulated		Non-insulated		Insulated		
UL	CSA	ISO/ BS EN	Std.	Thread	Straight Part no.	90° Part no.	Straight Part no.	90° Part no.	Straight Part no.	90° Part no.	Straight Part no.	90° Part no.	Straight Part No.	90° Part No.	Straight Part no.	90° Part No.
3/8	12	16	NPS	3/8	XC-269	XC-290	-	XC-890	253-TB	272	253-I-TB	272-I	301-TB	321-TB	3110-TB	3130-TB
-	-	-	-	-	-	-	-	-	-	-	-	-	-	-	-	-
1/2	16	20	NPS	1/2	XC-270	XC-291	XC-870	XC-891	254-TB	268-TB	254-I-TB	268-I-TB	302-TB	323	3112	3132
3/4	21	25	NPS	3/4	XC-272	XC-292	XC-872	XC-892	255	270	255-I	270-I	304	325	3115	3135
1	27	32	NPS	1	XC-273	XC-293	XC-873	XC-893	256	273-TB	256-I	273-I-TB	306	326-TB	3117	3137
1 1/4	35	40	NPS	1 1/4	XC-274	XC-294	XC-874	XC-894	257	274	257-I	274-I	308	327-TB	3118	3138
1 1/2	41	50	NPS	1 1/2	XC-275	XC-295	XC-875	XC-895	258	275	258-I	275-I	310	328	3119	3139
2	53	63	NPS	2	XC-276	XC-296	XC-876	XC-896	259	276	259-I	276-I	312	329	3120	3140
2 1/2	63	70	NPS	2 1/2	XC-277	XC-297	XC-877	XC-897	249	282-TB	249-I	282-I-TB	314	330-TB	3121	3141
3	78	80	NPS	3	XC-278	XC-298	XC-878	XC-898	277	283-TB	277-I	283-I-TB	316	331	3122	3142
4	103	100	NPS	4	XC-2710	XC-2910	XC-8710	XC-8910	281-TB	285-TB	281-I-TB	285-I-TB	320	3144-TB	3124	3144-TB

## General purpose aluminum — flexible metal conduits

Type CMAC — CSA Certified



### Type CMAC — general purpose “heavy wall” aluminum

Commercial grade aluminum flexible metal conduits, designed for use with Steel City® fittings. Typically used in “Greenfield” commercial construction and infrastructure applications.

**Materials:** Heavy wall aluminum core, non-jacketed

**Color:** Metallic

### Approvals:



CSA C22.2, No. 56  
File No.: LR-72635



UL 1  
File No.: E484989



IEC EN 61386-1, -23  
EU DoC: EC-012-17-172



### Steel City® flexible metal conduits

Trade size			Coil length									Specifications				
UL	CSA	ISO/ BS EN	Standard carton			Small reel			Bulk reel			UL bond wire	Id range (nominal)		Min. Inside bend radius	
			Part no.	Ft	M	Part no.	Ft	M	Part no.	Ft	M		Inch	mm	Inch	mm
3/8	12	16	CMACS01M-C	100	30	CMACS01M-K	500	150	CMACS01M-L	1,000	300	No	0.375 to 0.393 (0.384)	9.5 to 10.0 (9.75)	2.0	51
7/16	14	18	CMACS14M-C	100	30	CMACS14M-K	500	150	CMACS14M-L	1,000	300	No	0.437 to 0.457 (0.447)	11.1 to 11.5 (9.75)	2.3	57
1/2	16	20	CMACS02M-C	100	30	CMACS02M-K	500	150	CMACS02M-L	1,000	300	No	0.625 to 0.645 (0.635)	15.9 to 16.4 (16.2)	3.0	76
3/4	21	25	CMACS03M-C	100	30	CMACS03M-K	500	150	CMACS03M-L	1,000	300	No	0.815 to 0.825 (0.825)	20.6 to 21.2 (20.9)	4.0	102
1	27	32	CMACS04M-B	50	15	CMACS04M-J	400	120	-	-	-	No	1.000 to 1.040 (1.020)	25.4 to 26.1 (25.8)	5.0	127
1 1/4	35	40	CMACS05M-B	50	15	CMACS05M-J	400	120	-	-	-	No	1.250 to 1.300 (1.275)	31.8 to 33.0 (32.4)	6.2	157
1 1/2	41	50	CMACS06M-A	25	8	CMACS06M-H	300	90	-	-	-	No	1.500 to 1.575 (1.538)	38.1 to 40.0 (39.0)	7.5	191
2	53	63	CMACS07M-A	25	8	CMACS07M-D	150	45	-	-	-	No	2.000 to 2.080 (2.040)	50.8 to 52.8 (51.8)	10.0	254
2 1/2	63	70	CMACS08M-A	25	8	-	-	-	-	-	-	No	2.500 to 2.700 (2.600)	63.5 to 68.5 (66.0)	12.5	318
3	78	80	CMACS09M-A	25	8	-	-	-	-	-	-	No	3.000 to 3.200 (3.100)	76.2 to 81.3 (78.7)	15.0	381
4	103	100	CMACS11M-A	25	8	-	-	-	-	-	-	No	4.000 to 4.200 (4.100)	106.7 to 110.7 (108.7)	20	508

**Note:** Product must be installed in accordance with applicable national and local electrical codes

For more information see  
Technical Data Sheet TDS000018.  
For download on our website.  
Please see also page 25  
for more information.

## Flexible metal conduit fittings

Series XC, 200 and 300





**Approvals:**

 **UL 514 B**  
File No.: E1383, E-17909,  
E23018

 **UL 514 B**  
File No.: E23018

 **UL 514B**  
File No.: 23018

 **CSA C22.2, No. 18**  
File No. LR-12798,  
LR-18130M57

 **CSA C22.2, No. 18**  
File No. LR-2884



 **CSA 22.2, No. 18**  
File No.: LR-2884



		Steel City® fittings								T&B fittings						
		Series XC squeeze type				Series 200 squeeze type				Series 300/3100 Tite-Bite®						
		Die-cast zinc				Steel/malleable iron				Steel/malleable iron						
Trade size		Type		Non-insulated		Insulated		Non-insulated		Insulated		Non-insulated		Insulated		
UL	CSA	ISO/ BS EN	Std.	Thread	Straight Part no.	90° Part no.	Straight Part no.	90° Part no.	Straight Part no.	90° Part no.	Straight Part no.	90° Part no.	Straight Part No.	90° Part No.	Straight Part no.	90° Part No.
3/8	12	16	NPS	3/8	XC-269	XC-290	-	XC-890	253-TB	272	253-I-TB	272-I	301-TB	321-TB	3110-TB	3130-TB
-	-	-	-	-	-	-	-	-	-	-	-	-	-	-	-	-
1/2	16	20	NPS	1/2	XC-270	XC-291	XC-870	XC-891	254-TB	268-TB	254-I-TB	268-I-TB	302-TB	323	3112	3132
3/4	21	25	NPS	3/4	XC-272	XC-292	XC-872	XC-892	255	270	255-I	270-I	304	325	3115	3135
1	27	32	NPS	1	XC-273	XC-293	XC-873	XC-893	256	273-TB	256-I	273-I-TB	306	326-TB	3117	3137
1 1/4	35	40	NPS	1 1/4	XC-274	XC-294	XC-874	XC-894	257	274	257-I	274-I	308	327-TB	3118	3138
1 1/2	41	50	NPS	1 1/2	XC-275	XC-295	XC-875	XC-895	258	275	258-I	275-I	310	328	3119	3139
2	53	63	NPS	2	XC-276	XC-296	XC-876	XC-896	259	276	259-I	276-I	312	329	3120	3140
2 1/2	63	70	NPS	2 1/2	XC-277	XC-297	XC-877	XC-897	249	282-TB	249-I	282-I-TB	314	330-TB	3121	3141
3	78	80	NPS	3	XC-278	XC-298	XC-878	XC-898	277	283-TB	277-I	283-I-TB	316	331	3122	3142
4	103	100	NPS	4	XC-2710	XC-2910	XC-8710	XC-8910	281-TB	285-TB	281-I-TB	285-I-TB	320	3144-TB	3124	3144-TB

## Product selection

### Accessories



#### Conduit supports

Zinc-plated steel conduit supports used to support and securely fasten flexible metallic, rigid, IMC and EMT conduit.

#### Application:

- For use with flexible metallic, rigid, IMC and EMT conduits
- Commercial and light industrial applications
- Schools, hospitals, office buildings, hotels, etc.

#### Features:

- Trade sizes from 3/8" to 4" (3/8" available in one-hole type only)
- Available in one-hole and two-hole configurations
- Screwing type of fastening

**Material/Finish:** Steel, zinc plated

#### Approvals:



CSA Certified

#### Conduit straps — steel/zinc plated

Trade size Inches	One hole - steel zinc plated		Two hole - steel zinc plated	
	Part no.	Hole size Inches	Part no.	Hole size Inches
3/8	HS-100-SC	10	—	—
1/2	HS-101	1/4	HS-901	8
3/4	HS-102	1/4	HS-902	10
1	HS-103	1/4	HS-903	1/4
1 1/4	HS-104	5/16	HS-904	1/4
1 1/2	HS-105	3/8	HS-905	1/4
2	HS-106	3/8	HS-906	1/4
2 1/2	HS-107	7/16	HS-907	1/4
3	HS-108	1/2	HS-908	1/2
3 1/2	HS-109	1/2	HS-909	1/4
4	HS-110	1/2	HS-910	1/4



## Technical data

### Approximate dimensions

#### One-hole straps

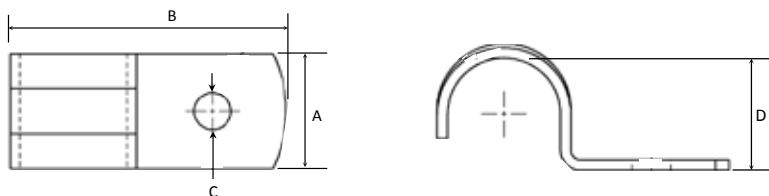

One-hole straps — steel/zinc plated

Cat. no.	Conduit size			Screw size (in.)	Dimensions (in.)				Dimensions (mm.)				Std. ctn.
	Inches	Metric	ISO BS EN		A	B	C	D	A	B	C	D	
HS-100-SC	3/8	12mm	16mm	10	3/4	1 3/4	22/63	5/8	19.0	44.5	6.7	15.1	1,000
HS-101	1/2	16mm	20mm	1/4	1	1 15/16	9/32	1 3/16	25.4	49.2	7.1	20.6	500
HS-102	3/4	21mm	25mm	1/4	1	2 5/16	9/32	1 1/32	25.4	58.7	7.1	26.2	500
HS-103	1	27mm	32mm	1/4	1	2 13/32	9/32	1 3/16	25.4	61.1	7.1	30.9	250
HS-104	1 1/4	35mm	40mm	5/16	1	3 3/32	11/32	1 9/16	25.4	78.6	8.7	39.7	100
HS-105	1 1/2	41mm	50mm	3/8	1 3/16	3 13/32	13/32	1 3/4	30.2	86.5	10.3	44.9	100
HS-106	2	53mm	63mm	3/8	1 3/16	3 27/32	13/32	2 3/16	30.2	97.6	10.3	56.0	100
HS-107	2 1/2	63mm	70mm	7/16	1 1/4	5 1/16	22/47	2 11/16	31.8	128.6	11.9	68.3	25
HS-108	3	78mm	80mm	1/2	1 3/8	5 7/8	17/32	3 5/16	34.9	149.2	13.5	84.5	25
HS-110	4	103mm	100mm	1/2	1 3/8	6 7/8	17/32	4 3/8	34.9	174.6	13.5	111.1	10

#### Two-hole straps

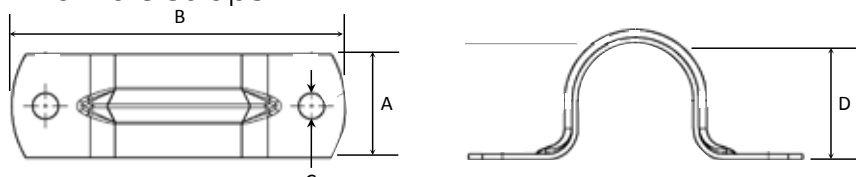

Two-hole straps — steel/zinc plated

Cat. no.	Conduit size			Screw size (in.)	Dimensions (in.)				Dimensions (mm.)				Std. ctn.
	Inches	Metric	ISO BS EN		A	B	C	D	A	B	C	D	
HS-901	1/2	16mm	20mm	1/4	1	1 15/16	0.281	1 3/16	25.4	49.2	7.1	21.3	1,200
HS-902	3/4	21mm	25mm	1/4	1	2 5/16	0.281	1 1/16	25.4	58.7	7.1	26.7	900
HS-903	1	27mm	32mm	1/4	1	2 13/32	0.281	1 9/16	25.4	61.1	7.1	33.3	600
HS-904	1 1/4	35mm	40mm	5/16	1	3 3/32	0.344	1 5/8	25.4	78.6	8.7	42.2	450
HS-905	1 1/2	41mm	50mm	3/8	1 3/16	3 13/32	0.406	1 7/8	30.2	86.5	10.3	48.3	50
HS-906	2	53mm	63mm	3/8	1 3/16	3 27/32	0.406	2 3/8	30.2	97.6	10.3	60.3	150
HS-907	2 1/2	63mm	70mm	7/16	1 1/4	5 1/16	0.468	2 7/8	31.8	128.6	11.9	73.0	150
HS-908	3	78mm	80mm	1/2	1 3/8	5 7/8	0.531	3 3/8	34.9	149.2	13.5	85.9	60
HS-910	4	103mm	100mm	1/2	1 3/8	6 7/8	0.531	4 3/8	34.9	174.6	13.5	111.1	60

## Technical data

### Approximate dimensions

#### Liquid-tight Flexible Metal Conduits (LFMC)

Liquid-tight flexible metallic conduits are all designed to UL 360 ID and OD dimensions to insure coordinated performance with Ser. LT liquidtight fittings



Part no.	Trade size			Inches				Millimeters			
	UL	CSA	ISO/BS EN	Inside (ID)		Outside (OD)		Inside (ID)		Outside (OD)	
	Inches	mm	mm	Min	Max	Min	Max	Min	Max	Min	Max
LTGUS01G-*	3/8	12	16	0.484	0.504	0.690	0.710	12.3	12.8	17.5	18.0
LTGUS02G-*	1/2	16	20	0.622	0.642	0.820	0.840	15.8	16.3	20.8	21.3
LTGUS03G-*	3/4	21	25	0.820	0.840	1.030	1.050	20.8	21.3	26.2	26.7
LTGUS04G-*	1	27	32	1.041	1.066	1.290	1.315	26.4	27.1	32.8	33.4
LTGUS05G-*	1 1/4	35	40	1.380	1.410	1.630	1.660	35.1	35.8	41.4	42.2
LTGUS06G-*	1 1/2	41	50	1.575	1.600	1.865	1.900	40.0	40.6	47.4	48.3
LTGUS07G-*	2	53	63	2.020	2.045	2.340	2.375	51.3	51.9	59.4	60.3
LTGUS08G-*	2 1/2	63	70	2.480	2.505	2.840	2.875	63.0	63.6	72.1	73.0
LTGUS09G-*	3	78	80	3.070	3.100	3.460	3.500	78.0	78.7	87.9	88.8
LTGUS11G-*	4	103	100	4.000	4.040	4.460	4.500	101.6	102.6	113.3	114.3

#### Flexible Metal Conduits (FMC)

Flexible metal conduits are designed to UL 1 ID and OD dimensions to insure coordinated performance with Ser. 200, 300 and XC fittings

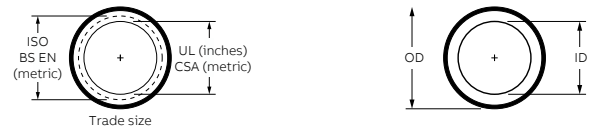

Part no.	Trade size			Inches				Millimeters			
	UL	CSA	ISO BS EN	Inside (ID)		Outside (OD)		Inside (ID)		Outside (OD)	
	Inches	mm	mm	Min	Max	Min	Max	Min	Max	Min	Max
CMxxS01M-*	3/8	12	16	0.375	0.393	0.560	0.610	9.5	10.0	14.2	15.5
CMxxS02M-*	1/2	16	20	0.625	0.645	0.860	0.920	15.9	16.4	21.8	23.4
CMxxS03M-*	3/4	21	25	0.081	0.835	1.045	1.105	20.6	21.2	26.5	28.1
CMxx04M-*	1	27	32	1.000	1.040	1.300	1.380	25.4	26.4	33.0	35.1
CMxxS05M-*	1 1/4	35	40	1.250	1.300	1.550	1.630	31.8	33.0	39.4	41.4
CMxxS06M-*	1 1/2	41	50	1.500	1.575	1.850	1.950	38.1	40.0	47.0	49.5
CMxxS07M-*	2	53	63	2.000	2.080	2.350	2.454	50.8	52.8	59.7	62.3
CMxxS08M-*	2 1/2	63	70	2.500	2.700	2.860	3.060	63.5	68.2	72.6	77.7
CMxxS09M-*	3	78	80	3.000	3.200	3.360	3.560	76.2	81.3	85.3	90.4
CMxxS11M-*	4	103	100	4.000	4.200	4.360	4.560	101.6	106.7	110.7	115.8

**Note:** Product must be installed in accordance with applicable national and local electrical codes.

## Technical data

### Approximate dimensions

#### Series LT commercial LT fittings

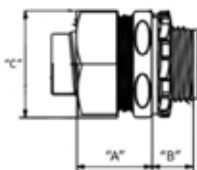
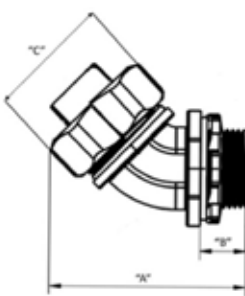
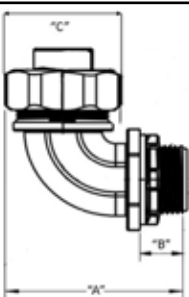
Approximate dimensions									
Straight fittings — NPT, ISO threads									
Trade size			Inches			Millimeters			
Inches	Metric	ISO/BS EN	A	B	C	A	B	C	
	3/8	12	16	0.41	0.55	1.06	10.5	14.0	27.0
	1/2	16	20	0.54	0.55	1.17	13.6	14.0	29.8
	3/4	21	25	0.54	0.59	1.42	13.8	15.0	36.0
	1	27	32	0.57	0.67	1.71	14.6	17.0	43.5
	1 1/4	35	40	0.66	0.70	2.13	16.8	17.7	54.0
	1 1/2	41	50	0.85	0.70	2.40	21.6	17.7	61.0
	2	53	63	0.90	0.79	2.94	22.8	20.0	74.7
	2 1/2	63	70	1.08	1.02	3.70	27.5	26.0	94.0
	3	78	80	1.20	1.10	4.41	30.5	28.0	112.0
	4	103	100	1.34	1.18	5.63	34.0	30.0	143.0
<b>45° fittings — NPT, ISO threads</b>									
	3/8	12	16	1.50	0.55	1.06	38.0	14.0	27.0
	1/2	16	20	1.85	0.55	1.17	47.0	14.0	29.8
	3/4	21	25	2.09	0.59	1.42	53.0	15.0	36.0
	1	27	32	2.87	0.67	1.71	73.0	17.0	43.5
	1 1/4	35	40	3.00	0.70	2.13	76.3	17.7	54.0
	1 1/2	41	50	3.04	0.70	2.40	77.3	17.7	61.0
	2	53	63	3.70	0.79	2.94	94.0	20.0	74.7
	2 1/2	63	70	5.75	1.02	3.70	146.0	26.0	94.0
	3	78	80	6.04	1.10	4.41	153.5	28.0	112.0
	4	103	100	7.05	1.18	5.63	179.0	30.0	143.0
<b>90° fittings — NPT, ISO threads</b>									
	3/8	12	16	1.48	0.55	1.06	37.5	14.0	27.0
	1/2	16	20	1.52	0.55	1.17	38.5	14.0	29.8
	3/4	21	25	1.91	0.59	1.42	48.6	15.0	36.0
	1	27	32	2.24	0.67	1.71	57.0	17.0	43.5
	1 1/4	35	40	2.61	0.70	2.13	66.3	17.7	54.0
	1 1/2	41	50	2.81	0.70	2.40	71.3	17.7	61.0
	2	53	63	3.52	0.79	2.94	89.5	20.0	74.7
	2 1/2	63	70	5.18	1.02	3.70	131.6	26.0	94.0
	3	78	80	6.02	1.10	4.41	153.0	28.0	112.0
	4	103	100	7.09	1.18	5.63	180.0	30.0	143.0

## Technical data

### Approximate dimensions

#### Series 200 squeeze fittings — steel

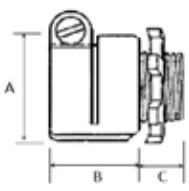
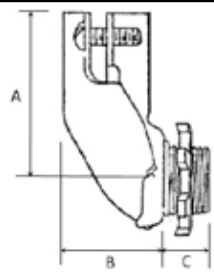
Approximate dimensions									
Straight fittings — NPS threads									
Trade Size			Inches			Millimeters			
Inches	Metric	ISO/BS EN	A	B	C	A	B	C	
	3/8	12	16	1 1/16	7/8	13/32	27.0	23.1	10.3
	1/2	16	20	1 7/32	7/8	13/32	31.0	23.1	10.3
	3/4	21	25	1 1/4	1	7/16	31.8	25.4	11.1
	1	27	32	1 19/32	1	1/2	40.5	25.4	12.7
	1 1/4	35	40	1 7/8	1 1/16	17/32	47.6	25.5	13.5
	1 1/2	41	50	2 1/4	1 3/4	9/16	57.2	44.5	14.3
	2	53	63	2 31/32	1 15/16	11/16	75.4	49.2	17.5
	2 1/2	63	70	3 5/16	1 13/16	3/4	84.1	46.0	19.1
	3	78	80	3 13/16	2	3/4	96.8	50.8	19.1
	4	103	100	5 3/32	4 3/32	1 5/8	129.4	104.0	41.3
90° fittings — NPS threads									
	3/8	12	16	1 1/16	1 1/8	7/16	36.5	28.6	11.1
	1/2	16	20	1 7/8	1 7/32	13/32	47.6	31.0	11.9
	3/4	21	25	1 13/16	1 7/16	7/16	46.0	36.5	11.1
	1	27	32	2 7/16	1 13/16	9/16	57.6	46.0	14.3
	1 1/4	35	40	3	2 1/4	5/8	76.2	57.2	15.9
	1 1/2	41	50	4	2 29/32	5/8	101.6	73.8	15.9
	2	53	63	4 7/8	3 7/8	3/4	123.8	98.4	19.1
	2 1/2	63	70	7 9/16	4 11/16	1 1/32	192.1	119.1	26.2
	3	78	80	8 15/16	5 9/16	1 1/16	227.0	141.3	27.0
4	103	100	12 3/8	7 7/8	1 9/16	314.3	181.0	39.7	

## Technical data

### Approximate dimensions

#### Series 300 Tite-Bite fittings

Straight fittings — NPS threads									
Trade size			Inches			Millimeters			
Inches	Metric	ISO/BS EN	A	B	C	A	B	C	
3/8	12	16	17/16	7/16	7/16	36.5	11.1	11.1	
1/2	16	20	125/32	19/32	15/32	45.2	32.5	11.9	
3/4	21	25	2	19/32	15/32	50.8	32.5	11.9	
1	27	32	23/8	17/32	17/32	60.3	31.0	13.5	
1 1/4	35	40	23/4	111/32	21/32	69.9	34.1	16.7	
1 1/2	41	50	33/8	17/8	3/4	79.4	47.6	19.0	
2	53	63	33/4	115/16	13/16	95.3	49.2	20.6	
2 1/2	63	70	43/8	23/8	7/8	111.1	60.3	22.2	
3	78	80	5	23/8	7/8	127.0	60.3	22.2	
4	103	100	53/4	21/2	19/32	146.0	63.5	32.5	

90° fittings — NPS threads									
Trade size			Inches			Millimeters			
Inches	Metric	ISO/BS EN	A	B	C	A	B	C	
3/8	12	16	119/32	111/32	7/16	26.0	25.7	11.1	
1/2	16	20	25/16	17/8	15/32	51.1	26.3	11.9	
3/4	21	25	21/8	2	15/32	50.9	50.8	11.9	
1	27	32	21/8	221/32	1/2	50.9	51.5	12.7	
1 1/4	35	40	27/8	31/8	3/4	51.7	76.3	19.1	
1 1/2	41	50	4	43/8	13/16	101.6	102.0	20.6	
2	53	63	47/8	59/16	1	102.5	153.0	25.4	
2 1/2	63	70	6	525/32	1	152.4	153.2	25.4	
3	78	80	7	6	1	177.8	147.0	25.4	
4	103	100	73/4	629/32	11/8	178.1	147.9	28.6	

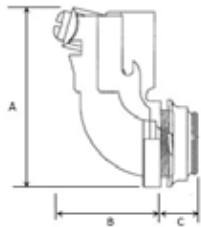
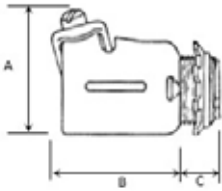

## Technical data

### Approximate dimensions

#### Series XC squeeze fittings — die-cast zinc

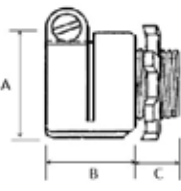
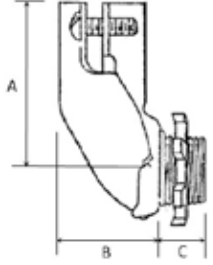
		Straight fittings — NPS threads								
		Trade size			Inches			Millimeters		
		Inches	Metric	ISO/BS EN	A	B	C	A	B	C
	$\frac{3}{8}$	12	16	$1\frac{1}{16}$	$\frac{7}{8}$	$\frac{13}{32}$	27.0	23.1	10.3	
	$\frac{1}{2}$	16	20	$1\frac{7}{32}$	$\frac{7}{8}$	$\frac{13}{32}$	31.0	23.1	10.3	
	$\frac{3}{4}$	21	25	$1\frac{1}{4}$	1	$\frac{7}{16}$	31.8	25.4	11.1	
	1	27	32	$1\frac{19}{32}$	1	$\frac{1}{2}$	40.5	25.4	12.7	
	$1\frac{1}{4}$	35	40	$1\frac{7}{8}$	$1\frac{1}{16}$	$\frac{17}{32}$	47.6	25.5	13.5	
	$1\frac{1}{2}$	41	50	$2\frac{1}{4}$	$1\frac{3}{4}$	$\frac{9}{16}$	57.2	44.5	14.3	
	2	53	63	$2\frac{31}{32}$	$1\frac{15}{16}$	$\frac{11}{16}$	75.4	49.2	17.5	
	$2\frac{1}{2}$	63	70	$3\frac{5}{16}$	$1\frac{13}{16}$	$\frac{3}{4}$	84.1	46.0	19.1	
3	78	80	$3\frac{13}{16}$	2	$\frac{3}{4}$	96.8	50.8	19.1		
		90° fittings — NPS threads								
	$\frac{3}{8}$	12	16	$1\frac{1}{16}$	$1\frac{1}{8}$	$\frac{7}{16}$	36.5	28.6	11.1	
	$\frac{1}{2}$	16	20	$1\frac{7}{8}$	$1\frac{7}{32}$	$\frac{15}{32}$	47.6	31.0	11.9	
	$\frac{3}{4}$	21	25	$1\frac{13}{16}$	$1\frac{7}{16}$	$\frac{7}{16}$	46.0	36.5	11.1	
	1	27	32	$2\frac{7}{16}$	$1\frac{13}{16}$	$\frac{9}{16}$	57.6	46.0	14.3	
	$1\frac{1}{4}$	35	40	3	$2\frac{1}{4}$	$\frac{5}{8}$	76.2	57.2	15.9	
	$1\frac{1}{2}$	41	50	4	$2\frac{29}{32}$	$\frac{5}{8}$	101.6	73.8	15.9	
	2	53	63	$4\frac{7}{8}$	$3\frac{7}{8}$	$\frac{3}{4}$	123.8	98.4	19.1	
	$2\frac{1}{2}$	63	70	$7\frac{9}{16}$	$4\frac{11}{16}$	$1\frac{1}{32}$	192.1	119.1	26.2	
3	78	80	$8\frac{15}{16}$	$5\frac{9}{16}$	$1\frac{1}{16}$	227.0	141.3	27.0		

# Index

## Order code classification

Part no.	GID Code	Page No.	Part no.	GID Code	Page No.	Part no.	GID Code	Page No.
254-I-TB	7TAA106070R0005	11	CLGES07G-C	7TAA012CA0R0016	8	CMSUS03M-C	7TAA012CC0R0002	10
254-TB	7TAA106050R0001	11	CLGES08G-A	7TAA012CA0R0007	8	CMSUS03M-K	7TAA012CC0R0012	10
255-I	7TAA106070R0006	11	CLGES09G-A	7TAA012CA0R0008	8	CMSUS04M-B	7TAA012CC0R0003	10
256-I	7TAA106070R0007	11	CLGES11G-A	7TAA012CA0R0009	8	CMSUS04M-J	7TAA012CC0R0013	10
257-I	7TAA106070R0008	11	CMACS01M-C	7TAA012CE0R0000	14	CMSUS05M-B	7TAA012CC0R0004	10
258-I	7TAA106070R0010	11	CMACS01M-K	7TAA012CE0R0011	14	CMSUS05M-J	7TAA012CC0R0014	10
259-I	7TAA106070R0011	11	CMACS01M-L	7TAA012CE0R0019	14	CMSUS06M-A	7TAA012CC0R0005	10
268-I-TB	7TAA106070R0018	11	CMACS02M-C	7TAA012CE0R0002	14	CMSUS06M-H	7TAA012CC0R0015	10
268-TB	7TAA106050R0003	11	CMACS02M-K	7TAA012CE0R0013	14	CMSUS07M-A	7TAA012CC0R0006	10
270-I	7TAA106070R0020	11	CMACS02M-L	7TAA012CE0R0021	14	CMSUS07M-D	7TAA012CC0R0016	10
272-I	7TAA106070R0022	11	CMACS03M-C	7TAA012CE0R0003	14	CMSUS08M-A	7TAA012CC0R0007	10
273-I-TB	7TAA106070R0023	11	CMACS03M-K	7TAA012CE0R0014	14	CMSUS09M-A	7TAA012CC0R0008	10
273-TB	7TAA106060R0008	11	CMACS03M-L	7TAA012CE0R0022	14	CMSUS11M-A	7TAA012CC0R0009	10
274-I	7TAA106070R0024	11	CMACS04M-B	7TAA012CE0R0004	14	HS-100-SC	7TBA117230R0000	17
275-I	7TAA106070R0025	11	CMACS04M-J	7TAA012CE0R0015	14	HS-101	7TAA117230R0001	17
276-I	7TAA106070R0026	11	CMACS05M-B	7TAA012CE0R0005	14	HS-102	7TAA117230R0002	17
277-I	7TAA106070R0028	11	CMACS05M-J	7TAA012CE0R0016	14	HS-103	7TAA117230R0003	17
281-I-TB	7TAA106070R0033	11	CMACS06M-A	7TAA012CE0R0006	14	HS-104	7TAA117230R0004	17
281-TB	7TAA106070R0034	11	CMACS06M-H	7TAA012CE0R0017	14	HS-105	7TAA117230R0005	17
282-I-TB	7TAA106070R0035	11	CMACS07M-A	7TAA012CE0R0007	14	HS-106	7TAA117230R0006	17
282-TB	7TAA106070R0036	11	CMACS07M-D	7TAA012CE0R0018	14	HS-107	7TBA117230R0007	17
283-I-TB	7TAA106070R0037	11	CMACS08M-A	7TAA012CE0R0008	14	HS-108	7TBA117230R0008	17
283-TB	7TAA106070R0038	11	CMACS09M-A	7TAA012CE0R0009	14	HS-110	7TBA117230R0010	17
285-I-TB	7TAA106070R0041	11	CMACS11M-A	7TAA012CE0R0010	14	HS-901	7TBA117230R0023	17
285-TB	7TAA106070R0042	11	CMACS14M-C	7TAA012CE0R0001	14	HS-902	7TBA117230R0024	17
301-TB	7TAA106040R0006	11	CMACS14M-K	7TAA012CE0R0012	14	HS-903	7TBA117230R0025	17
302-TB	7TAA106010R0001	11	CMACS14M-L	7TAA012CE0R0020	14	HS-904	7TBA117230R0026	17
3110-TB	7TAA106020R0002	11	CMAUS01M-C	7TAA012CD0R0000	12	HS-905	7TBA117230R0027	17
3130-TB	7TAA106030R0013	11	CMAUS01M-L	7TAA012CD0R0011	12	HS-906	7TBA117230R0028	17
3144-TB	7TAA106020R0012	11	CMAUS02M-C	7TAA012CD0R0002	12	HS-907	7TBA117230R0029	17
321-TB	7TAA106020R0013	11	CMAUS02M-L	7TAA012CD0R0013	12	HS-908	7TBA117230R0030	17
326-TB	7TAA106030R0022	11	CMAUS03M-C	7TAA012CD0R0003	12	HS-910	7TBA117230R0032	17
327-TB	7TAA106030R0023	11	CMAUS03M-K	7TAA012CD0R0014	12	LT100-SC	7TAA115120R0007	7
330-TB	7TAA106030R0026	11	CMAUS04M-B	7TAA012CD0R0004	12	LT100T-SC	7TAA115120R0000	7
CLGES01G-C	7TAA012CA0R0000	8	CMAUS04M-J	7TAA012CD0R0015	12	LT125-SC	7TAA115120R0001	7
CLGES01G-K	7TAA012CA0R0010	8	CMAUS05M-B	7TAA012CD0R0005	12	LT125T-SC	7TAA115120R0008	7
CLGES01G-L	7TAA012CA0R0017	8	CMAUS05M-J	7TAA012CD0R0016	12	LT150-SC	7TAA115120R0002	7
CLGES02G-C	7TAA012CA0R0001	8	CMAUS06M-A	7TAA012CD0R0006	12	LT150T-SC	7TAA115120R0009	7
CLGES02G-K	7TAA012CA0R0011	8	CMAUS06M-H	7TAA012CD0R0017	12	LT-200	7TAA010930R0000	7
CLGES02G-L	7TAA012CA0R0018	8	CMAUS07M-A	7TAA012CD0R0007	12	LT200-SC	7TAA115120R0012	7
CLGES03G-C	7TAA012CA0R0002	8	CMAUS07M-D	7TAA012CD0R0018	12	LT200T-SC	7TAA115120R0011	7
CLGES03G-K	7TAA012CA0R0012	8	CMAUS08M-A	7TAA012CD0R0008	12	LT-201	7TAA010910R0000	7
CLGES03G-L	7TAA012CA0R0019	8	CMAUS09M-A	7TAA012CD0R0009	12	LT-202	7TAA010910R0001	7
CLGES04G-C	7TAA012CA0R0003	8	CMAUS11M-A	7TAA012CD0R0010	12	LT-203	7TAA010920R0000	7
CLGES04G-J	7TAA012CA0R0013	8	CMAUS14M-C	7TAA012CD0R0001	12	LT-204	7TAA010920R0001	7
CLGES05G-B	7TAA012CA0R0004	8	CMAUS14M-L	7TAA012CD0R0012	12	LT-205	7TAA010920R0002	7
CLGES05G-E	7TAA012CA0R0014	8	CMSUS01M-C	7TAA012CC0R0000	10	LT-206	7TAA010910R0002	7
CLGES06G-B	7TAA012CA0R0005	8	CMSUS01M-L	7TAA012CC0R0010	10	LT-207	7TAA010920R0003	7
CLGES06G-D	7TAA012CA0R0015	8	CMSUS02M-C	7TAA012CC0R0001	10	LT-208	7TAA010910R0003	7
CLGES07G-B	7TAA012CA0R0006	8	CMSUS02M-L	7TAA012CC0R0011	10	LT-210	7TAA010920R0005	7

## Index

### Order code classification

Part no.	GID Code	Page No.	Part no.	GID Code	Page No.	Part no.	GID Code	Page No.
LT250-SC	7TAA115120R0013	7	LT-808	7TAA010980R0291	7	XC-269	7TAA010560R0007	11
LT250T-SC	7TAA115120R0060	7	LT-810	7TAA010980R0293	7	XC-270	7TAA010560R0008	11
LT-290	7TAA010930R0001	7	LT-890	7TAA010930R0005	7	XC-2710	7TAA010560R0009	11
LT-291	7TAA010910R0004	7	LT-891	7TAA010930R0006	7	XC-272	7TAA010560R0010	11
LT-2910	7TAA010930R0009	7	LT-892	7TAA010930R0007	7	XC-273	7TAA010560R0011	11
LT-292	7TAA010910R0005	7	LT-893	7TAA010930R0008	7	XC-274	7TAA010560R0012	11
LT-293	7TAA010920R0006	7	LT-894	7TAA010980R0294	7	XC-275	7TAA010560R0013	11
LT-294	7TAA010920R0007	7	LT-895	7TAA010980R0295	7	XC-276	7TAA010560R0014	11
LT-295	7TAA010920R0008	7	LT-896	7TAA010980R0296	7	XC-277	7TAA010560R0015	11
LT-296	7TAA010920R0009	7	LT-897	7TAA010980R0297	7	XC-278	7TAA010560R0016	11
LT-297	7TAA010920R0010	7	LT9100-SC	7TAA115120R0053	7	XC-290	7TAA010560R0017	11
LT-298	7TAA010920R0011	7	LT9100T-SC	7TAA115120R0055	7	XC-291	7TAA010560R0023	11
LT300-SC	7TAA115120R0013	7	LT9125-SC	7TAA115120R0054	7	XC-2910	7TAA010560R0024	11
LT300T-SC	7TAA115120R0017	7	LT9125T-SC	7TAA115120R0056	7	XC-292	7TAA010560R0018	11
LT38-SC	7TAA115600R0003	7	LT9150-SC	7TAA115120R0049	7	XC-293	7TAA010570R0007	11
LT38T-SC	7TAA115120R0003	7	LT9150T-SC	7TAA115120R0044	7	XC-294	7TAA010570R0014	11
LT400-SC	7TAA115120R0016	7	LT9200-SC	7TAA115120R0052	7	XC-295	7TAA010560R0019	11
LT400T-SC	7TAA115120R0061	7	LT9200T-SC	7TAA115120R0057	7	XC-296	7TAA010560R0025	11
LT4100-SC	7TAA115120R0063	7	LT9250-SC	7TAA115120R0039	7	XC-297	7TAA010560R0020	11
LT4100T-SC	7TAA115120R0034	7	LT9250T-SC	7TAA115120R0038	7	XC-298	7TAA010560R0026	11
LT4125-SC	7TAA115120R0033	7	LT9300-SC	7TAA115120R0036	7	XC-870	7TAA010580R0014	11
LT4125T-SC	7TAA115120R0031	7	LT9300T-SC	7TAA115120R0037	7	XC-8710	7TAA010570R0016	11
LT4150-SC	7TAA115120R0030	7	LT938-SC	7TAA115980R0020	7	XC-872	7TAA010580R0015	11
LT4150T-SC	7TAA115120R0029	7	LT938T-SC	7TAA115120R0042	7	XC-873	7TAA010580R0016	11
LT4200-SC	7TAA115120R0058	7	LT9400-SC	7TAA115120R0027	7	XC-874	7TAA010580R0026	11
LT4200T-SC	7TAA115120R0051	7	LT9400T-SC	7TAA115120R0024	7	XC-875	7TAA010580R0027	11
LT4250-SC	7TAA115120R0026	7	LT950-SC	7TAA115120R0059	7	XC-876	7TAA010580R0028	11
LT4250T-SC	7TAA115120R0020	7	LT950T-SC	7TAA115120R0046	7	XC-877	7TAA010580R0029	11
LT4300-SC	7TAA115120R0021	7	LT975-SC	7TAA115120R0047	7	XC-878	7TAA010580R0030	11
LT4300T-SC	7TAA115120R0019	7	LT975T-SC	7TAA115120R0041	7	XC-890	7TAA010580R0017	11
LT438-SC	7TAA115120R0050	7	LTGUS01G-C	7TAA012LN0R0000	6	XC-891	7TAA010570R0011	11
LT438T-SC	7TAA115120R0045	7	LTGUS01G-K	7TAA012LN0R0020	6	XC-8910	7TAA010580R0018	11
LT4400-SC	7TAA115120R0025	7	LTGUS01G-L	7TAA012LN0R0040	6	XC-892	7TAA010570R0012	11
LT4400T-SC	7TAA115120R0032	7	LTGUS02G-C	7TAA012LN0R0001	6	XC-893	7TAA010560R0021	11
LT450-SC	7TAA115120R0043	7	LTGUS02G-K	7TAA012LN0R0021	6	XC-894	7TAA010580R0031	11
LT450T-SC	7TAA115120R0062	7	LTGUS02G-L	7TAA012LN0R0041	6	XC-895	7TAA010580R0019	11
LT475-SC	7TAA115120R0040	7	LTGUS03G-C	7TAA012LN0R0002	6	XC-896	7TAA010570R0018	11
LT475T-SC	7TAA115120R0048	7	LTGUS03G-K	7TAA012LN0R0022	6	XC-897	7TAA010570R0013	11
LT50-SC	7TAA115120R0010	7	LTGUS03G-L	7TAA012LN0R0042	6	XC-898	7TAA010580R0020	11
LT50T-SC	7TAA115120R0004	7	LTGUS04G-C	7TAA012LN0R0003	6			
LT75-SC	7TAA115120R0005	7	LTGUS04G-J	7TAA012LN0R0023	6			
LT75T-SC	7TAA115120R0006	7	LTGUS05G-B	7TAA012LN0R0004	6			
LT-800	7TAA010980R0283	7	LTGUS05G-E	7TAA012LN0R0024	6			
LT-801	7TAA010930R0002	7	LTGUS06G-B	7TAA012LN0R0005	6			
LT-802	7TAA010930R0003	7	LTGUS06G-D	7TAA012LN0R0025	6			
LT-803	7TAA010930R0004	7	LTGUS07G-B	7TAA012LN0R0006	6			
LT-804	7TAA010910R0006	7	LTGUS07G-C	7TAA012LN0R0026	6			
LT-805	7TAA010980R0288	7	LTGUS08G-A	7TAA012LN0R0007	6			
LT-806	7TAA010980R0289	7	LTGUS09G-A	7TAA012LN0R0008	6			
LT-807	7TAA010980R0290	7	LTGUS11G-A	7TAA012LN0R0009	6			



## Further information

Visit our website

Visit the Steel City® web pages on ABB.com for our most up-to-date product lineup, and much more. This is the place to go to find all of the planning documents you need at your fingertips, including:

- **Technical data sheets**
- **Chemical resistance charts**
- **CE declarations of conformity**



T&B Liquidtight systems® online

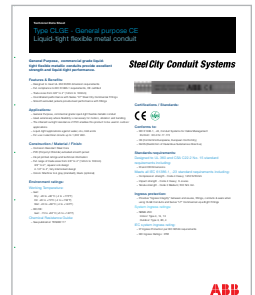
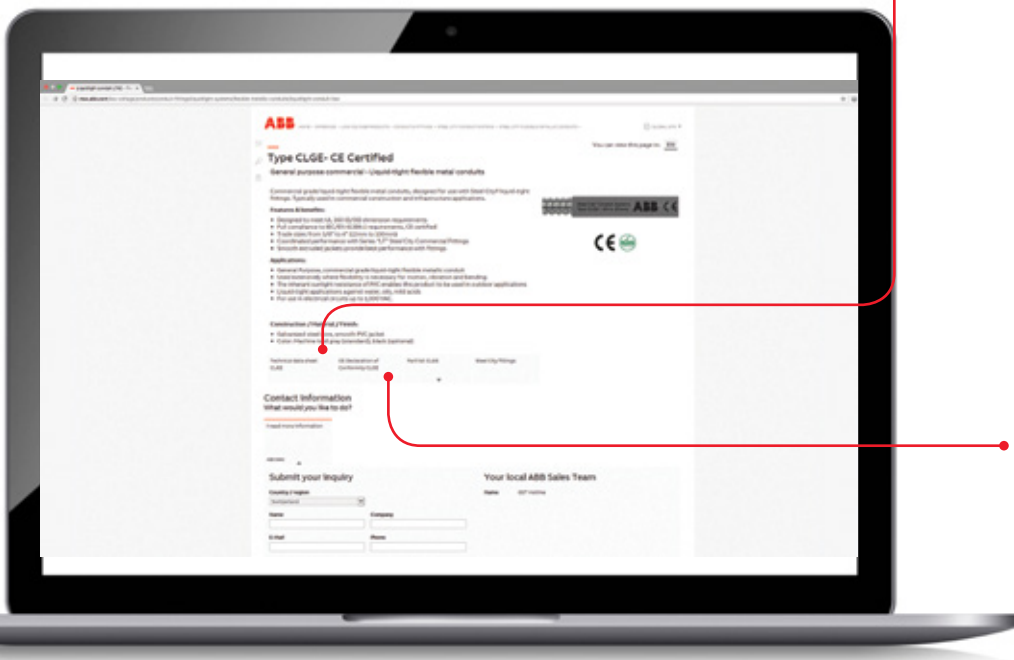

### Additional information

We reserve the right to make technical changes or modify the contents of this document without prior notice. With regard to purchase orders, the agreed particulars shall prevail. ABB Installation Products Inc. does not accept any responsibility whatsoever for potential errors or possible lack of information in this document.

We reserve all rights in this document and in the subject matter and illustrations contained therein. Any reproduction, disclosure to third parties or utilization of its contents – in whole or in parts – is forbidden without prior written consent of ABB Installation Products Inc.



—  
**US**

ABB Installation Products Inc.  
Electrification Business  
860 Ridge Lake Blvd.  
Memphis, TN 38120  
+1 901-252-5000

**[tnb.abb.com](http://tnb.abb.com)**  
**[electrification.us.abb.com](http://electrification.us.abb.com)**