

ACS580-01..., ACH580-01... and ACQ580-01...+C135 frames R1 to R3 flange mounting kit quick installation guide



ABB parts

Available as option +C135. Also separately available for ACX580-01 IP21 and IP55 with ordering codes:
3AXD50000105311 (R1), 3AXD50000105328 (R2), 3AXD50000105335 (R3).

Part a for frames R1...R3

The diagram shows various components labeled with letters a through k. It includes mounting brackets, screws, nuts, and a fan. A large rectangular plate labeled 'i' is also shown.

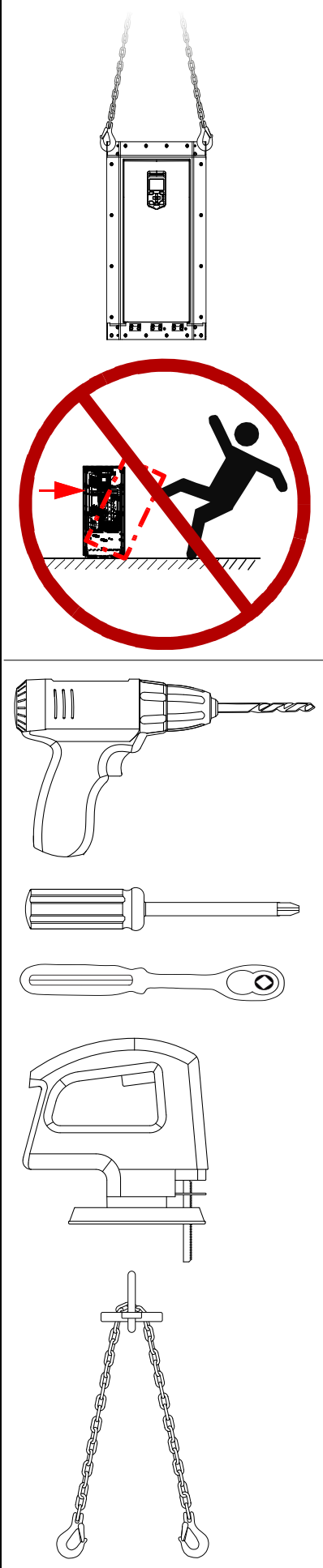
- 4 × M4 nut
- 4 × M5×20 screw
- R1: 10 × M6×25 screw
- R2: 12 × M6×25 screw
- R3: 14 × M6×25 screw
- R1...R2: 18 × M6 nut
- R3: 19 × M6 nut
- R1...R2: 2 × M4 ×8 screw

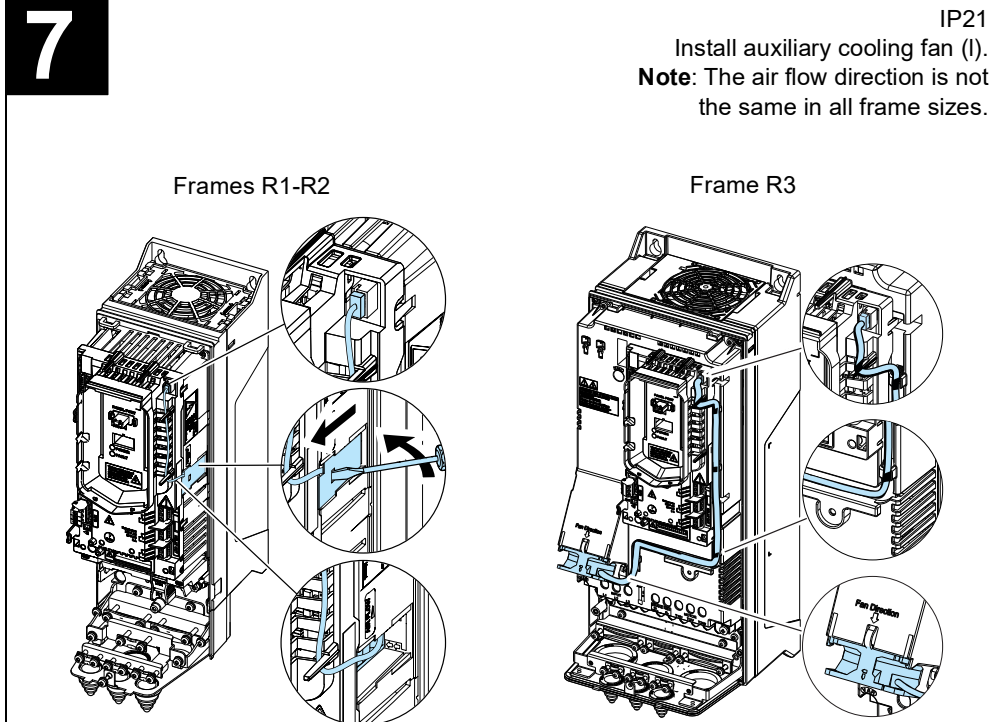
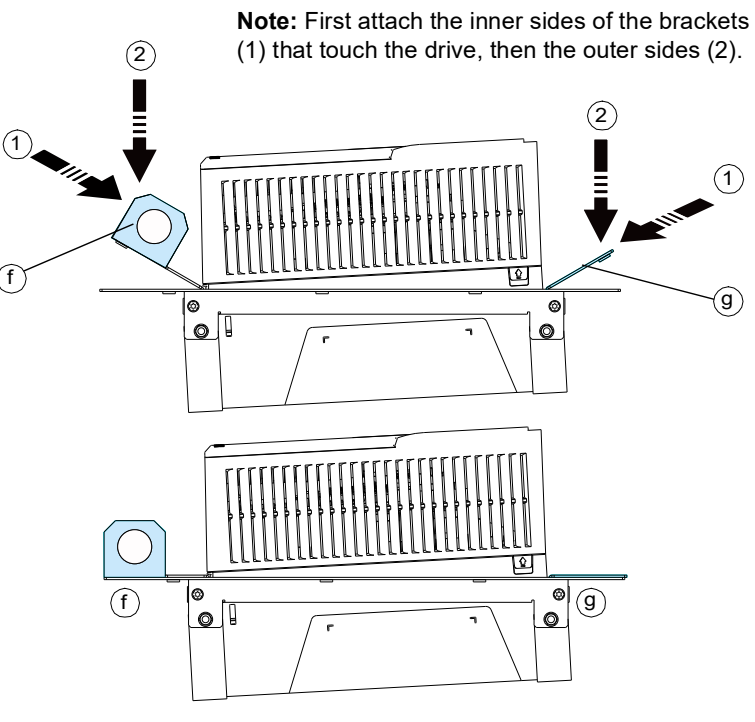
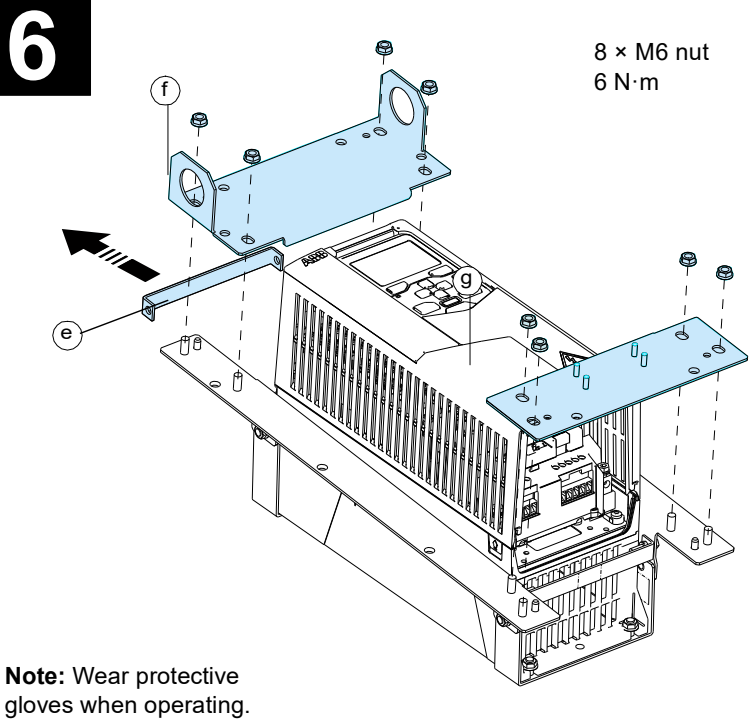
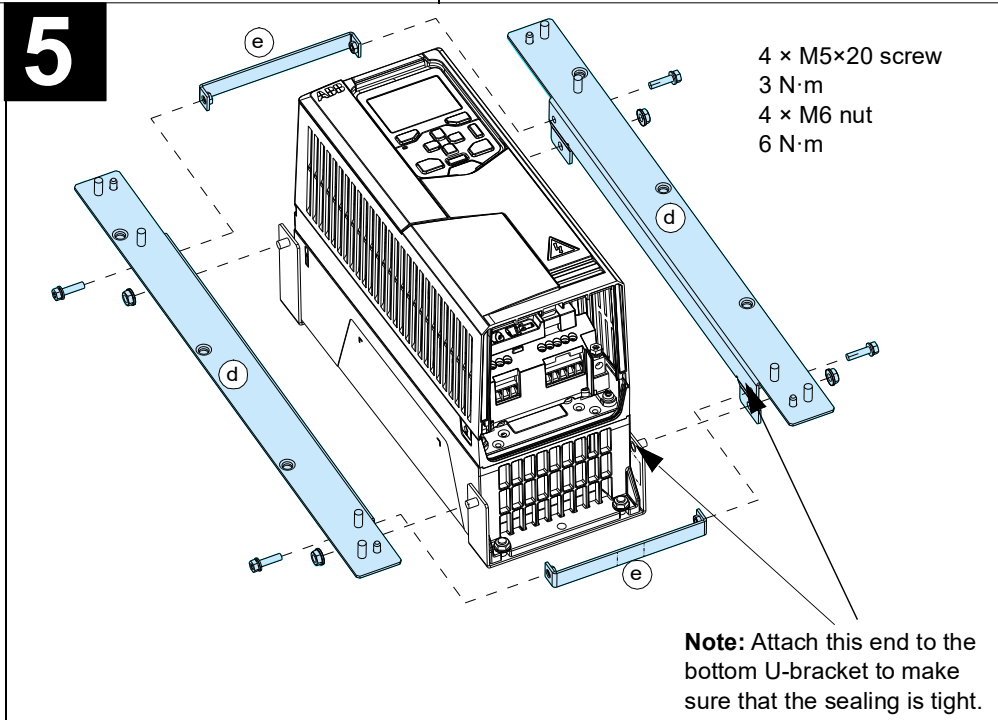
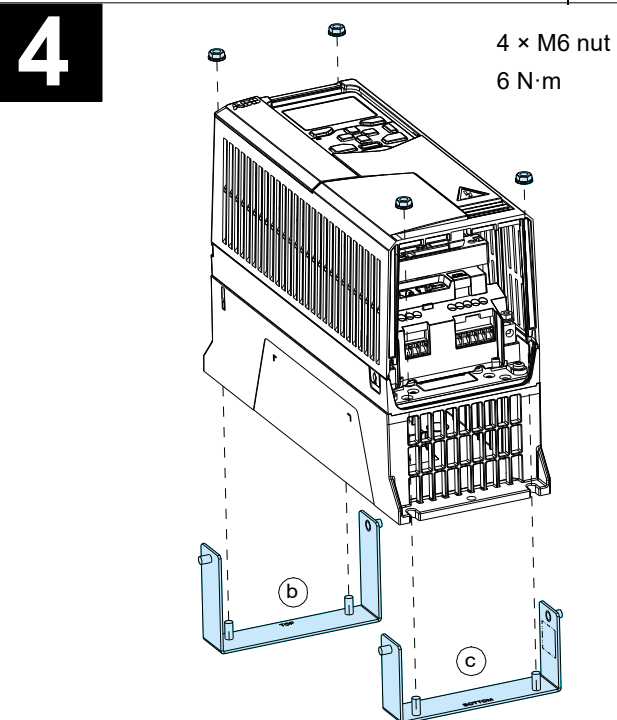
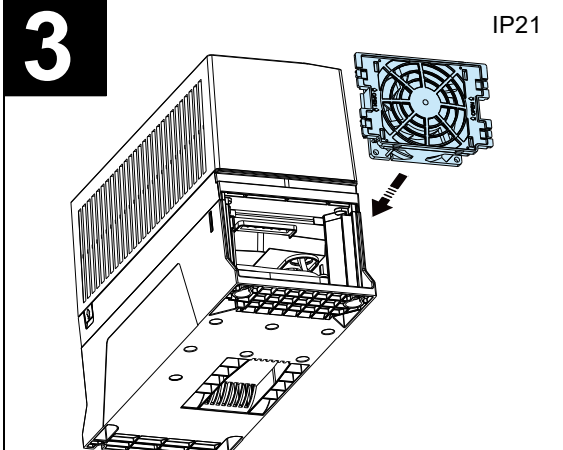
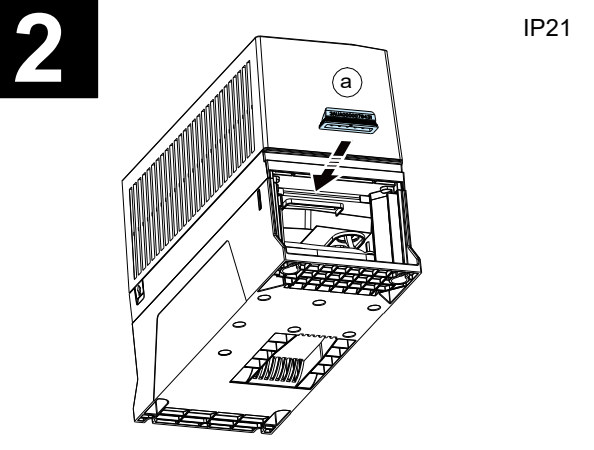
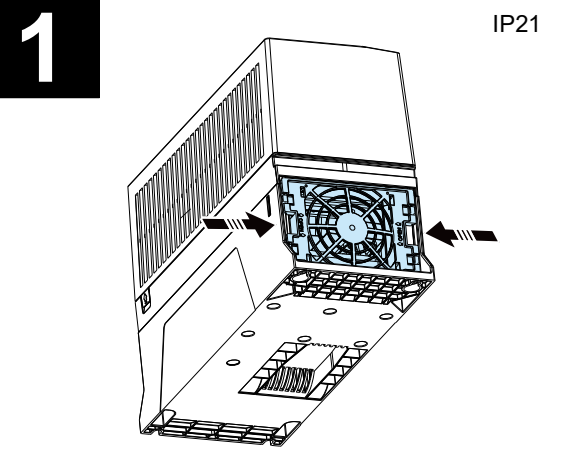

8

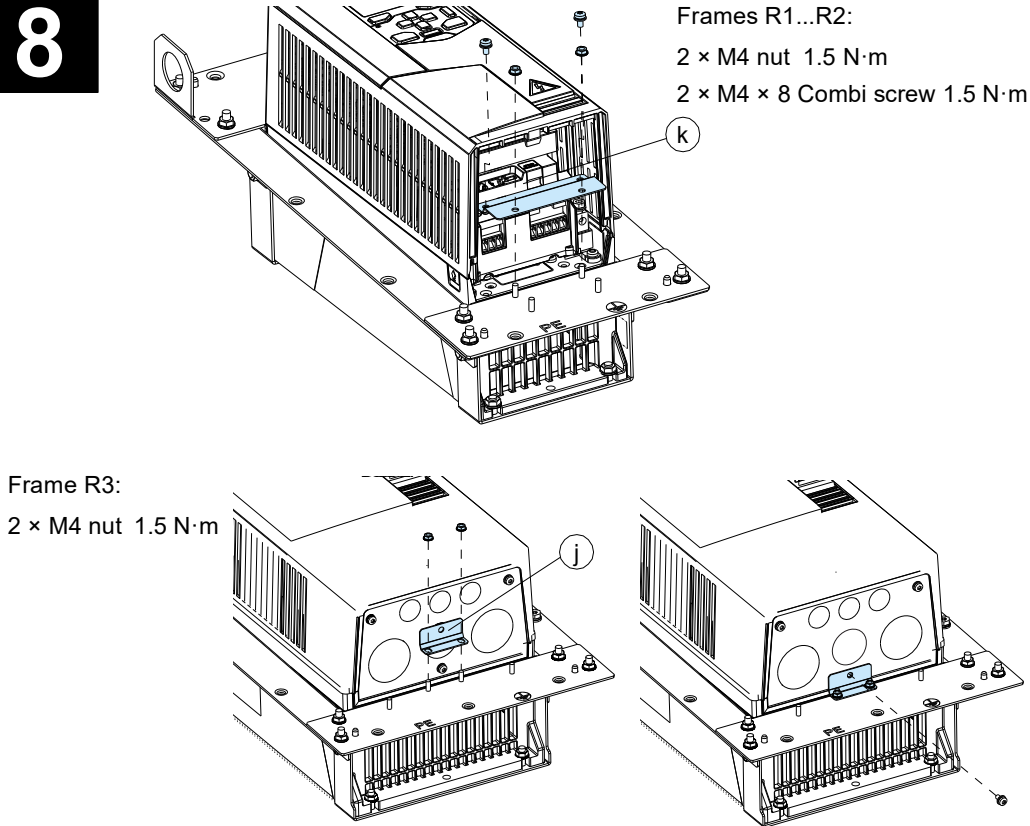

Optional steps

Note: Frame R3 is shown as an example. The cable shelf varies in different frame sizes.

Note: Reinstall the screws to avoid moisture exchange through the empty holes!

1.5 N·m

2 × M4 nut
1.5 N·m

9

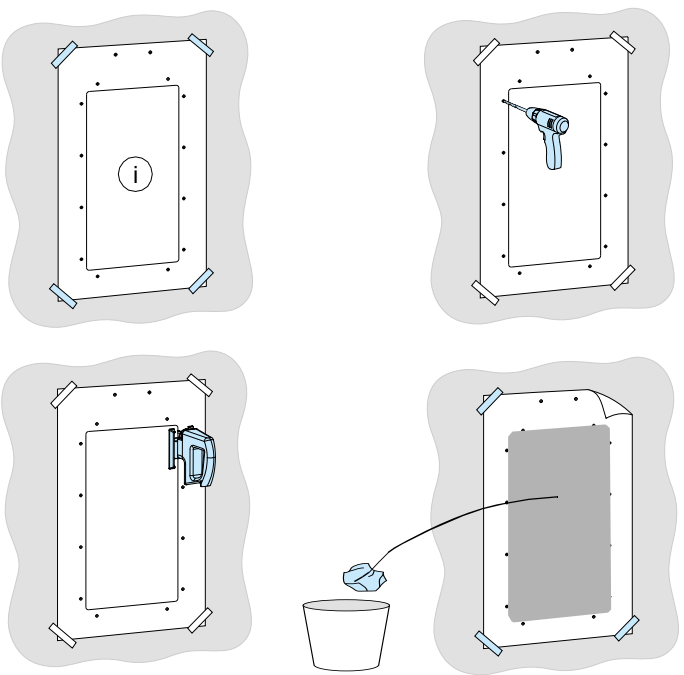

Drill holes for M6 Rivet or Kalei nuts. Consider the hole size for the nuts. Rivet/Kalei nuts are not included in the delivery.

Note: Mounting templates are different (size, number and position of holes) for different frame sizes.

10

Frames R1...R2:
2 × M6 nuts

Frames R3:
3 × M6 nuts
6 N·m

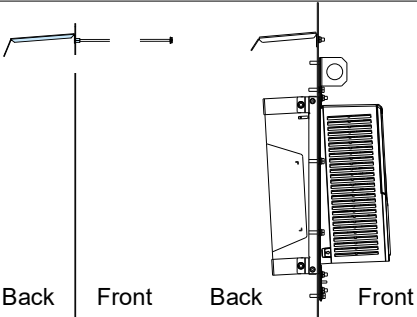

Note: UL Type 12 is fulfilled on the drive backside when the flange and hood are installed. Step 10 is not required for IP55.

For dimensions, see the mounting template delivered with the flange mounting kit or ACS580-01..., ACH580-01... and ACQ580-01...+C135 drives with flange mounting kit supplement (3AXD50000349821 [English]).

Go to www.abb.com/drives

[ACS580-01 manuals](#) [ACH580-01 manuals](#) [ACQ580-01 manuals](#)



11

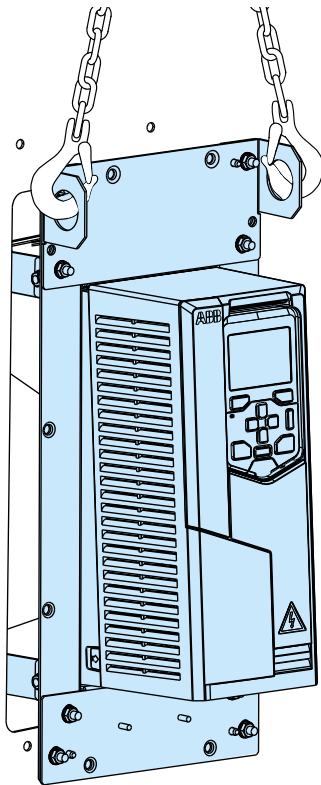

12

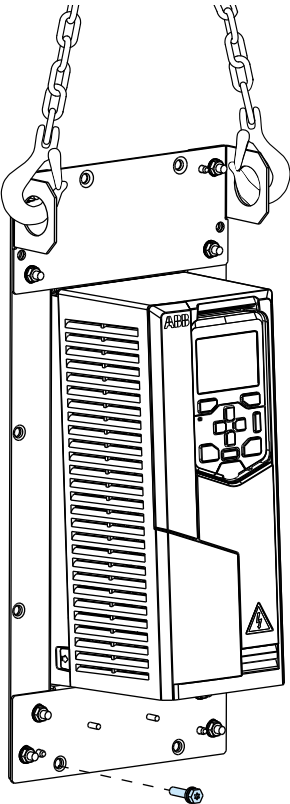

1 × M6×25 screw
6 N·m

13

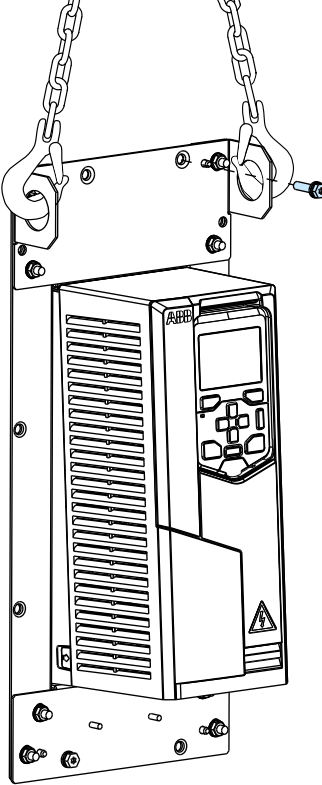

1 × M6×25 screw
6 N·m

14

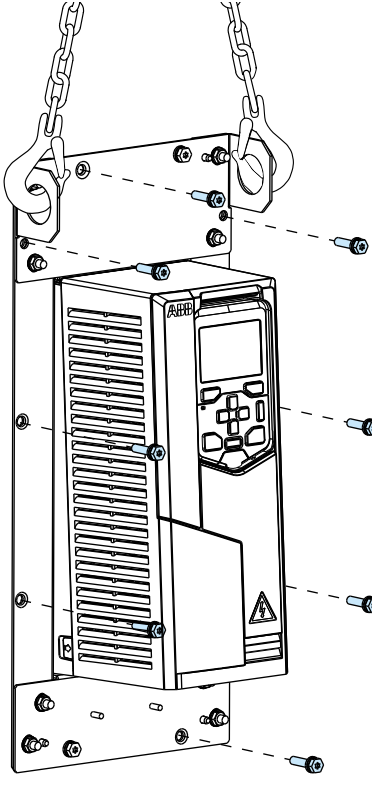

R1: 8 × M6×25 screw
R2: 10 × M6×25 screw
R3: 12 × M6×25 screw
6 N·m

15

