

TOP VIEW

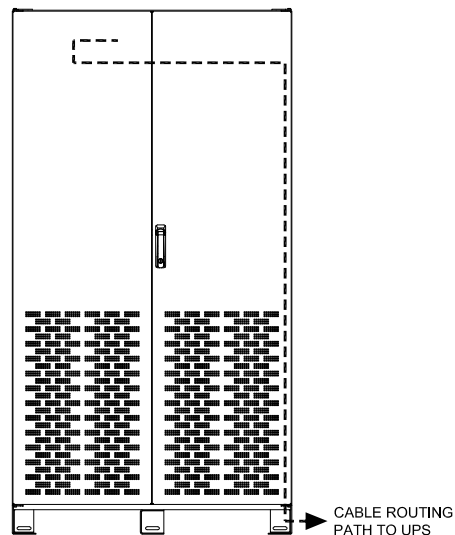

FRONT VIEW

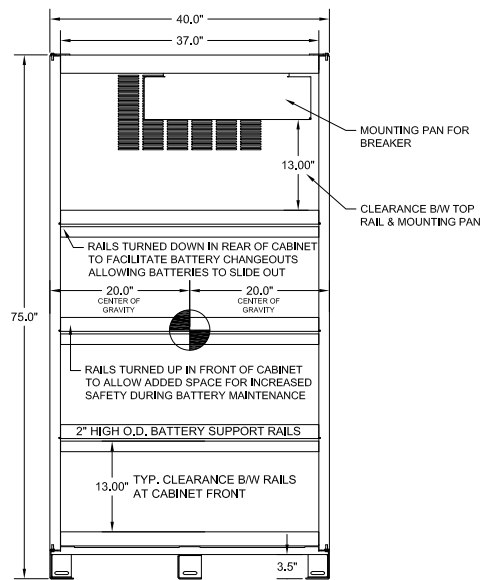

FRONT VIEW
(DOORS REMOVED)

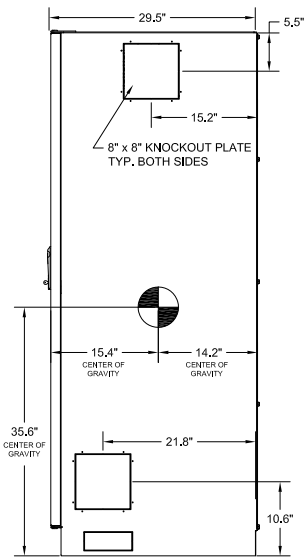

RIGHT SIDE VIEW

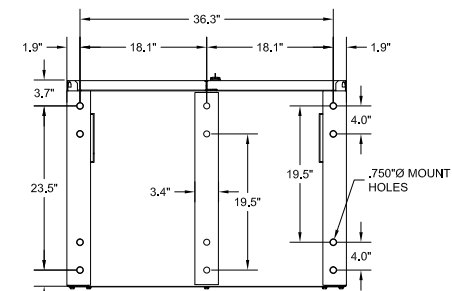
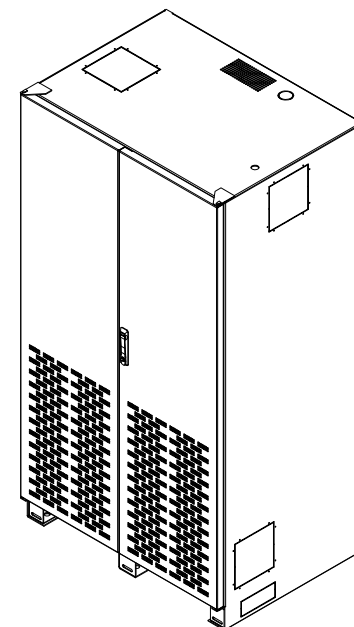

BOTTOM VIEW

NOTES:

1. EMPTY CABINET WEIGHT: 520 LBS
2. NEMA 1 ENCLOSED BATTERY CABINET.
3. FACTORY ASSEMBLED CABINETS ARE LISTED TO UL 1778.
4. HEAVY GAUGE WELDED STEEL CONSTRUCTION.
5. FINISH IS BLACK DURABLE CHIP & CORROSION RESISTANT POWDER COAT.
6. A MINIMUM REAR CLEARANCE OF 2" IS RECOMMENDED FOR OPTIMAL COOLING OF THE EQUIPMENT.
7. FOR EASE OF CONDUIT INSTALLATION, (1) 8" x 8" CONDUIT PLATE IS PROVIDED TO REPLACE A KNOCKOUT IN THE CABINET.
8. BATTERIES CAN BE ACCESSED FROM THE FRONT AND REAR.
9. CABINET CAN BE MOVED WITH PALLET JACK OR FORK LIFT AT PALLET JACK ACCESS POINTS LOCATED AT FRONT OR REAR OF CABINET. FROM THE SIDES, THE CABINET CAN BE MOVED WITH ROL-A-LIFT TYPE EQUIPMENT MOVER. THE CABINET IS ONLY TO BE LIFTED FROM THE BOTTOM.
10. CENTER OF GRAVITY IS FIGURED WITH 540 WATT BATTERIES IN A 480V CONFIGURATION.
11. THE BC50 BATTERY CABINET (OPTIONAL CONFIGURATION) IS CERTIFIED TO THE INTERNATIONAL BUILDING CODE (IBC) AND THE CALIFORNIA BUILDING CODE (CBC) TO MEET SEISMIC DESIGN CATEGORY F, SS = 2.0 AND IMPORTANCE FACTOR 1.5.

BC50 BATTERY CABINET
FOR USE WITH GE TLE SERIES 40-1000 KVA UPS

MECHANICAL DRAWING

THE INFORMATION CONTAINED IN THIS DRAWING IS THE SOLE PROPERTY OF C&C POWER, INC. ANY REPRODUCTION WITHOUT THE WRITTEN CONSENT OF C&C POWER, INC IS PROHIBITED.

DIMENSIONS ARE IN INCHES		INITIALS	DATE
TOLERANCES:			
DECIMALS:	ANGLES:	DRAWN	JRL 06/29/2021
.XX ±.13	±1°	CHECKED	CH 06/29/2021
.XXX ±.062			

SCALE:	SHEET:	REV:	6
NTS	A		

SHEET 1 OF 2



Electrification Product Group
EP Industrial Solutions Division
Manufactured by C&C Power for ABB

© 2021 C&C POWER, INC. ALL RIGHTS RESERVED

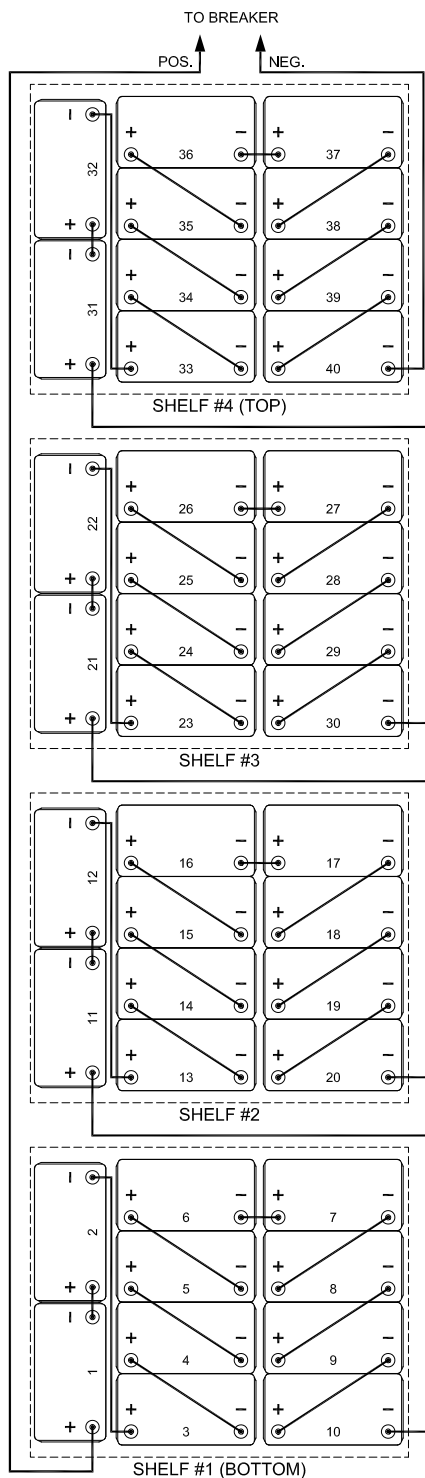

BREAKER WIRING

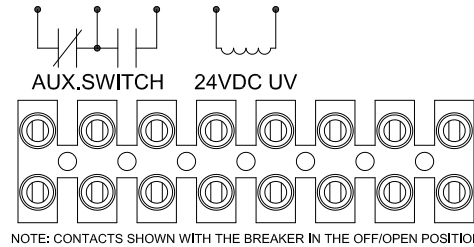
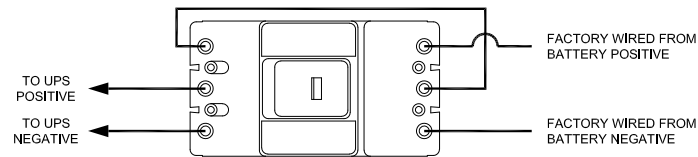

BREAKER ACCESSORIES

NOTES:

1. ALL INTERNAL WIRING IS UL LISTED, MTW, STYLE, 105C, EXTRA FLEXIBLE CABLE.
2. BREAKER IS UL LISTED.
3. BATTERY CABINETS WITH BREAKERS ARE SHIPPED WITH BREAKER IN THE OFF/OPEN POSITION.
4. BREAKER ACCESSORY TERMINAL BLOCK IS SHOWN WITH OPTIONAL ACCESSORIES.
5. MAIN CABLES FROM BATTERY CABINET TO UPS ARE INCLUDED AND ARE SIZED FOR A "SIDE BY SIDE" LINEUP WITH THE UPS WITH BATTERY CABINET MOUNTED TO THE LEFT SIDE OF THE UPS.
6. CABINETS ARE SHIPPED WITH A BATTERY JUMPER REMOVED TO BREAK STRING VOLTAGE FOR ADDED SAFETY IN SHIPPING.
7. GROUND CONNECTION IS #14-1/0 AWG MECHANICAL LUG.

CABLE KIT SIZING

MAIN BREAKER MAX AMPS	MAINS TO UPS
125	1 AWG THHW
150	1/0 AWG THHW
225	4/0 AWG THHW
300	(2) 1/0 AWG THHW
350	(2) 2/0 AWG THHW
400	(2) 4/0 AWG THHW
600	(2) 350 MCM THHW

BC50 BATTERY CABINET

FOR USE WITH GE TLE SERIES 40-1000 KVA UPS

ELECTRICAL DRAWING

THE INFORMATION CONTAINED IN THIS DRAWING IS THE SOLE PROPERTY OF C&C POWER, INC. ANY REPRODUCTION WITHOUT THE WRITTEN CONSENT OF C&C POWER, INC IS PROHIBITED.

DIMENSIONS ARE IN INCHES	INITIALS	DATE
TOLERANCES:	DRAWN JRL	04/13/2020
DECIMALS: .XX ±.13	CHECKED CH	04/13/2020
ANGLES: .XXX ±.082		

SCALE: NTS

SHEET 2 OF 2

REV: 4

SHEET 2 OF 2



Electrical Solutions Product Group
EP Industrial Solutions Division
Manufactured by C&C Power for ABB

© 2020 C&C POWER, INC. ALL RIGHTS RESERVED