



Door Entry System

ABB-Welcome
Your gateway to the world

Power and productivity
for a better world™



Contents



01 Ease

Style meets function	06
Ease in communication	08
Easy remote access	10



02 Simplicity

Designed to please	14
Simple but impressive	16



03 Security

On duty around the clock	20
--------------------------	----



04 Flexibility

Infinite possibilities	24
Customize to fit your needs	26
One solution for all requirements	28





Ease
Simplicity
Security
Flexibility

Style meets function



ABB Welcome indoor station

- » Large 7-inch color display with intuitive touch control
- » Call transfer between different apartment and security station units
- » Ability to leave messages to family members or visitors, or to record theirs

Your home is an expression of yourself. And with the ABB Welcome system, you won't compromise impressive style for innovative technology. For Welcome is more than just a door video system – it is the future of home monitoring and security at your fingertips.

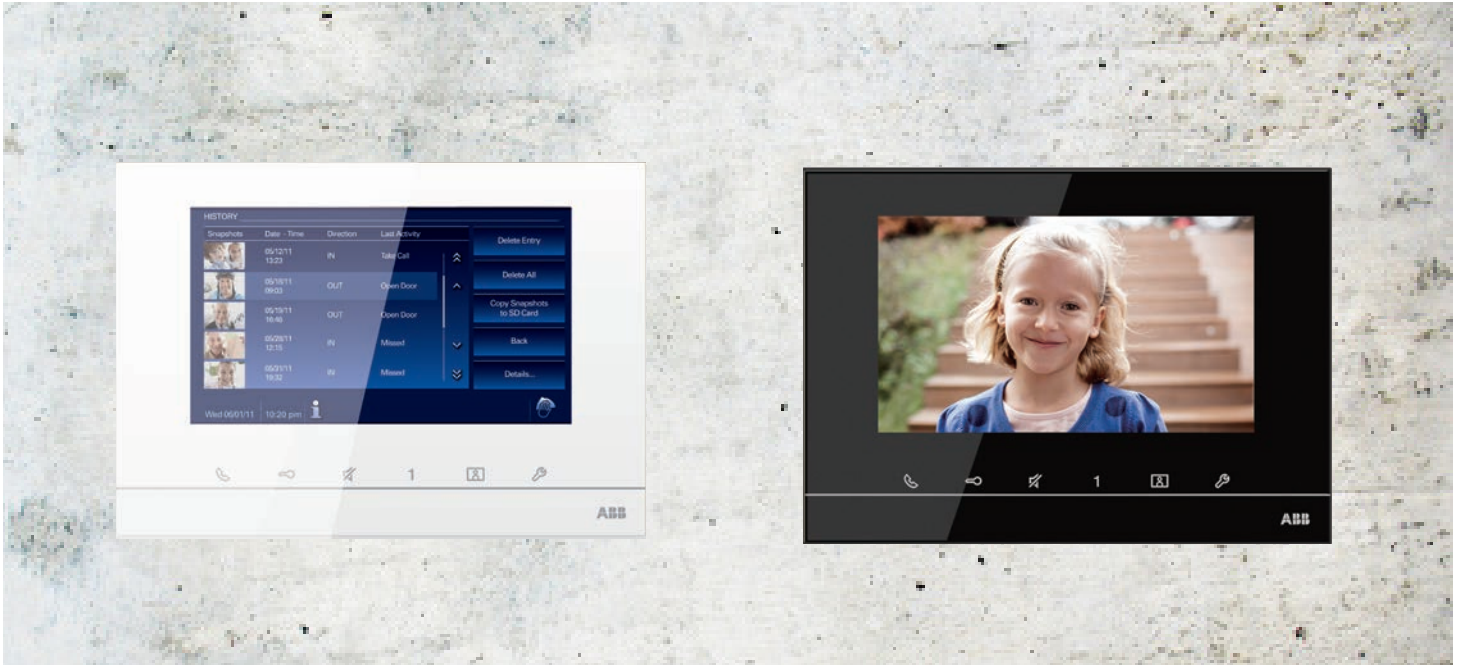

ABB Welcome stainless steel, outdoor station

- » Automatic day to night mode switchover
- » Supplemental illumination of facial features
- » Scratch- and fire-resistant finish on camera module

Good design is not simply about appearance; it is also about functionality. For example, ABB Welcome light sensors automatically switch over from day to night mode. This means that your entry area always presents a good impression, and visitors are instantly drawn to the illuminated station plate. With the ABB Welcome video outdoor station, you can easily see visitors' faces – even in the dark – thanks to an infrared LED that is automatically activated when the bell button is pressed.

Ease in communication



01



02



03

ABB Welcome audio indoor stations

- » Large function buttons (buttons are optional)
- » Additional buttons for customization – such as intercom, call guard unit, unlock additional door, etc.
- » Surface mounted

01 ABB Welcome audio indoor station, handset

02 ABB Welcome audio indoor station, handset with induction loop (for hearing-impaired)

03 ABB Welcome audio indoor station, hands-free

Welcome represents ease in communication, whether it is within your home, or to the outside world. The large buttons, intuitive design, and indicating LEDs ensure an effortless experience. Other functions can include automatic unlock, door status check, and second door unlock.



With Welcome, less is more. The 4.3-inch wide video handset is one of the thinnest on the market. But it is not just the sleek shape that makes it beautiful. You'll also love its powerful and intuitive user experience, even with hearing aids.

Easy remote access



- » Your telephone becomes the indoor station
- » For all types of home networks and mobile devices
- » Simple configuration

ABB-Welcome telephone gateway

The ABB Welcome telephone gateway allows users to control doors remotely and communicate with outdoor stations via mobile or landline telephones.



Communicative. The new ABB Welcome telephone gateway links an ABB Welcome system with any standard telephone system.

ABB Welcome is smartphone compatible. Its app can be used to communicate with the outdoor station, open doors, switch on lights, and much more.



-
- » Access with the app to your ABB Welcome system via the Internet
 - » Send messages via ABB portal to your smartphone
 - » Picture and video memory can be accessed from the Internet
-

iOS



ABB-Welcome IP gateway

The ABB Welcome IP gateway enables the integration of smart devices, allowing accessing your home video, and controlling doors and lighting via apps.



The IP gateway, the ABB portal and the ABB Welcome app enable secure remote control using the Internet. This makes it possible to identify and greet your visitors and guests not only from the sofa or the terrace, but also from a remote location. Using the “call during absence” function, messages are sent to a mobile device, such as a tablet or smartphone. No special settings need to be made on the Internet router for this connection. The devices are linked in the ABB portal.



A man with grey hair and a beard, wearing a blue blazer over a white shirt, is looking to the right while holding a black coffee cup. He is standing in front of a light-colored wall. On the wall, there is a grey rectangular device with a camera lens and a fingerprint scanner. The background shows a blurred green lawn and trees.

Ease
Simplicity
Security
Flexibility

Designed to please

Speaking, hearing, seeing and touching. Welcome brings these senses together in one pleasurable communication experience. That is why the ABB Welcome stainless steel outdoor stations become an integral part of our customers' lives.

ABB-Welcome outdoor stations

- » Full duplex/suppression of noise interference
- » Easy installation

01 ABB-Welcome outdoor station, Keypad

02 ABB-Welcome outdoor station, three buttons



01



02

The ABB Welcome blends with any home style while providing a comfortable and enjoyable communication link between you and the outside world.



ABB Welcome outdoor station

- » Call by name scrolling or by inputting letters
- » Public or private password
- » Built-in RFID proximity reader

Simple but impressive

Thanks to its intuitive design, using the Welcome indoor station is as easy as saying, “hello.” Even without prior experience, residents or guests will instantly understand the easily recognized symbols and functions at a glance.

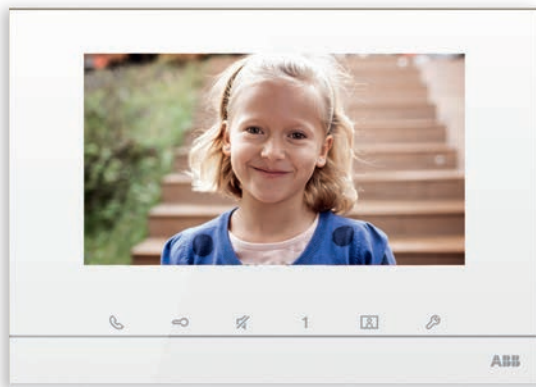

Welcome is designed with a beautiful modern style, and an elegant look. It is more than just a robust door entry system; Welcome also helps you to create an atmosphere of comfort, harmony and style in your home.



Communication

For receiving and ending calls.



Door opener

Opens the electric door lock.



Mute function

Switches off the microphone of the indoor station during a conversation, preventing the visitor at the front door from listening in. It can also be used to switch off the bell. The bell switches back on automatically after 10 hours.

1

Programmable button

For customized function, e.g. intercom, second lock control, relay actuator control for light switch or additional lock, etc.



Snapshot

For instantly taking a photo of visitors at the front door.



Settings

For individually configuring the device.

Installation is as easy as 1-2-3. The screwless, snap-in, modular design is used on both the outdoor and indoor stations. This makes installation an easy, quick and enjoyable process for both surface- and flush-mounted versions.



ABB Welcome is the perfect compliment to your home. And, simple installation makes it easy for Welcome to become part of your life.



Ease
Simplicity
Security
Flexibility



On duty around the clock

Nothing is more disturbing than knowing that intruders could invade the peace and quiet of your home at any time. With our extensive range of safety measures, you can protect your family's well-being. "Home sweet home" is also home safe home.

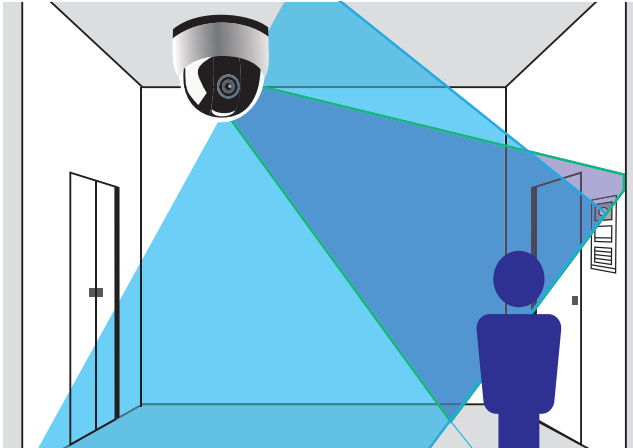

Be connected wherever you are

Our outdoor stations make it easy to integrate additional analog cameras to improve your monitoring range. Home residents can switch between cameras by using our indoor stations, and have the ability to store and archive video and picture messages from visitors.



Interact with the security station

Calling, using the intercom, or sending an emergency message to the security station is easy with the ABB Welcome door entry system. It is also possible to let the security station screen visitor's calls first before taking a call. (Available to all residents or just selected VIPs)





Ease Simplicity Security Flexibility



Infinite possibilities

Our customers' requirements vary from the most basic to the complex. With nine functional modules, ABB Welcome provides the answer for all these needs. This modularity delivers the optimum door communication solution for all types of new construction and retrofit applications. Modularity also allows for a reduction in stock for our distributors and quick service replacements should the need arise.

01 ABB-Welcome camera module

02 ABB-Welcome display module with card reader

03 ABB-Welcome nameplate module

04 ABB-Welcome audio module, no buttons

05 ABB-Welcome audio module, 1/2 buttons

06 ABB-Welcome audio module, 2/4 buttons

07 ABB-Welcome pushbutton module, 3/6 buttons

08 ABB-Welcome pushbutton module, 4/8 buttons

09 ABB-Welcome keypad module

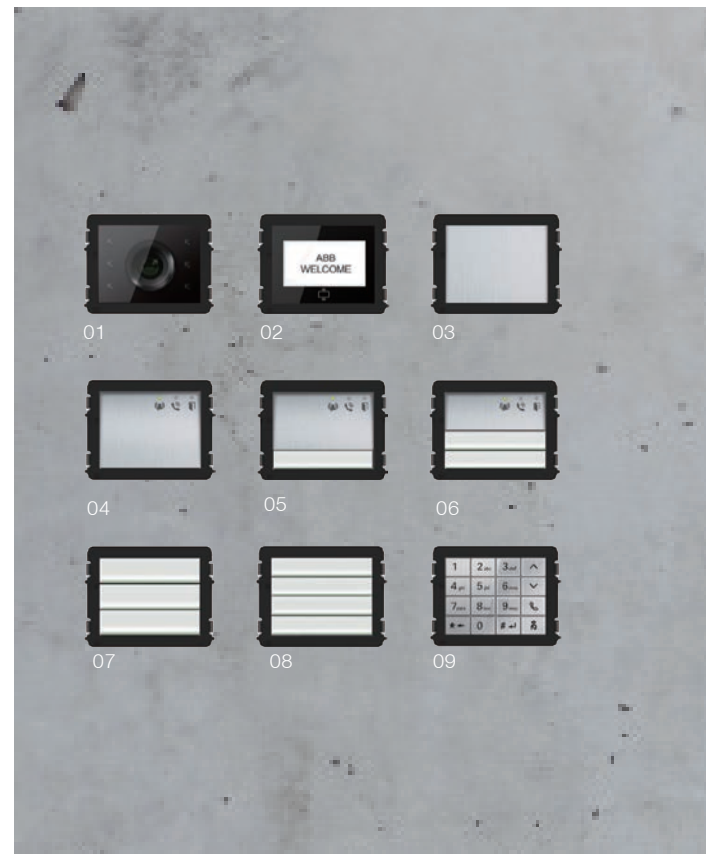



Modular design means more flexibility. For a single family home, many combinations of outdoor stations are possible to create the desired solution according to the requirements of the builder, architect, installer and the aesthetic taste of the owner.



Customize to fit your needs



01



02



03

01 Flush mounted

02 Surface mounted

03 Desk base

Simple and elegant, yet discreet, the 4.3-inch hands-free indoor station is perfect in any living environment.



ABB Welcome Indoor station, 4.3-inch white

- » 4.3-inch display with six touch-sensitive buttons (resolution of 480 x 272 pixels)
- » Up to 60 images can be saved
- » Push to talk in case in noisy situation



The ABB Welcome 4.3-inch video indoor station allows users to select frames with six different finishes to blend with any environment.

One solution for all requirements

With the extensive range of engineered products and its simple, two-wire connection technology, Welcome is the answer to all your needs, whether for new construction or the renovation of old buildings.



ABB-Welcome capacity

- » Two-wire technology throughout
 - » Nine guard units
 - » 60 buildings
 - » 250 indoor stations for per building
 - » 2000 feet from gate station to last indoor station
 - » Nine outdoor stations for each apartment (including gate stations, outdoor stations and second confirmed outdoor stations)
 - » Two locks possible for one outdoor station
-

More is possible. ABB Welcome systems offer flexible solutions for single homes and large residential complexes. With modular construction and two-wire technology it is easy to plan, install and activate the Welcome system. The 2-wire bus technology makes any installation possible to fully meet the requirements of the user.

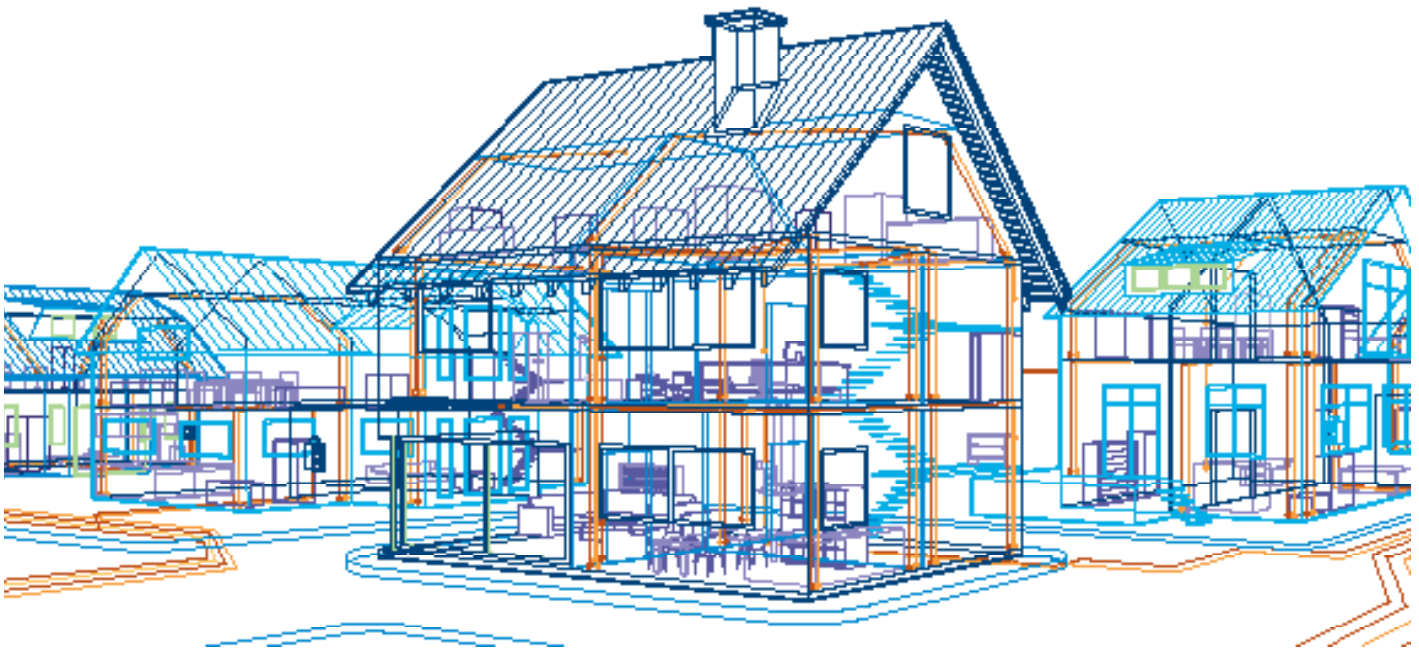

- 01 One-family house
- 02 Multi-family house
- 03 Apartment building
- 04 High-rise building
- 05 Residential Complex

Full-range of products

* For other installation accessories, please check the order catalog.

Welcome outdoor station- stainless steel



01

02

03

- 01 ABB-Welcome outdoor station, one buttons

- 02 ABB-Welcome outdoor station, two buttons

- 03 ABB-Welcome outdoor station, three button

- 04 ABB-Welcome outdoor station, six buttons

- 05 ABB-Welcome outdoor station, Keypad with display



04

05

Welcome outdoor station- aluminum



01

02

03

- 01 ABB-Welcome outdoor station cover frame, 1 module, Dimensions:128 x 125 x 19 mm

- 02 ABB-Welcome outdoor station cover frame, 3 modules, Dimensions:274 x 125 x 19 mm

- 03 ABB-Welcome exteriorstation cover frame, 6 modules, Dimensions:201 x 125 x 19 mm

- 04 ABB-Welcome outdoor station cover frame, 2 modules, Dimensions:274 x 230 x 19 mm

- 05 ABB-Welcome outdoor station cover frame, 4 modules, Dimensions:347 x 125 x 19 mm

- 06 ABB-Welcome outdoor station cover frame, 8 modules, Dimensions:347 x 230 x 19 mm



04



05



06



* For other color reference, please check the order catalog.

Welcome indoor station

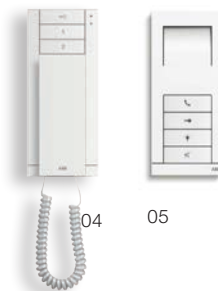
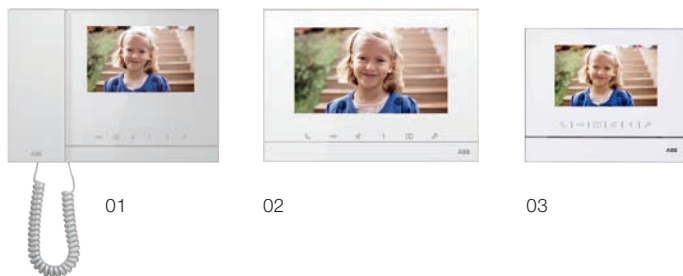

01 ABB-Welcome video indoor station, 4.3-inch handset

02 ABB-Welcome video indoor station, 7-inch hands-free

03 ABB-Welcome video indoor station, 4.3-inch hands-free

04 ABB-Welcome audio indoor station, handset

05 ABB-Welcome audio indoor station, hands-free

Welcome accessories



01 ABB-Welcome telephone gateway

02 ABB-Welcome IP gateway

03 ABB-Welcome gateway

04 ABB-Welcome mini system controller

05 ABB-Welcome system controller

06 ABB-Welcome system controller with actuator

07 ABB-Welcome distributor, exterior

08 ABB-Welcome distributor, interior

09 ABB-Welcome switch actuator

10 ABB-Welcome security station

