

MEDIUM VOLTAGE PRODUCT

TJC 7.4

Indoor Voltage Transformer



The single-pole voltage transformer TJC 7.4 is cast in epoxy resin and designed for insulation voltages up to 36 kV.

Primary terminal

One outlet of the primary winding, including the respective terminal is insulated from the earth to a level which corresponds to the rated insulation value. The other outlet of the primary winding with the terminal is earthed during the operation. For fastening the primary conductor to the terminal, the TJC 7.4 terminal uses either one M16 screw or, optionally, two M10 screws.

Secondary terminal

The transformer supports up to three secondary windings. One or two of these windings are intended for measurement and/or protection applications in a star connection. The remaining winding is designed for integration into an open-delta configuration within a three-phase system.

For safe and proper operation, it is essential to earth one terminal from each secondary winding's star connection, as well as one terminal from the open-delta connection across the three transformers.

Secondary terminals are equipped with M5 screws for wiring connections and through-holes for direct earthing of the secondary circuit using M5 screws.

The secondary terminal board is protected by a sealable plastic cover. The maximum diameter of the cable or wire connected to a single secondary terminal is $2 \times \text{Ø}2.5 \text{ mm}$.

Mounting

The transformer can be mounted in any position and is secured using four M10 screws. An M8 screw is provided for earthing the transformer to the base plate.

Parameters	TJP 7.4
Rated primary voltages	up to $35/\sqrt{3} \text{ kV}^{1)}$
Rated secondary voltages	up to $120/\sqrt{3} \text{ V}^{1)}$
Rated voltages for open-delta connection	up to $120/3 \text{ V}^{1)}$
Voltage factor	$1.9 \times U_n/8 \text{ h}$
Highest voltage for equipment	up to $36 \text{ kV}^{2)}$
Power frequency test voltage, 1 min.	up to $70 \text{ kV}^{2)}$
Lightning impulse test voltage	up to $170 \text{ kV}^{2)}$
Accuracy class (measuring winding)	0.2; 0.5; 1
Accuracy class (protection winding)	3P; 6P
Max. rated burden, classes	30/0.2 - 75/0.5 - 150/1 VA/cl
Residual winding	50 - 200/6P VA/cl
Rated frequency	50 Hz; 60 Hz
Max. number of secondary windings	up to 3
Standard	IEC ³⁾

1) Other rated values can be supplied on request.

2) Insulation levels according to IEC standards. Other insulation levels can be supplied on request.

3) On request, the transformer can be manufactured in accordance with the requirements and recommendations of the VDE, IEEE, BS, GOST, and CSN.

TJC 7.4

Dimensional Drawing

Weight: 49 kg

Creepage distance: 400 mm

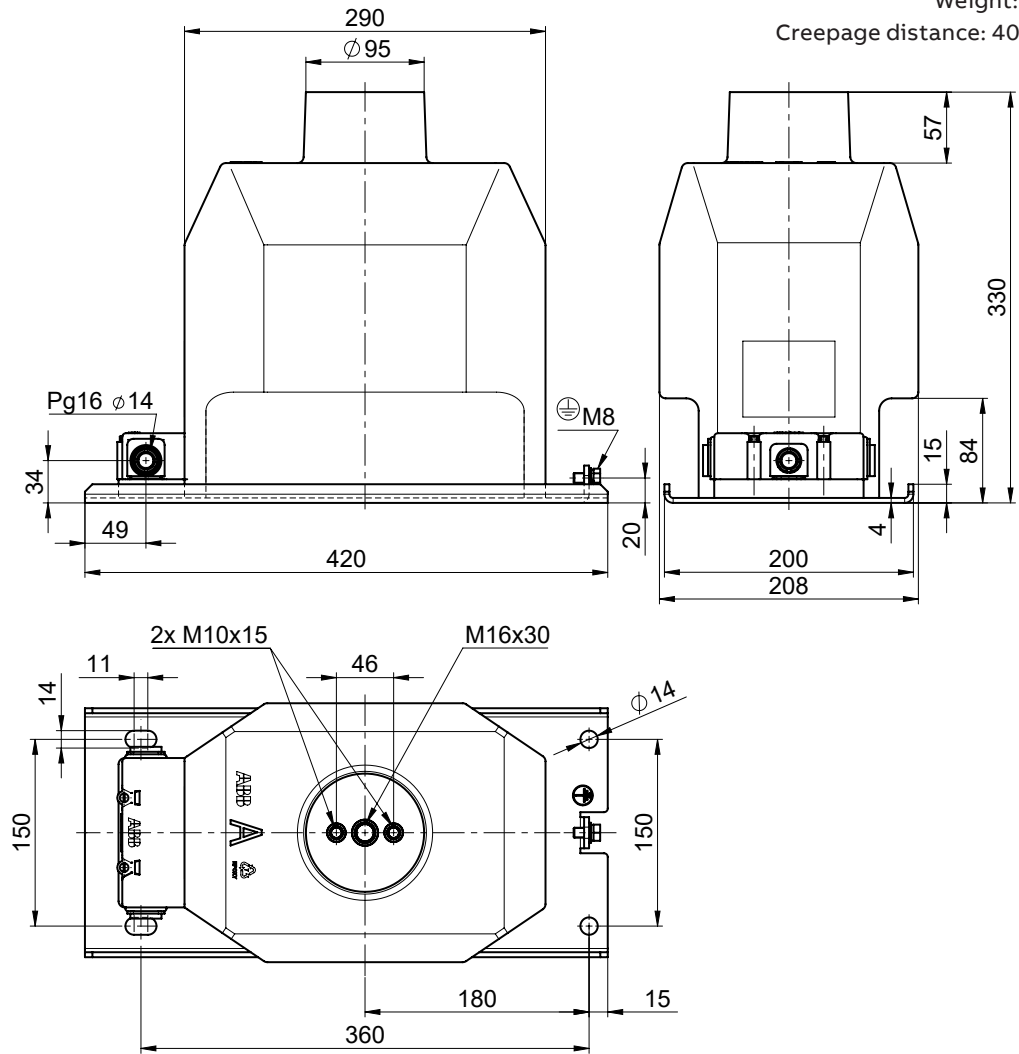

Marking of the voltage transformers outlets

- a** Single-pole insulated transformer
- b** Single-pole insulated transformer with a tap
- c** Single-pole insulated transformer with two secondary windings
- d** Single-pole insulated transformer with two secondary windings, with one of which being the auxiliary (residual) winding
- e** Single-pole insulated transformer with two secondary, tapped windings, with one which being the auxiliary (residual) winding

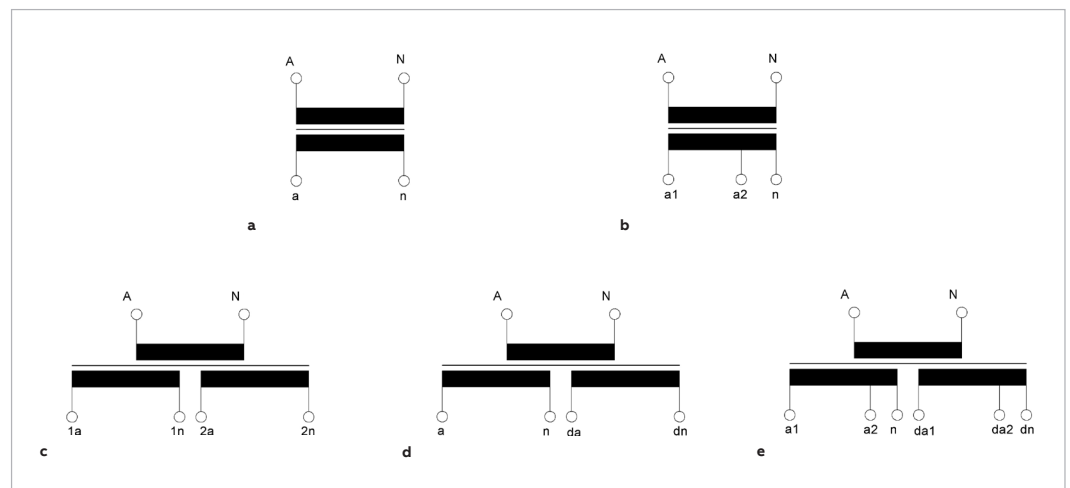

CONTACT US

ABB s.r.o.
 ELDS Brno
 Videnska 117, 619 00 Brno,
 Czech Republic
 Tel.: +420 547 152 036
 +420 547 152 854
 E-mail: kontakt@cz.abb.com

NOTE

We reserve the right to make technical changes or modify the contents of this document without prior notice. With regard to purchase orders, the agreed particulars shall prevail. ABB does not accept any responsibility whatsoever for potential errors or possible lack of information in this document.

We reserve all rights in this document and in the subject matter and illustrations contained therein. Any reproduction, disclosure to third parties or utilization of its contents - in whole or in parts - is forbidden without prior written consent of ABB.

Copyright© 2026 ABB
 All rights reserved